

Electrical Test Program – Component Locations (RTR)

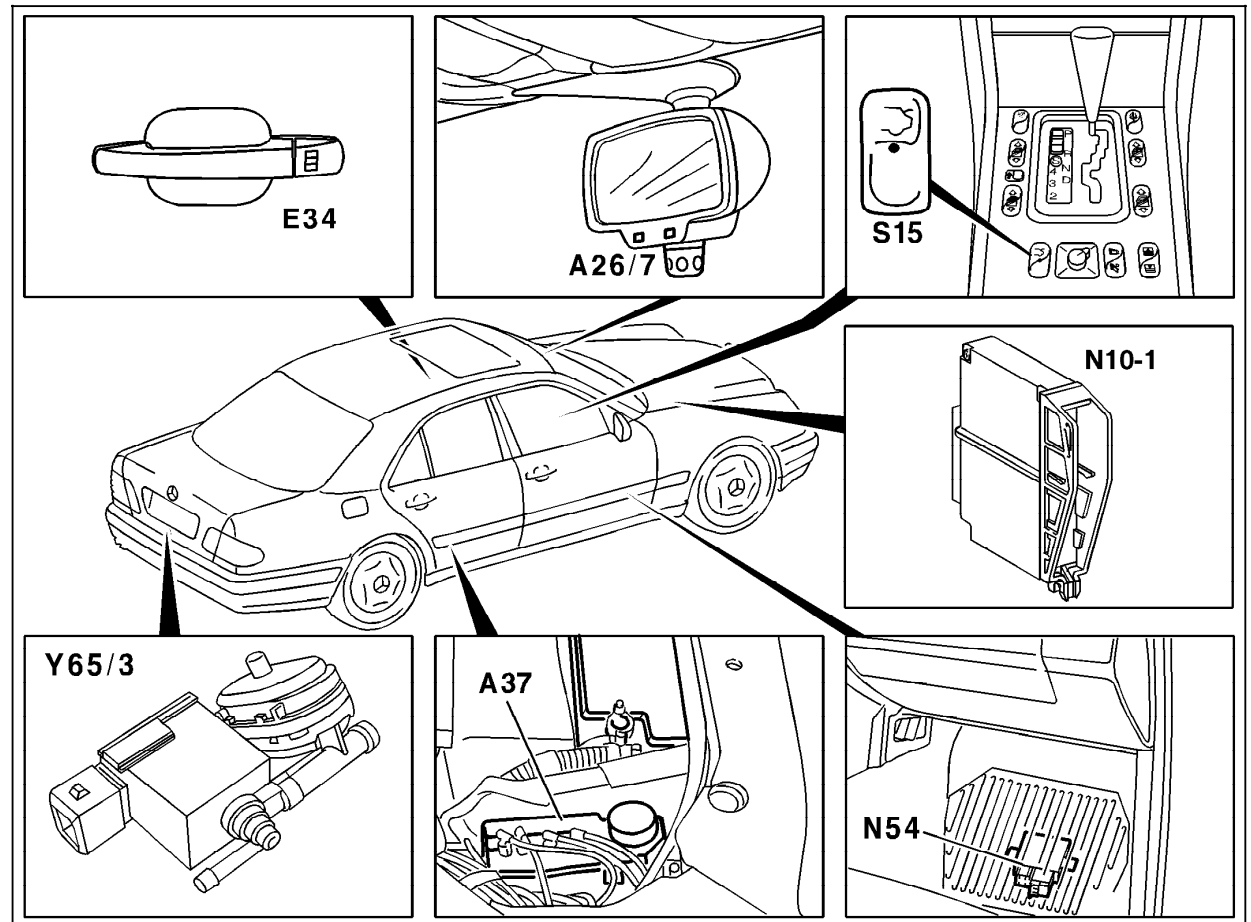

Figure 1

- A26/7 RCL receiver (interior rearview mirror)
- A37 PSE control module, combined functions
- N10-1 Combination control module
- N54 RCL control module
- S15 Remote trunk release switch
- Y65/3 RTR control valve (CL)

U80.20-0236-06