

Pneumatic Test Program - Preparation for Test

Preparation for Test:

1. Unlock vehicle using IR transmitter,
2. Connect vacuum/pressure tester with reservoir to PSE control module (see 32, Figure 1),
3. Voltage supply to all control modules and CAN data lines ok,
4. Battery voltage 11 – 14 V,
5. Fuses for PSE system and PSE control module ok,
6. Review section 0,
7. Review 31

Parts Required for Test:

1	Reservoir	107 800 08 19
1	Y-distributor	117 078 01 45
3	Plug	000 987 11 45
1	Connection hose, 50 mm long	007 997 61 82
2	Pneumatic line, 1 m long	000 158 14 35
1	Connector	202 800 05 53

Special Tools

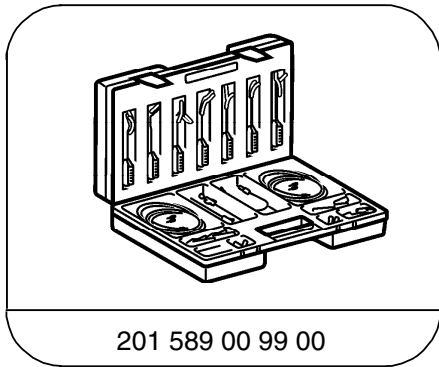

201 589 00 99 00

Electrical connecting set

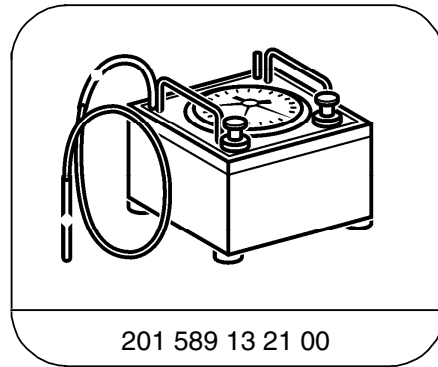

201 589 13 21 00

Tester

Notes:

1. Before testing the safety switch time of the consumers, interrupt the PSE control module power supply for at least 3 seconds.
2. After completing the **PSE** control module test, interrupt the PSE control module power supply for at least 3 seconds (erase safety time memory).
3. Additionally, after completing the **PSE** control module test, do not operate any system which would require vacuum or pressure for approx. 10 minutes.
4. The connections on the PSE control module are marked with their German acronyms. Reference to these connections in this test are made to their U. S. equivalents. In other words:
 ZV (German) = CL (U.S.),
 SRU (German) = MVA (U.S.),
 OSL (German) = OSB (U.S.).

Pneumatic Test Program - Preparation for Test

Connection Diagram - Vacuum/Pressure Tester with Reservoir

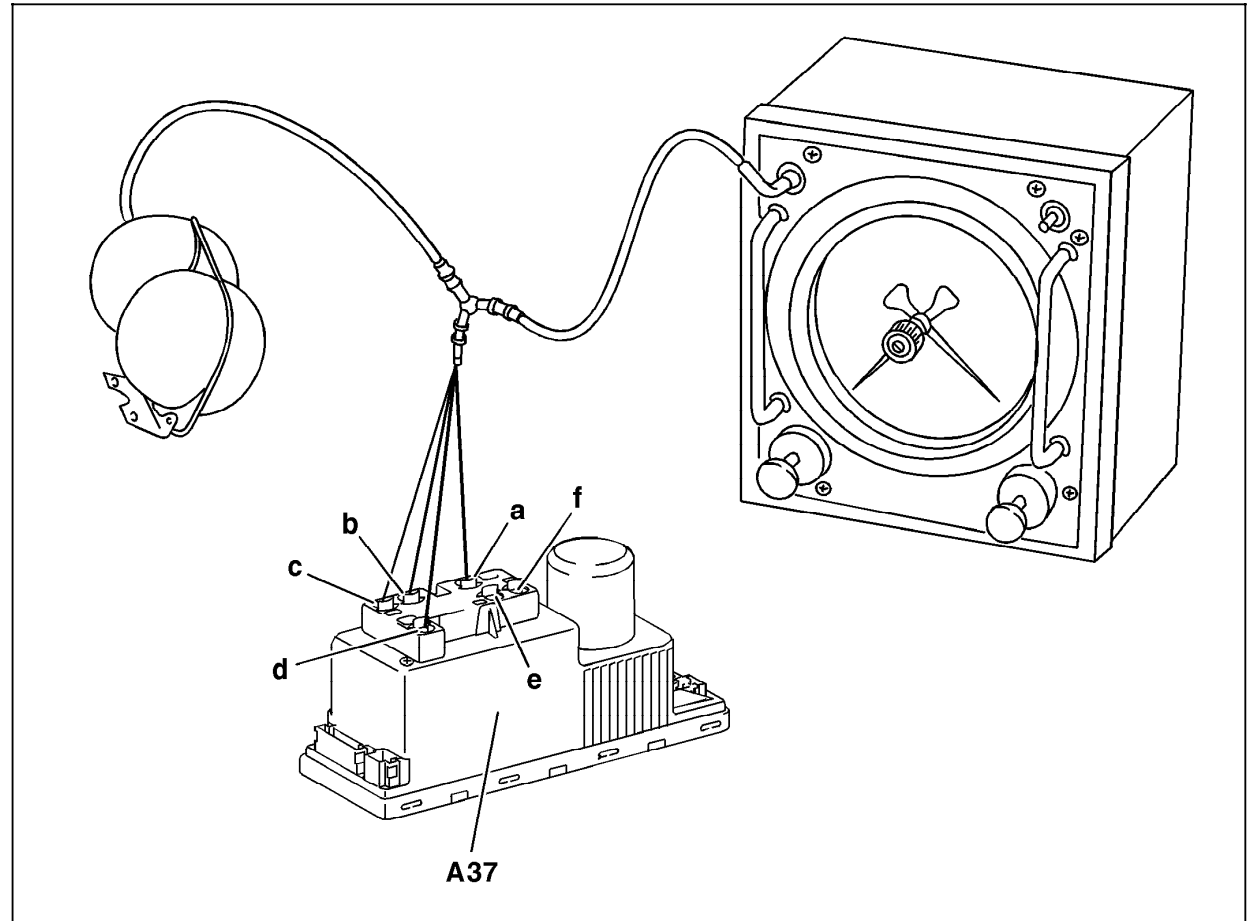

Figure 1

- a Right front/right rear door pneumatic connection
- b Left front door pneumatic connection
- c Fuel tank pneumatic connection
- d RTR/RHR in rear pneumatic connection
- e Multi-contour seat backrest pneumatic connection
- f MVA pneumatic connection
- A37 PSE control module, combined functions

P80.20-0366-06