

### Electrical Test Program – Connection of Components

A2	Radio	N7	Exterior lamp failure monitoring module
A26/7	RCL receiver (interior rearview mirror)	N10-1	Combination control module
A37	PSE control module, combined functions	N22	A/C pushbutton control module (Automatic A/C)
E3e1	Turn signal lamp	N32/1	Left front ESA control module (with memory)
E4e1	Turn signal lamp	N32/2	Right front ESA control module (with memory)
E6/1e1	Turn signal	N47-1	ASR/SPS control module
E6/2e1	Turn signal	N47-2	ETS/SPS control module
E15/2	Front dome lamp (with shut-off delay and front reading lamp)	N54	RCL control module
E15/3	Rear dome lamp	N54/1	IR DAS control module
E17/3	Left front door entrance/exit lamp	R1	Rear window defroster element
E17/4	Right front door entrance/exit lamp	S2	Starter switch
E17/5	Left rear door entrance/exit lamp	S4	Combination switch
E17/6	Right rear door entrance/exit lamp	S6/1s2	Interior switch (CL)
E25/3	Left D-pillar interior lamp	S6/1s3	RHR unlocking switch
E25/4	Right D-pillar interior lamp	S9/1	Stop lamp switch (4-pole)
H3	Alarm horn	S13/2	Sliding/pop-up roof switch
K54	Locking confirmation relay module	S15	Remote trunk release switch
L6/1	Left front axle VSS sensor	S17/3	Left front door switch
L11	Transponder coil	S17/4	Right front door switch
M2/2	Module box blower motor	S17/5	Left rear door switch
M6/1	Wiper motor	S17/6	Right rear door switch
M10/3	Left front power window motor (voltage supply)	S17/8	Trunk lamp switch
M10/4	Right front power window motor (voltage supply)	S21	Center console switch group
M10/5	Left rear power window motor	S21/3	Left rear power window switch
M10/6	Right rear power window motor	S21/4	Right rear power window switch
M12/1	Sliding/pop-up roof	S62	Engine hood switch (ATA)
M20	ESC motor	S86/1	Left front door lock switch (CF) <sup>USA</sup>
M21/4	Electrically adjustable and heated driver-side outside rearview mirror (with memory)	S87/1	Right front door lock switch (CF) <sup>USA</sup>
M21/5	Electrically adjustable and heated front passenger outside rearview mirror (with memory)	S88/2	Rotary tumbler/trunk lid microswitch <sup>USA</sup>
M27	Left front ESA motor group (with memory)	S91	Left front ESA switch group (with memory)
M28	Right front ESA motor group (with memory)	S91s11	Steering column up/down switch
N7	Exterior lamp failure monitoring module	S91s12	Steering column in/out switch
N10-1	Combination control module	S92	Right front ESA switch group (with memory)
N22	A/C pushbutton control module (Automatic A/C)	X11/4	Data link connector (DTC readout)
N32/1	Left front ESA control module (with memory)	Y65/3	RTR control valve (CL)
N32/2	Right front ESA control module (with memory)		
N47-1	ASR/SPS control module	A	CAN-version
N47-2	ETS/SPS control module	SN1	Lock switch circuit 1 (disarm)
		SN2	Lock switch circuit 2 (arm)
		1	Engine control module

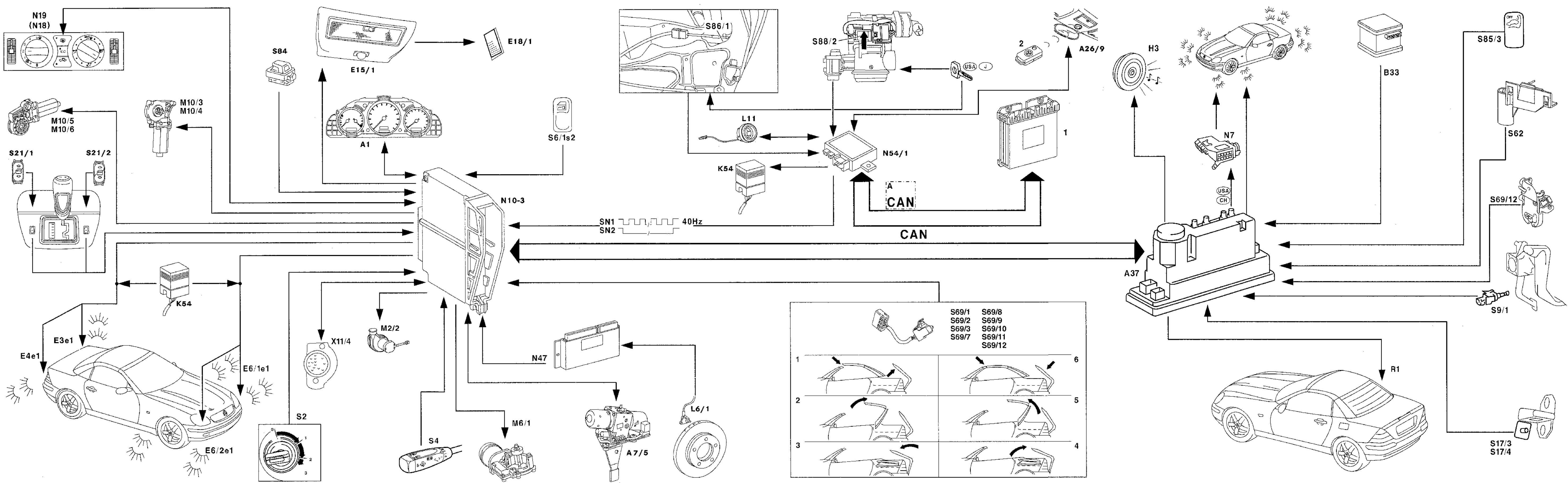

### Electrical Test Program – Connection of Components

A1	Instrument cluster	S6/1s2	Interior switch (CL)
A7/5	Retractable hardtop hydraulic unit	S9/1	Stop lamp switch (4-pole)
A26/9	RCL receiver (roof frame)	S17/3	Left front door switch
A37	PSE control module, combined functions	S17/4	Right front door switch
E3e1	Turn signal lamp	S17/8	Trunk lamp switch
E4e1	Turn signal lamp	S21/1	Left front power window switch (front center console )
E6/1e1	Turn signal	S21/2	Right front power window switch (front center console)
E6/2e1	Turn signal	S62	Engine hood switch (ATA)
E15/1	Front dome light (with switch)	S69/1	Retractable hardtop closed limit switch (right pin)
E18/1	Trunk lamp	S69/2	Retractable hardtop locked limit switch (right rotary switch)
H3	Alarm horn	S69/3	Retractable hardtop locked limit switch (left rotary switch)
K54	Locking confirmation relay module	S69/7	Trunk lid closed/locked left limit switch
L6/1	Left front axle VSS sensor	S69/8	Trunk lid closed/locked right limit switch
L11	Transponder coil	S69/9	Trunk lid open limit switch
M2/2	Module box blower motor	S69/10	Trunk divider closed limit switch
M6/1	Wiper motor	S69/11	Retractable hardtop open/stored limit switch
M10/3	Left front power window motor (voltage supply)	S69/12	Rotary latch selector switch, trunk lock/trunk illumination
M10/4	Right front power window motor (voltage supply)	S84	Power soft top switch
M10/5	Left rear power window motor	S85/3	ATA status/towing protection switch
M10/6	Right rear power window motor	S86/1	Left front door lock switch (CF) <b>(USA)</b>
N7	Exterior lamp failure monitoring module	S88/2	Rotary tumbler/trunk lid microswitch <b>(USA)</b>
N10-3	Combination control module	X11/4	Data link connector (DTC readout)
N19/1	A/C pushbutton control module (Tempmatic)		
N47	Traction systems control module	A	CAN-version
N54	RCL control module	SN1	Lock switch circuit 1 (disarm)
R1	Rear window defroster element	SN2	Lock switch circuit 2 (arm)
S2	Starter switch	1	Engine control module
S4	Combination switch	2	IR transmitter key