

Electrical Test Program – Component Locations (NS)

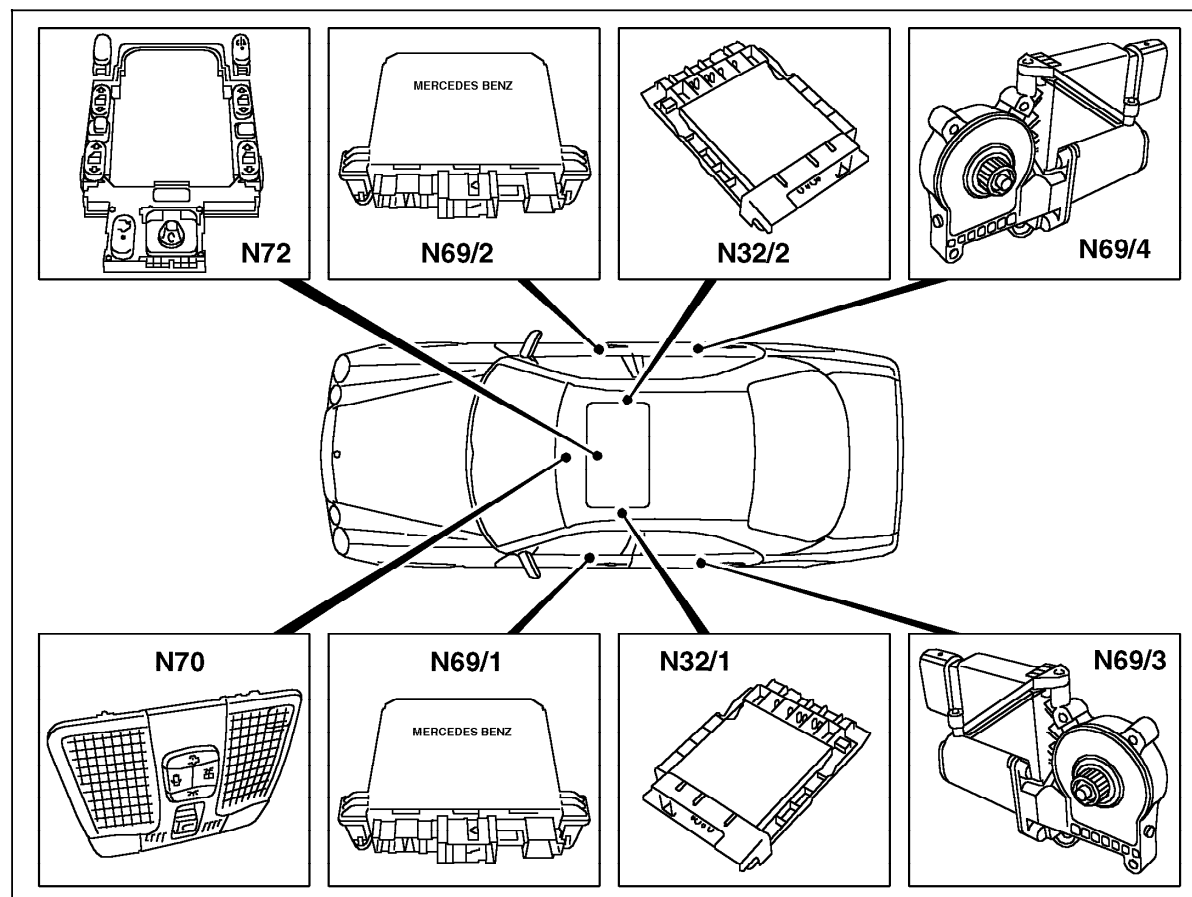

P54.21-0234-06

Figure 1

- N32/1 Left front ESA control module (with memory)
- N32/2 Right front ESA control module (with memory)
- N69/1 Front driver-side door control module
- N69/2 Front passenger-side door control module
- N69/3 Rear driver-side door control module
- N69/4 Rear passenger-side door control module
- N70 Roof control panel control module
- N72 Lower control field control module

Electrical Test Program – Component Locations (NS)

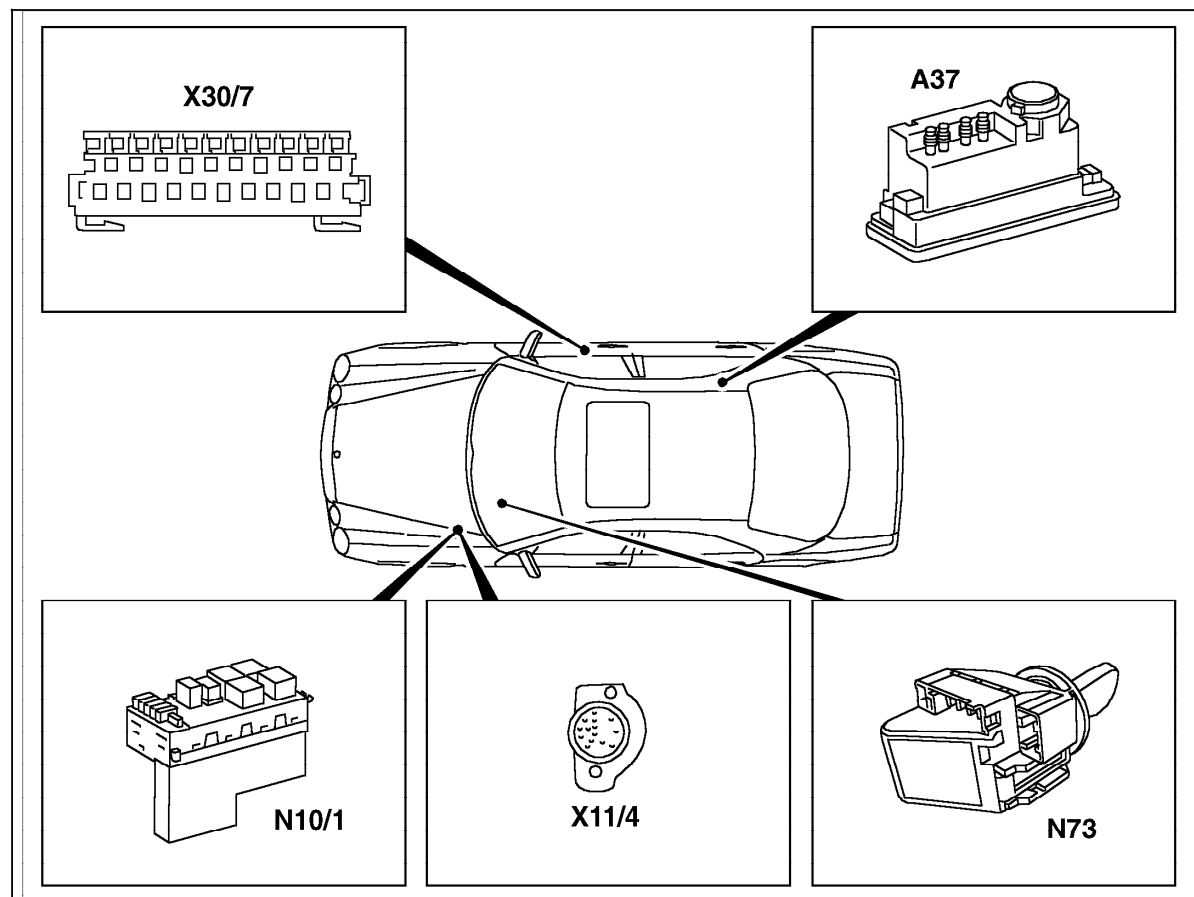

P54.21-0238-06

Figure 2

- A37 PSE control module
- N10/1 Signal pick-up and activation module (SAM) left front
- N73 Electronic ignition lock control module
- X11/4 Data link connector (DTC readout)
- X30/7 Star point coupler databus (CAN) tie-in connector

Electrical Test Program – Component Locations (NS)

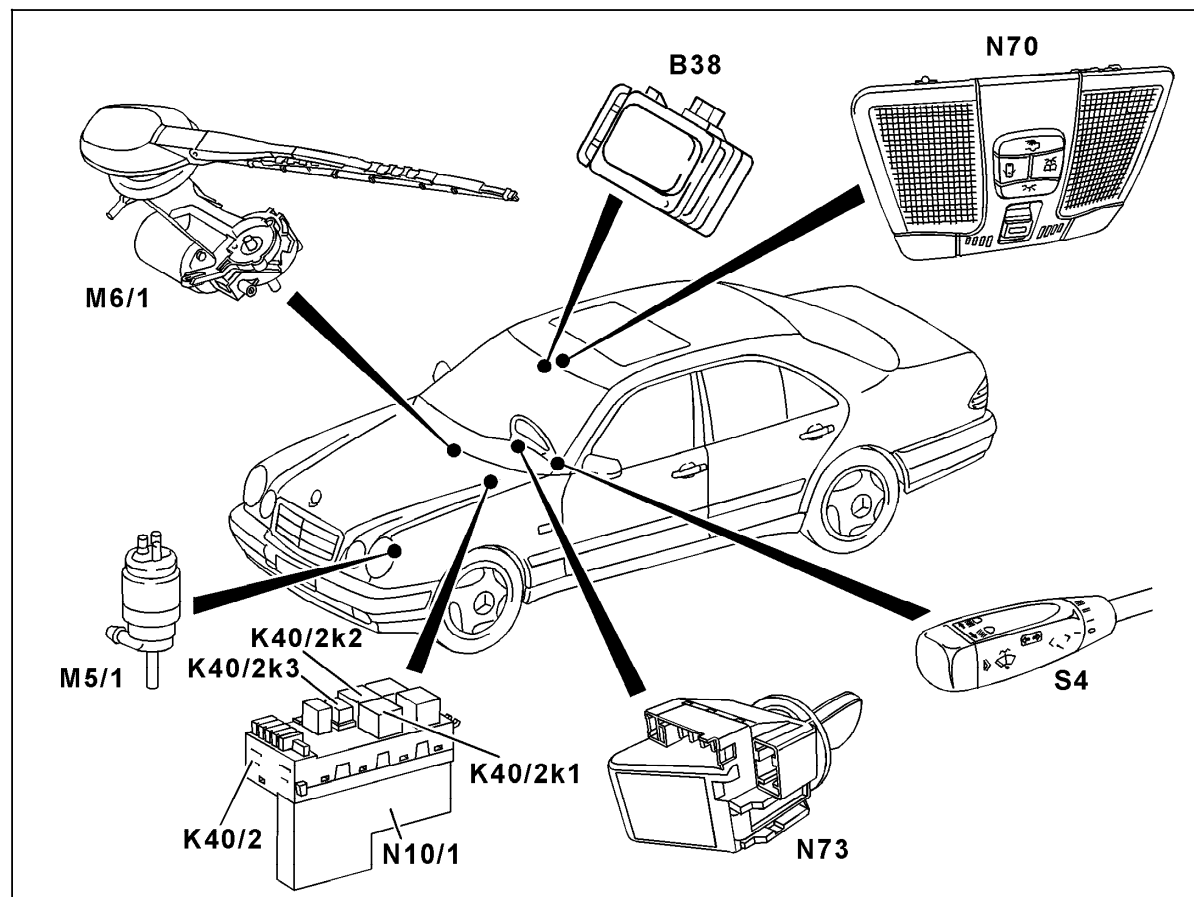
Front Windshield Wiper System
(Model 210 shown)

P82.30-0299-06

Figure 3

B38	Rain sensor
K40/2	Driver-side fuse and relay module box
K40/2k1	Wiper stage 1 relay
K40/2k2	Wiper stage 2 relay
K40/2k3	Windshield washer relay
M5/1	Windshield washer pump
M6/1	Wiper motor
N10/1	Signal pick-up and activation module (SAM) left front
N73	Electronic ignition lock control module
S4	Combination switch

Electrical Test Program – Component Locations (NS)

Rear Window Wiper/Washer System (Model 210 wagon shown)

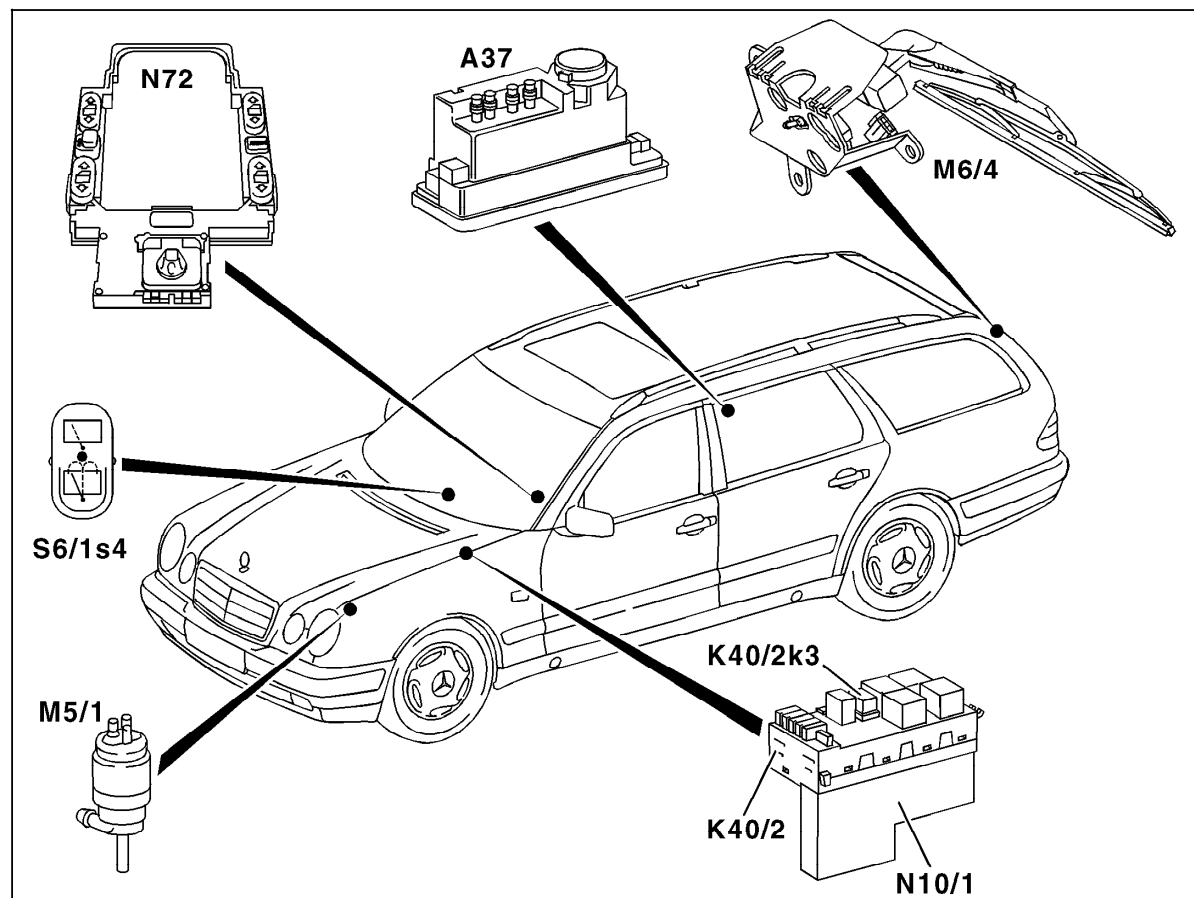

P82.30-0308-06

Figure 4

- A37 PSE control module
- K40/2 Driver-side fuse and relay module box
- K40/2k3 Windshield washer relay
- M5/1 Windshield washer pump
- M6/4 Rear window wiper motor
- N10/1 Signal pick-up and activation module (SAM) left front
- N72 Lower control field control module
- S6/1s4 Tailgate window wiper switch

Electrical Test Program – Component Locations (NS)

Headlamp Cleaning System (HCS)

Models 208, 210

(Model 210 shown)

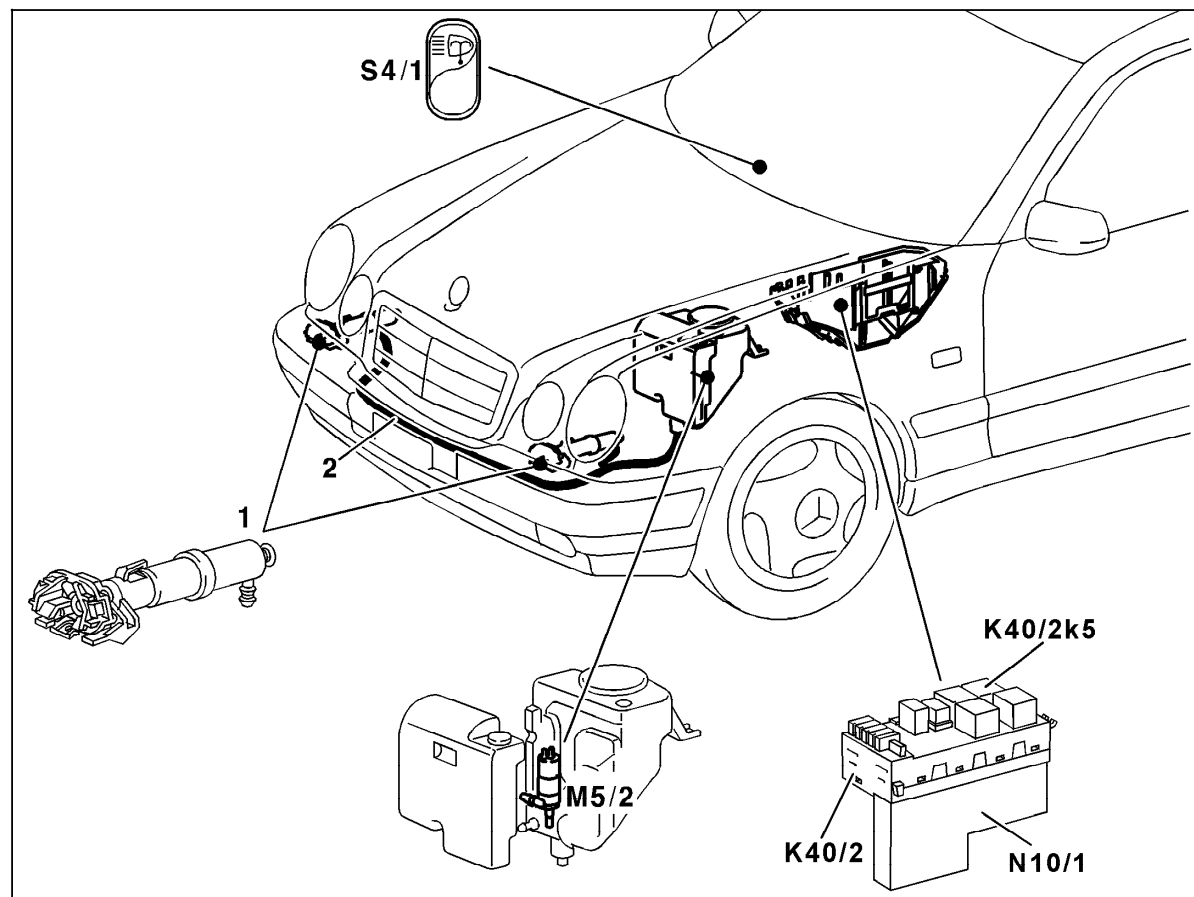

P82.15-0236-06

Figure 5

- K40/2 Driver-side fuse and relay module box
- K40/2k5 HCS pump relay
- M5/2 Headlamp washer pump
- N10/1 Signal pick-up and activation module (SAM) left front
- S4/1 HCS switch
- 1 Telescoping nozzle
- 2 Washer fluid hose

Electrical Test Program – Component Locations (NS)

Headlamp Cleaning System (HCS) Model 202

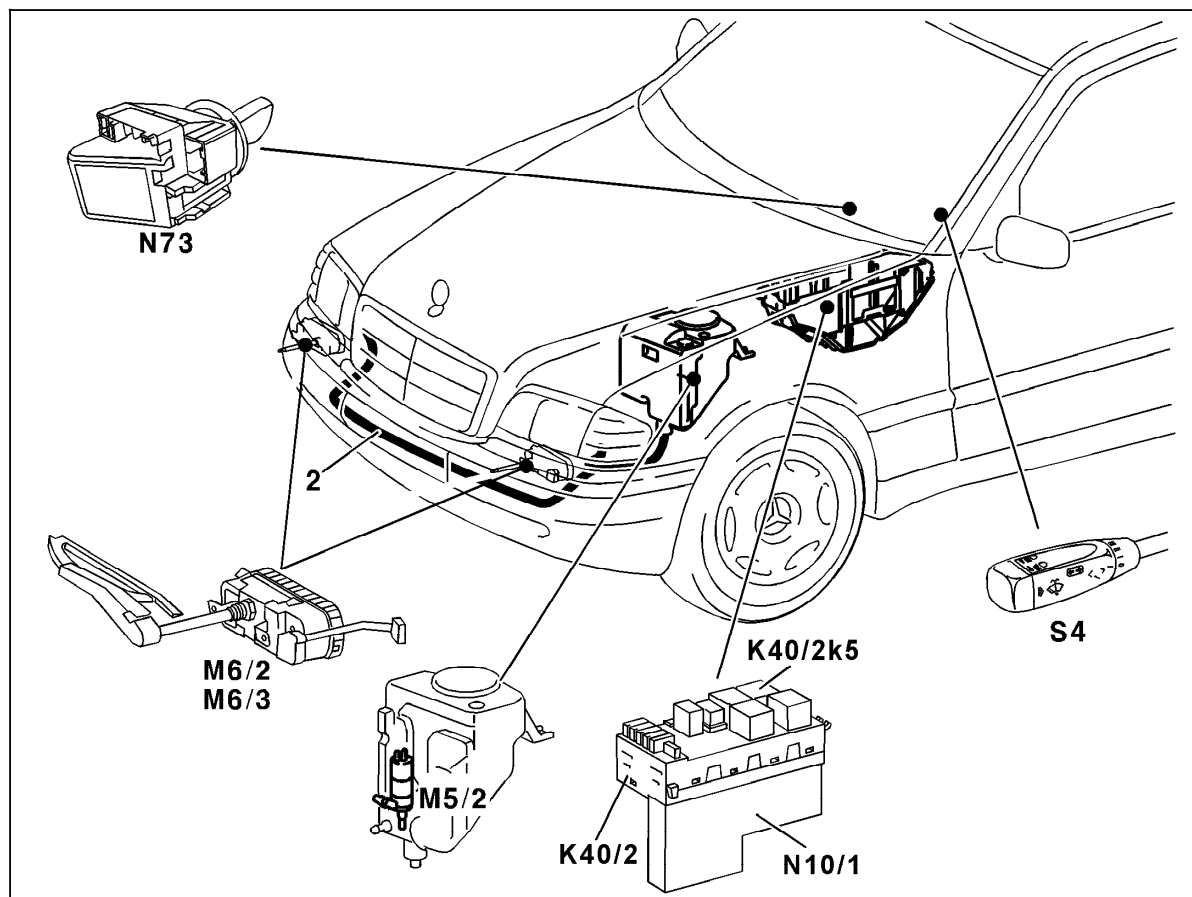

Figure 6

K40/2	Driver-side fuse and relay module box
K40/2k5	HCS pump relay
M5/2	Windshield washer pump
M6/2	Left headlamp wiper motor
M6/3	Right headlamp wiper motor
N10/1	Signal pick-up and activation module (SAM) left front
N73	Electronic ignition lock control module
S4	Combination switch

P82.15-0238-06

Electrical Test Program – Component Locations (NS)

Interior Lighting

Models 202, 210 Sedan, C208

(Model 210 sedan shown)

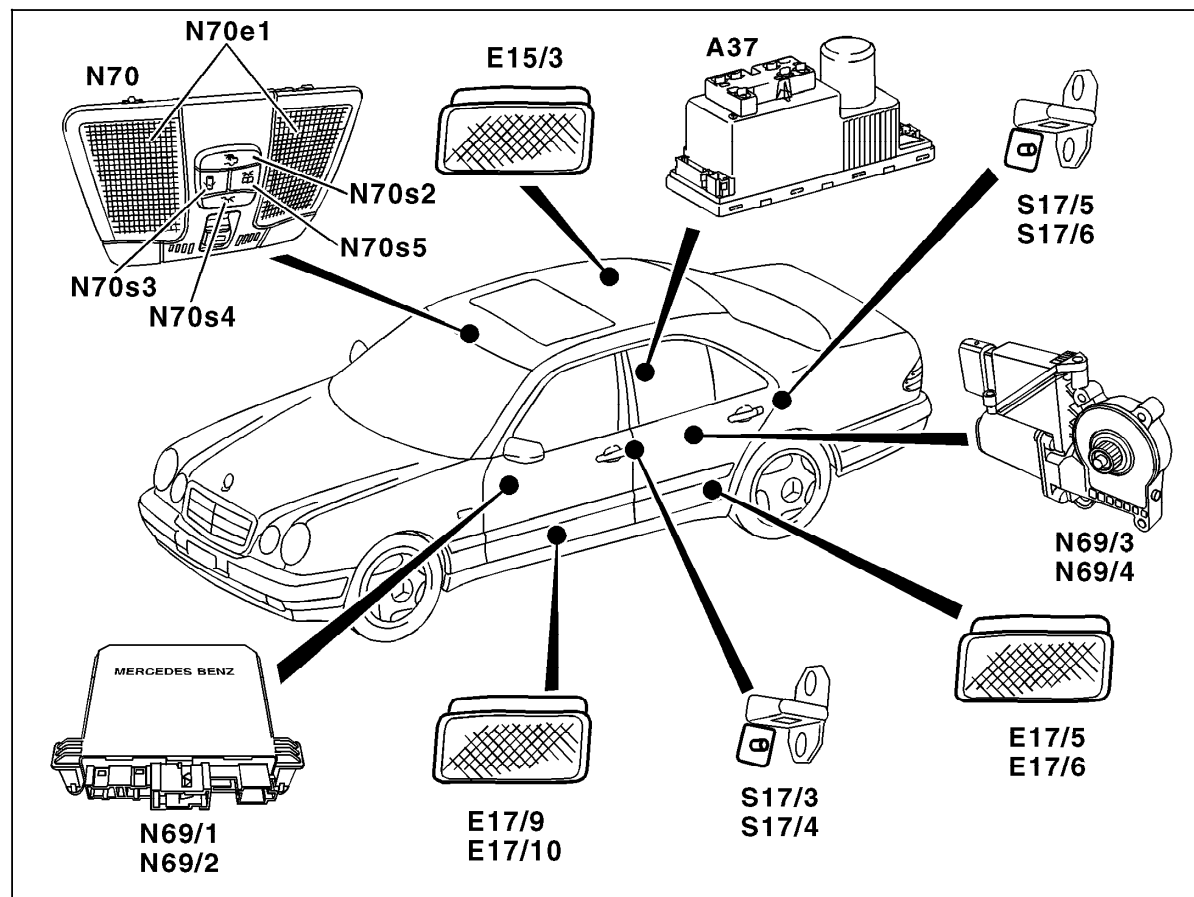

P82.20-0276-06

Figure 7

- A37 PSE control module
- E15/3 Rear dome lamp
- E17/5 Left rear door entrance/exit lamp
- E17/6 Right rear door entrance/exit lamp
- E17/9 Left front door entrance/exit lamp
- E17/10 Right front door entrance/exit lamp
- N69/1 Front driver-side door control module
- N69/2 Front passenger-side door control module
- N69/3 Rear driver-side door control module
- N69/4 Rear passenger-side door control module
- N70 Roof control panel control module
- N70e1 Dome lamp with delay/front reading lamp
- N70s2 Rear dome lamp switch on/off
- N70s3 Door switch on/off
- N70s4 Dome lamp switch on/off
- N70s5 Work lamp switch on/off
- S17/3 Left front door switch
- S17/4 Right front door switch
- S17/5 Left rear door switch
- S17/6 Right rear door switch

Electrical Test Program – Component Locations (NS)

Interior Lighting Model 208.4

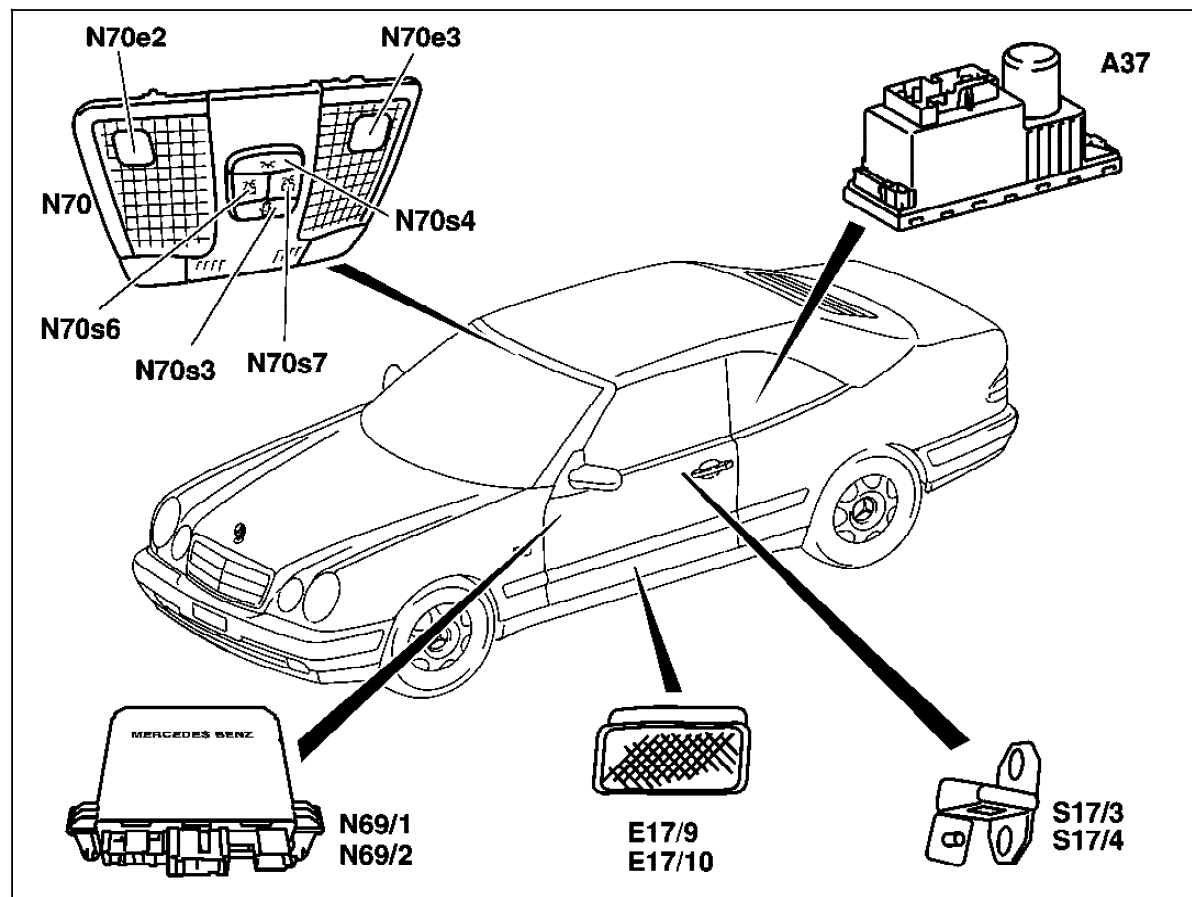

Figure 8

A37	PSE control module
E17/9	Left front door entrance/exit lamp
E17/10	Right front door entrance/exit lamp
N69/1	Front driver-side door control module
N69/2	Front passenger-side door control module
N70	Roof control panel control module
N70e2	Dome lamp with delay/front left reading lamp
N70e3	Dome lamp with delay/front right reading lamp
N70s3	Door switch on/of
N70s4	Dome lamp switch on/off
N70s6	Dome lamp switch left front
N70s7	Dome lamp switch right front
S17/3	Left front door switch
S17/4	Right front door switch

P82.20-2008-06

Electrical Test Program – Component Locations (NS)

Interior Lighting

Model 210 Wagon shown

Figure 9

A12	Tailgate closing assist
A12s1	Tailgate closing assist switch/interior illumination switch
A37	PSE control module
E15/3	Rear dome lamp
E17/5	Left rear door entrance/exit lamp
E17/6	Right rear door entrance/exit lamp
E17/9	Left front door entrance/exit lamp
E17/10	Right front door entrance/exit lamp
E25/3	Left D-pillar interior lamp
E25/4	Right D-pillar interior lamp
N69/1	Front driver-side door control module
N69/2	Front passenger-side door control module
N69/3	Rear driver-side door control module
N69/4	Rear passenger-side door control module
N70	Roof control panel control module
N70e1	Dome lamp with delay/front reading lamp
N70s2	Rear dome lamp switch on/off
N70s3	Door switch on/off
N70s4	Dome lamp switch on/off
N70s5	Work lamp switch on/off
S17/3	Left front door switch
S17/4	Right front door switch
S17/5	Left rear door switch
S17/6	Right rear door switch

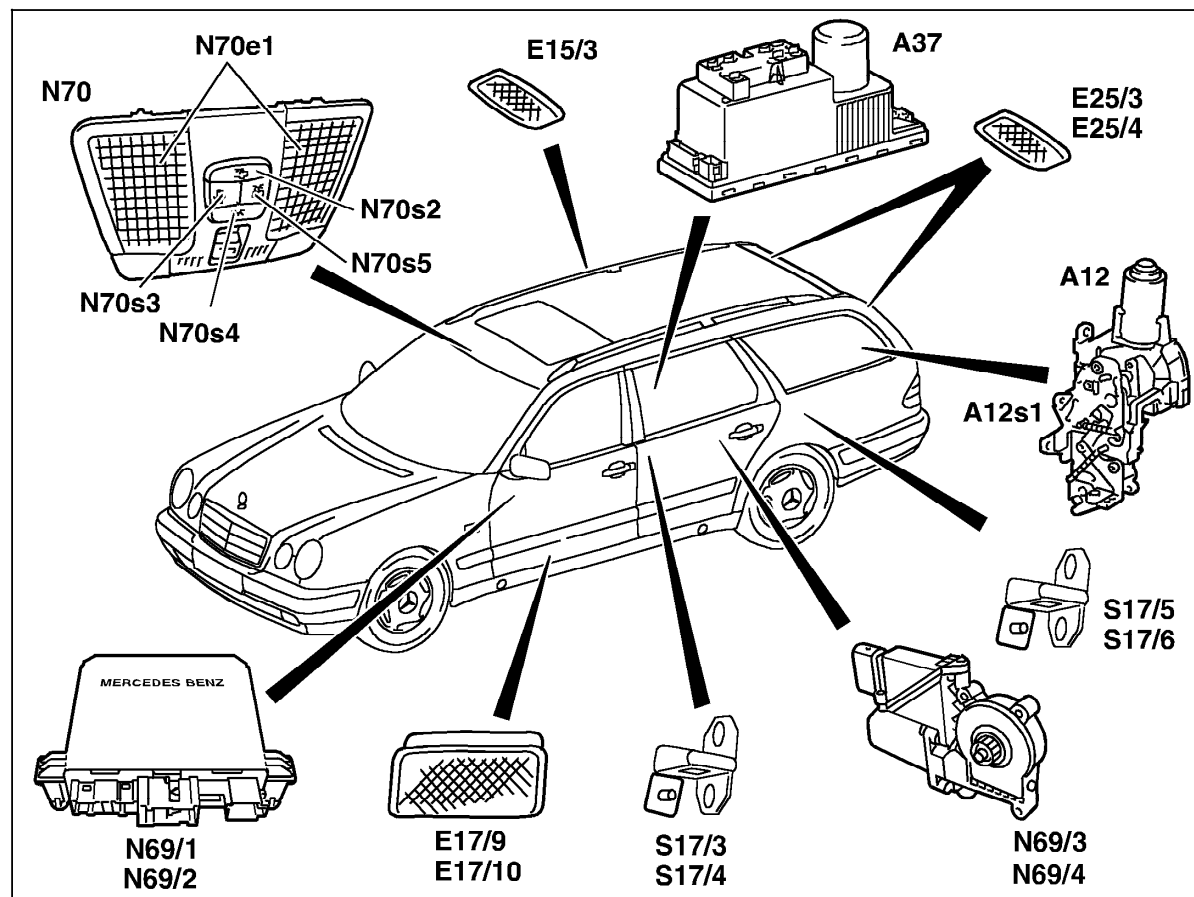

P82.20-0316-06

Electrical Test Program – Component Locations (NS)

Heated rear window

Model 210 Sedan shown

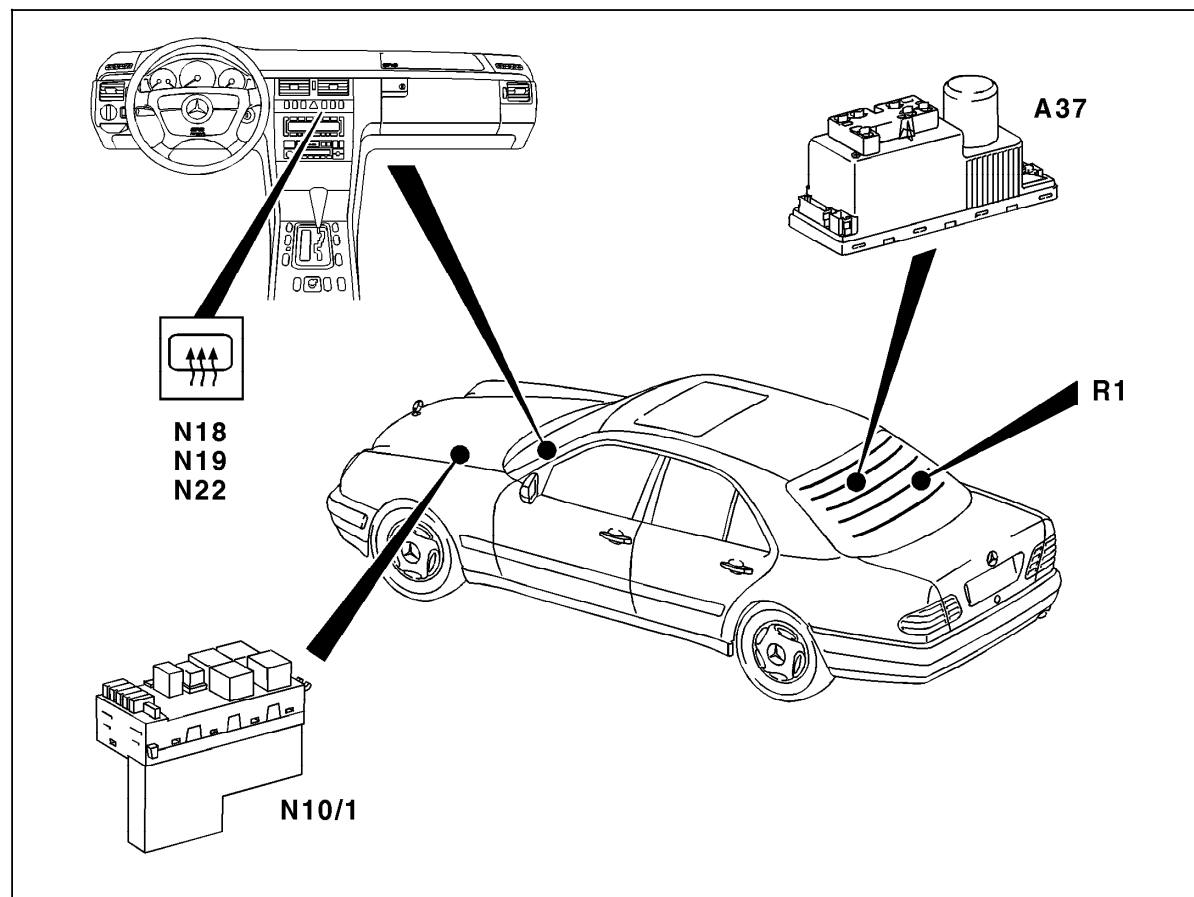

Figure 9

- A37 PSE control module
- N10/1 Signal pick-up and activation module
- N22 A/C pushbutton control module (Automatic A/C)
- R1 Heated rear window

P67.29-0210-06

Electrical Test Program – Component Locations (NS)

Heated rear window

Model 208.4 shown

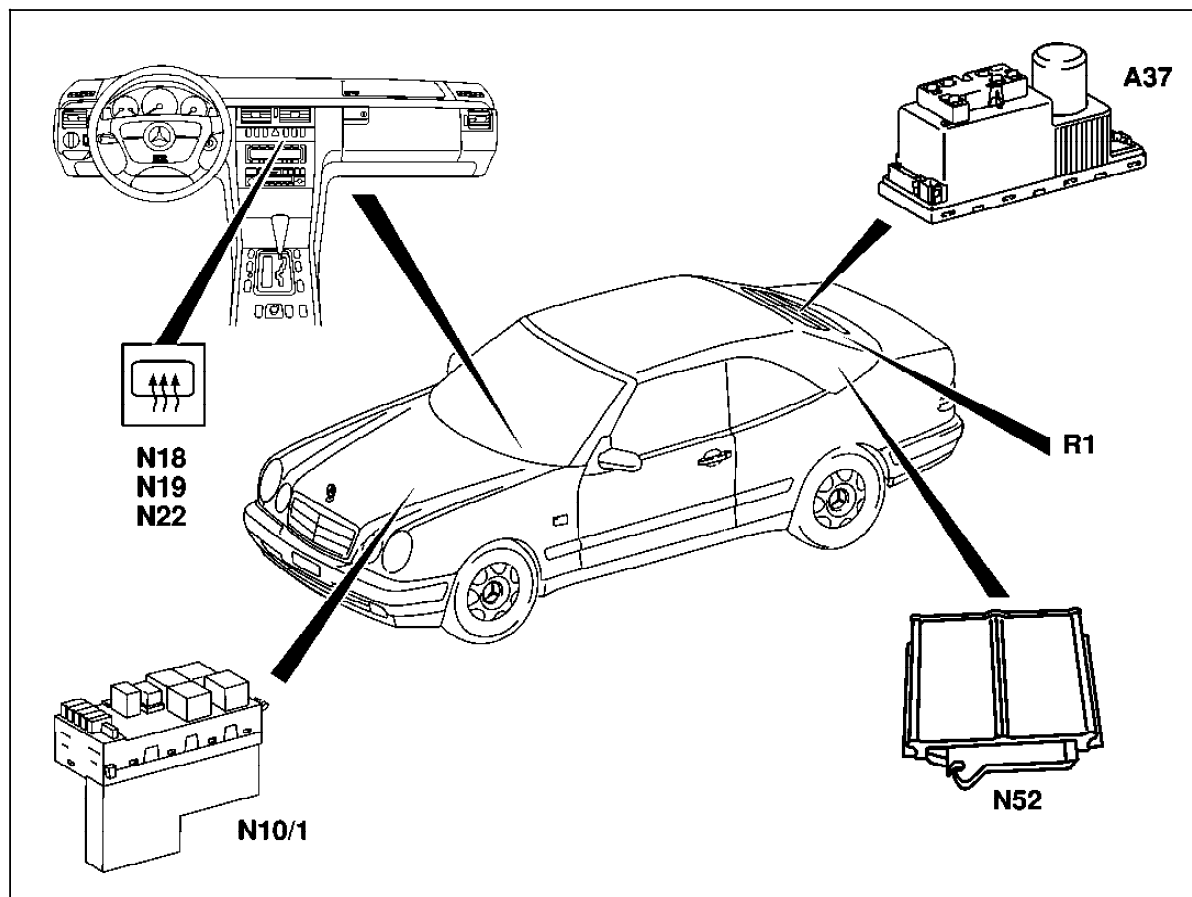

Figure 10

- A37 PSE control module
- N10/1 Signal pick-up and activation module
- N18 Heat pushbutton control module
- N19 Air conditioning pushbutton control module
- N22 A/C pushbutton control module (Automatic A/C)
- N52 Roll bar/power soft top control module
- R1 Heated rear window

P67.29-2003-06