

Electrical Test Program – Connection of Components

Connection of RCL control module/DAS shut-off valve control module via CAN
 Models 202/140

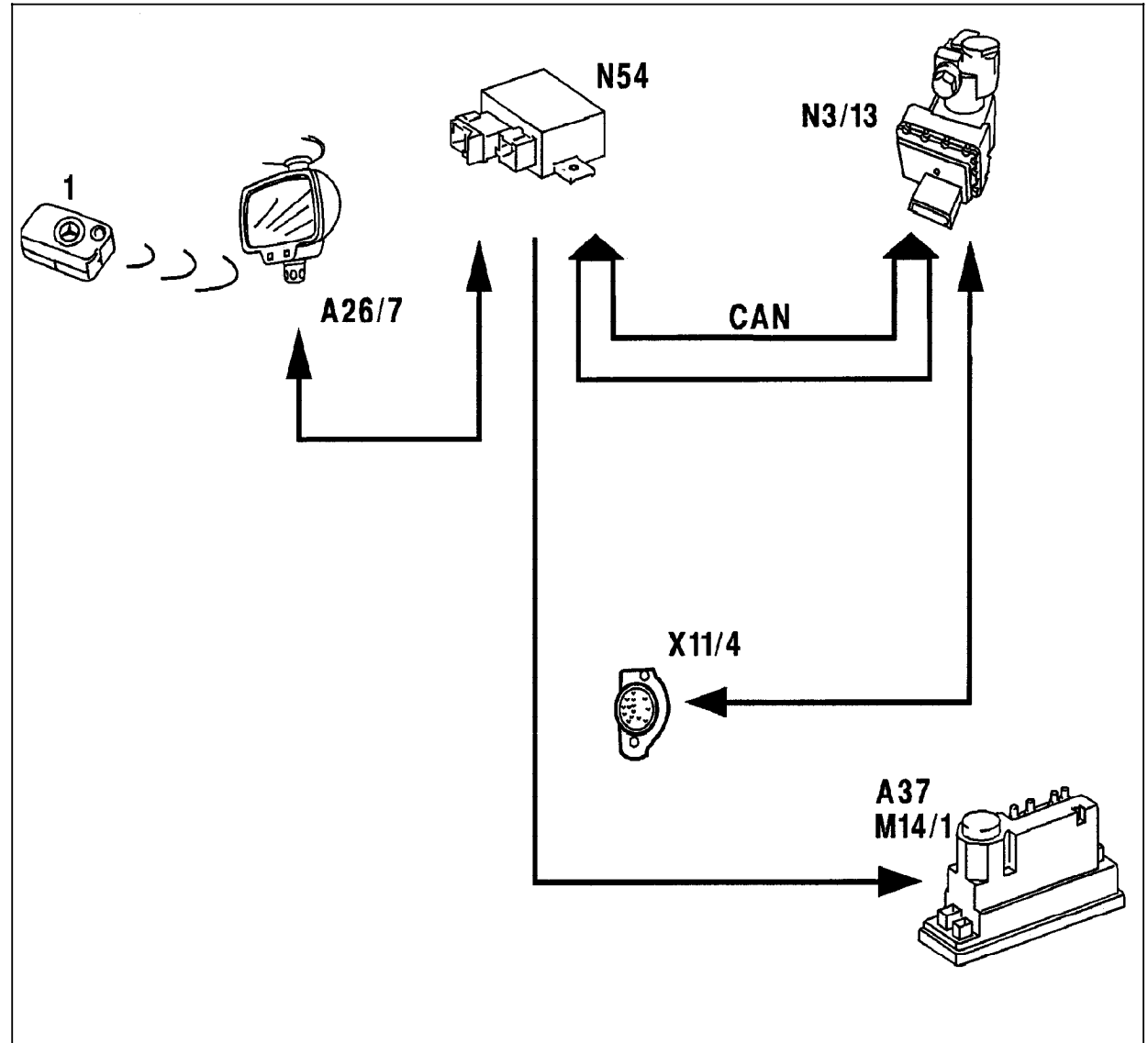

Figure 1

- A26/7 RCL receiver (interior rearview mirror)
- A37 PSE control module, combined functions
- CAN Control-Area-Network
- N3/13 DAS shut-off valve control module
- N54 RCL control module
- X11/4 Data link connector (DTC readout)
- 1 IR transmitter key

U80.30-0245-06

Electrical Test Program – Connection of Components

Connection of RCL control module/Engine control module via CAN
Models 129/140/202

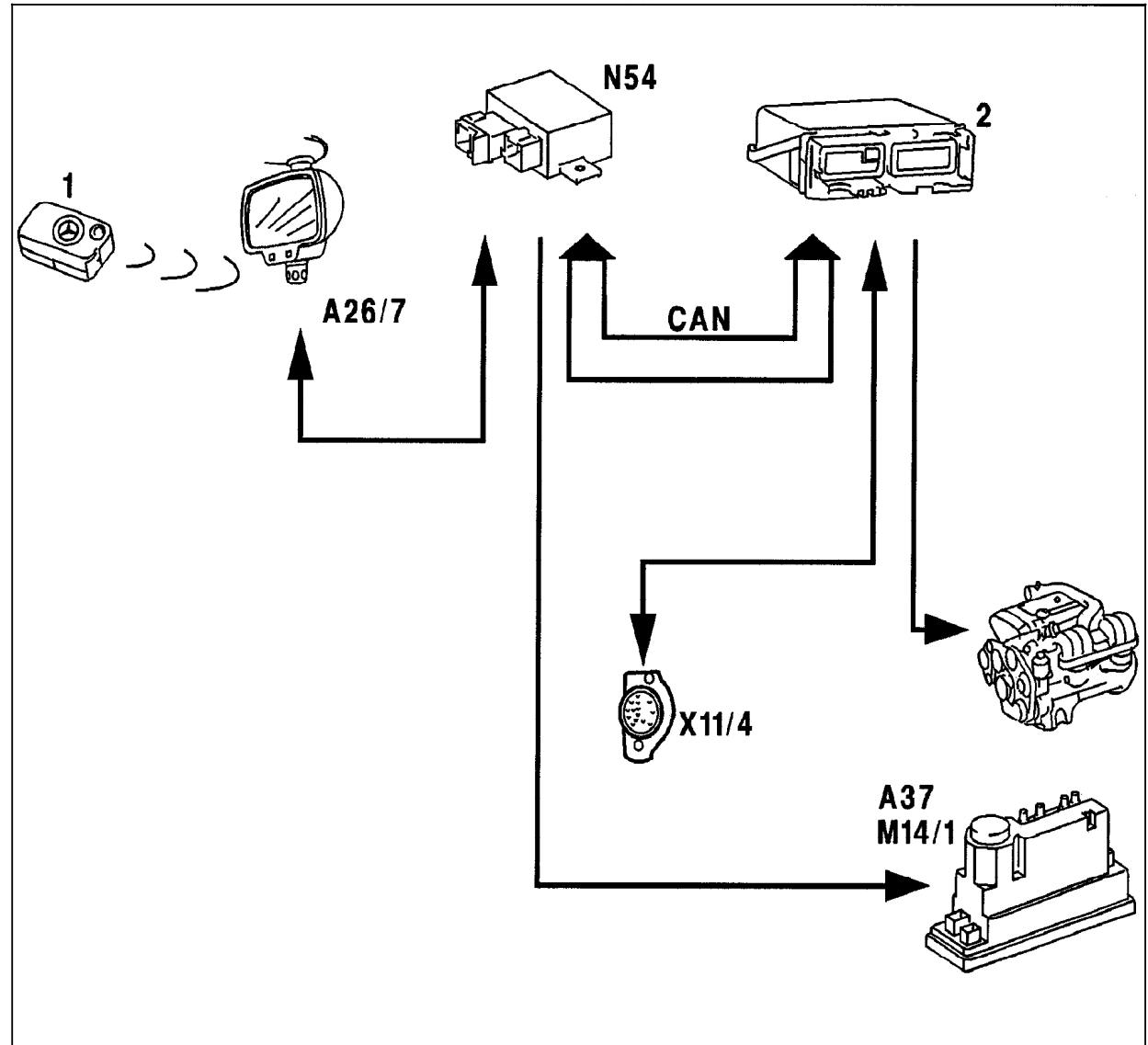

Figure 2

- A26/7 RCL receiver (interior rearview mirror)
- A37 PSE control module, combined functions
- CAN Control-Area-Network
- N54 RCL control module
- M14/1 Supply pump (CL) or Model 129: (CL/vacuum)
- X11/4 Data link connector (DTC readout)
- 1 IR transmitter key
- 2 Engine control module

U80.30-0243-06

Electrical Test Program – Connection of Components

Connection of RCL control module/Engine control module via CAN
Model 210

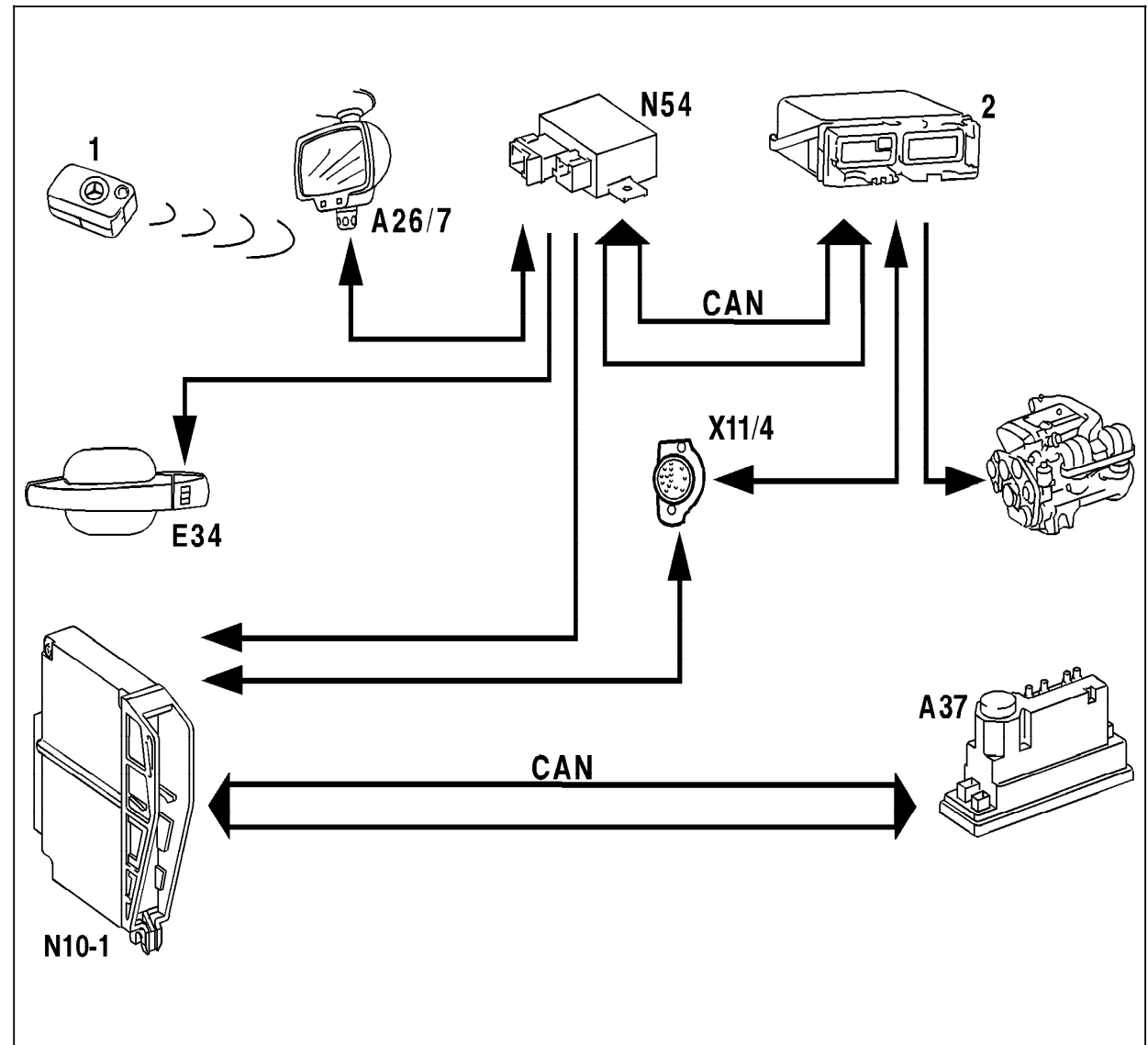

Figure 3

- A26/7 RCL receiver (interior rearview mirror)
- A37 PSE control module, combined functions
- CAN Control-Area-Network
- N10-1 Combination control module
- N54 RCL control module
- X11/4 Data link connector (DTC readout)
- 1 IR transmitter key
- 2 Engine control module

U80.30-0240-06