

Electrical Test Program – Connection of Components

Model 129

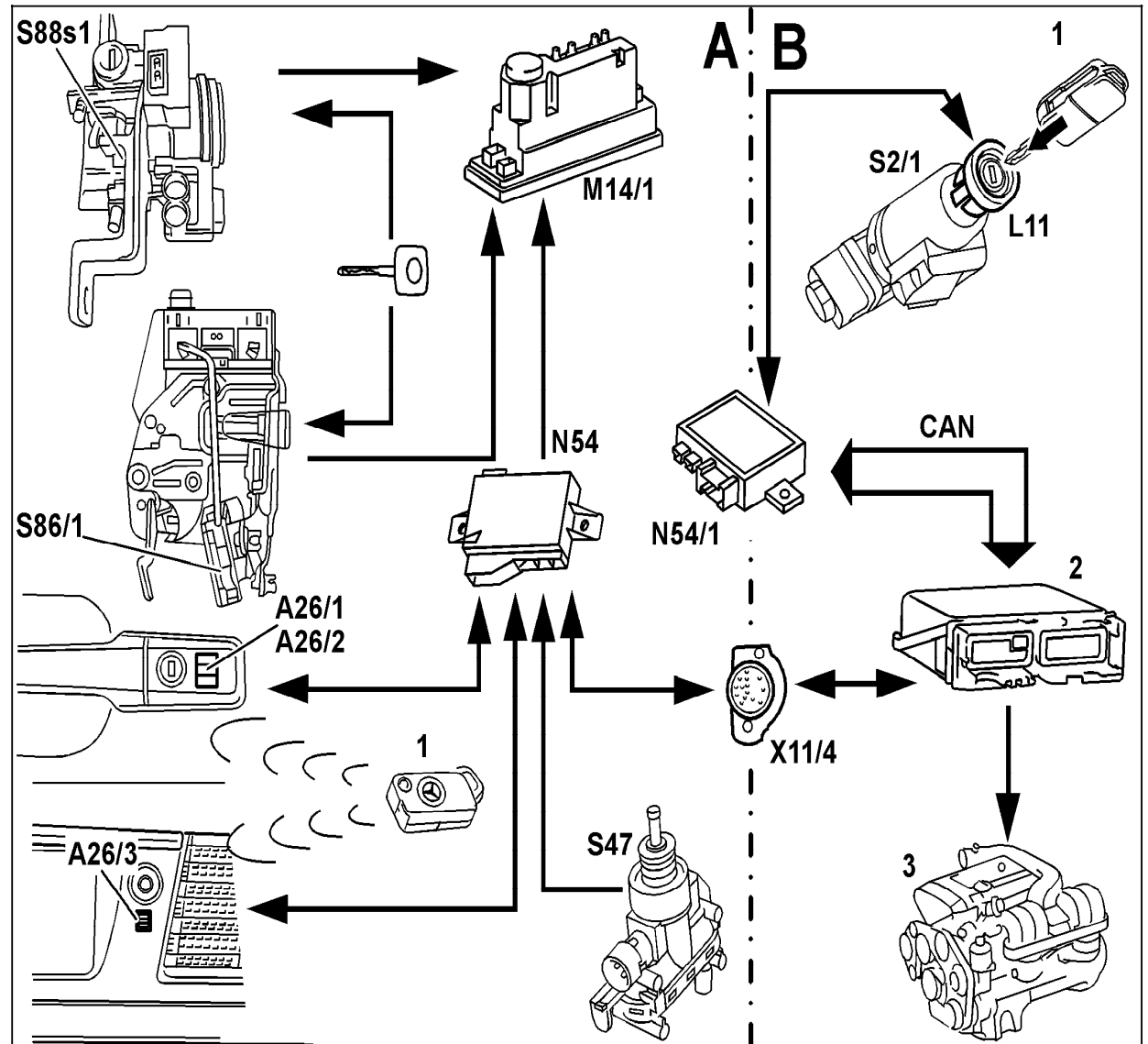

Figure 1

- A Infrared remote central locking (RCL)
- B Drive authorization system stage X (activation of motor electronics via transponder)
- A26/1 Left front door IR receiver (RCL)
- A26/2 Right front door IR receiver (RCL)
- A26/3 Trunk lid IR receiver (RCL)
- CAN Control-Area-Network
- L11 Coil for transponder
- M14/1 Supply pump (CL)
- N54 RCL control module
- N54/1 IR DAS control module
- S2/1 Ignition/starter switch
- S47 Left front door actuator
- S86/1 Left front door lock switch (CF)
- S88s1 ATA/CF microswitch
- X11/4 Data link connector (DTC readout)
- 1 IR transmitter key with transponder
- 2 Engine control module
- 3 Engine

P80.30-0364-06

Electrical Test Program – Connection of Components

Model 140

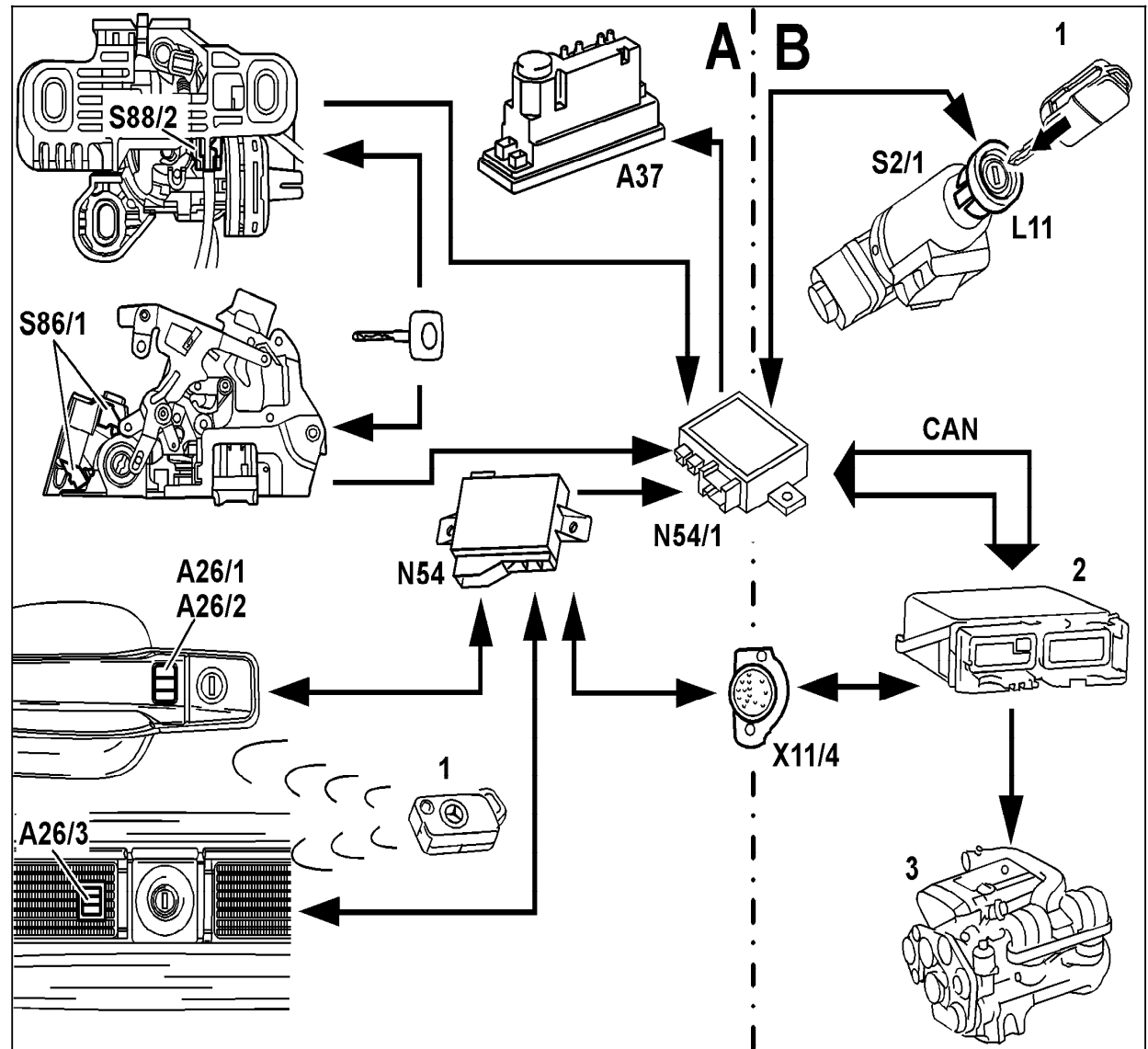

Figure 2

- A Infrared remote central locking (RCL)
- B Drive authorization system stage X (activation of motor electronics via transponder)
- A26/1 Left front door IR receiver (RCL)
- A26/2 Right front door IR receiver (RCL)
- A26/3 Trunk lid IR receiver (RCL)
- A37 PSE control module
- CAN Control-Area-Network
- L11 Coil for transponder
- N54 RCL control module
- N54/1 IR DAS control module
- S2/1 Ignition/starter switch
- S86/1 Left front door lock switch (CF)
- S88s1 ATA/CF microswitch
- X11/4 Data link connector (DTC readout)
- 1 IR transmitter key with transponder
- 2 Engine control module
- 3 Engine

P80.30-0337-06

Electrical Test Program – Connection of Components

Model 202

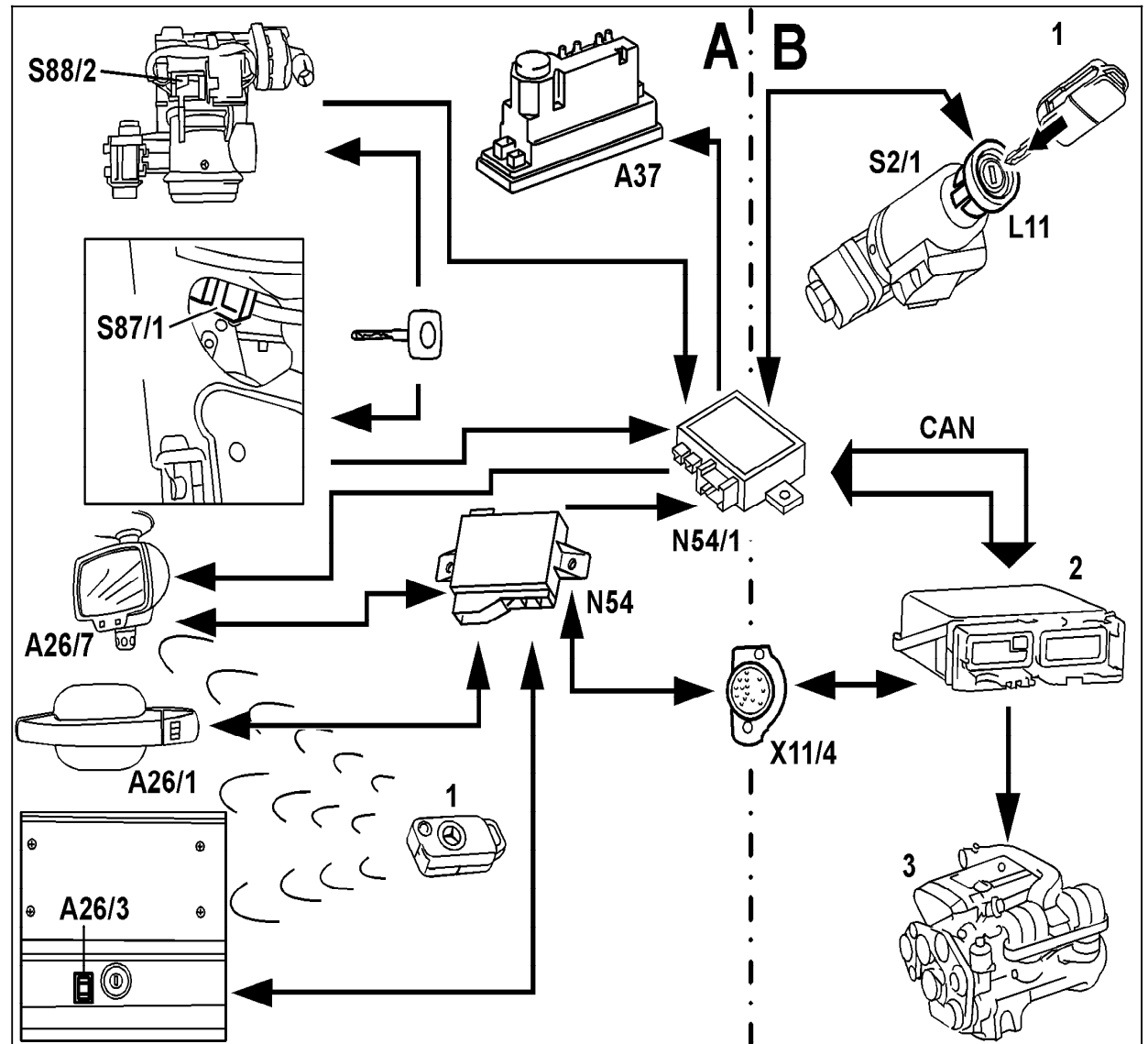

Figure 3

- A Infrared remote central locking (RCL)
- B Drive authorization system stage X (activation of motor electronics via transponder)
- A26/1 Left front door IR receiver (RCL)
- A26/3 Trunk lid IR receiver (RCL)
- A26/7 RCL receiver (interior rearview mirror)
- A37 PSE control module
- CAN Control-Area-Network
- L11 Coil for transponder
- N54 RCL control module
- N54/1 IR DAS control module
- S2/1 Ignition/starter switch
- S87/1 Right front door lock switch (CF)
- S88/2 Trunk lid lock switch (CF)
- X11/4 Data link connector (DTC readout)
- 1 IR transmitter key with transponder
- 2 Engine control module
- 3 Engine

P80.30-0335-06

Electrical Test Program – Connection of Components

Model 210

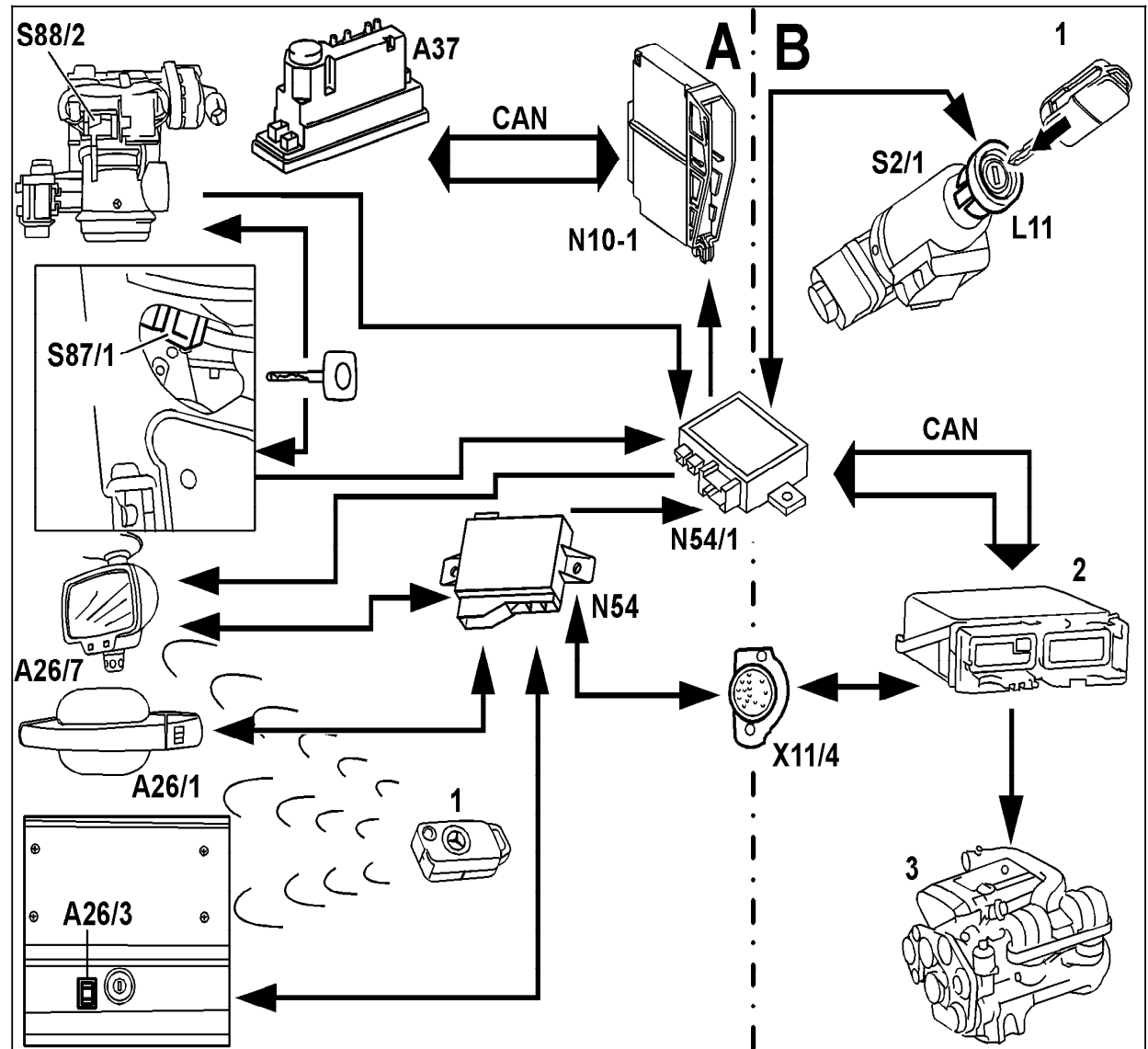

Figure 4

- A Infrared remote central locking (RCL)
- B Drive authorization system stage X (activation of motor electronics via transponder)
- A26/1 Left front door IR receiver (RCL)
- A26/3 Trunk lid IR receiver (RCL)
- A26/7 RCL receiver (interior rearview mirror)
- A37 PSE control module
- CAN Control-Area-Network
- L11 Coil for transponder
- N10-1 Combination control module (CF, windshield wiper, rear window defroster)
- N54 RCL control module
- N54/1 IR DAS control module
- S2/1 Ignition/starter switch
- S87/1 Right front door lock switch (CF)
- S88/2 Trunk lid lock switch (CF)
- X11/4 Data link connector (DTC readout)
- 1 IR transmitter key with transponder
- 2 Engine control module
- 3 Engine

P80.30-0336-06