

Electrical Test Program - Component Locations

Limit switches

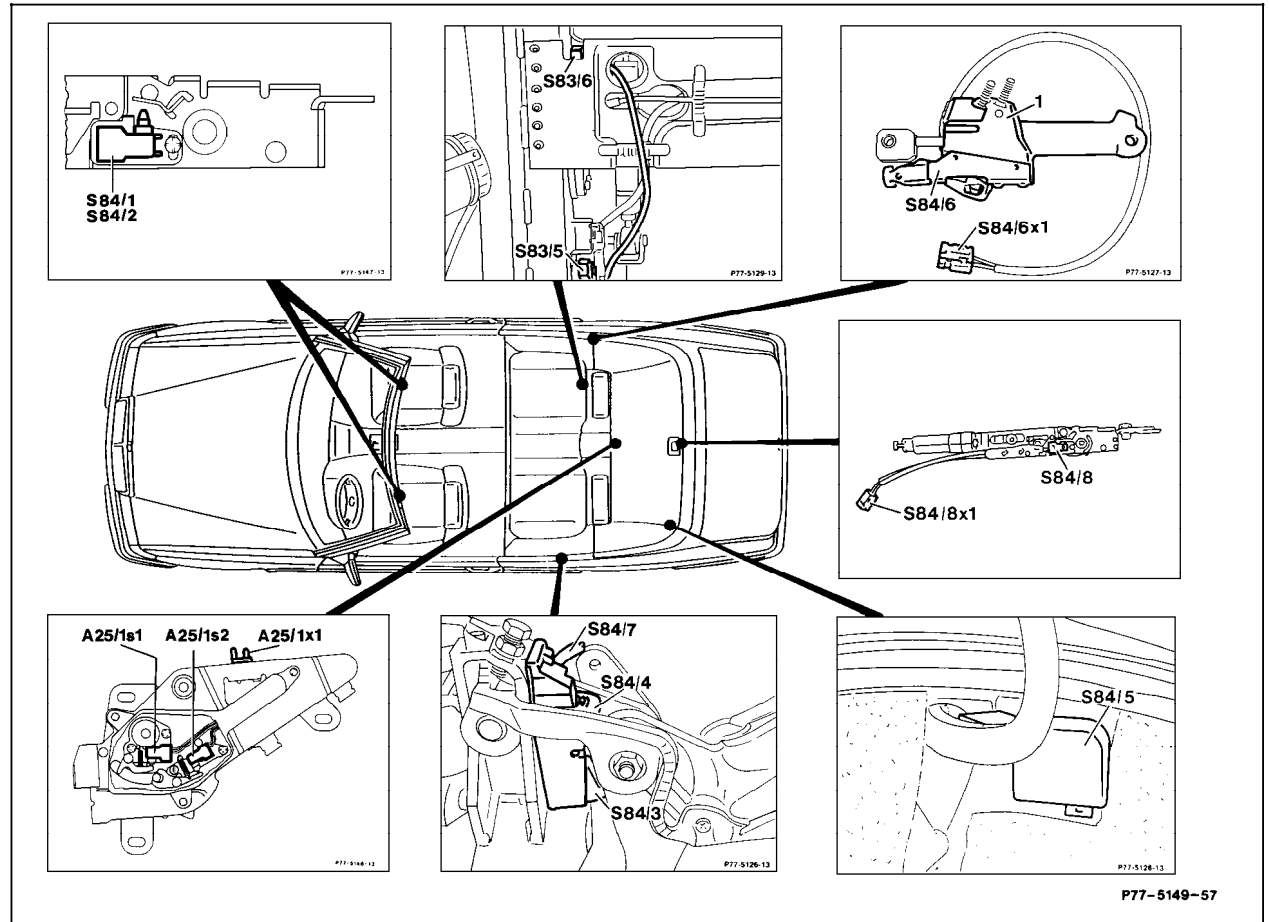

Figure 1

- A25/1s1 Soft top compartment cover "closed" switch
- A25/1s2 Soft top compartment cover "locked" switch
- S83/5 RB "retracted" switch
- S83/6 RB "extended" switch
- S84/1 Left front soft top "locked" switch
- S84/2 Right front soft top "locked" switch
- S84/3 Soft top "open" switch (soft top in storage compartment)
- S84/4 Soft top "overhead" switch
- S84/5 Soft top compartment "open" switch
- S84/6 Soft top fabric bow "raised" switch
- S84/7 Soft top fabric bow "down" switch
- S84/8 Soft top fabric bow "locked" switch

P77-5149-57

P77-5149-57

Electrical Test Program - Component Locations

Switches and control modules

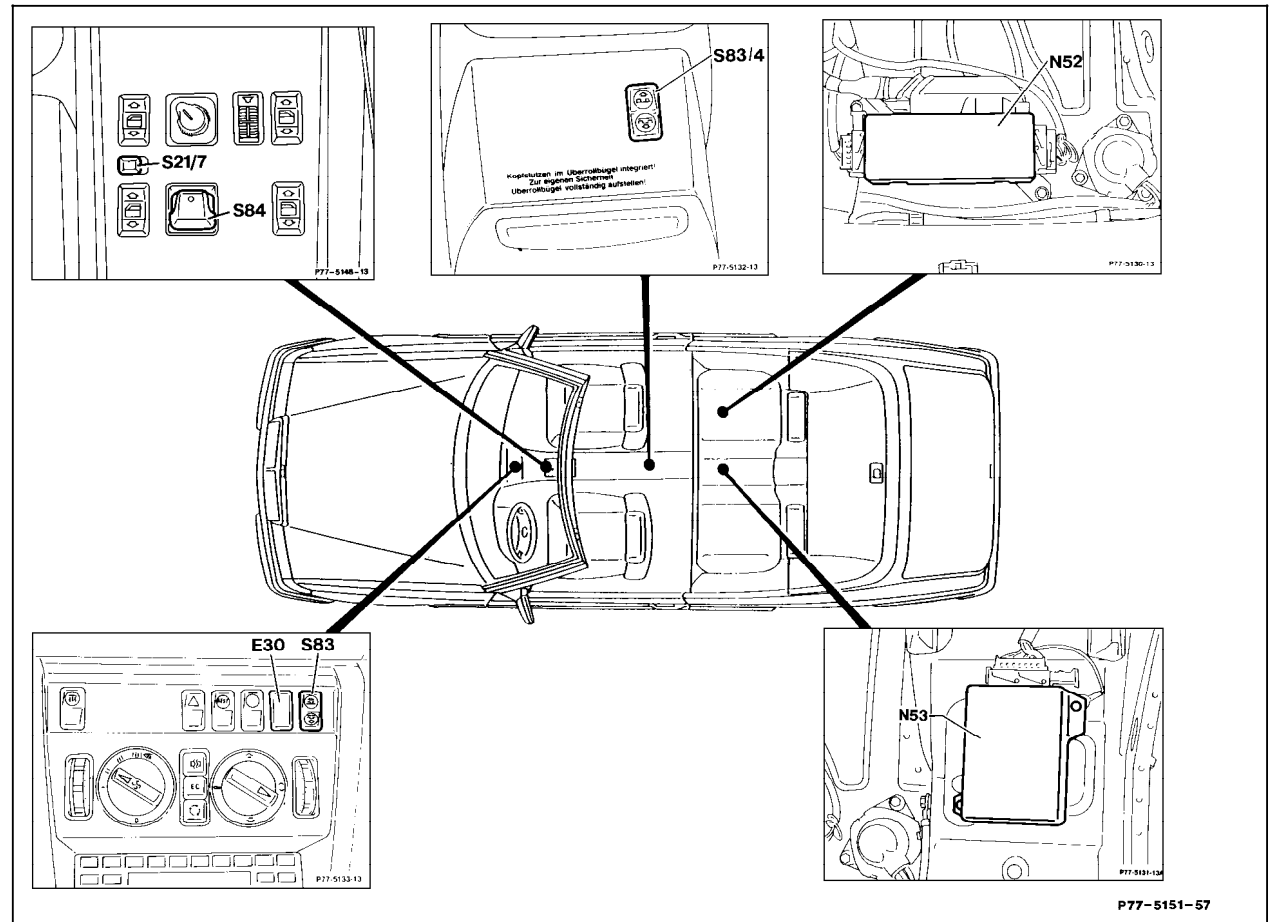

Figure 2

- E30 Center console roll bar malfunction indicator lamp
- N52 Power soft top control module
- N53 RB control module (crash deployment)
- S21/7 Rear power window safety switch
- S83 RB switch (manual operation)
- S83/4 RB switch (rear center console)
- S84 Power soft top switch

P77-5151-57

P77-5151-57

Electrical Test Program - Component Locations

Electrical components

Figure 3

- A7/5 CST/RB hydraulic unit
- A7/5k1 Relay
- A7/5m1 Motor
- A7/5x Soft top/roll bar hydraulic unit connector
- A7/5y1 Main valve
- E15 Dome lamp (with shut-off delay and reading lamp)
- E15h1 Warning buzzer
- F24 Auxiliary fuse holder (CST/RB)
- F24/1 Auxiliary fuse holder (hydraulic unit)
- Y55 Right CST valve block (4 connections)
- Y55y6 Soft top "open" valve
- Y55y7 Soft top "close" valve
- Y55y8 Fabric bow "raise" valve
- Y55y9 Fabric bow "lower" valve
- Y56 Left CST valve block (3 connections)
- Y56y3 Soft top compartment lock valve
- Y56y4 Fabric bow lock valve
- Y56y5 Soft top compartment cover drive valve
- Y57 RB valve block
- Y57y10 Rod side valve
- Y57y11 Piston side valve

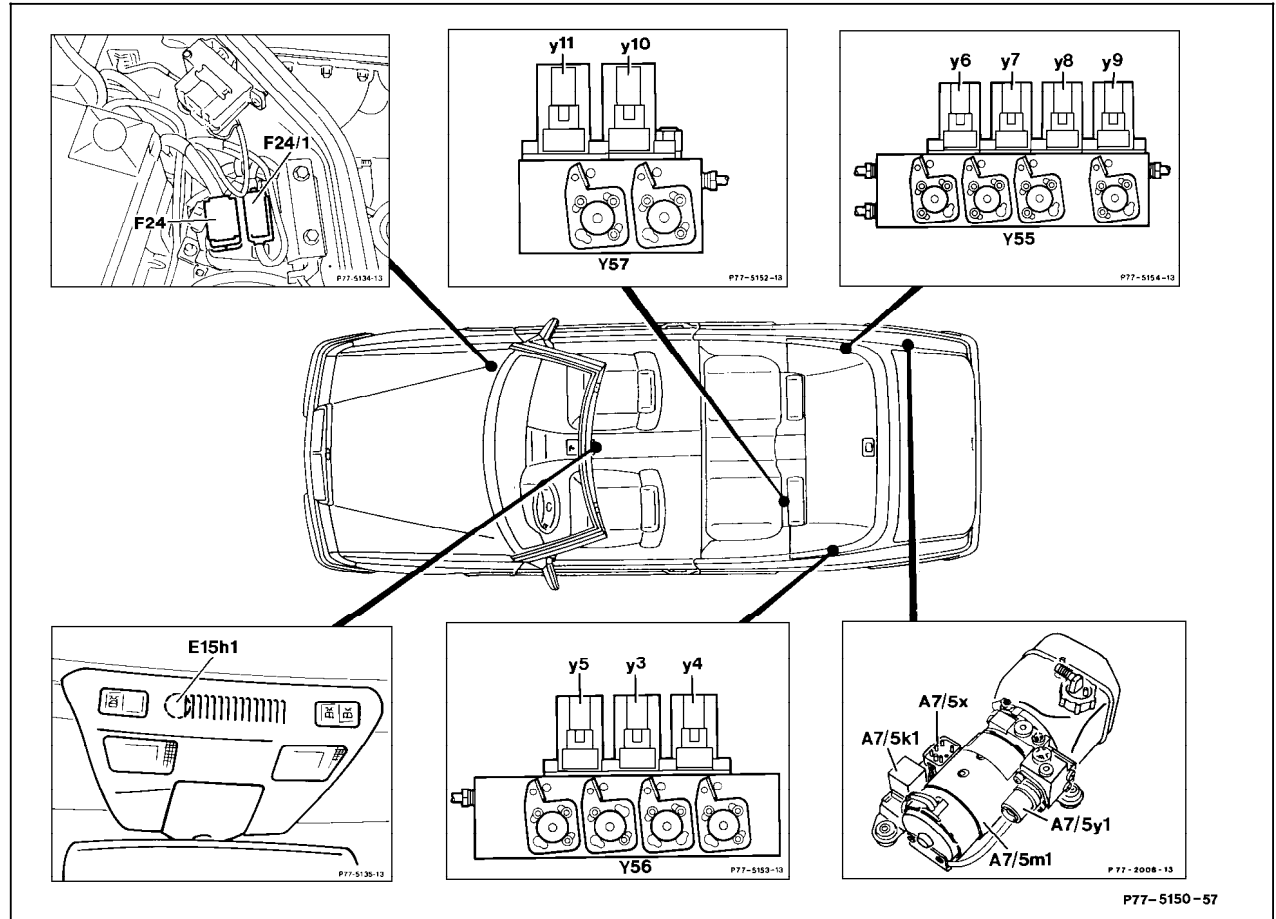

P77-5150-57

P77-5150-57