

11.1 Cabriolet Soft Top (CST), Roll Bar (RB) (Manual Operation)

Model 124

Hydraulic Test Program - Component Locations

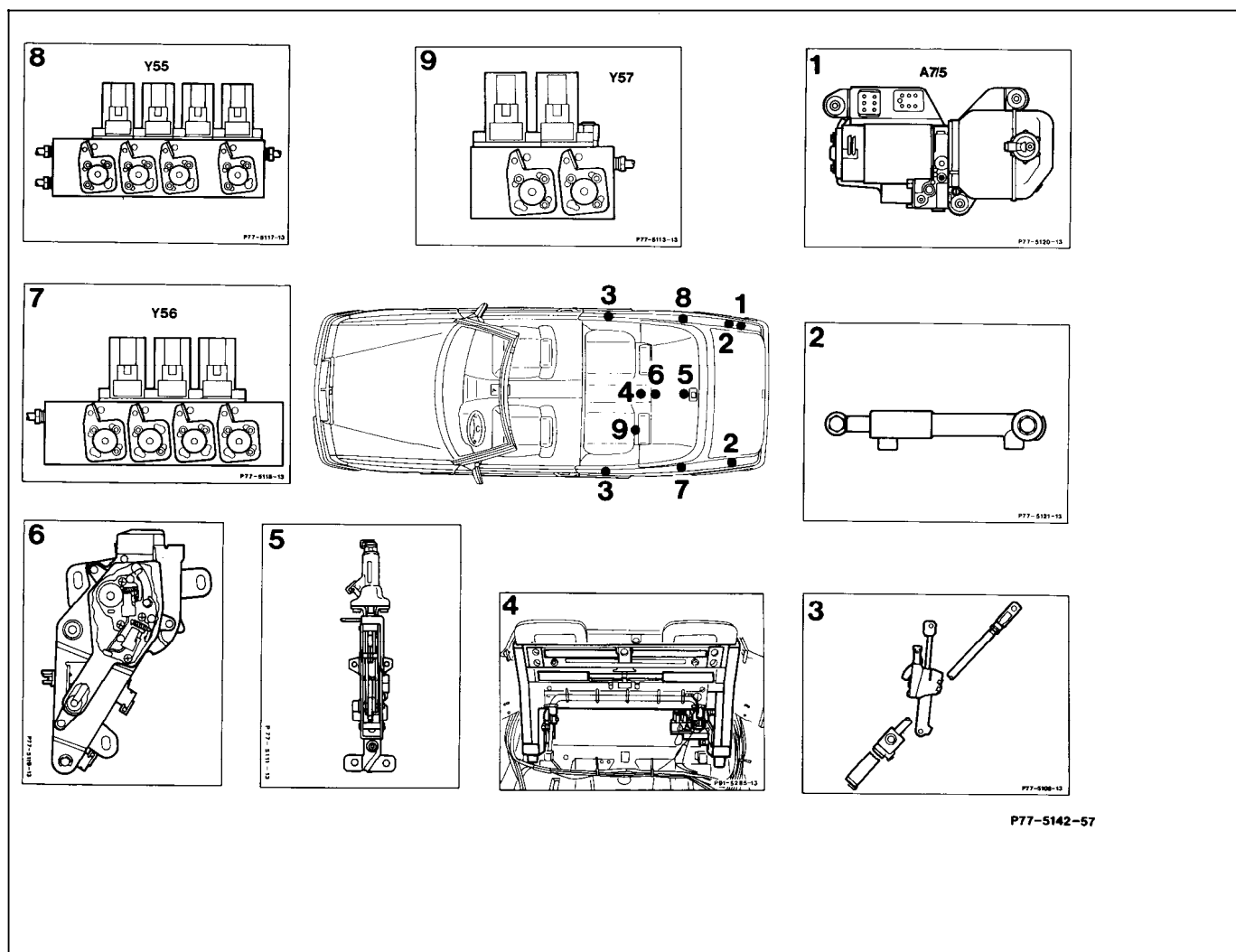

Figure 1

- A7/5 CST/RB hydraulic unit (1)
- Y55 Right CST valve block (4 connections) (8)
- Y56 Left CST valve block (3 connections) (7)
- Y57 RB valve block (9)
- 2 Soft top compartment cover hydraulic cylinder
- 3 Soft top and fabric bow hydraulic cylinder
- 4 Roll bar assembly
- 5 Fabric bow lock
- 6 Soft top compartment cover lock

P77-5142-57