

Electrical Test Program – Component Locations

Limit switches

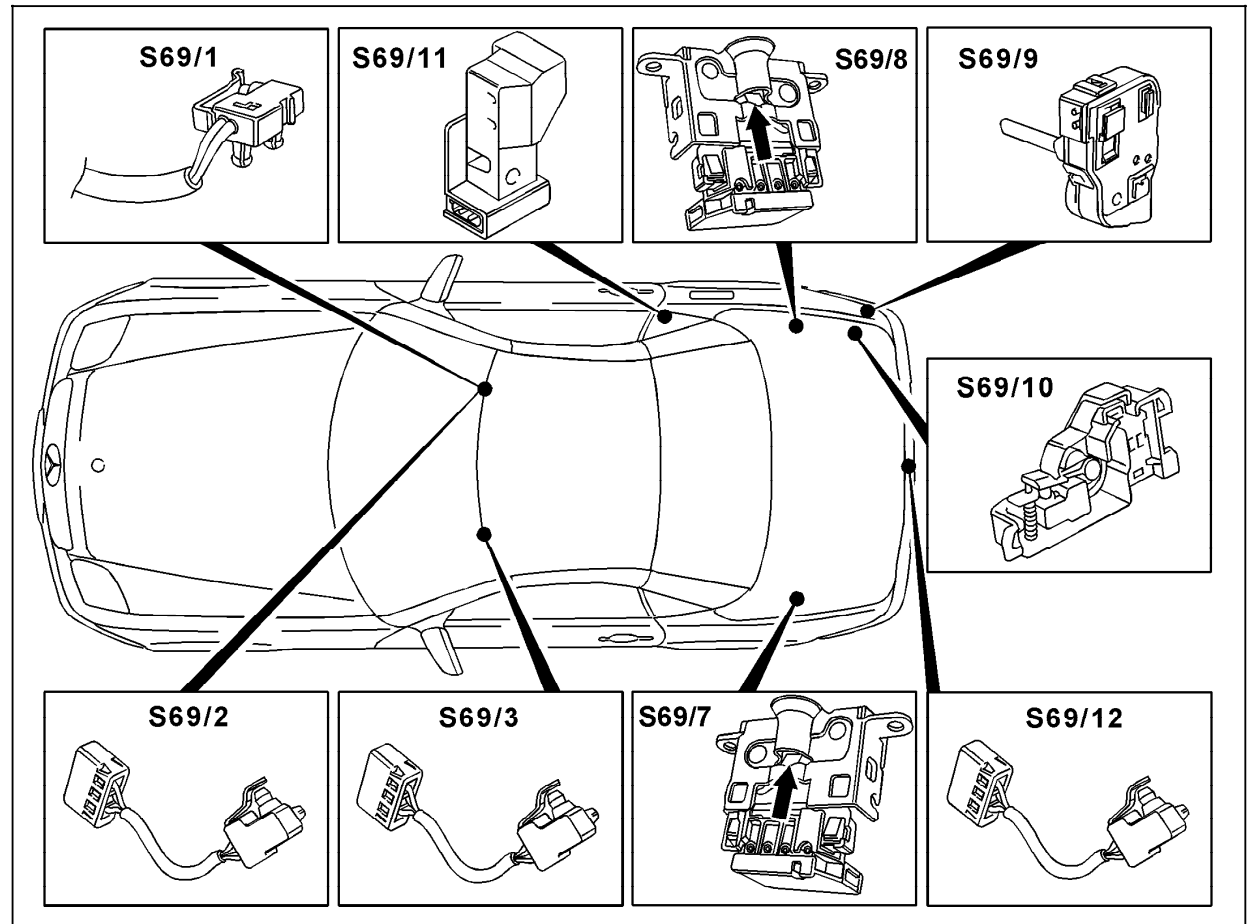

Figure 1

- S69/1 Retractable hardtop closed limit switch (right pin)
- S69/2 Retractable hardtop locked limit switch (right rotary latch)
- S69/3 Retractable hardtop locked limit switch (left rotary latch)
- S69/7 Trunk lid closed/locked left limit switch
- S69/8 Trunk lid closed/locked right limit switch
- S69/9 Trunk lid open limit switch
- S69/10 Retractable luggage cover engaged limit switch
- S69/11 Retractable hardtop open/stored limit switch
- S69/12 Trunk lock/trunk illumination rotary latch selector switch

P77.39-0216-06

Electrical Test Program – Component Locations

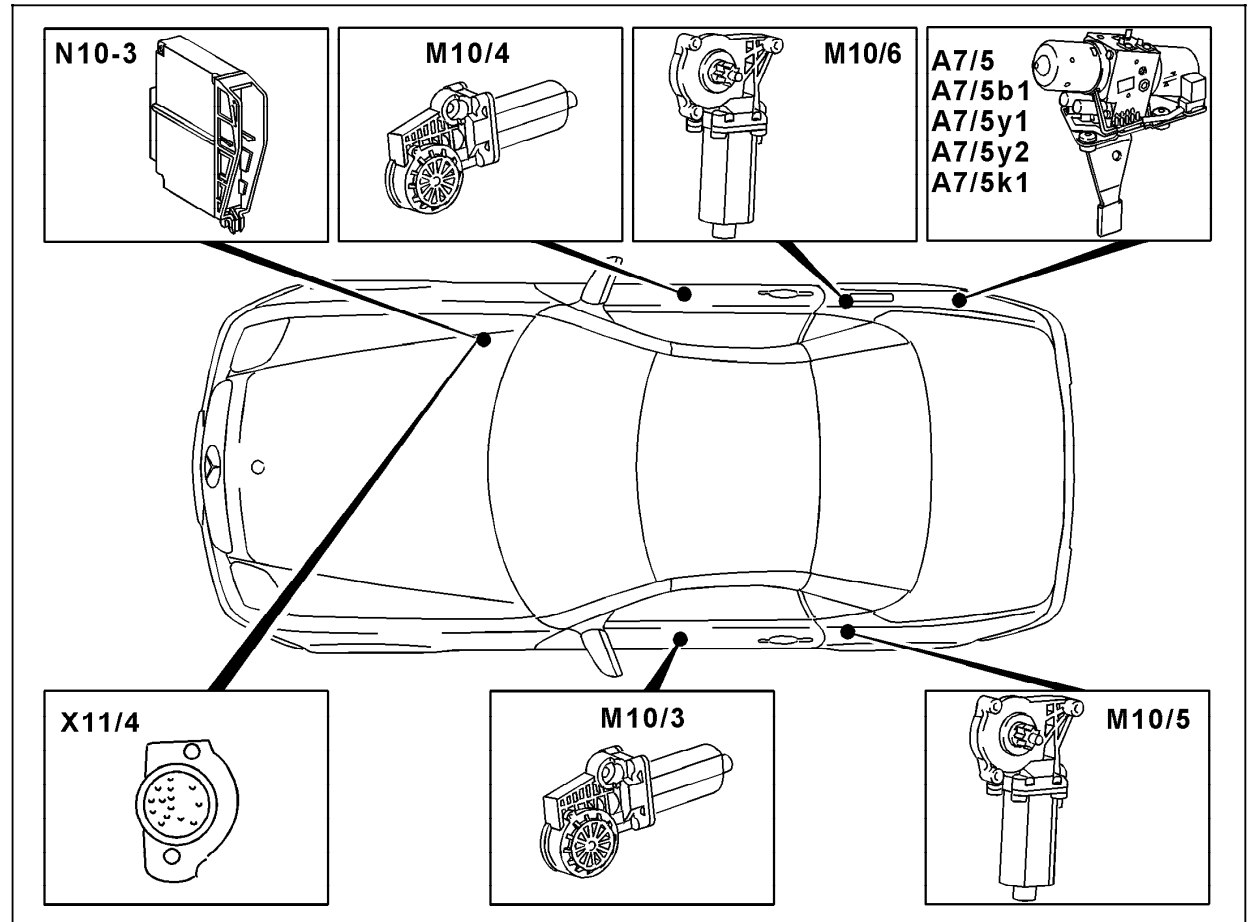

Figure 2

- A7/5 Retractable hardtop hydraulic unit
- A7/5b1 Overload protection thermocouple
- A7/5k1 Hydraulic unit relay
- A7/5y1 Retractable hardtop solenoid valve
- A7/5y2 Trunk lid solenoid valve
- M10/3 Left front power window motor (voltage supply)
- M10/4 Right front power window motor (voltage supply)
- M10/5 Left rear power window motor
- M10/6 Right rear power window motor
- N10-3 Combination control module
- X11/4 Data link connector (DTC readout)

P77.39-0217-06

Electrical Test Program – Component Locations

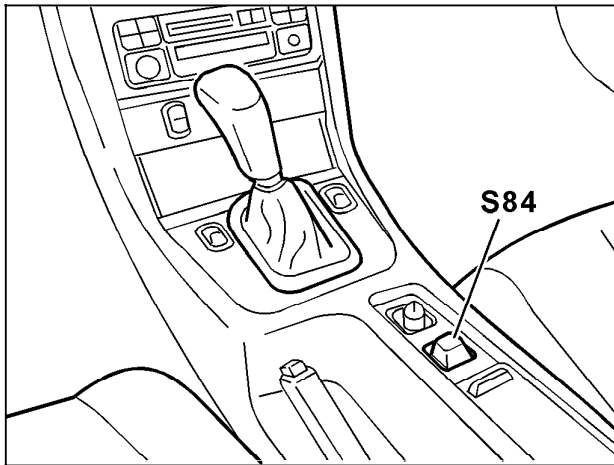

Figure 3

P77.39-0242-01

S84 Retractable hardtop switch