

Electrical Test Program – Component Locations

Wiper System

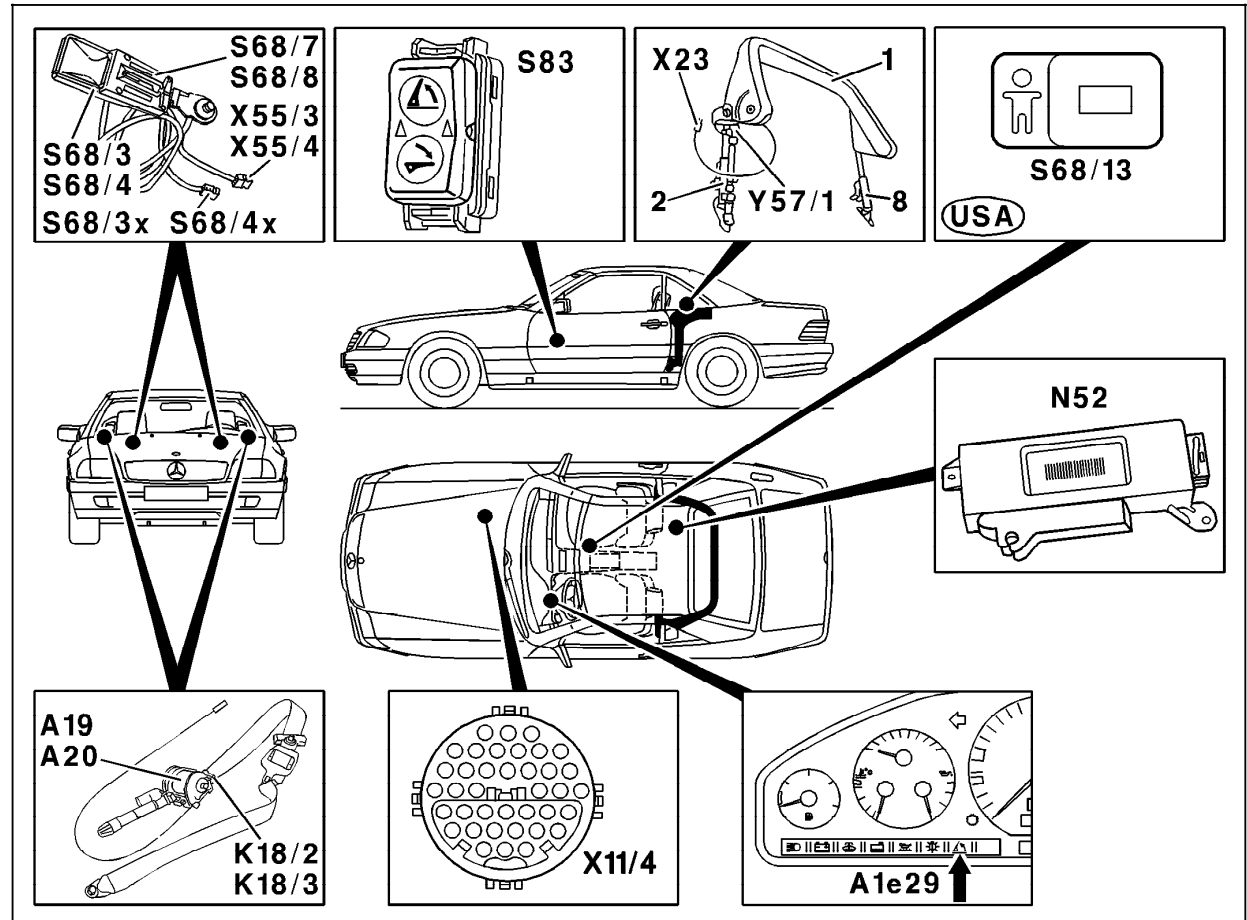

Figure 1

- A1e29 RB MIL
- A19 Left seat belt lock
- A20 Right seat belt lock
- K18/2 Left front seat belt lock relay module
- K18/3 Right front seat belt lock relay module
- N52 Power soft top control module
- R12/1 Left front ETR squib
- R12/2 Right front ETR squib
- S68/7 Left front seat belt buckle/belt lock switch
- S68/8 Right front seat belt buckle/belt lock switch
- S68/13 Seat belt lock switch (child safety lock)
- S83 RB switch (manual operation)
- X11/4 Data link connector (DTC readout)
- X23 RB solenoid valve connector (2-pole)
- X55/3 Left ESA connector block
- X55/4 Right ESA connector block
- Y57/1 RB deployment solenoid

P91.50-0201-06