

#### Electrical Test Program – Connection of Components

Model 208  
Engine 112, 113

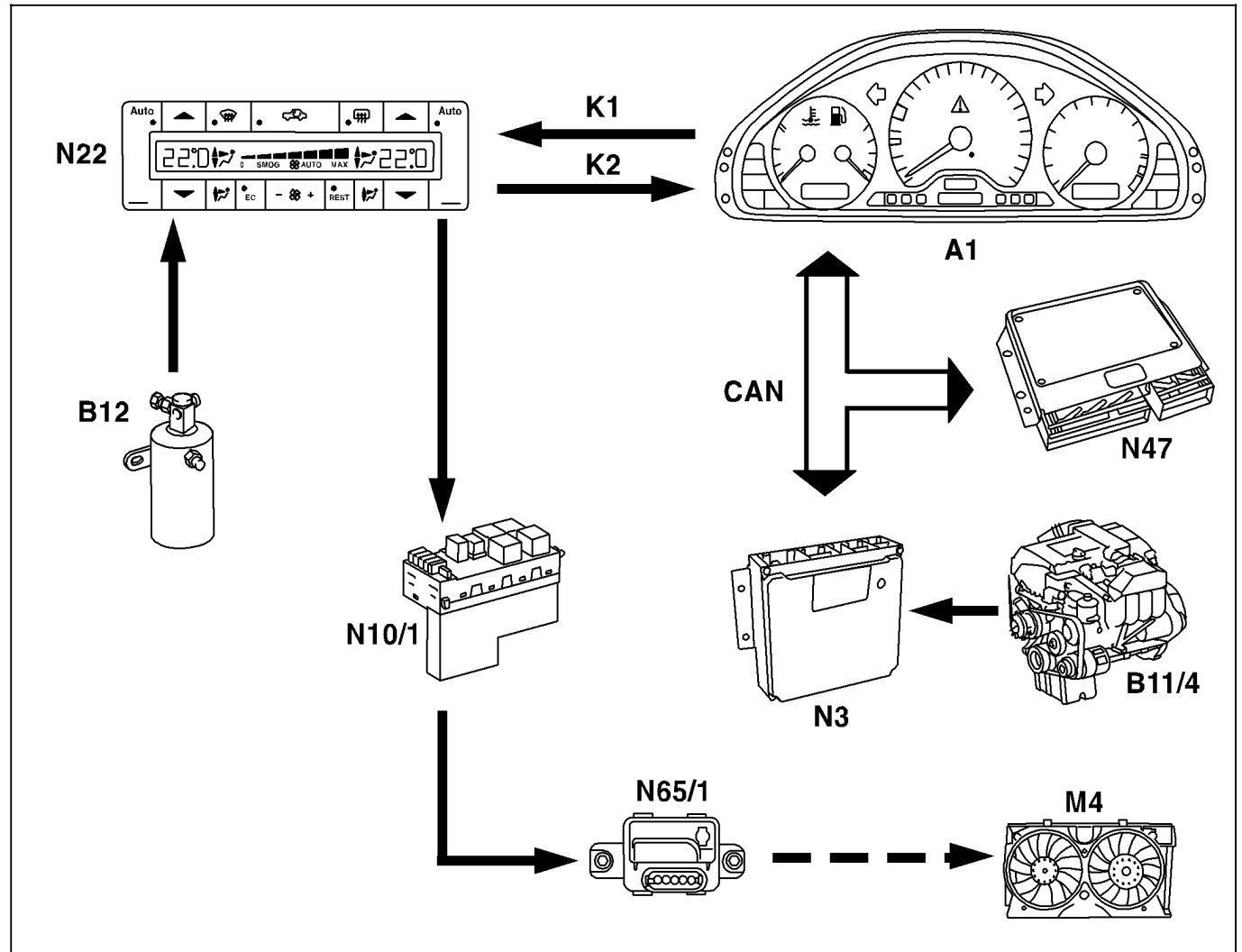

Figure 1

- A1 Instruments cluster
- B11/4 ECT sensor (DFI, IFI)
- B12 Refrigerant pressure sensor
- M4 Auxiliary fan
- N3 CFI control module
- N10/1 Signal pick-up and activation module (SAM) left front
- N22 A/C pushbutton control module (Automatic A/C)
- N47 Traction systems control module
- B10/4 In-car temperature sensor
- B10/6 Evaporator temperature sensor
- N22 A/C pushbutton control module
- N65/1 AIR control module

P83.40-2089-06

#### Electrical Test Program – Connection of Components

Connection of Components for Temperature Regulation  
Model 208 shown

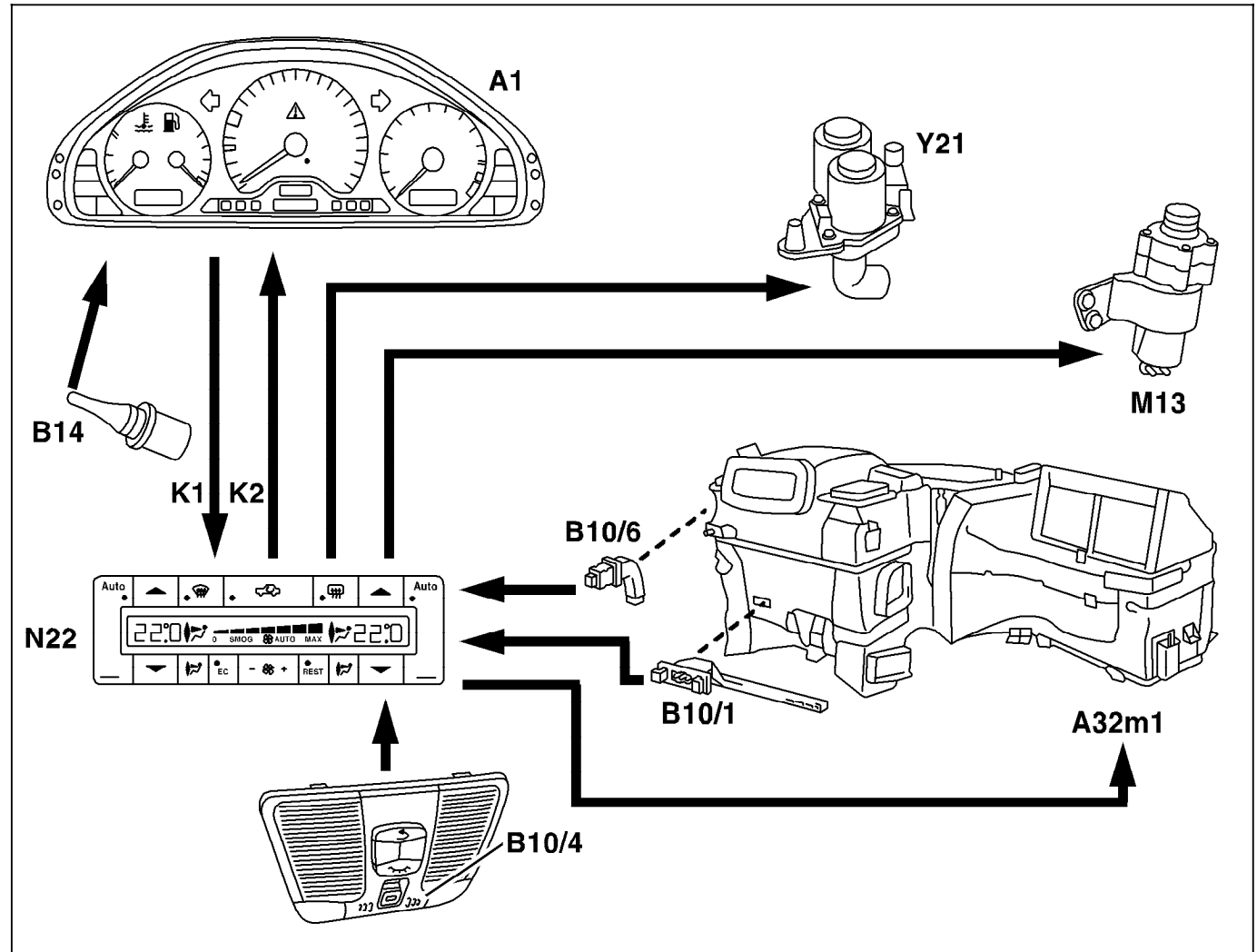

Figure 2

- A1 Instrument cluster
- A32m1 Blower motor
- B10/1 Heater core temperature sensor
- B10/4 In-cat temperature sensor
- B10/6 Evaporator temperature sensor
- B14 Outside temperature indicator temperature sensor
- M13 Coolant circulation pump
- N19 A/C pushbutton control module
- Y21 Duovalve

P83.40-2078-06