

Pneumatic Test Program – Component Locations

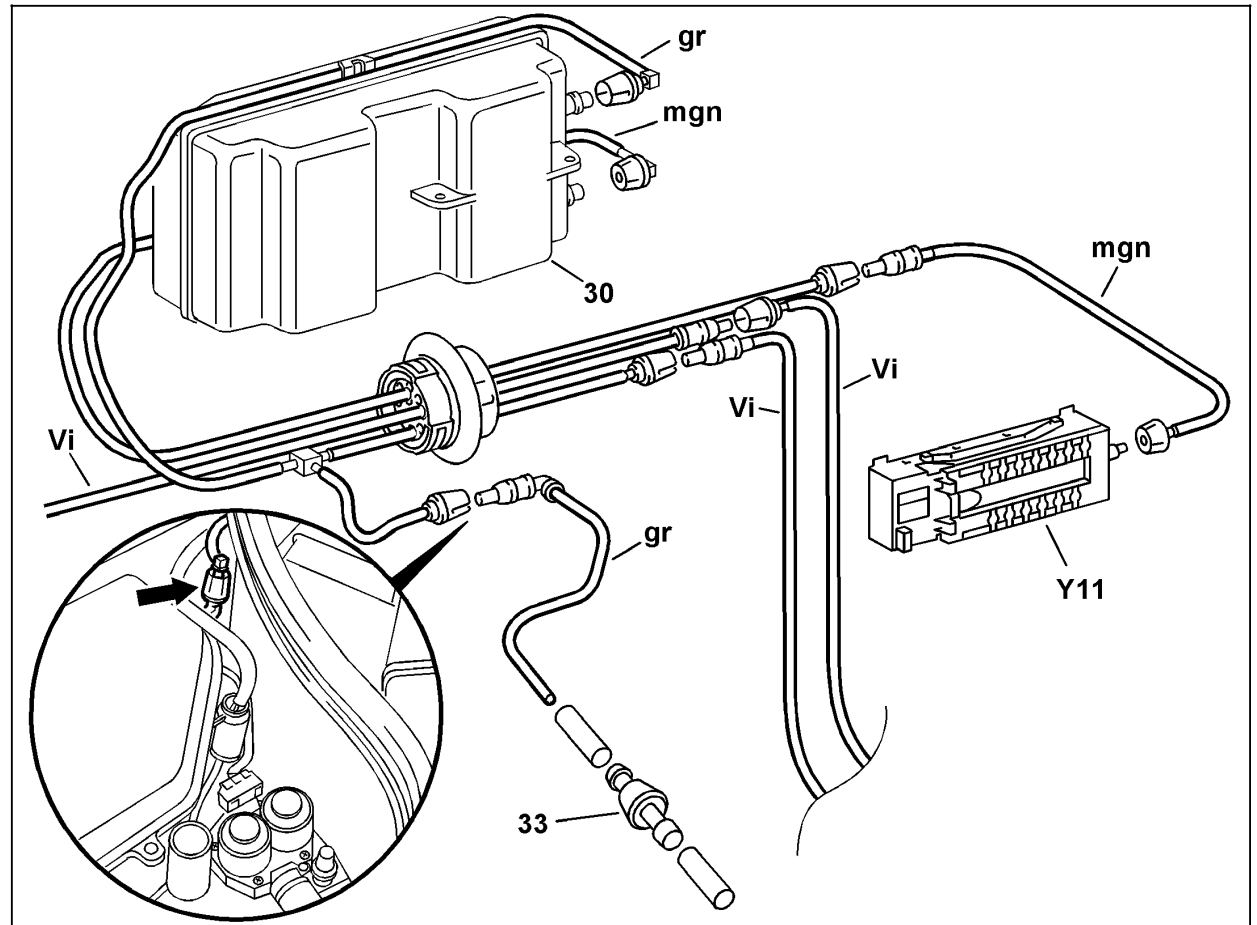

Figure 1

- 30 Vacuum reservoir
- 33 Check valve
- Y11 Switchover valve (15 connections)

- gr Gray
- mgn Medium green
- vi Violet

P83.40-0425-06

Pneumatic Test Program – Component Locations

Figure 2

- 35 Connector (passenger compartment)
- 37 Left defroster flap vacuum actuator
- 38 Right defroster flap vacuum actuator
- 41 Diverter flap vacuum actuator
- 42 Right center tempering flap vacuum actuator
- 43 Left center tempering flap vacuum actuator
- 44 Fresh/recirculating air flap vacuum actuator
- 47 Left foot well flap vacuum actuator
- 48 Right foot well flap vacuum actuator
- Y11 Switchover valve block (15 connections)

- HBL Light blue
- drt Dark red
- ge Yellow
- mgn Medium green
- rt Red
- ws White
- dgn Dark green

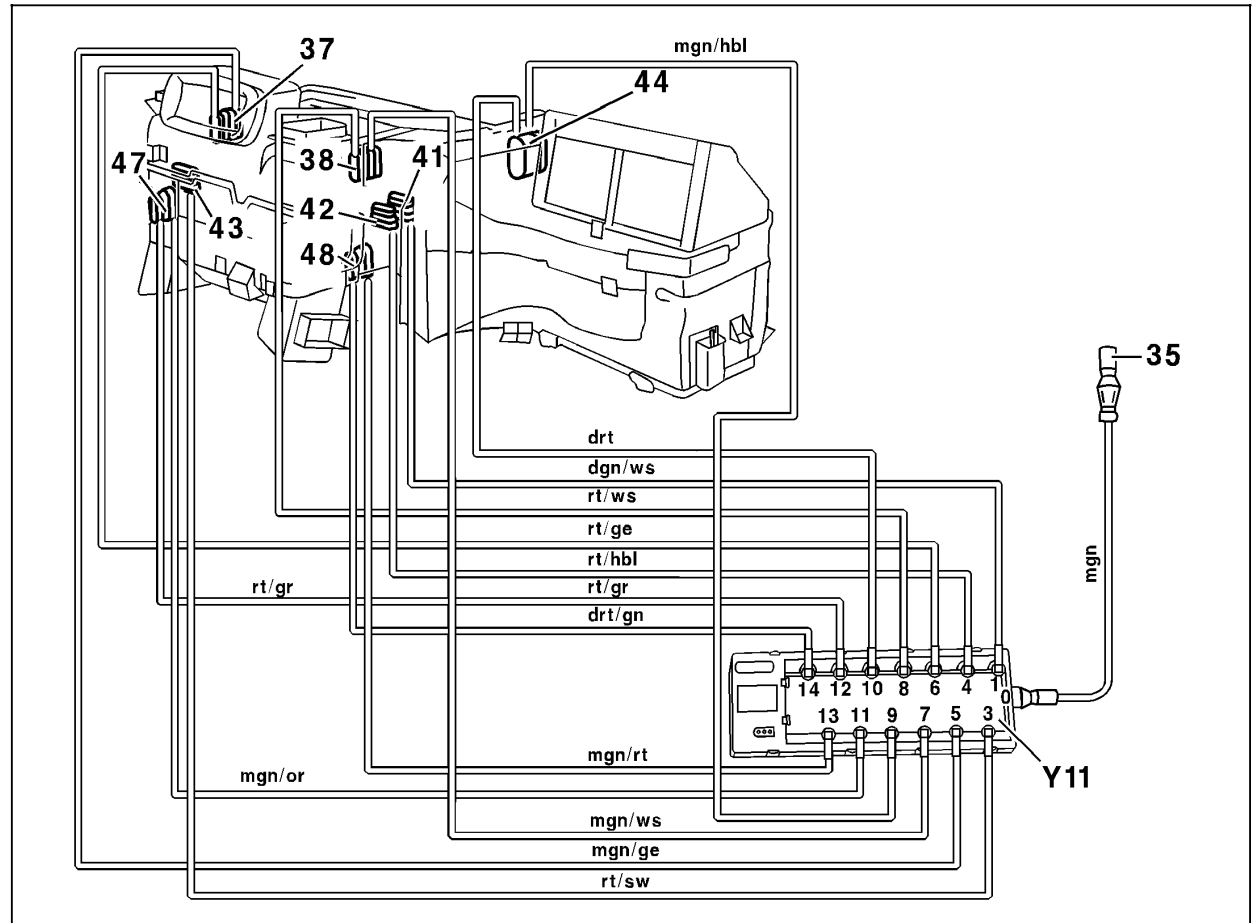

P83.40-0408-06