

Electrical Test Program – Component Locations

Electrical Components in Passenger Compartment

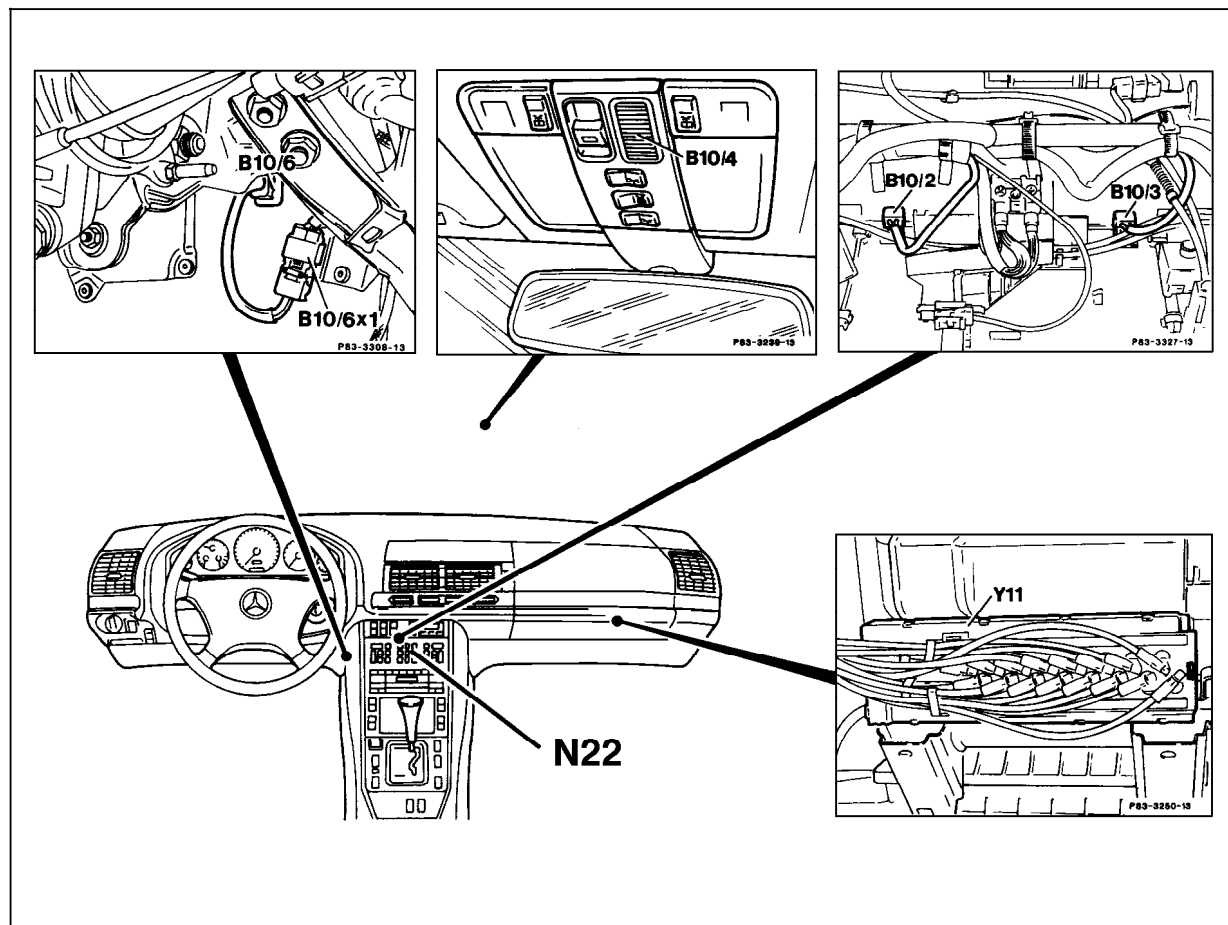

Figure 1

- B10/2 Left heater core temperature sensor
- B10/3 Right heater core temperature sensor
- B10/4 In-car temperature sensor (with aspirator blower in E15)
- B10/6 Evaporator temperature sensor
- B10/6x1 Evaporator temperature sensor connector
- N22 A/C pushbutton control module
- Y11 Switchover valve block (15 connections, multiplex)

P83-5006-57

Electrical Test Program – Component Locations

Electrical Components in Engine Compartment

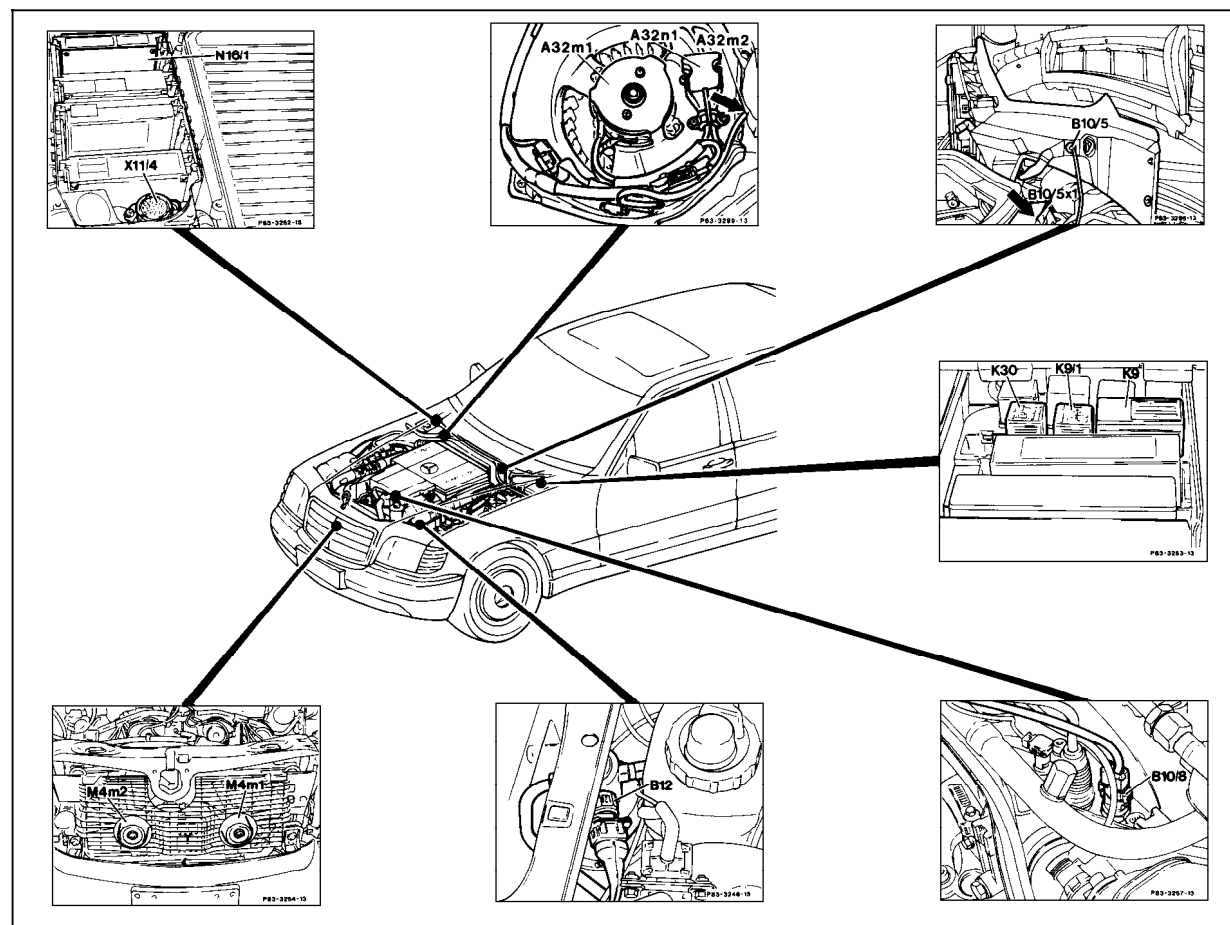

Figure 2

- A32m1 Blower motor
- A32m2 Activated charcoal filter actuator
- A32n1 Blower regulator
- B10/5 Outside temperature sensor
- B10/5x1 Outside temperature sensor connector
- B10/8 ECT sensor (A/C)
- B12 Refrigerant pressure sensor
- K9 Auxiliary fan relay module (stage 2)
- K9/1 Auxiliary fan relay module (stage 1)
- K30 Auxiliary coolant pump control relay module
- M4m1 Left auxiliary fan
- M4m2 Right auxiliary fan
- N16/1 Base module
- X11/4 Data link connector (DTC readout)

P83-0441-57

Electrical Test Program – Component Locations

Component Locations in Passenger Compartment

Figure 3

B10/9	Left rear heater core temperature sensor
B10/10	Right rear heater core temperature sensor
B10/11	Rear evaporator temperature sensor
B10/11x1	Rear evaporator temperature sensor connector
M2/1	Rear blower motor, automatic A/C
N29/2	Rear A/C electronic blower regulator
N29/2x1	Rear A/C electronic blower regulator connector (4-pole)
107	Refrigerant injector
c	Hot water feed
d	Hot water return

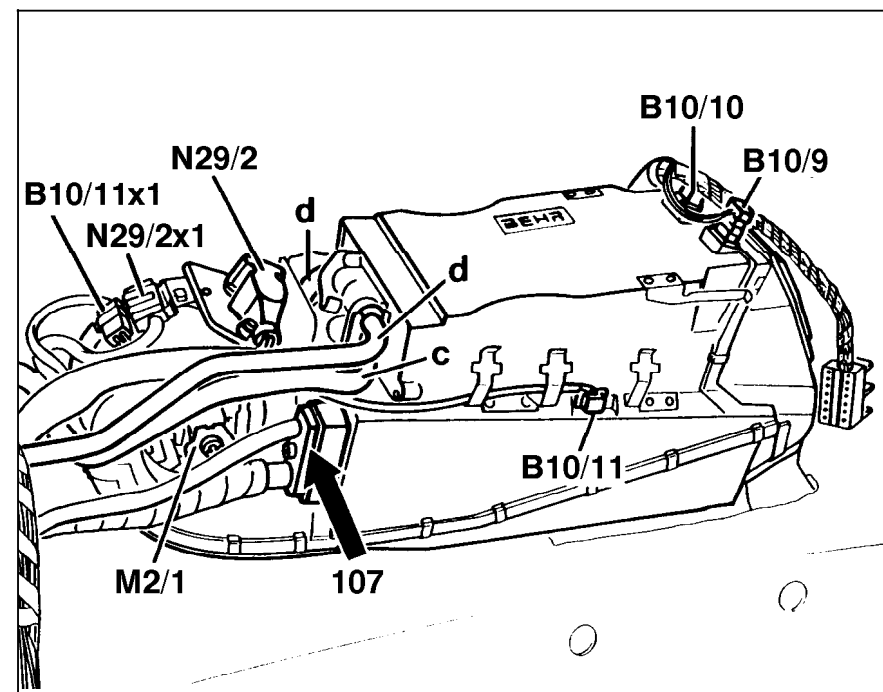

P83-5493-35

Electrical Test Program – Component Locations

Component Locations in Passenger Compartment

Figure 4

Y67/1 Rear tunnel flap vacuum valve

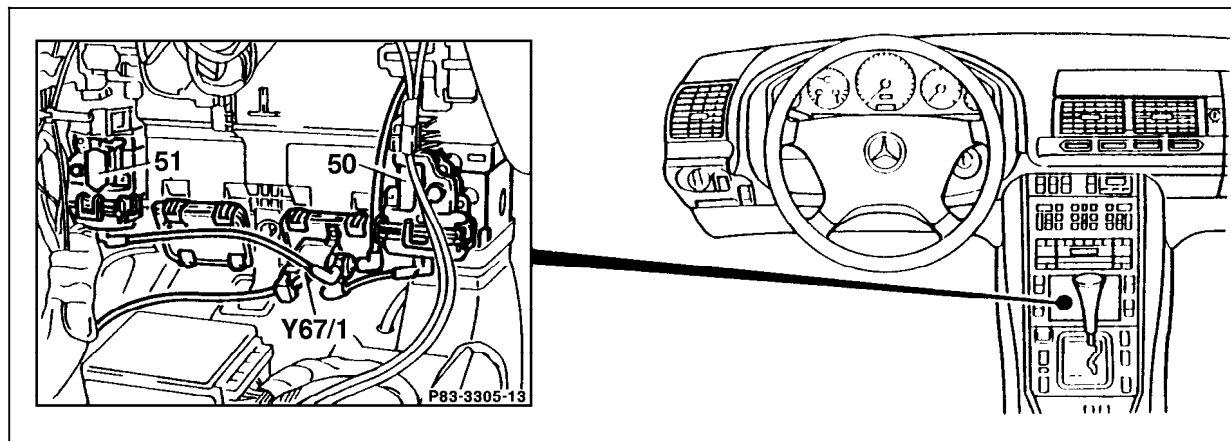

P83-5455-53

Electrical Test Program – Component Locations

Vacuum Diagram

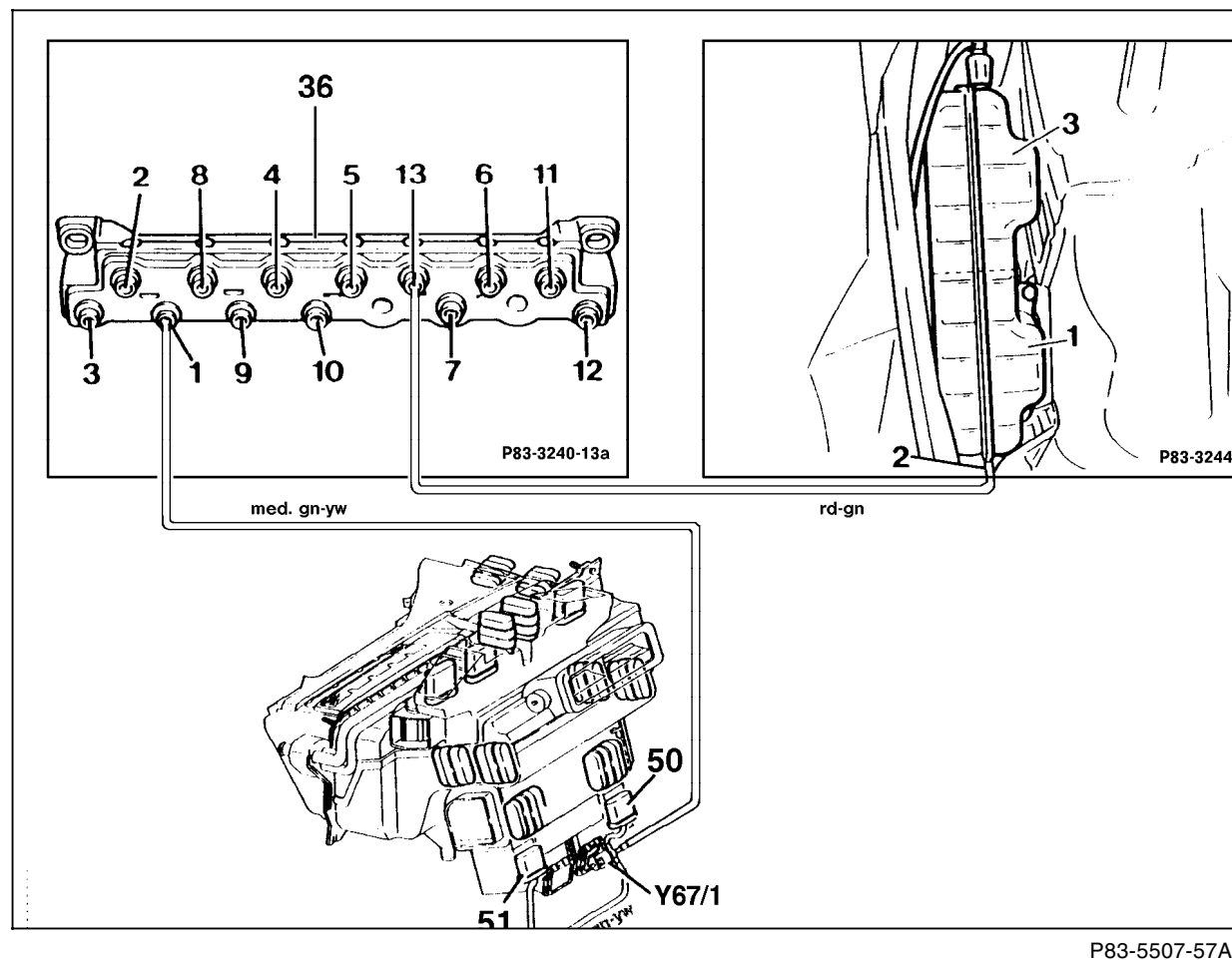

Figure 5

- Y67/1 Rear tunnel flap vacuum valve
- 1 Vacuum accumulator
- 36 Vacuum distribution block
- 50 Vacuum element – right rear legroom
- 51 Vacuum element – left rear legroom

Electrical Test Program – Component Locations

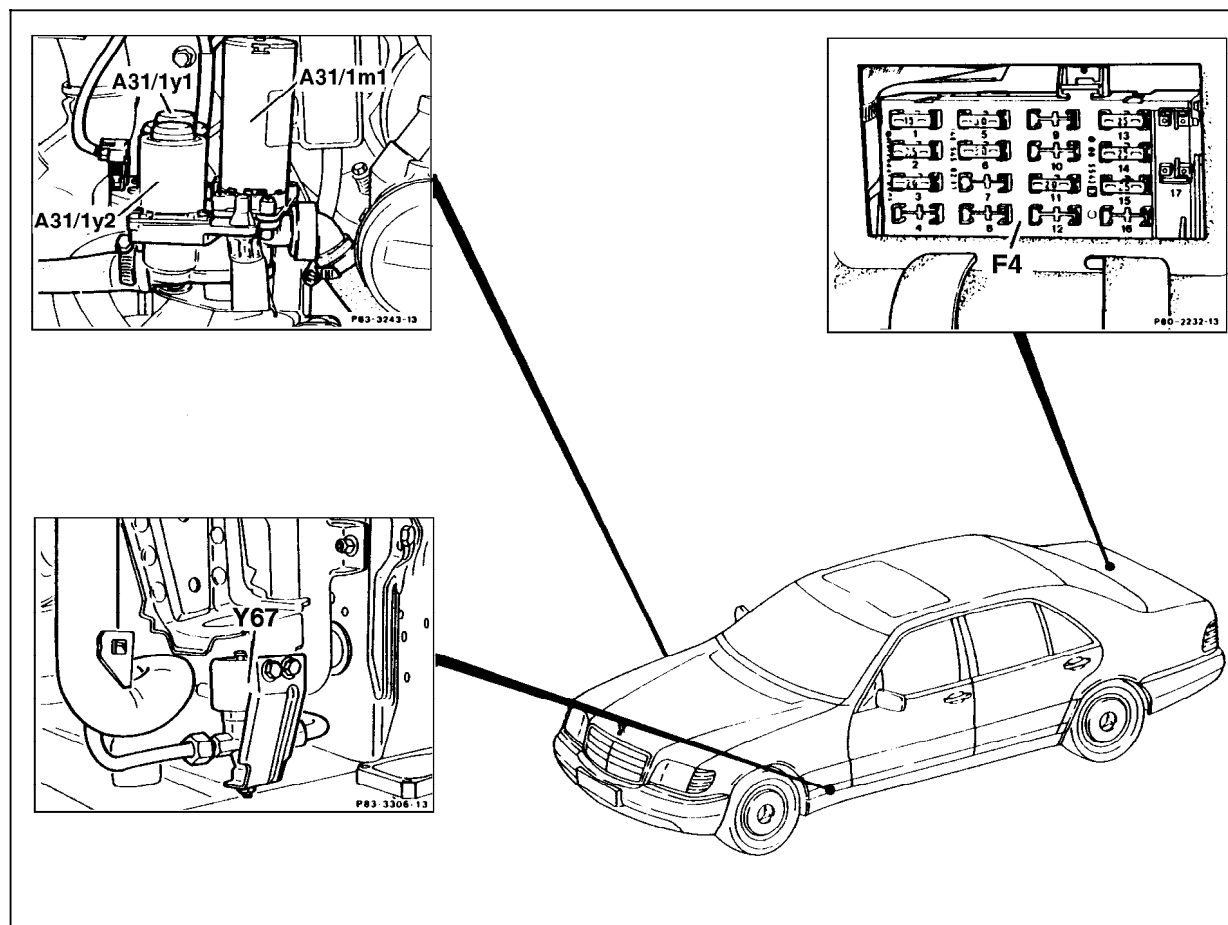

Figure 6

- A31/1m1 Coolant circulation pump
- A31/1y1 Left duovalve
- A31/1y2 Right duovalve
- F4 Rear fuse box
- Y67 Rear refrigerant shut-off valve

P83-5018-57