

Electrical Test Program – Connection of Components

**Connection of Components
Model 210
Engines 104, 606 up to 8/96
Engine 119 up to 9/97**

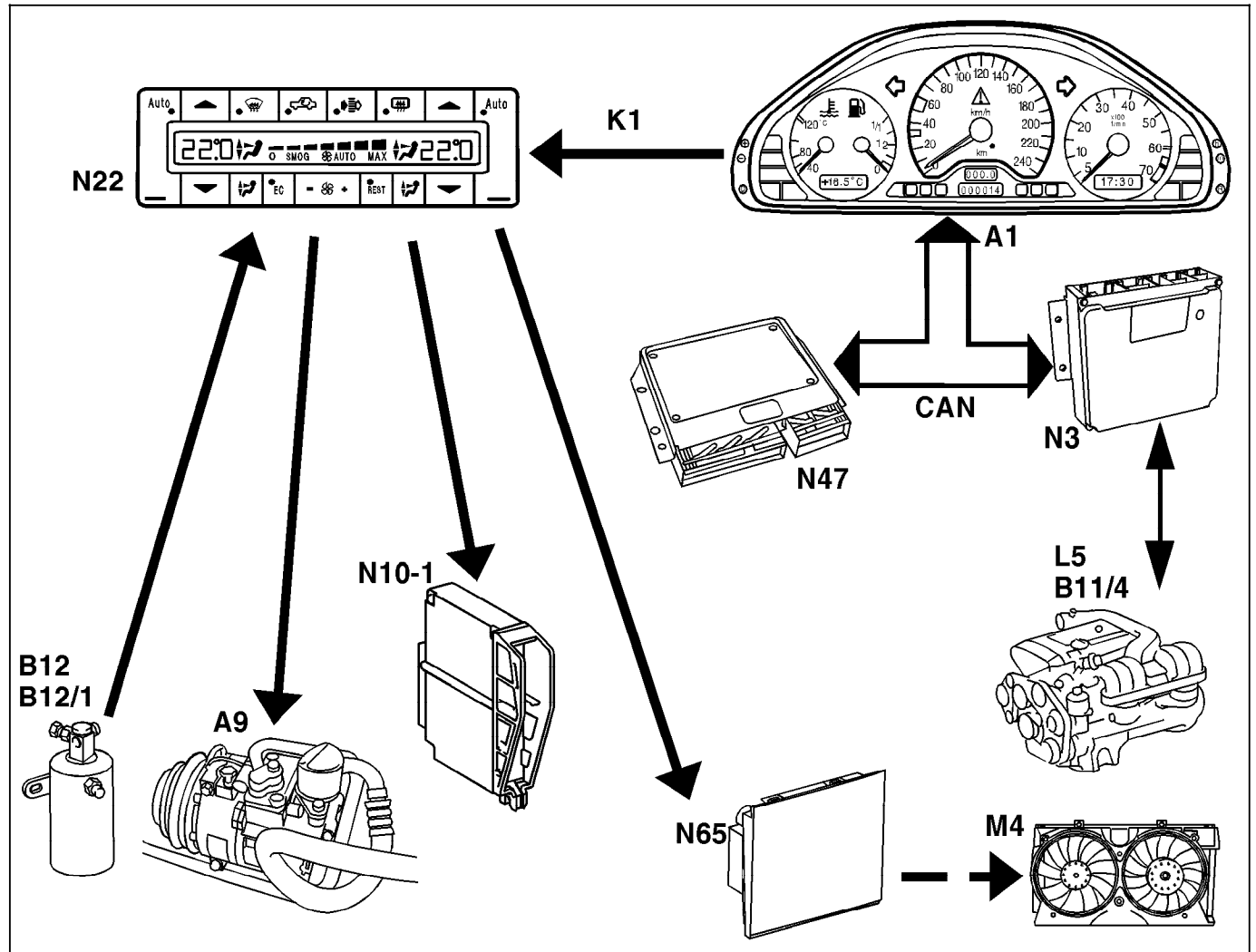

Figure 1

- A1 Instrument cluster
- A9 A/C compressor
- B11/4 CT sensor
- B12 Refrigerant pressure sensor
- B12/1 Refrigerant temperature sensor
- L5 CKP sensor
- M4 Auxiliary fan
- N3 CFI control module
- N47 Traction systems control module
- N10-1 Combination control module (CF, windshield wiper, rear window defroster)
- N22 AAC pushbutton control module
- N65 Pulse module (traction systems, HCS, ATA, AAC)

P83.40-0435-06

Electrical Test Program – Connection of Components

Connection of Components
Model 210 as of 9/96 to 2/97
Engines 104, 606

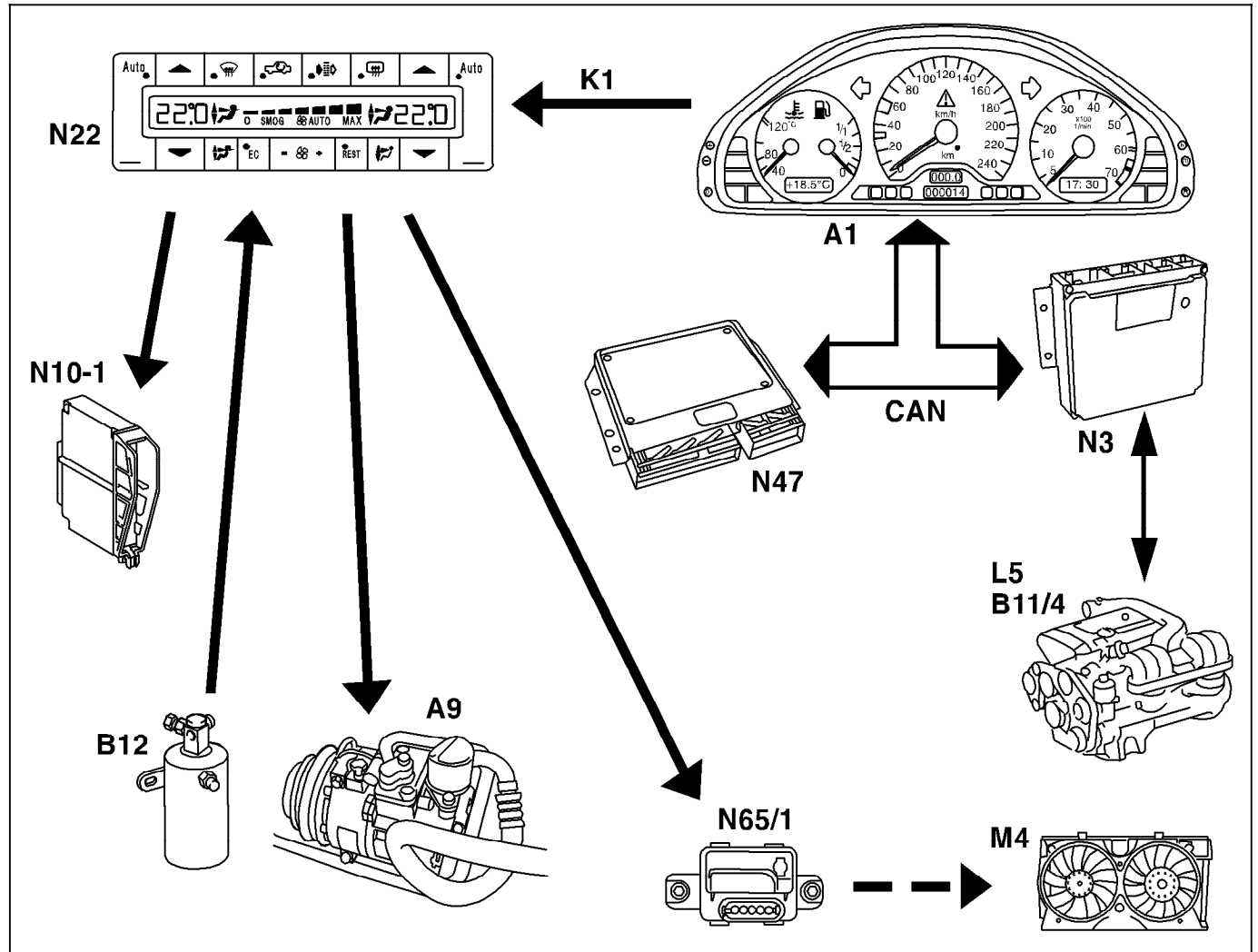

Figure 2

- A1 Instrument cluster
- A9 A/C compressor
- B11/4 CT sensor
- B12 Refrigerant pressure sensor
- B12/1 Refrigerant temperature sensor
- L5 CKP sensor
- M4 Auxiliary fan
- N3 CFI control module
- N47 Traction systems control module
- N10-1 Combination control module (CF, windshield wiper, rear window defroster)
- N22 AAC pushbutton control module
- N65/1 AIR control module

P83.40-2071-06

Electrical Test Program – Connection of Components

Connection of Components
 Model 210
 Engine 112 as of 6/98

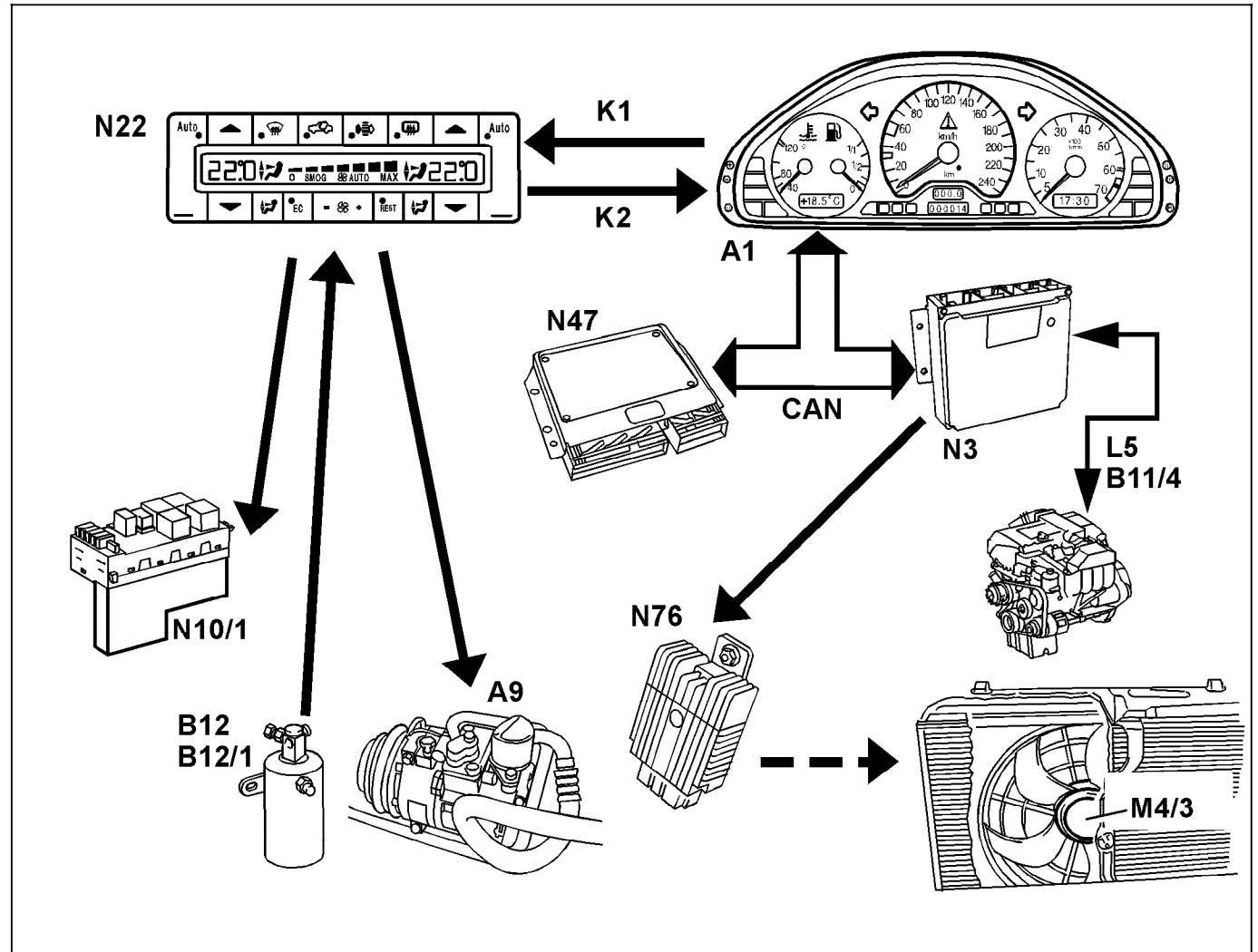

Figure 3

- A1 Instrument cluster
- A9 A/C compressor
- B11/4 CT sensor
- B12 Refrigerant pressure sensor
- B12/1 Refrigerant temperature sensor
- L5 CKP sensor
- M4/3 Engine/climate control electric cooling fan
- N3 CFI control module
- N47 Traction systems control module
- N10/1 Signal pick-up and activation module (SAM) left front
- N22 AAC pushbutton control module
- N76 Engine/climate control electric cooling fan control module

P83.40-0412-06

Electrical Test Program – Connection of Components

Connection of Components
 Model 210
 Engine 113, 606 as of 3/97
 Engine 112 up to 5/98

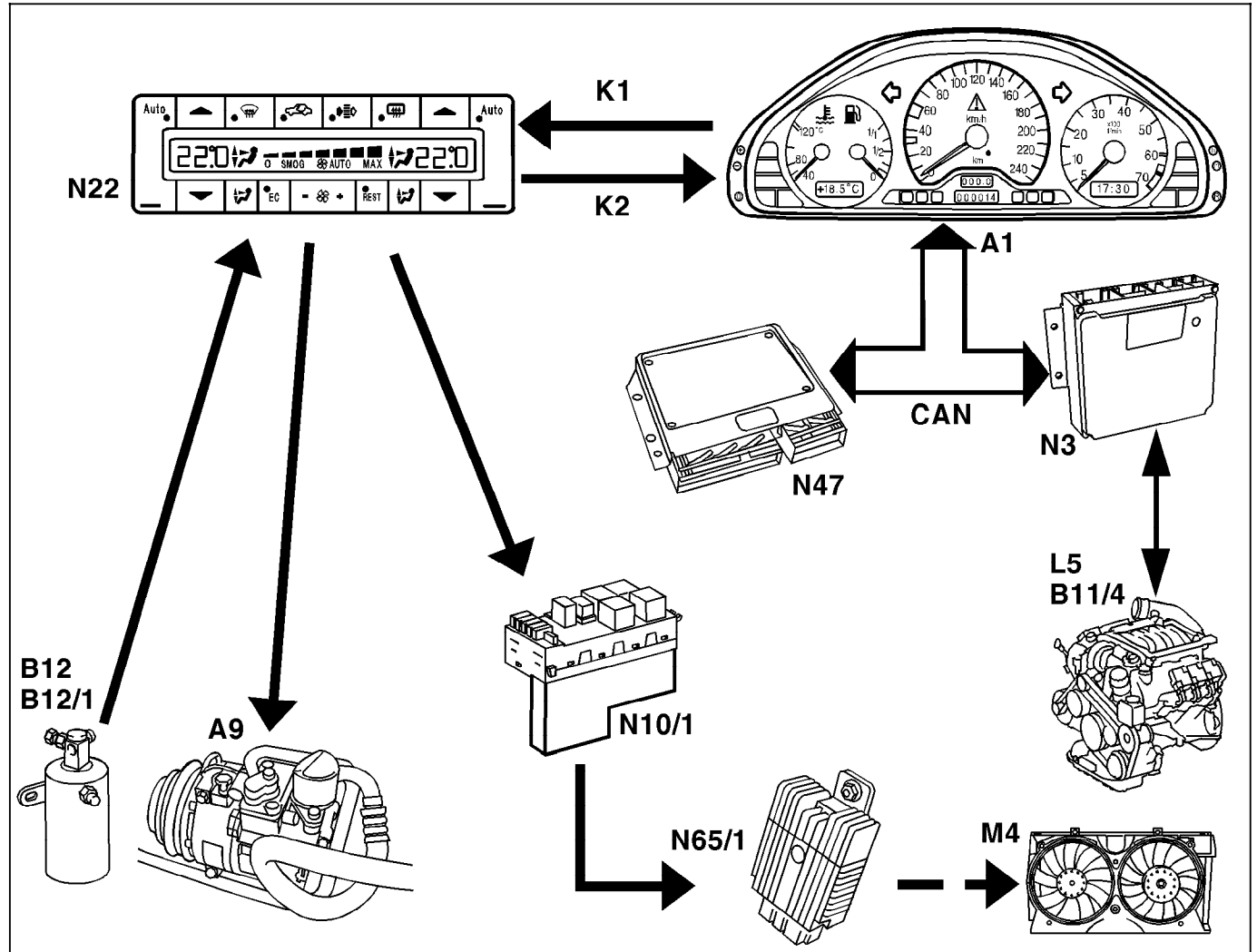

Figure 4

- A1 Instrument cluster
- A9 A/C compressor
- B11/4 CT sensor
- B12 Refrigerant pressure sensor
- B12/1 Refrigerant temperature sensor
- L5 CKP sensor
- M4/3 Engine/climate control electric cooling fan
- N3 CFI control module
- N47 Traction systems control module
- N10/1 Signal pick-up and activation module (SAM) left front
- N22 AAC pushbutton control module
- N65/1 AIR control module

P83.40-0433-06

Electrical Test Program – Connection of Components

Connection of Components for
 Auxiliary fan (M4) regulation
 Model 210
 Engine 104, 606 up to 8/96
 Engine 119 up to 9/97

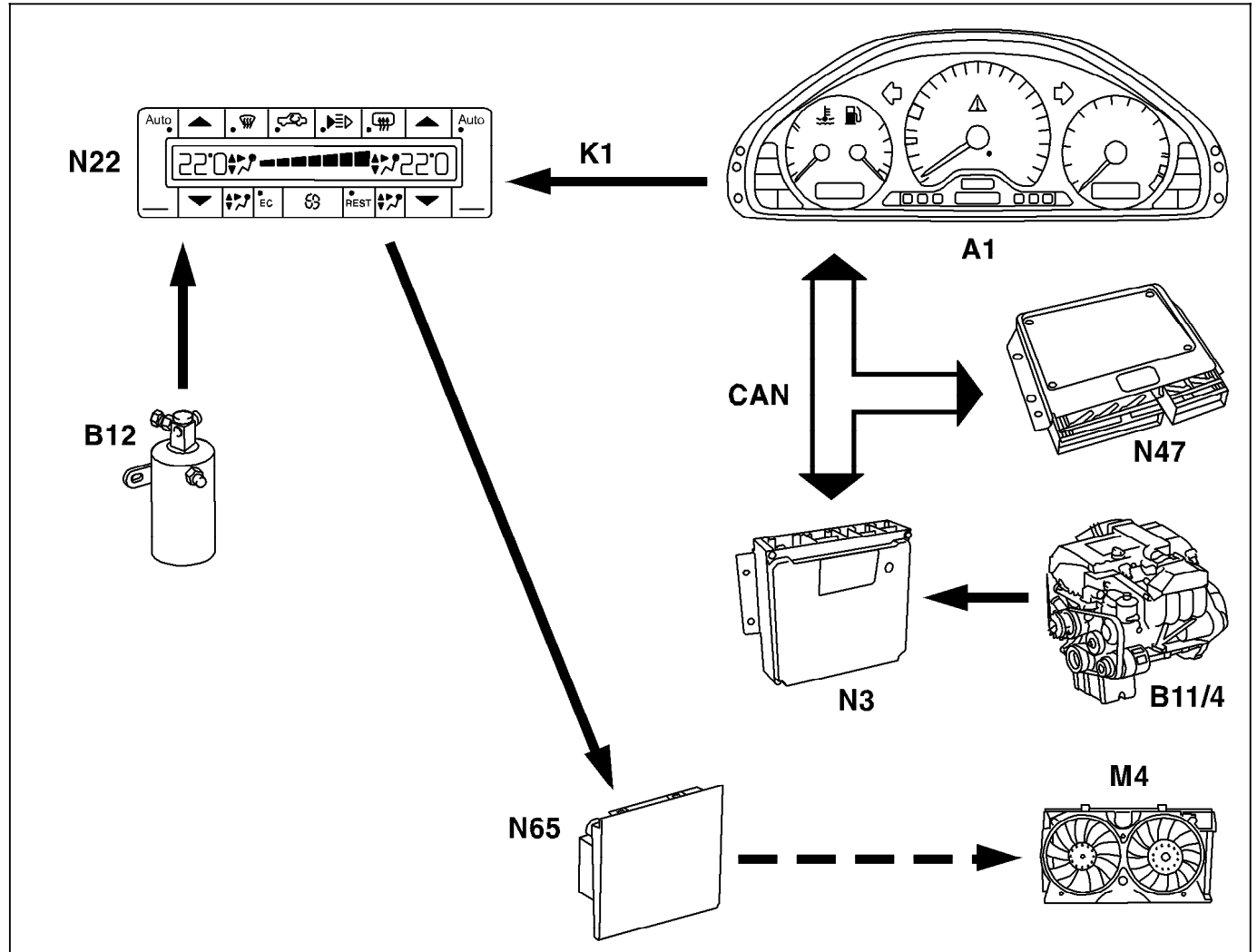

Figure 5

- A1 Instrument cluster
- B11/4 CT sensor.
- B12 Refrigerant pressure sensor
- M4 Auxiliary fan
- N3 CFI control module
- N47 Traction systems control module
- N65 Pulse module (traction systems, HCS, ATA, AAC)

P83.40-2081-06

Electrical Test Program – Connection of Components

Connection of Components for
Auxiliary fan (M4) regulation
Model 210 as of 9/96 up to 2/97
Engines 104 and 606

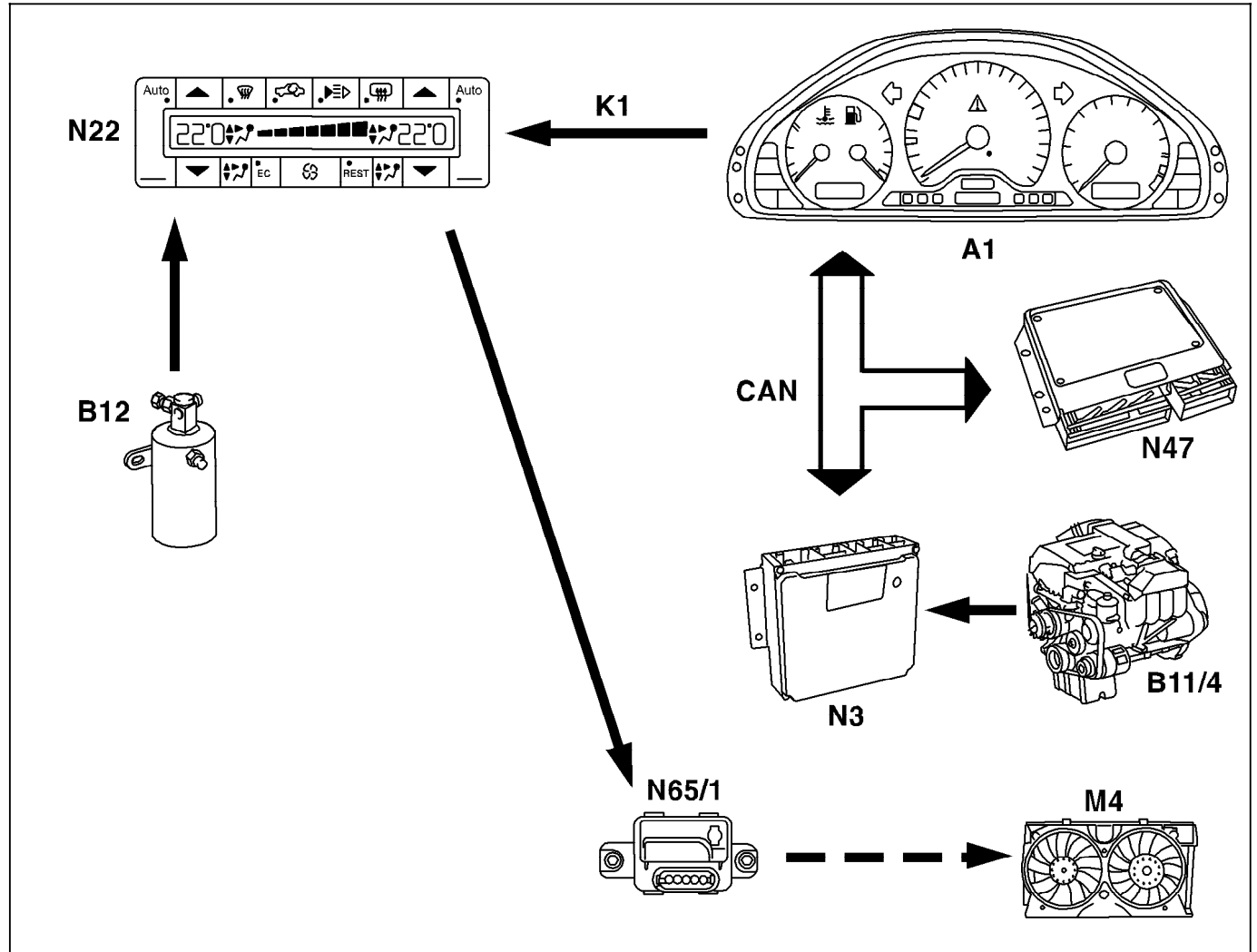

Figure 6

- A1 Instrument cluster
- B11/4 CT sensor.
- B12 Refrigerant pressure sensor
- M4 Auxiliary fan
- N3 CFI control module
- N22 AAC pushbutton control module
- N47 Traction systems control module
- N65/1 AIR control module

P83.40-2083-06

Electrical Test Program – Connection of Components

Connection of Components for
 Auxiliary fan (M4) regulation
 Model 210
 Engines 113 and 606 up to 3/97
 Engine 112 up to 5/98

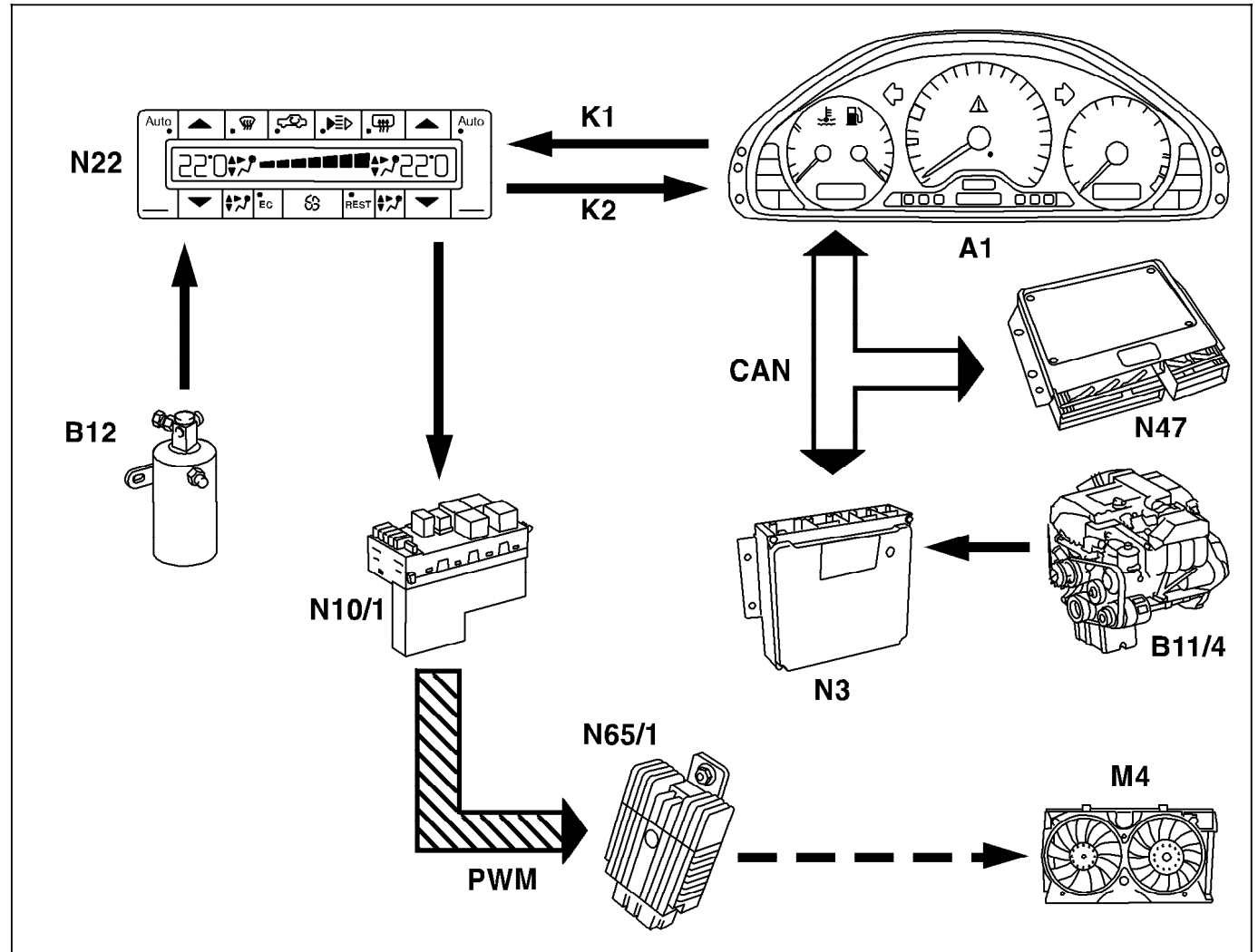

Figure 7

- A1 Instrument cluster
- B11/4 CT sensor.
- B12 Refrigerant pressure sensor
- M4/3 Engine/climate control electric cooling fan
- N3 CFI control module
- N10/1 Signal pick-up and activation module (SAM) left front
- N22 AAC pushbutton control module
- N47 Traction systems control module
- N65/1 AIR control module

P83.40-2080-06

Electrical Test Program – Connection of Components

Connection of Components for
 Engine/climate control electric
 cooling fan (M4/3) regulation
 Model 210
 Engine 112 as of 6/98

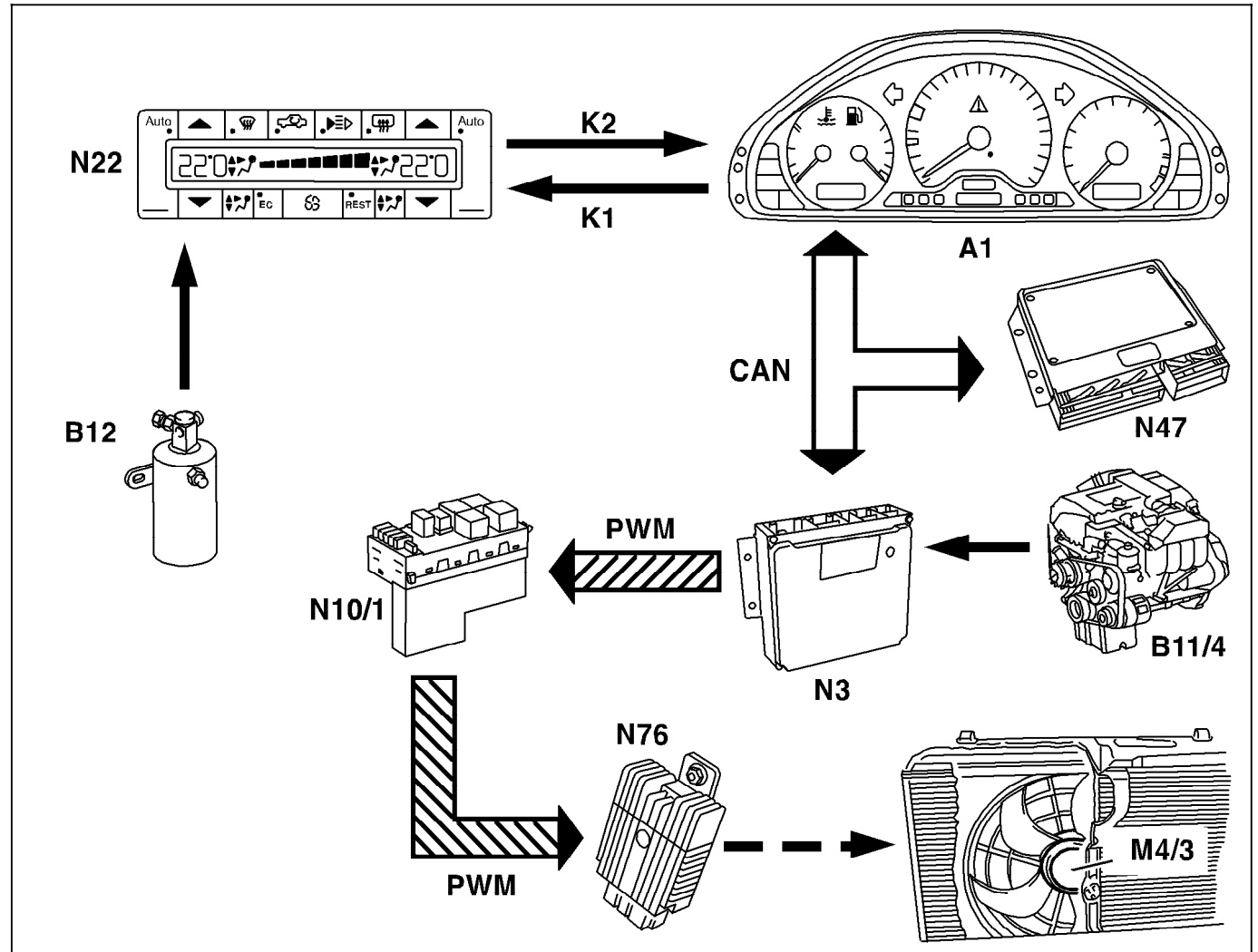

Figure 8

- A1 Instrument cluster
- B11/4 CT sensor.
- B12 Refrigerant pressure sensor
- M4/3 Engine/climate control electric cooling fan
- N3 CFI control module
- N10/1 Signal pickup- and activation module (SAM) left front
- N22 AAC pushbutton control module
- N47 Traction systems control module
- N76 Engine/climate control electric cooling fan control module

P83.40-2079-06

Electrical Test Program – Connection of Components

Connection of Components for Temperature Regulation
Model 210

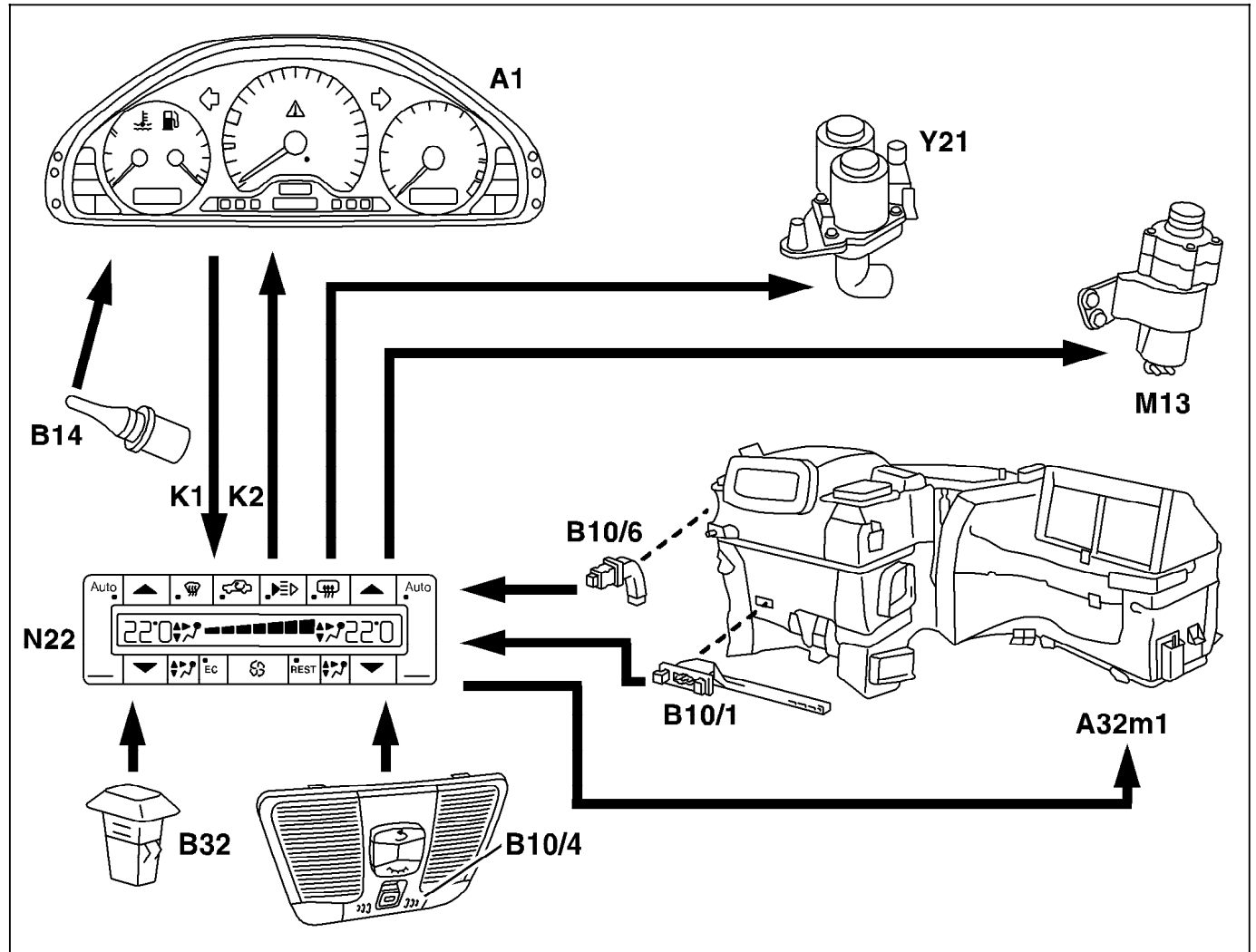

Figure 9

- A1 Instrument cluster
- A32m1 Blower motor
- B10/1 Heater core temperature sensor
- B10/4 In-car temperature sensor
- B10/6 Evaporator temperature sensor
- B14 Outside temperature indicator temperature sensor
- B32 Sun sensor
- M13 Coolant circulation pump
- N22 AAC pushbutton control module
- Y21 Duovalve

P83.40-2077-06