

Electrical Test Program – Connection of Components

Model 202 with
Engine 104
Engine 111 up to M.Y. 1997

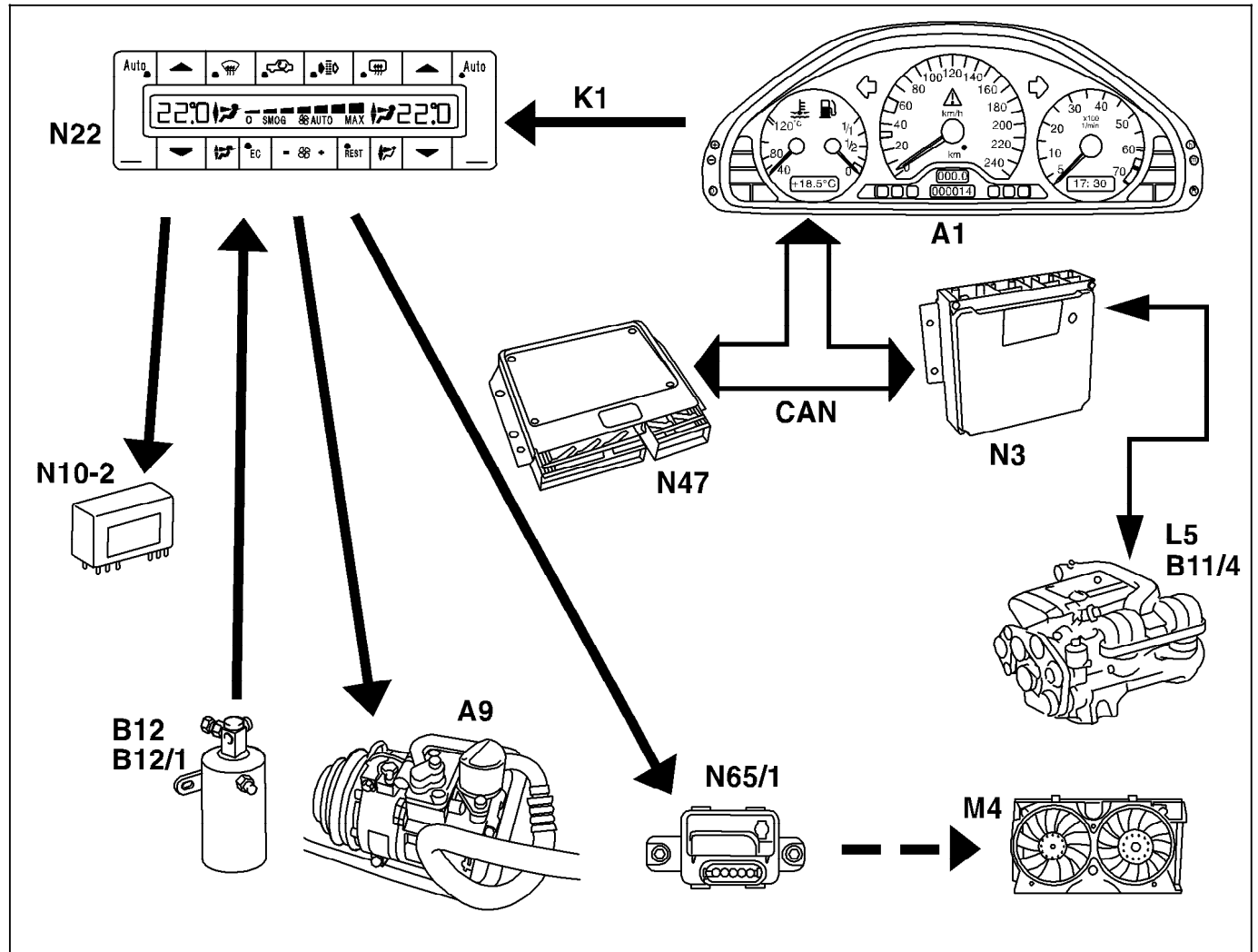

Figure 1

- A1 Instrument cluster
- A9 A/C compressor
- B11/4 ECT sensor (DIFI, IFI)
- B12 Refrigerant pressure sensor
- B12/1 Refrigerant temperature sensor
- L5 CKP sensor
- M4 Auxiliary fan
- N3 CFI control module
- N10/2 Combination relay module
- N22 A/C pushbutton control module
- N47 Traction systems control module
- N65/1 AIR control module

P83.40-2068-06

Electrical Test Program – Connection of Components

Model 202
Engine 111 M.Y. 1997

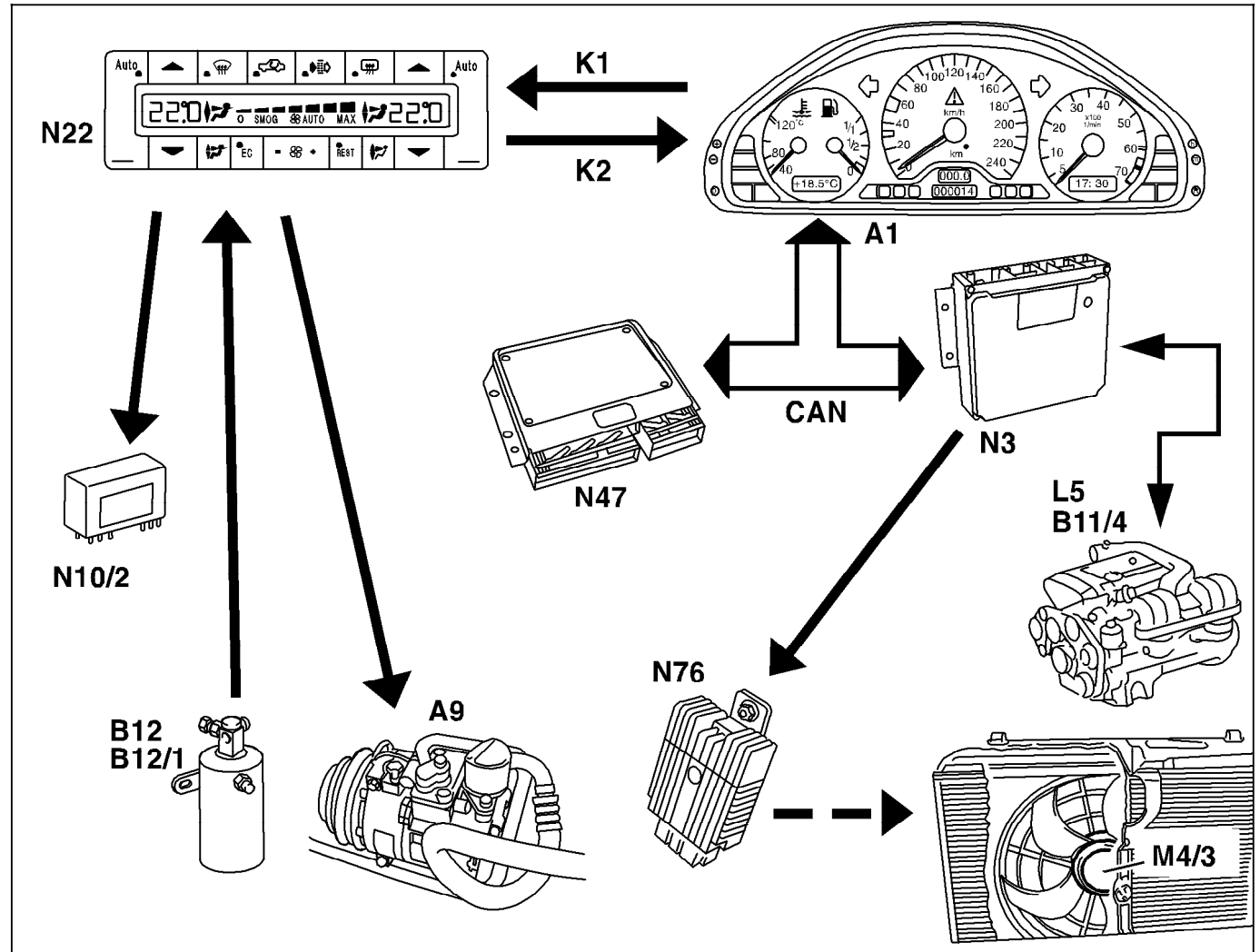

Figure 2

- A1 Instrument cluster
- A9 A/C compressor
- B11/4 ECT sensor (DIFI, IFI)
- B12 Refrigerant pressure sensor
- B12/1 Refrigerant temperature sensor
- L5 CKP sensor
- M4/3 Engine/climate control electric cooling fan
- N3 CFI control module
- N10/2 Combination relay module
- N22 A/C pushbutton control module
- N47 Traction systems control module
- N76 Engine/climate control electric cooling fan control module

P83.40-2070-06

Electrical Test Program – Connection of Components

Model 202
Engine 111 M.Y. 1998

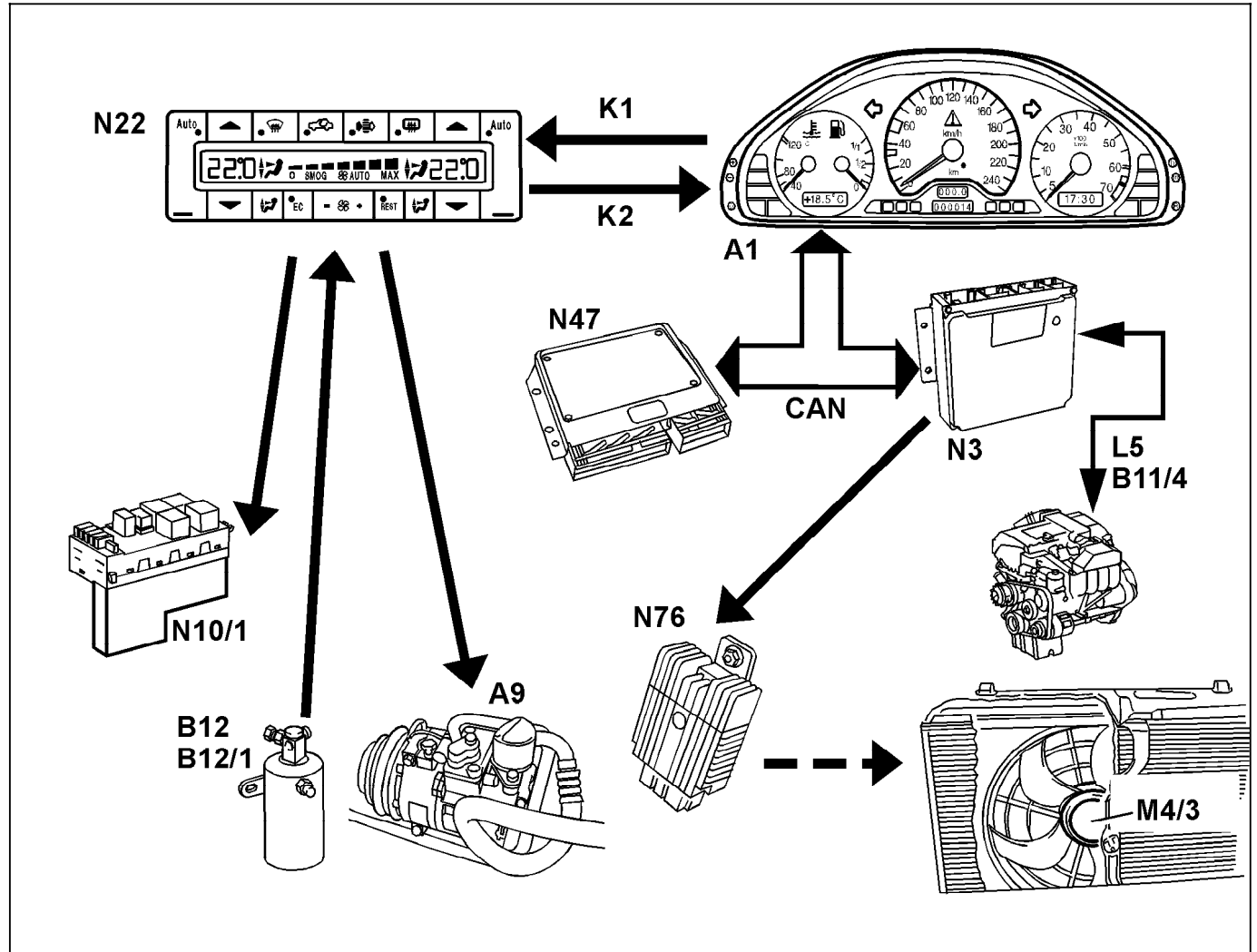

Figure 3

- A1 Instrument cluster
- A9 A/C compressor
- B11/4 ECT sensor (DIFI, IFI)
- B12 Refrigerant pressure sensor
- B12/1 Refrigerant temperature sensor
- L5 CKP sensor
- M4/3 Engine/climate control electric cooling fan
- N3 CFI control module
- N10/1 Signal pick-up and activation module (SAM) left front
- N22 A/C pushbutton control module
- N76 Engine/climate control electric cooling fan control module

P83.40-0412-06

Electrical Test Program – Connection of Components

Model 202
Engine 112

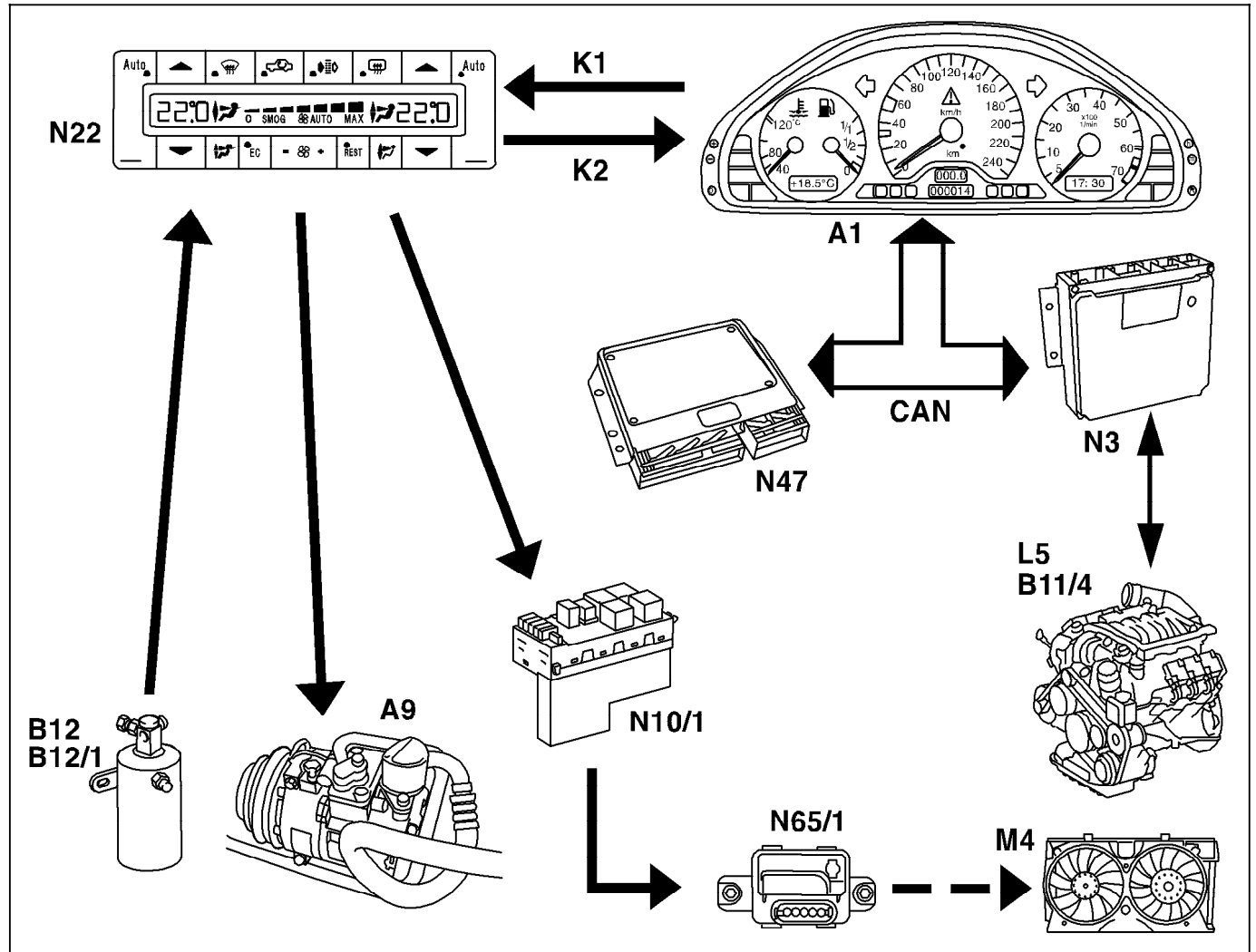

Figure 4

- A1 Instrument cluster
- A9 A/C compressor
- B11/4 ECT sensor (DIFI, IFI)
- B12 Refrigerant pressure sensor
- B12/1 Refrigerant temperature sensor
- L5 CKP sensor
- M4 Auxiliary fan
- N3 CFI control module
- N10/1 Signal pick-up and activation module (SAM) left front
- N22 A/C pushbutton control module
- N65/1 AIR control module

P83.40-2069-06

Electrical Test Program – Connection of Components

Model 202
 Connection of components for
 Auxiliary fan (M4) activation
 Engine 104
 Engine 111 up to M.Y. 1997

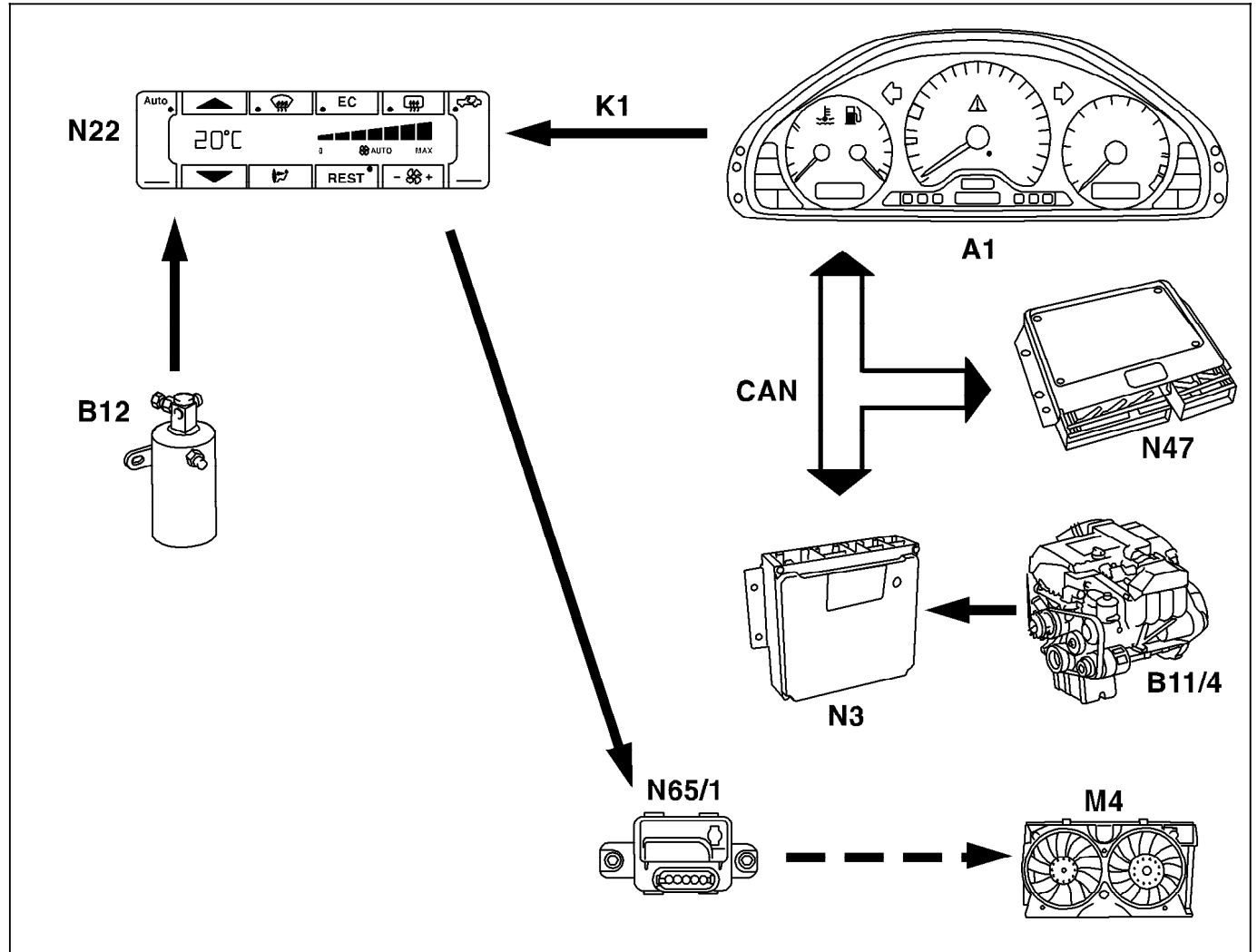

Figure 5

- A1 Instrument cluster
- B11/4 ECT sensor (DIFI, IFI)
- B12 Refrigerant pressure sensor
- M4 Auxiliary fan
- N3 CFI control module
- N22 A/C pushbutton control module
- N47 Traction systems control module
- N65/1 AIR control module

P83.40-2086-06

Electrical Test Program – Connection of Components

Model 202
 Connection of components for
 Auxiliary fan (M4) activation
 Engine 104
 Engine 111 up to M.Y. 1997

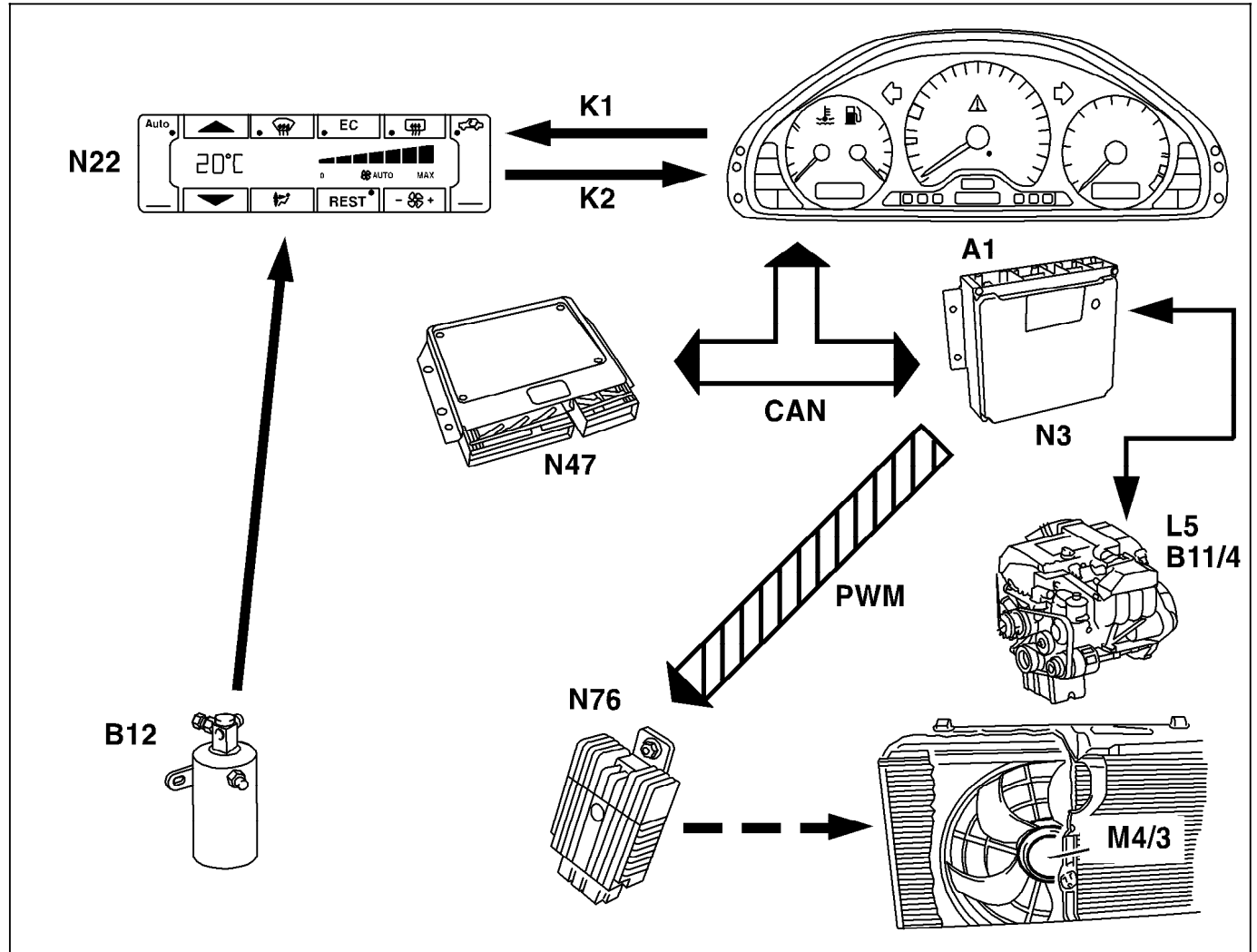

Figure 6

- A1 Instrument cluster
- B11/4 ECT sensor (DIFI, IFI)
- B12 Refrigerant pressure sensor
- M4/3 Engine climate control electric cooling fan
- N3 CFI control module
- N22 A/C pushbutton control module
- N47 Traction systems control module
- N76 Engine/climate control electric cooling fan control module

P83.40-2087-06

Electrical Test Program – Connection of Components

Model 202
Connection of components for
Auxiliary fan (M4) activation
Engine 111 as of M.Y. 1998
Engine 112.920 as of M.Y. 1999

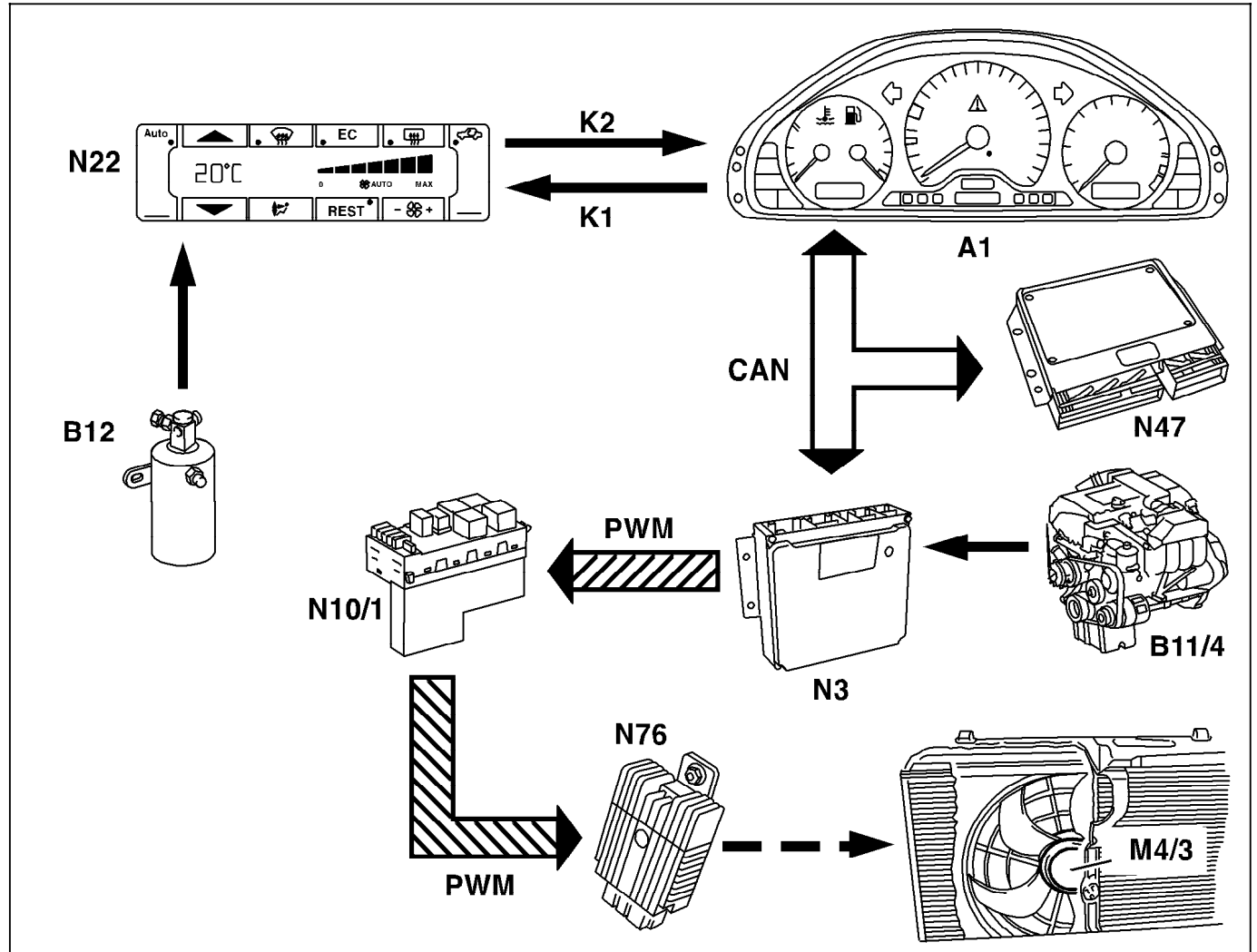

Figure 7

- A1 Instrument cluster
- B11/4 ECT sensor (DIFI, IFI)
- B12 Refrigerant pressure sensor
- M4/3 Engine climate control electric cooling fan
- N3 CFI control module
- N10/1 Signal pick-up and activation module (SAM) left front
- N22 A/C pushbutton control module
- N47 Traction systems control module
- N76 Engine/climate control electric cooling fan control module

P83.40-2088-06

Electrical Test Program – Connection of Components

Model 202
 Connection of components for
 temperature regulation
 Models 202, 208

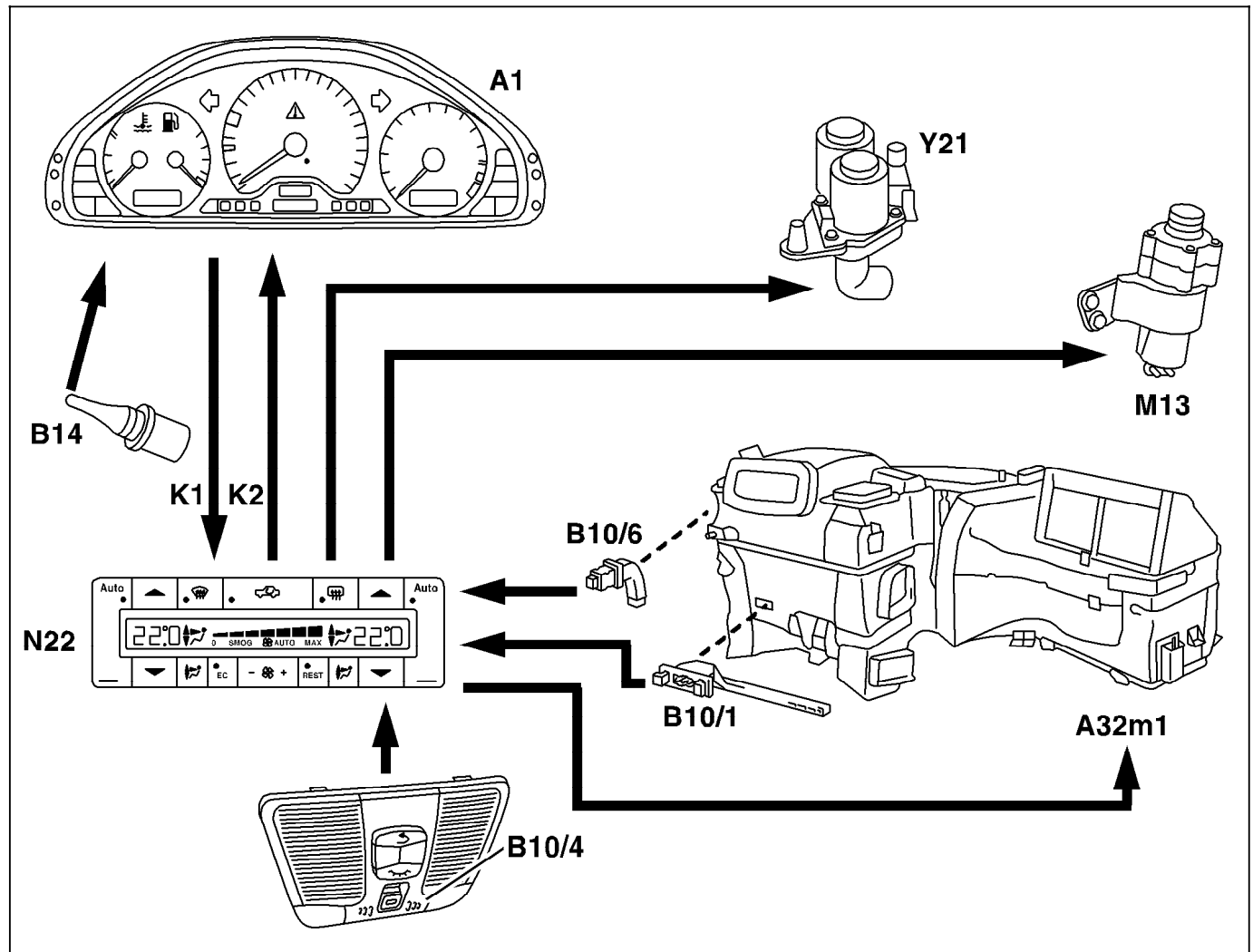

Figure 8

- A1 Instrument cluster
- A32m1 Blower motor
- B10/1 Heater core temperature sensor
- B10/4 In-car temperature sensor
- B10/6 Evaporator temperature sensor
- B14 Outside temperature indicator temperature sensor
- M13 Coolant circulation pump
- N3 CFI control module
- N19 A/C pushbutton control module
- Y21 Duovalve

P83.40-2078-06