

#### Hydraulic Test Program - Valve Assembly Internal Leakage Test

Preliminary work:  
Leveling valve pressure test ..... 34

#### Preparation for Test

1. Check oil level in oil reservoir, correct if necessary.
2. Unscrew connecting rod at front and rear leveling valve levers (set levers to neutral position).
3. Disconnect leak oil line of suspension struts at front axle and close steel line.
4. Check pressure supply screw (50a) for proper seating.
5. Disconnect return line (T) at oil reservoir.

#### Special Tools

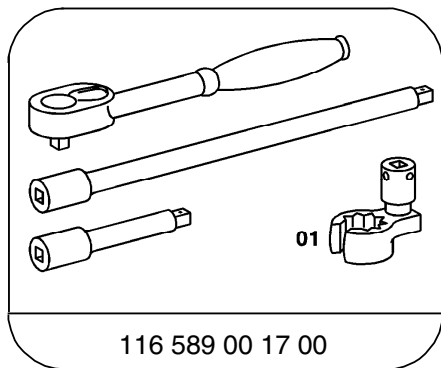

Box wrench

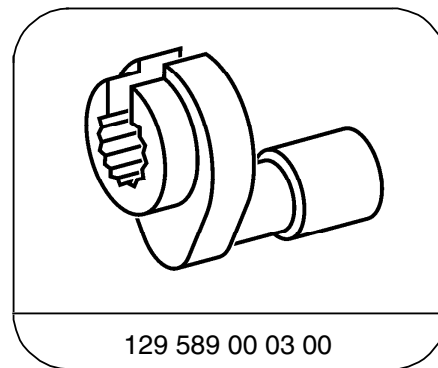

Box wrench

## Hydraulic Test Program - Valve Assembly Internal Leakage Test

### Component Locations

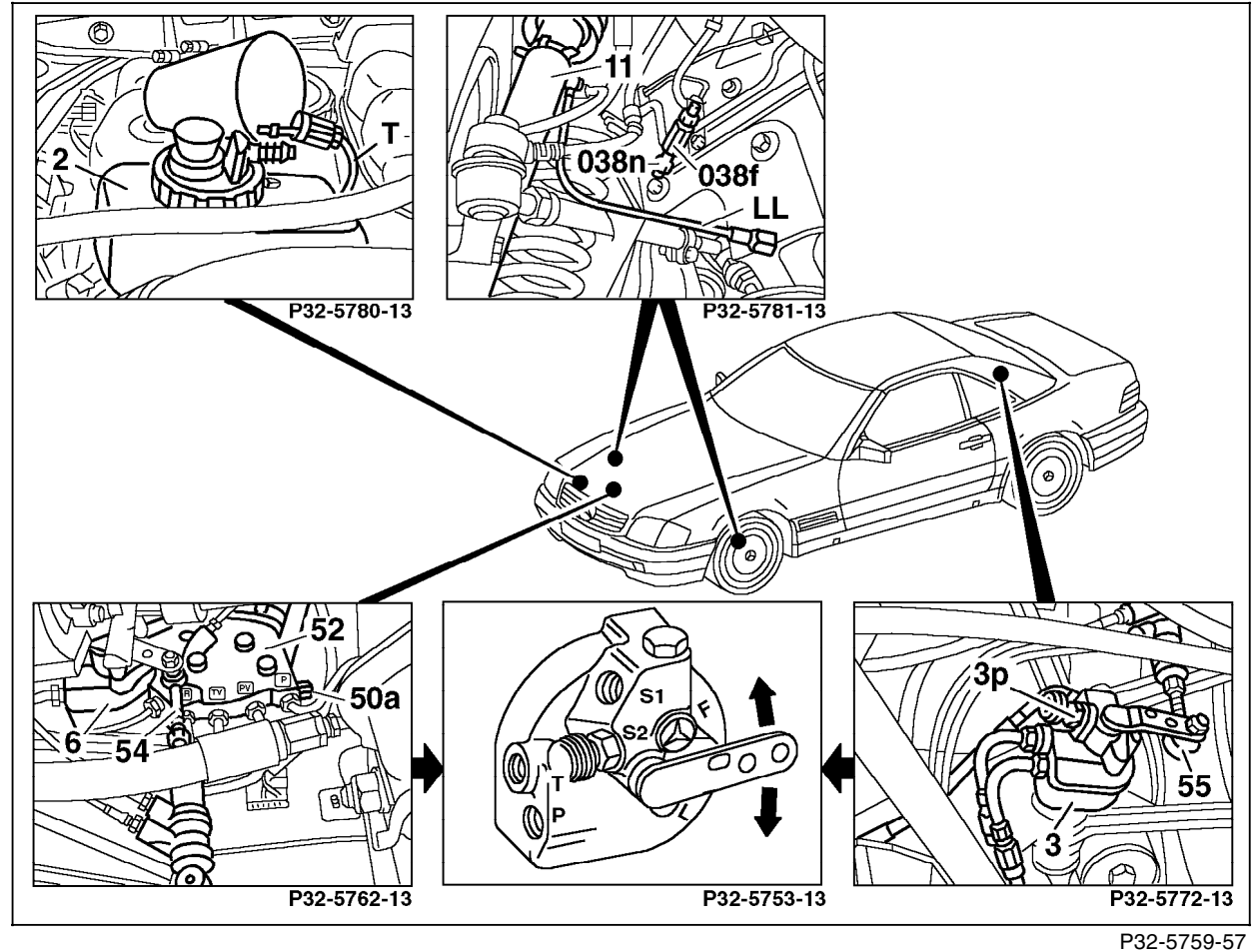

Figure 1

- 2 Hydraulic oil reservoir
- 3 Rear axle leveling valve
- 6 Front axle leveling valve
- 50a Pressure supply screw
- 54 Front axle connecting rod
- 55 Rear axle connecting rod
- LL Leak oil return line - left suspension strut, front axle distributor/valve unit
- T Return line - oil reservoir distributor/valve unit
- 038f Coupling (from hydraulic kit)
- 038n Vent screw (from hydraulic kit)

Hydraulic Test Program - Valve Assembly Internal Leakage Test

Test step	Test scope	Test connection	Test condition	Nominal value	Possible cause/Remedy
⇒ 1.0	<b>Valve assembly internal leakage</b>	—	<p>Engine: <b>at Idle</b>                      Set front axle leveling valve lever to “F” (fill).                      Then move leveling valve lever to center position.</p> <p>Set rear axle leveling valve lever to “F” (fill).                      Then move leveling valve lever to center position.</p> <p>Engine: <b>OFF</b>                      Wait at least two minutes (allows valves to close).</p> <p>Move both leveling valve levers to “L” (empty).</p>	<p>Vehicle must raise at front axle.</p> <p>Vehicle must raise at rear axle.</p>	<p>Replace distributor valve or valve assembly.</p> <p>Replace distributor valve or valve assembly.</p>
	Leak oil discharge	—	<p>Disconnect return line (T) at reservoir. Attach drain hose and place into measuring container.</p>	<p>Vehicle must not lower.</p> <p>Maximum of 2 cc oil discharge in four hours.</p>	<p>36</p> <p>Replace distributor valve or valve assembly.</p>