

3.4 Adaptive Damping System (ADS II) with electronic level control

Hydraulic Test Program – Hydraulic Oil Pump Test

Preparation for Test

1. Depressurize rear axle hydraulic system by slowly opening bleeder screw (57a).
2. Connect test gauge (038) with hose (038e) to rear axle distribution fitting (57) in place of bleed screw (57a).
3. Check oil level in oil reservoir, correct if necessary.



To perform this test, the oil fill quantity must be increased by 0.5 liters. If the oil reservoir was empty, the hydraulic oil pump must first be bled by disconnecting the high pressure flexible hose at the steel line. Run the engine and hold the hose into a container until the oil exits free of bubbles.

4. Connect HHT (refer to section 0).
5. Disconnect return line (T) at oil reservoir (2) and using a suitable hose (061), hold it in a measuring glass.



Monitor oil level during testing, air **must not** be allowed to enter the system through the hydraulic pump.

Special Tools

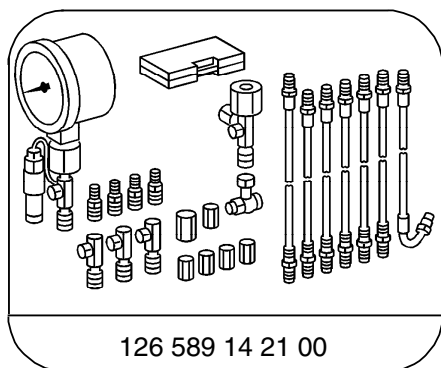

Tester

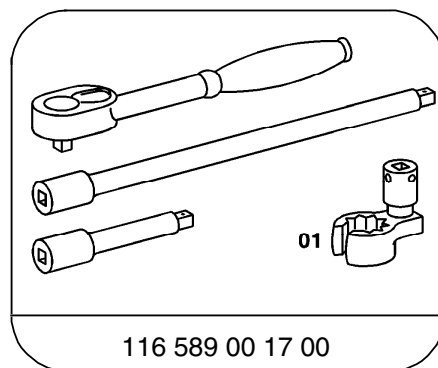

Box wrench

3.4 Adaptive Damping System (ADS II) with electronic level control

Hydraulic Test Program – Hydraulic Oil Pump Test

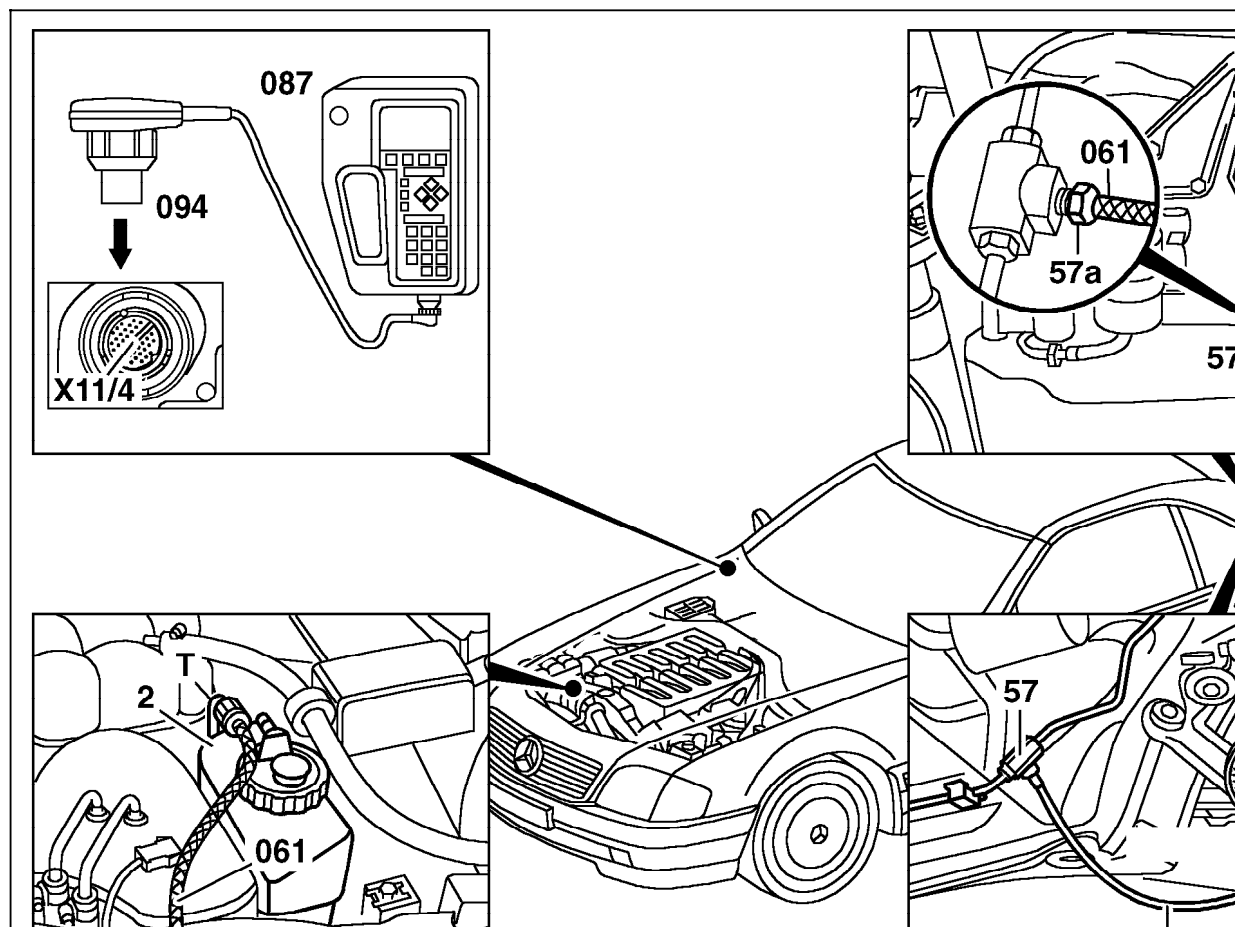



Figure 1

- 2 Hydraulic oil reservoir
- 038 Test gauge
- 038e Hydraulic test hose
- 57 Distribution fitting
- 57a Bleed screw
- 061 Bleed hose
- 087 HHT
- 094 Multiplexer test cable 965 589 00 40
- X11/4 Data link connector

P32.31-0243-06

3.4 Adaptive Damping System (ADS II) with electronic level control

Hydraulic Test Program - Hydraulic Oil Pump Test

⇒		Test scope	Test connection	Test condition	Nominal value	Possible cause/Remedy
1.0		Hydraulic oil pump Delivery pressure  WARNING! High pressure	 250 bar at rear axle distribution fitting.	Engine: at Idle . HHT activation: raise Observe test gauge needle until pressure no longer increases.	> 180 - 190 bar delivery capacity at idle > 0.2 l/min.	Delivery pressure < 180 bar, Delivery capacity < 0.2 l/min: Replace hydraulic oil pump Delivery pressure < 180 bar, Delivery capacity > 0.2 l/min: Replace leveling valve.