

3.4 Adaptive Damping System (ADS II) with electronic level control

Hydraulic Test Program – Leveling Valve Pressure Test

Preparation for Test

1. Depressurize rear axle hydraulic system by slowly opening bleed screw (57a).
2. Connect test gauge (038) with hose (038e) to distribution fitting (57) in place of bleed screw (57a).
3. Check oil level in oil reservoir, correct if necessary.
4. Connect HHT (refer to section 0).



Monitor oil level during testing, air **must not** be allowed to enter the system through the hydraulic pump.

Special Tools

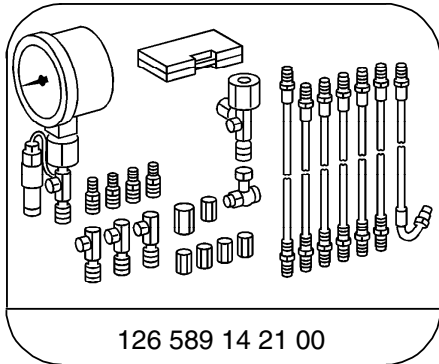

Tester

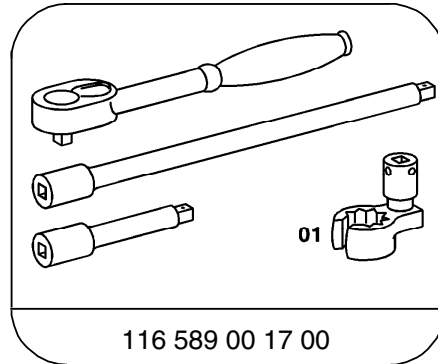

Box wrench

3.4 Adaptive Damping System (ADS II) with electronic level control

Hydraulic Test Program – Leveling Valve Pressure Test

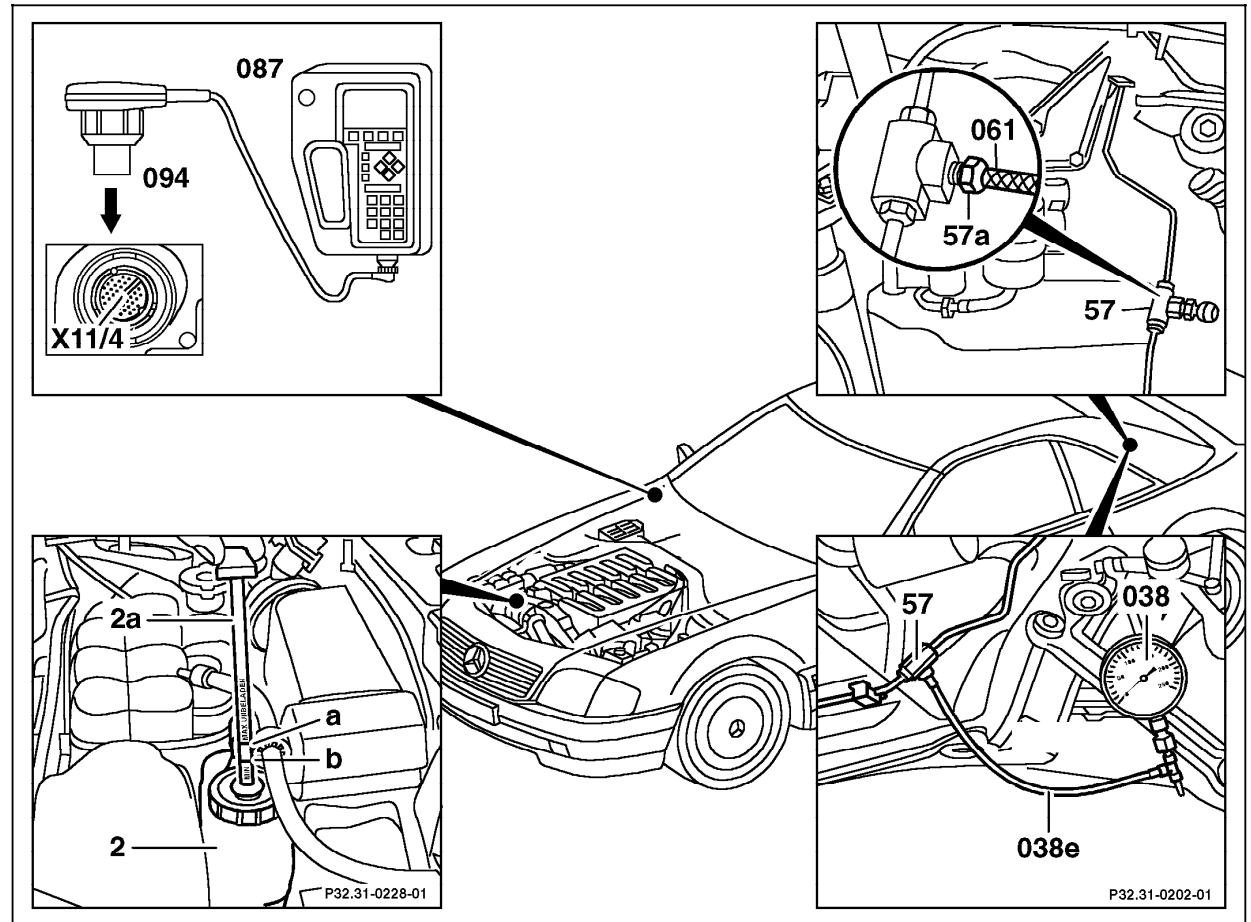



Figure 1

- 2 Hydraulic oil reservoir
- 2a Dipstick
- a Max. level
- b Min. level
- 57 Distribution fitting
- 57a Bleed screw
- 061 Bleed hose
- 087 HHT
- 094 Multiplexer test cable 965 589 00 40
- X11/4 Data link connector

P32.31-0246-06

3.4 Adaptive Damping System (ADS II) with electronic level control

Hydraulic Test Program – Leveling Valve Pressure Test

⇒		Test scope	Test connection	Test condition	Nominal value	Possible cause/Remedy
1.0		Leveling valve Opening pressure Relief valve Overflow valve	 250 bar at rear axle distribution fitting	Engine: at Idle HHT activation: raise HHT activation: lower (5 min)	180 - 190 bar 33-36 bar after 5 min.	Delivery pressure > 190 bar Replace leveling valve. Delivery pressure < 180 bar Hydraulic pump test 32. Replace leveling valve.