

6.2 Anti-lock Brake System (ABS)

Models 124.034, 129 (HFM-SFI only), 140

Electrical Test Program - Component Locations

Electrical Components in Engine Compartment and on Front Axle (shown on model 140)

Figure 1

- | | |
|-------|--|
| A7 | ABS hydraulic unit |
| F1 | Fuse for ABS control module (N30) in base module (N16/1) |
| L6/1 | Left front axle vehicle speed sensor |
| L6/2 | Right front axle vehicle speed sensor |
| N16/1 | Base module |
| N30 | ABS control module |
| X11/4 | Data link connector (DTC readout) |
| Y61 | Master cylinder switchover valve (ABS) |

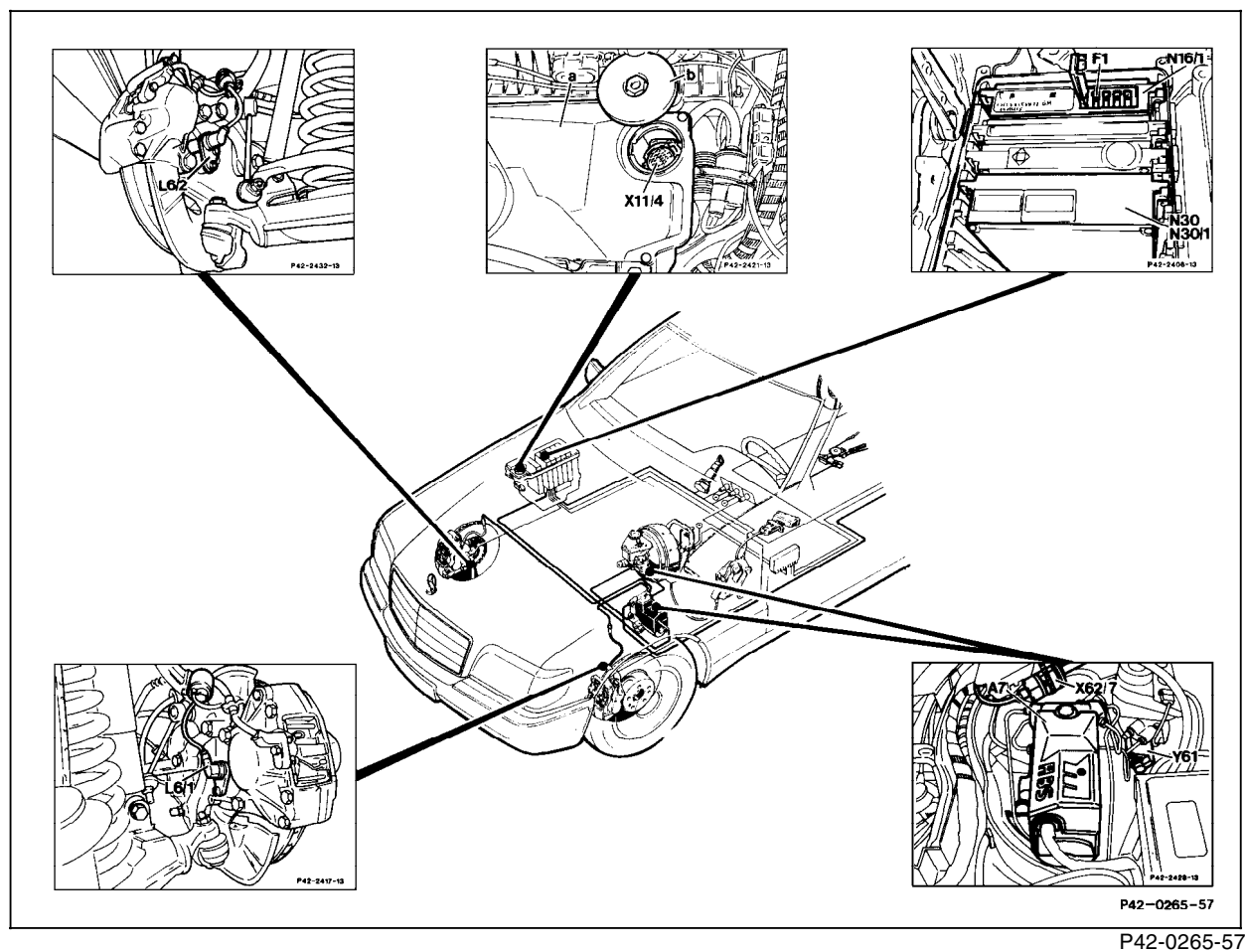

6.2 Anti-lock Brake System (ABS)

Models 124.034, 129 (HFM-SFI only), 140

Electrical Test Program - Component Locations

Electrical Components in Passenger Compartment and on Rear Axle (shown on model 140)

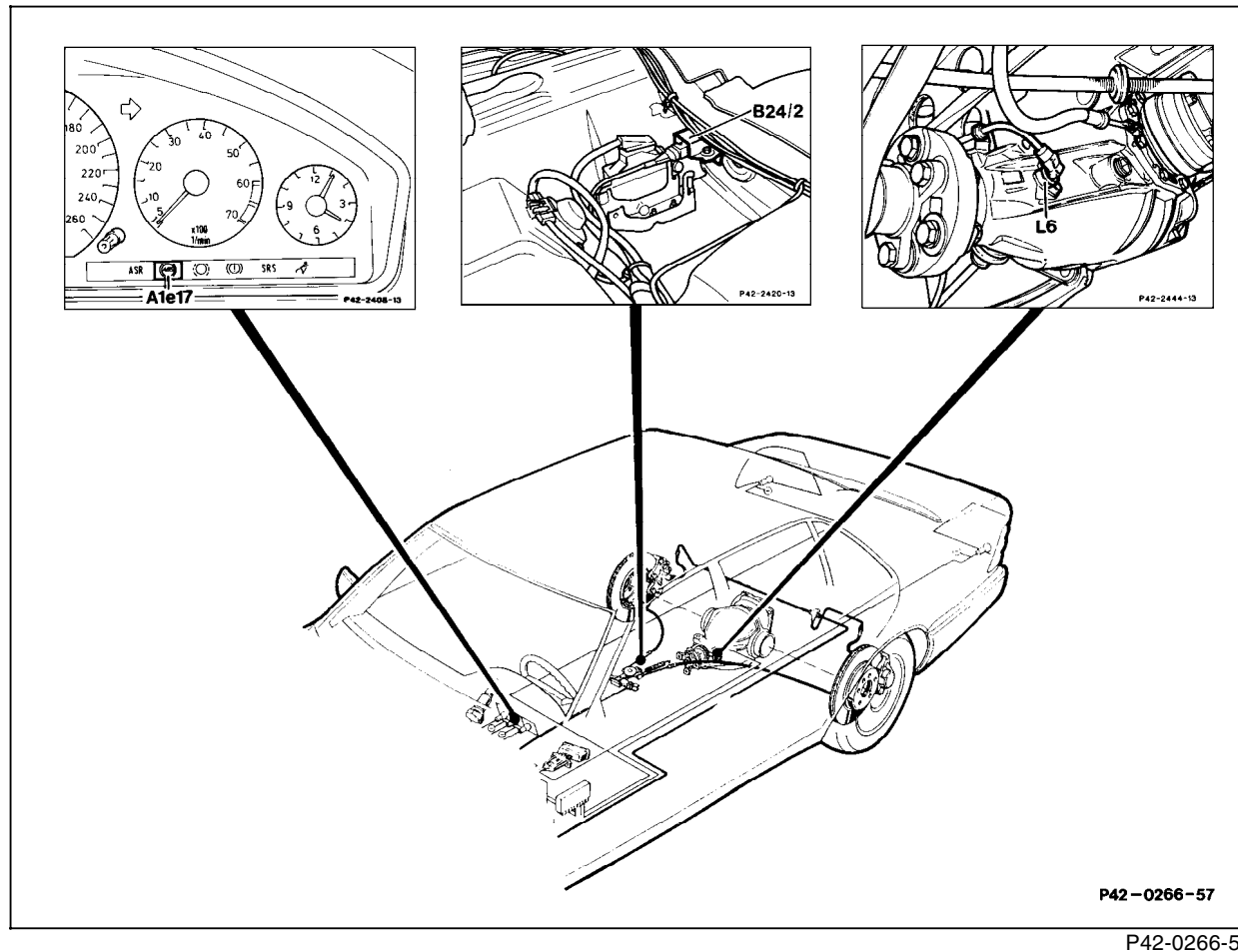

Figure 2

A1e17	ABS malfunction indicator lamp
B24/2	ABS lateral acceleration sensor
L6	Rear axle vehicle speed sensor