

Electrical Test Program - Component Locations

Model 140

Note:

For SPS control module (N49/1) layout on model 140 with engine 120 or California version engines 104/119, refer to 23, Figure 5.

Figure 1

- 1 Steering gear
- L2 **Model 140.0 (LH-SFI) up to 05/93 and 140.1 (diesel) up to 01/93**
Transmission inductive speed sensor
- L6 **Model 140 (LH-SFI) with ABS up to 05/93 1)**
Rear axle vehicle speed sensor (location, see 23, Figure 4)
- L6/3 **Model 140 (LH-SFI) with ASR up to 05/93 1)**
Left rear axle vehicle speed sensor
- L6/4 **Model 140 (LH-SFI) with ASR up to 05/93 1)**
Right rear axle vehicle speed sensor
- N16/1 Base module
- F3 Fuse box (35-fuse, in fuse and relay box F1)
- N49/1 SPS control module
- X11/4 Data link connector (38-pole)
- Y10 SPS P-valve

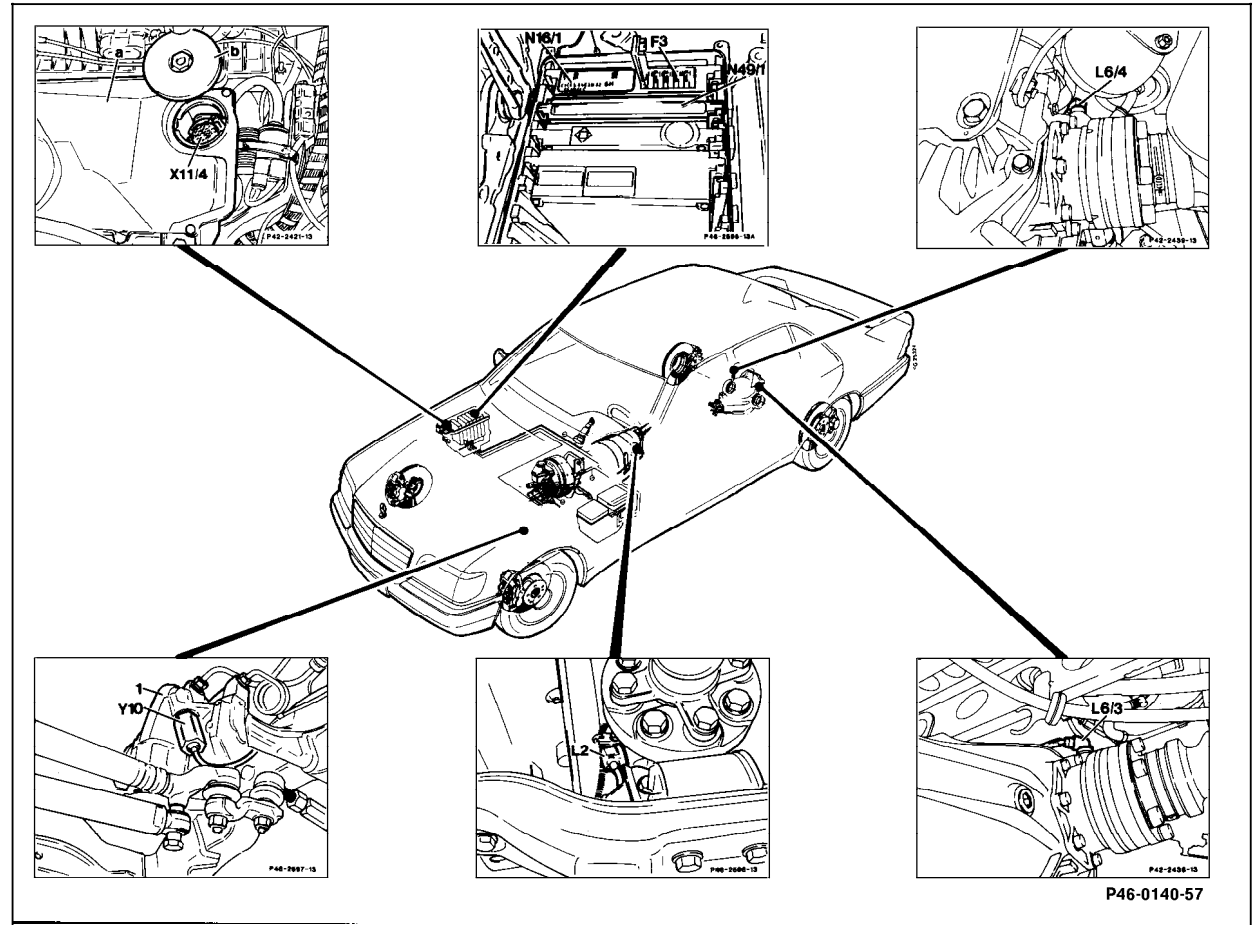

P46-0140-57

P46-0140-57

1) As of 06/93, signal is obtained from ABS or ABS/ASR control module. Sensors remain installed.