

Electrical Test Program - Component Locations

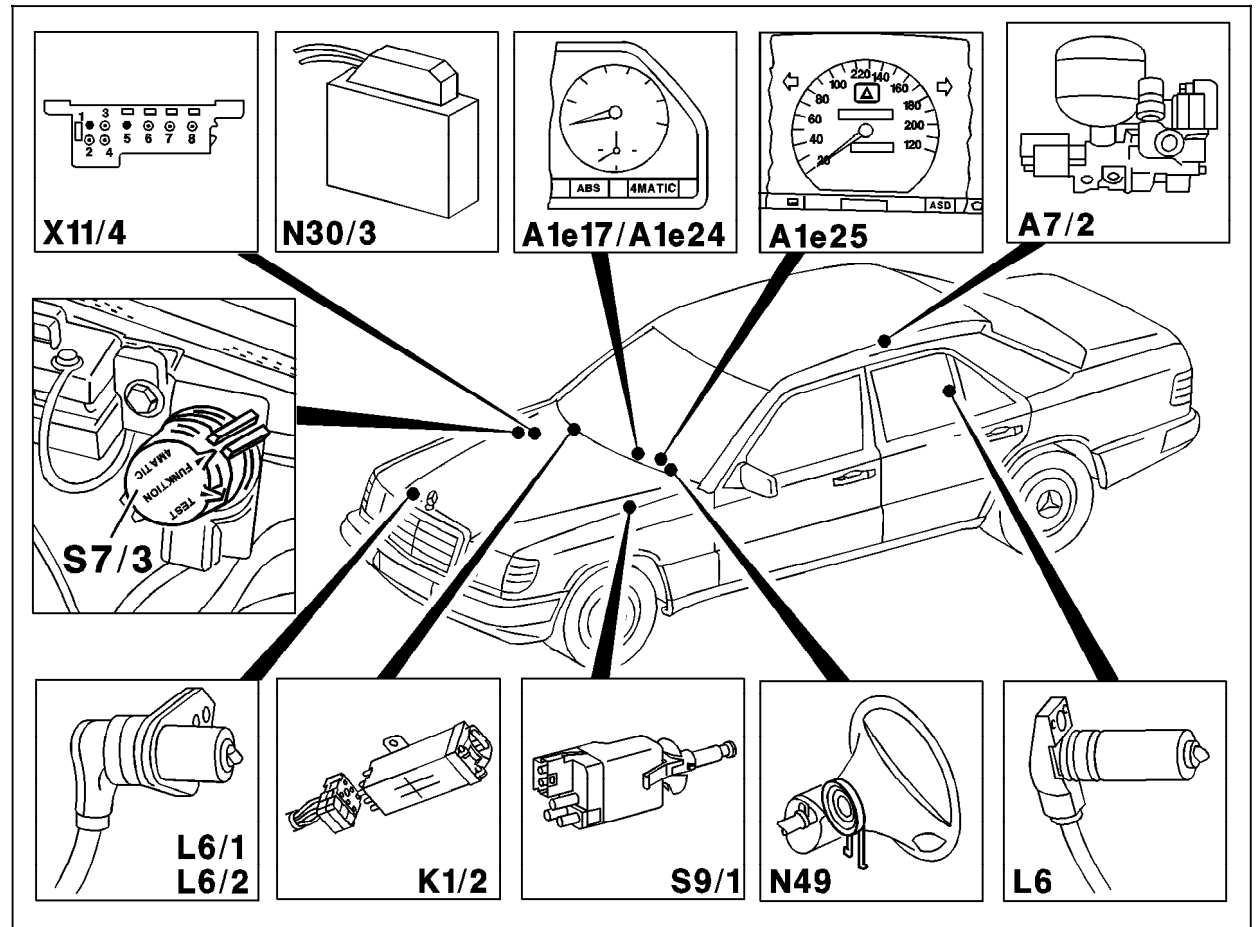

Figure 1

- A1e17    ABS MIL
- A1e24    4MATIC MIL
- A1e25    4MATIC function indicator lamp
- A7/2     4MATIC hydraulic unit
- K1/2     Overvoltage protection relay module  
(87E/87L/30a, 9-pole)
- L6        Rear axle VSS sensor
- L6/1     Left front axle VSS sensor
- L6/2     Right front axle VSS sensor
- N30/3    4MATIC control module
- N49      Steering angle sensor
- S7/3     4MATIC function/test selection switch
- S9/1     Stop lamp switch (4-pole)
- X11/4    Data link connector (16-pole)

P28-5045-57