

Electrical Test Program - Component Locations

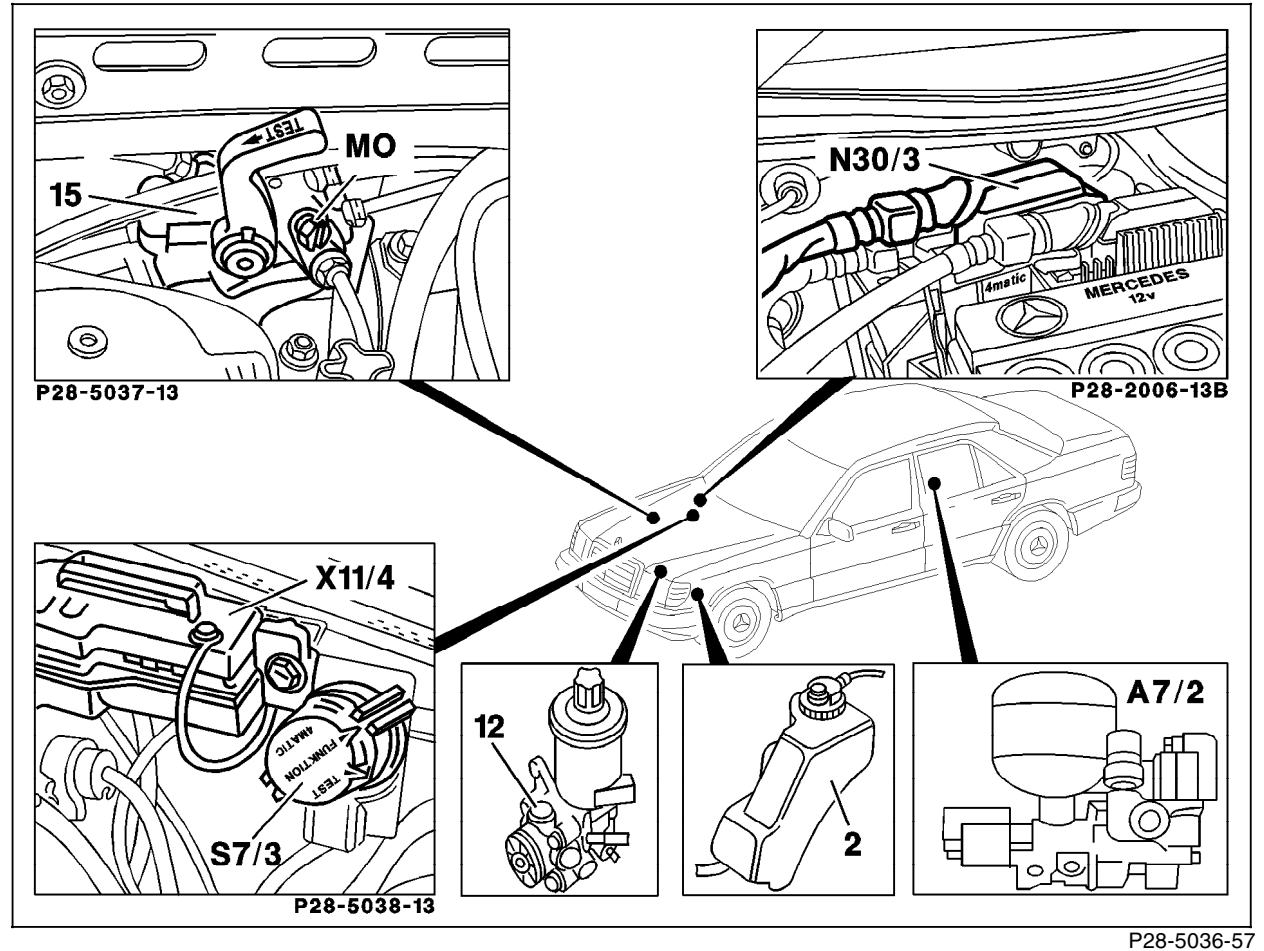

Figure 1

- 2 Oil reservoir
- 12 Oil supply pump
- 15 Service valve (up to 04/91)
- A7/2 4MATIC hydraulic unit
- N30/3 4MATIC control module
- S7/3 4MATIC function/test selection switch
- X11/4 Data link connector (16-pole)