

B 6 Fuel Pump Test

Operation No. of Text Description and Time Allowance 07-5701

Test Steps

- 1

Test equipment

connect/disconnect according to connection diagram.
- 2.1

Fuel line (70/6) on fuel filter and on electrohydraulic shut off actuator (Y1/1)

disconnect and connect test line (A) between fuel filter and electrohydraulic shut-off actuator (Y1/1).  
Place end of test line into measuring glass and check fuel quantity (see Test and Adjustment Data, section A).
- 3

Engine running at **CTP**

measure over flow quantity after 30 seconds
- 4

Delivery quantity

check (see Test and Adjustment Data, section A).

 For quick bleeding of the fuel injection system, plug end of test line until engine runs.

## B 6 Fuel Pump Test

### Connection Diagram – Test Equipment Engine 606.912 IFI

Figure 1

- |       |   |
|-------|---|
| 001   | Digital tester                                    |
| 015   | Test cable with plug                              |
| 016   | Diagnostic socket                                 |
| 021   | TDC impulse sensor                                |
| 041   | Stop watch  |
| 70/2  | Fuel filter                                       |
| 70/6  | Fuel outlet to electrohydraulic shut-off actuator |
| A     | Test line   |
| B     | Measuring glass                                   |
| W3    | Ground (left front wheelhousing)                  |
| X12/3 | Terminal block (terminal 30)                      |
| Y1/1  | Electrohydraulic shut-off actuator                |

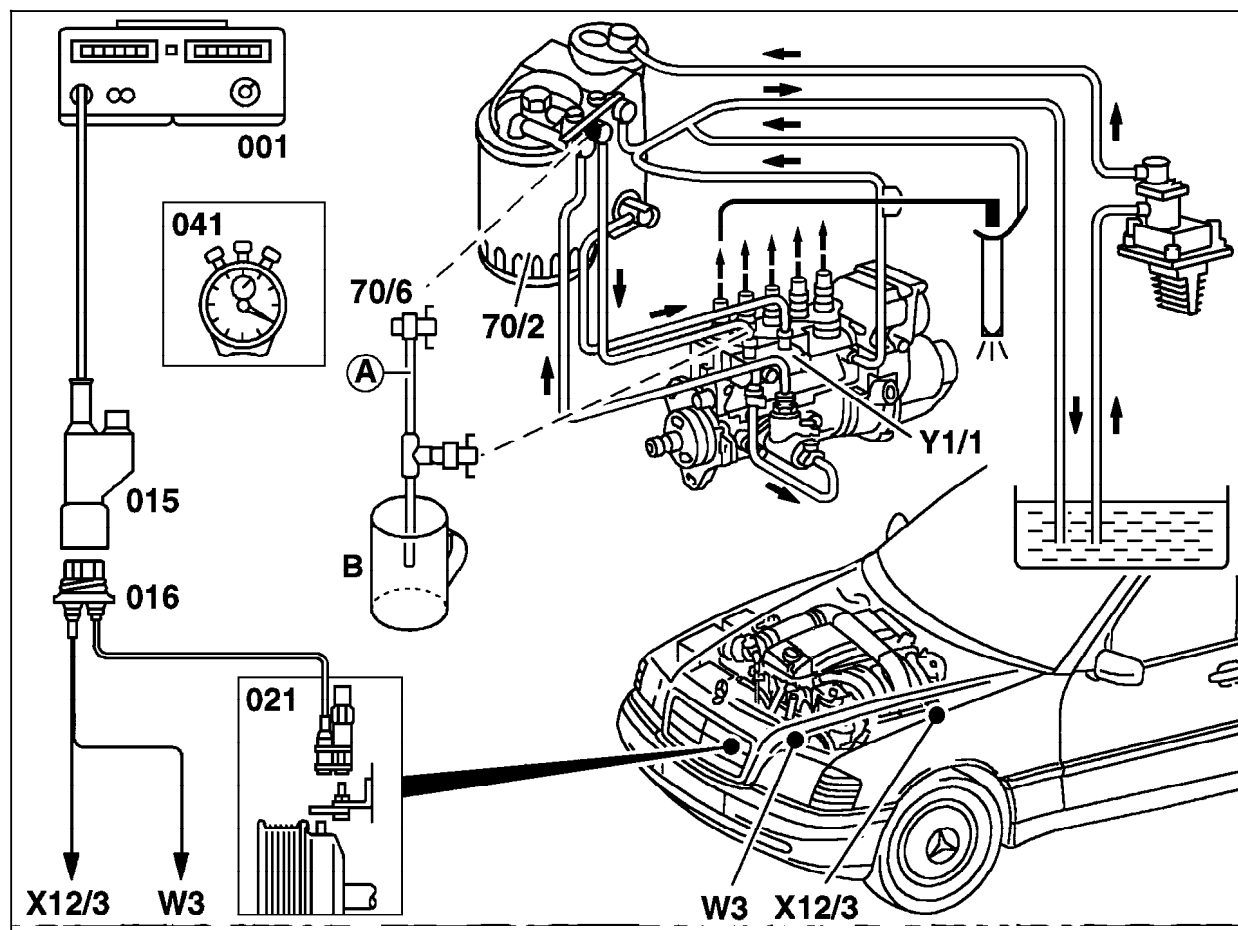

P07-6345-57

B 6

Fuel Pump Test

Special Tools

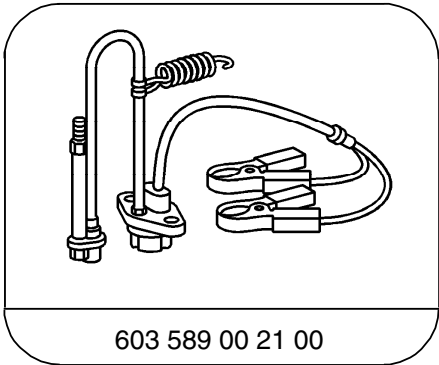

TDC sensor

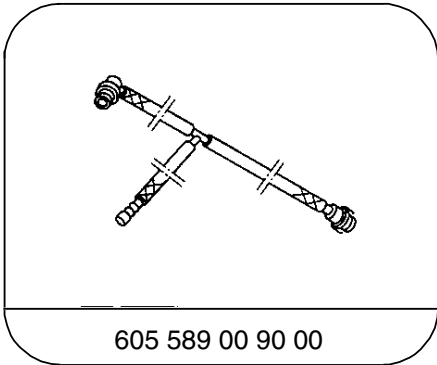

Test line

Conventional tools, test equipment

Description	Brand, model, etc.
Engine analyzer <sup>1)</sup>	Bear DACE
Measuring glass (at least 1 liter)	
Stop watch	

<sup>1)</sup> Available through the MBUSA Standard Equipment Program.