

B 7 Fuel Pressure Test

Operation No. of Text Description and Time Allowance 07-5702

Test Steps

- 1 Test line (A) on fuel filter upper part (70/2) and on electrohydraulic shut-off actuator (Y1/1) in place of fuel supply line disconnect, connect.
- 2 Pressure tester (054) on test line (A) connect, disconnect.
- 3 Fuel pressure check, (see Test and Adjustment Data, section A).

Note:

Air will enter the fuel injection system when connecting the pressure tester. After starting the engine, the fuel system will bleed itself automatically.

B 7 Fuel Pressure Test

Connection Diagram – Test Equipment
Engine 606.912 IFI

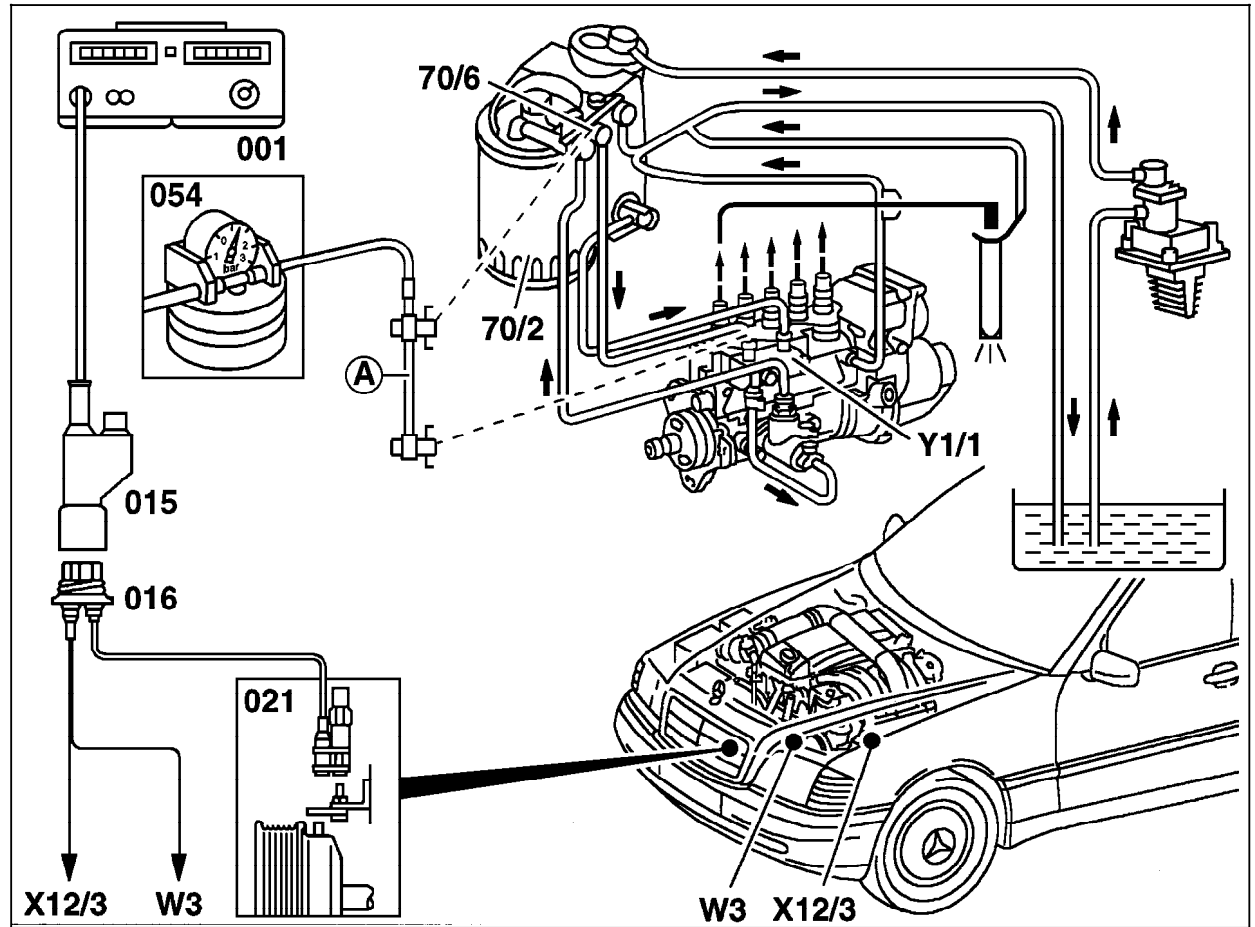

Figure 1

- 001 Digital tester
- 015 Test cable with plug
- 016 Diagnostic socket
- 021 TDC impulse sensor
- 054 Pressure tester
- 70/2 Fuel filter
- 70/6 Fuel outlet to electrohydraulic shut-off actuator
- A Test line
- W3 Ground (left front wheelhousing)
- X12/3 Terminal block (terminal 30)
- Y1/1 Electrohydraulic shut-off actuator

P07-6349-57

B 7 Fuel Pressure Test

Special Tools

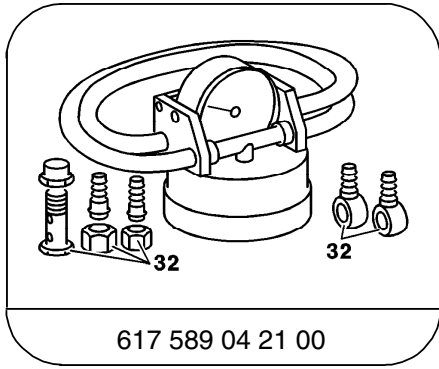

617 589 04 21 00

Tester

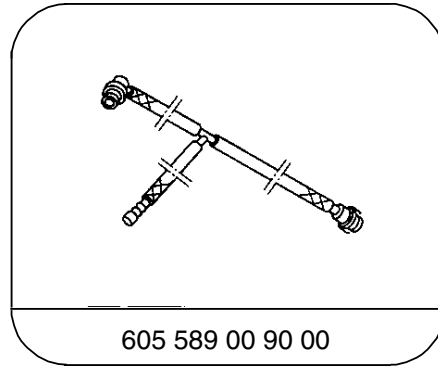

605 589 00 90 00

Test line