

Hydraulic Test Program – Preparation for Test (Testing Cold Start)

Preliminary work:

Testing starting system 34

Special Tools

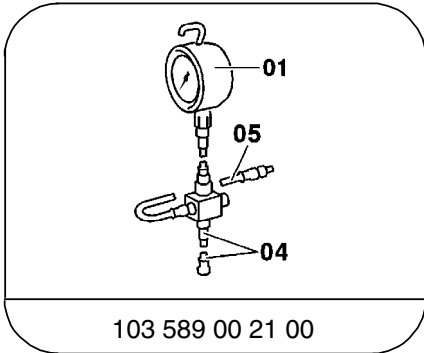

103 589 00 21 00

Tester

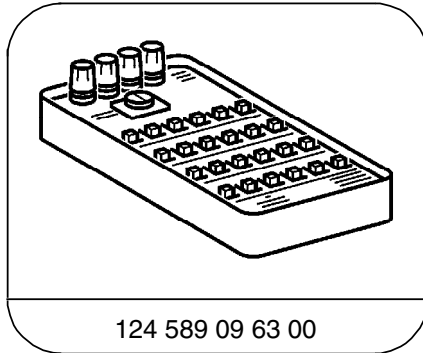

124 589 09 63 00

Ohm decade

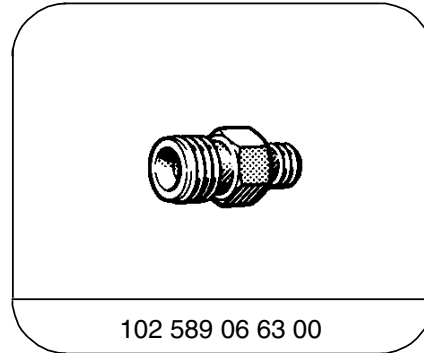

102 589 06 63 00

Double connection

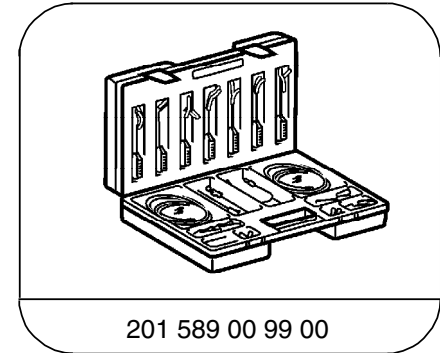

201 589 00 99 00

Electrical connecting set

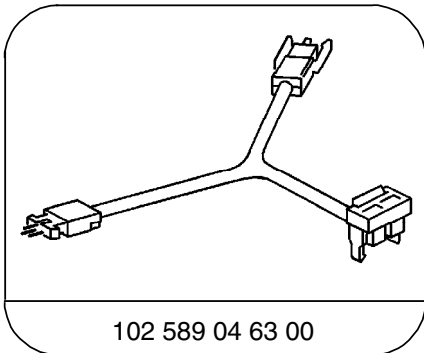

102 589 04 63 00

Test cable

Conventional tools, test equipment

Description	Brand, model, etc.
Multimeter ¹⁾	Fluke models 23, 83, 85, 87

¹⁾ Available through the MBUSA Standard Equipment Program.

Hydraulic Test Program – Preparation for Test (Testing Cold Start)

Connection diagram – Engine 104

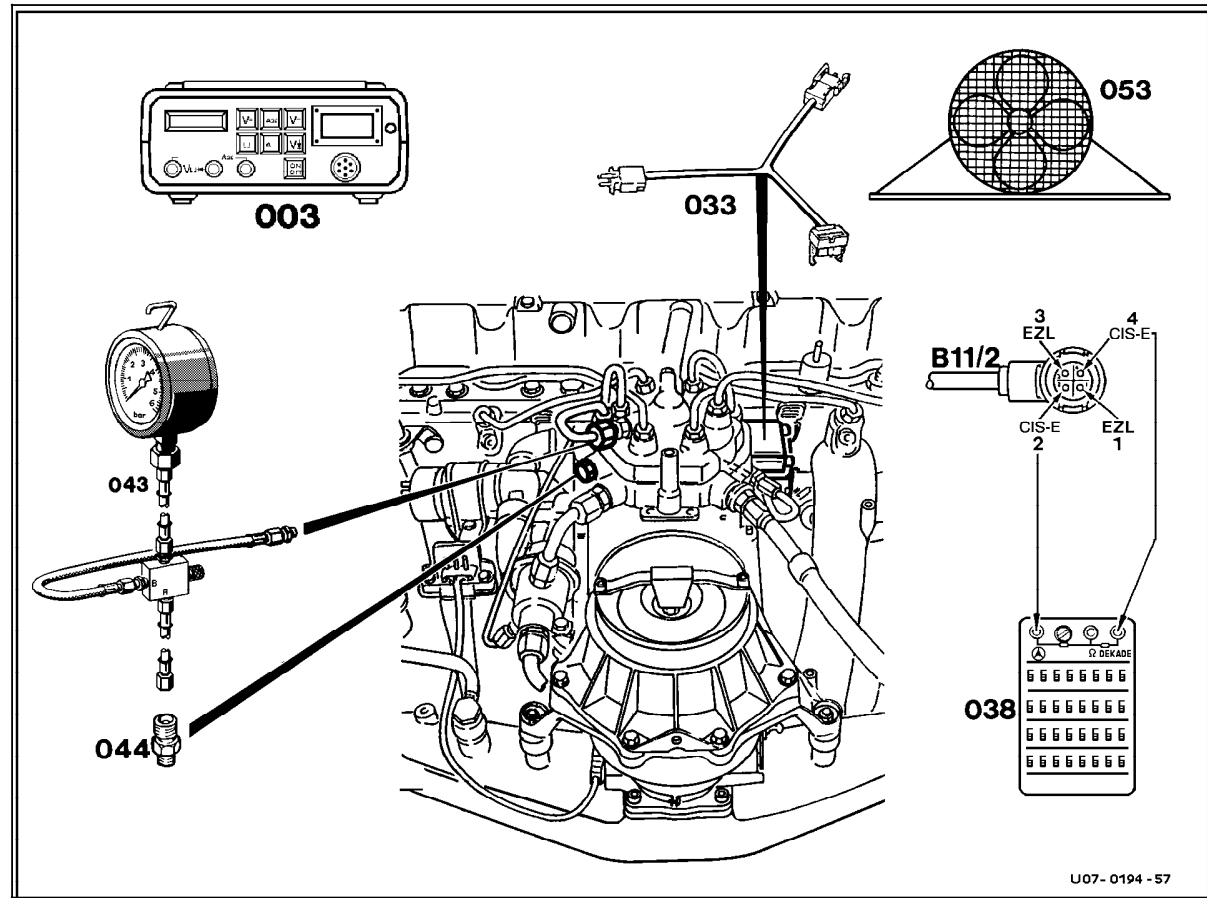

Figure 1

- 003 Multimeter
- 033 Test cable, part no. 102 589 04 63 00
- 038 Resistance substitution unit
- 043 Pressure gauge, part no. 103 589 00 21 00
- 044 Adaptor, part no. 102 589 06 63 00
- 053 Cooling fan
- B11/2 Connector, coolant temperature sensor

U07-0194-57

U07-0194-57

Hydraulic Test Program – Preparation for Test (Testing Cold Start)

Connection diagram – Engine 119

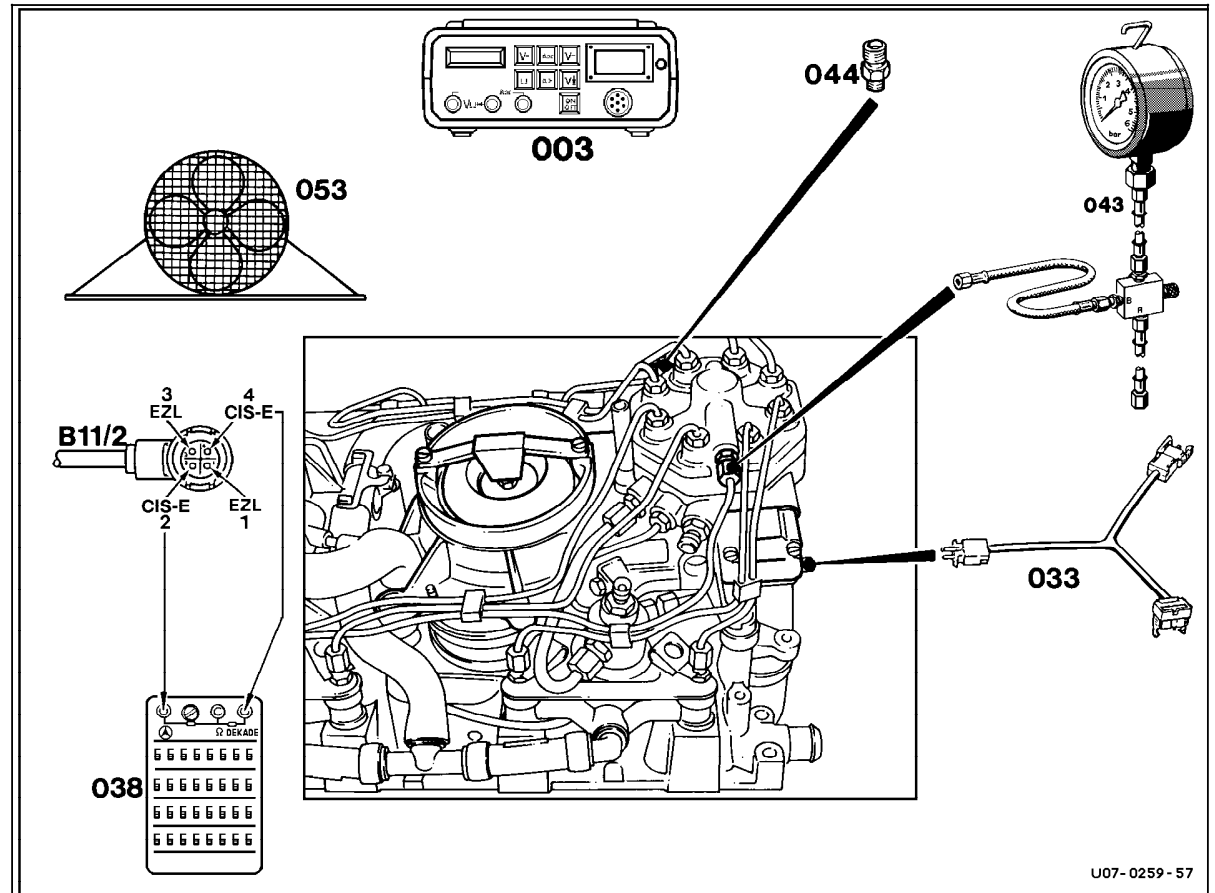

Figure 1

- 003 Multimeter
- 033 Test cable, part no. 102 589 04 63 00
- 038 Resistance substitution unit
- 043 Pressure gauge, part no. 103 589 00 21 00
- 044 Adaptor, part no. 102 589 06 63 00
- 053 Cooling fan
- B11/2 Connector, coolant temperature sensor

U07-0259-57

U07-0259-57