

## 5.1 Distributor Ignition System (DI)

Engines 104, 119 CFI

### Electrical Test Program - Component Locations

#### Engine 104 CFI

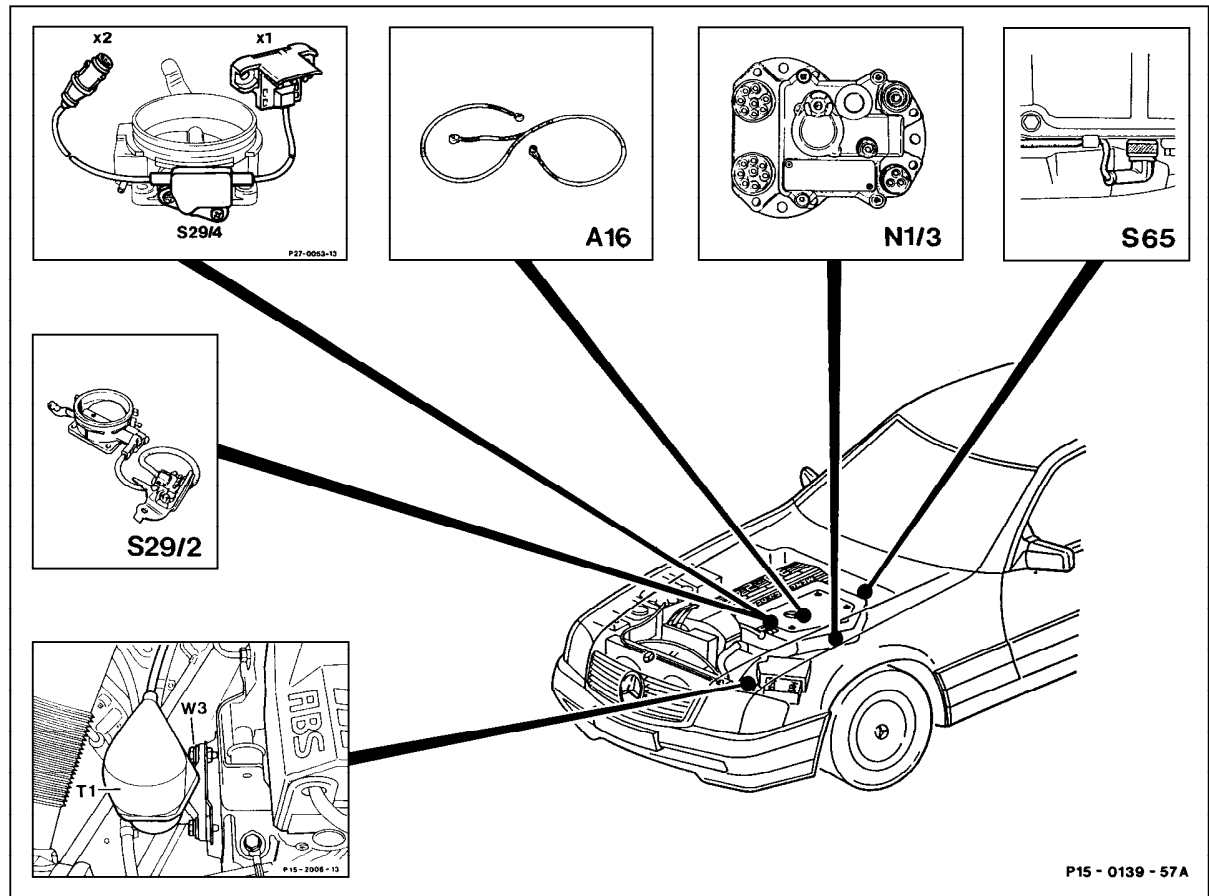

Figure 1

- A16 Knock sensors
- N1/3 Ignition control module
- S29/2 Wide open throttle/closed throttle position switch
- S29/4 Throttle body switch  
(5-speed automatic transmission)
- S29/4X1 Throttle valve potentiometer connector
- S29/4X2 Throttle position potentiometer connector
- S65 Transmission overload protection switch, brake  
band B1
- T1 Ignition coil

P15 - 0139 - 57A

P15-0139-57A

## 5.1 Distributor Ignition System (DI)

Engines 104, 119 CFI

### Electrical Test Program - Component Locations

#### Engine 104 CFI

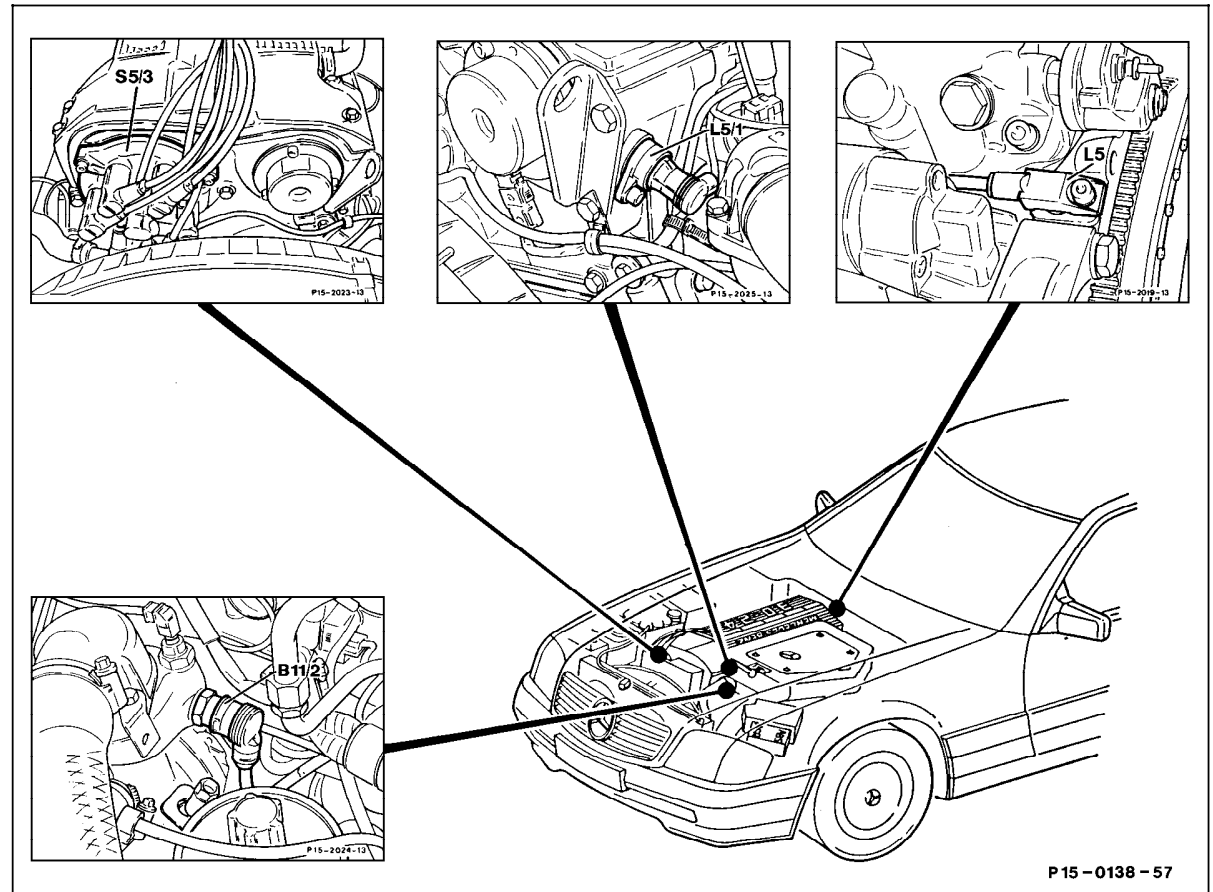

Figure 2

- |       |  |
|-------|--|
| B11/2 | Engine coolant temperature sensor (DI/CFI)(4-pole) |
| L5    | Crankshaft position sensor                         |
| L5/1  | Camshaft position sensor                           |
| S5/3  | High-voltage distributor                           |

P15-0138-57

## Electrical Test Program - Component Locations

### Engine 119 CFI

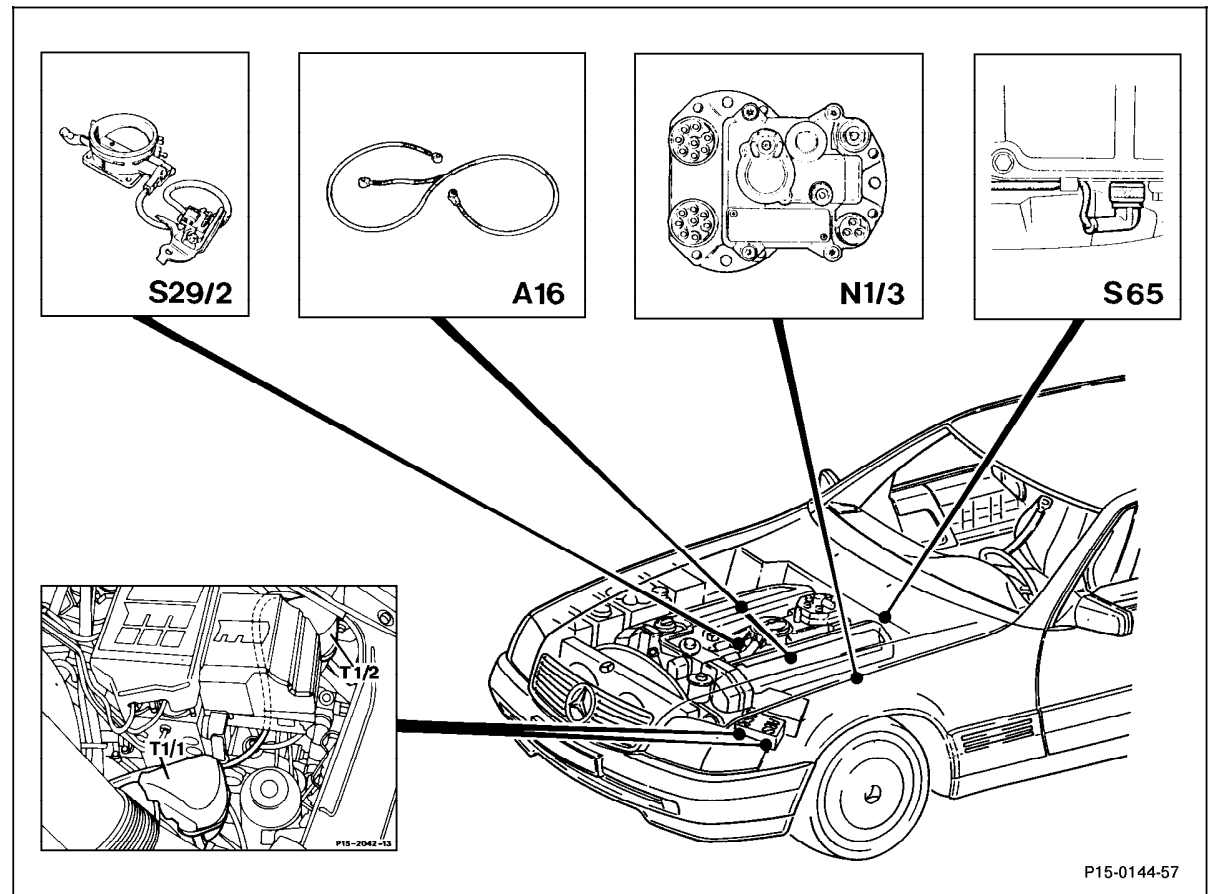

Figure 3

- A16 Knock sensors
- N1/3 Ignition control module
- S29/2 Wide open throttle/closed throttle position switch
- S65 Transmission overload protection switch, brake band B1
- T1/1 Ignition coil 1 (right cylinder bank)
- T1/2 Ignition coil 2 (left cylinder bank)

P15-0144-57

P15-0144-57

## Electrical Test Program - Component Locations

### Engine 119 CFI

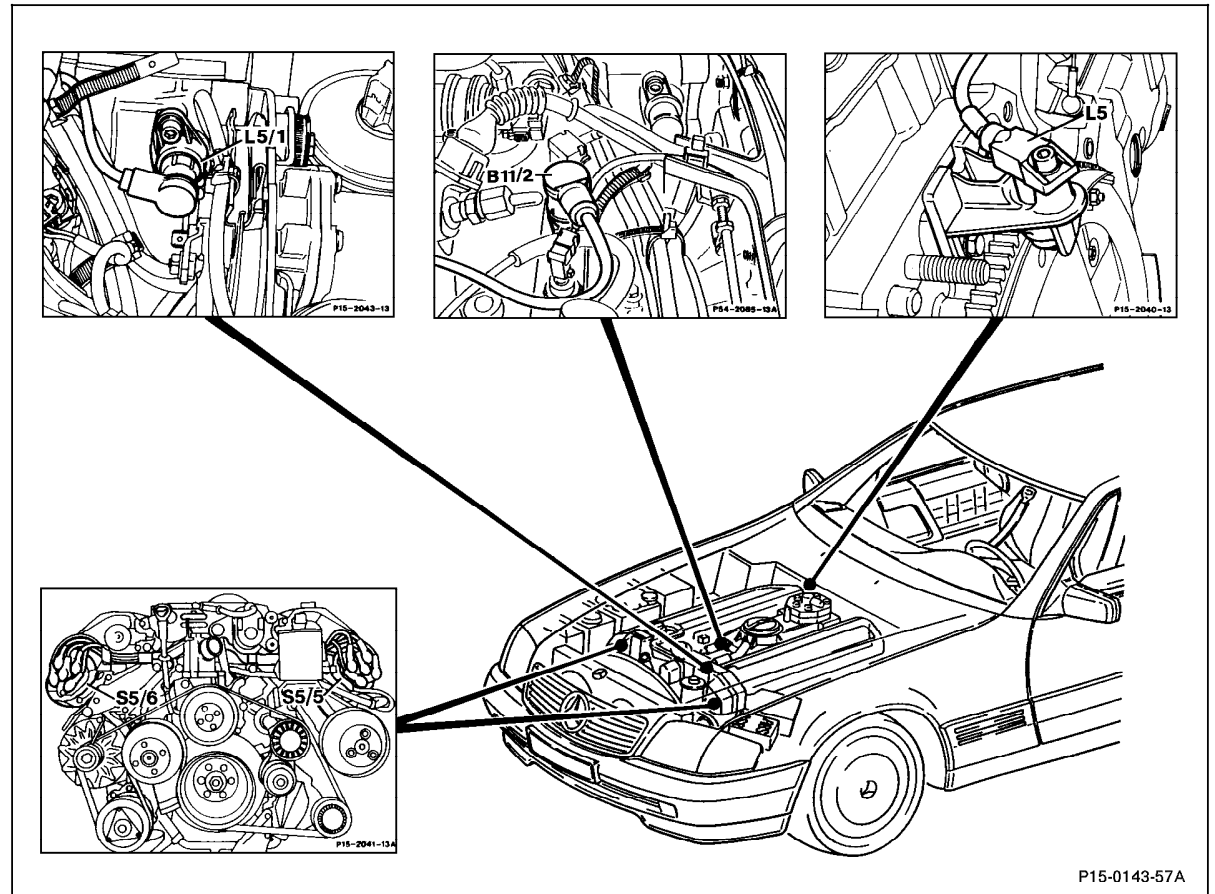

Figure 4

- B11/2 Engine coolant temperature sensor (DI/CFI)(4-pole)
- L5 Crankshaft position sensor
- L5/1 Camshaft position sensor
- S5/5 Left high-voltage distributor
- S5/6 Right high-voltage distributor

P15-0143-57A

P15-0143-57A