

Electrical Test Program - Component Locations

Engine 104, Model 140

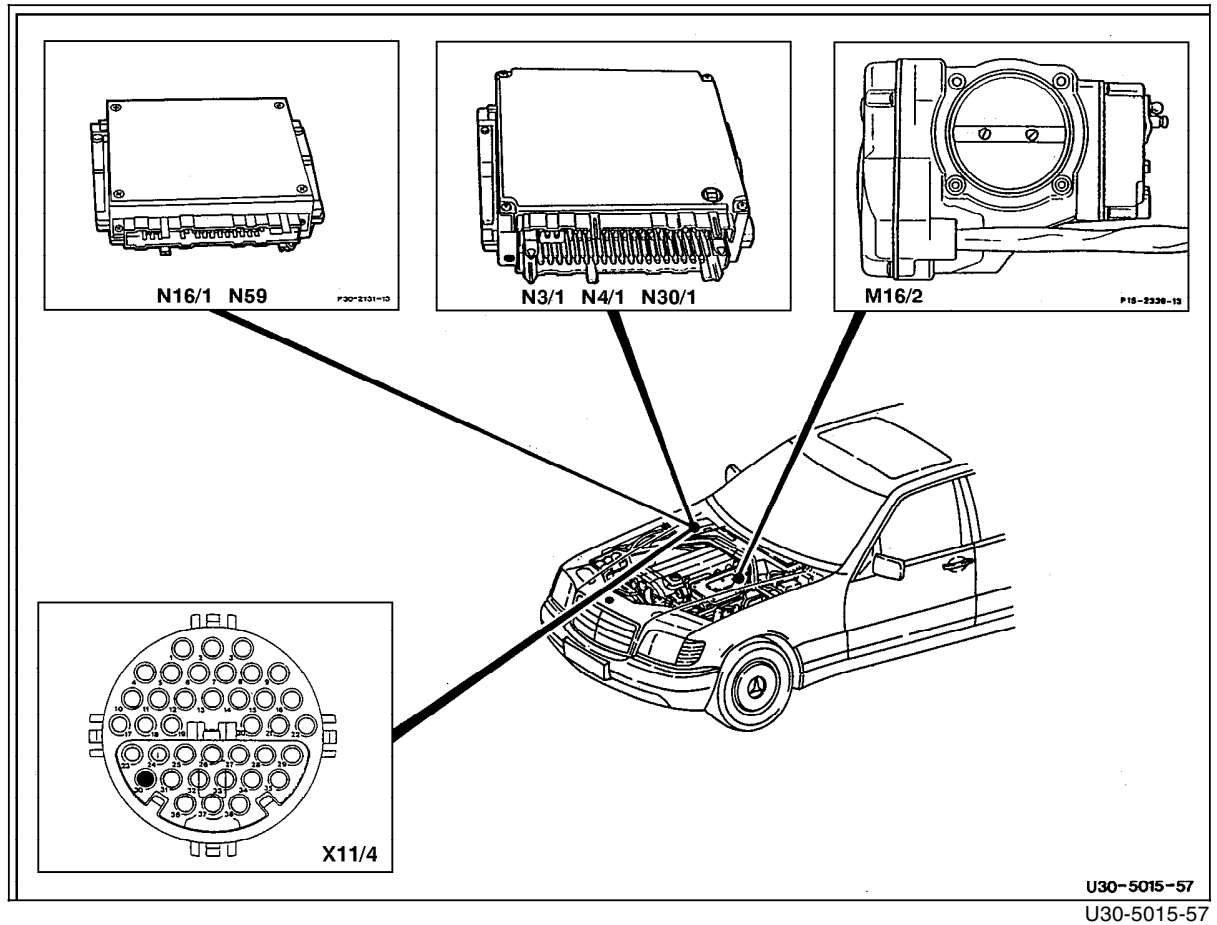

Figure 1

- M16/2 CC/ISC actuator
- N3/1 LH-SFI control module
- N4/3 CC/ISC control module
- N16/1 Base module
- N30 ABS control module
- N59 Diagnostic module (OBD I)
- X11/4 Data link connector (DTC readout) (38-pole)

Electrical Test Program - Component Locations

Engine 104, Model 140

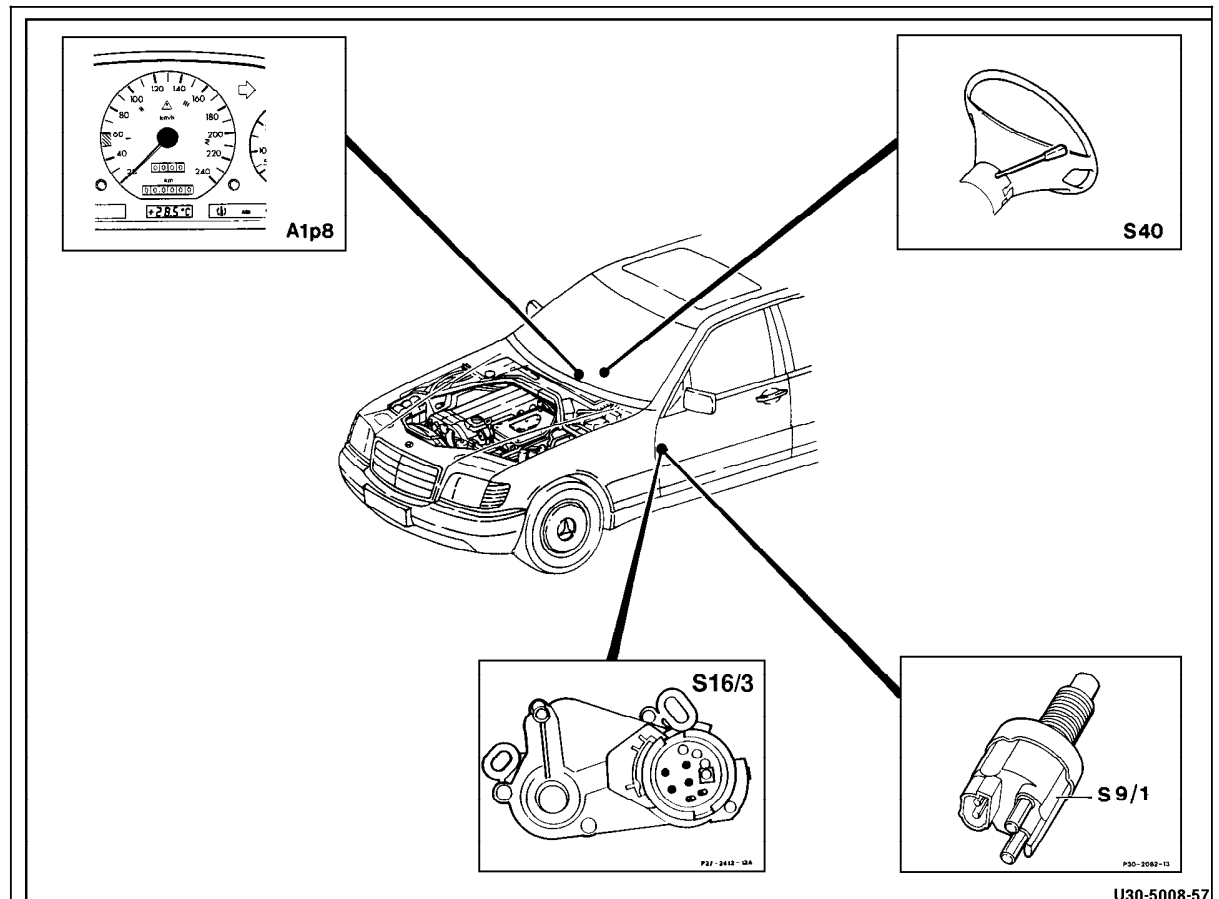

Figure 2

- A1p8 Electronic speedometer with top speed limitation
- S9/1 Stop lamp switch
- S16/3 Starter lock-out/backup lamp switch (transmission range recognition)
- S40 Cruise control switch
  - V Decelerate/set
  - B Accelerate/set
  - SP Resume
  - A Off

U30-5008-57  
U30-5008-57

Electrical Test Program - Component Locations

Engine 119, Models 124.034, 140

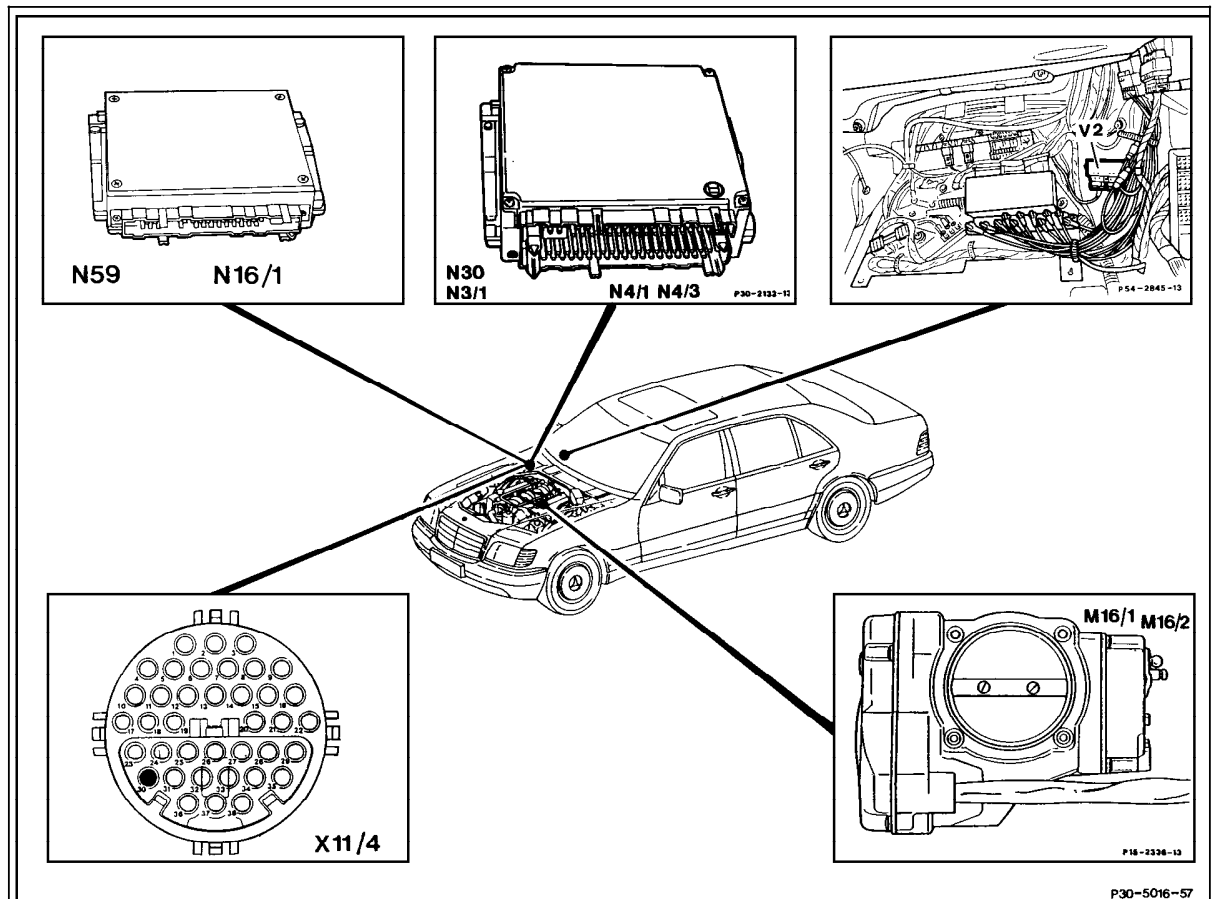

Figure 3

- M16/2 CC/ISC actuator
- N3/1 LH-SFI control module
- N4/3 CC/ISC control module
- N16/1 Base module
- N30 ABS control module
- N59 Diagnostic module (OBD I) (California)
- X11/4 Data link connector (DTC readout) (38-pole)
- V2 Engine rpm increase diode matrix (right footwell, model 140 with engine 119 only)

P30-5016-57  
P30-5016-57

Electrical Test Program - Component Locations

Engine 119, Models 124.034, 140

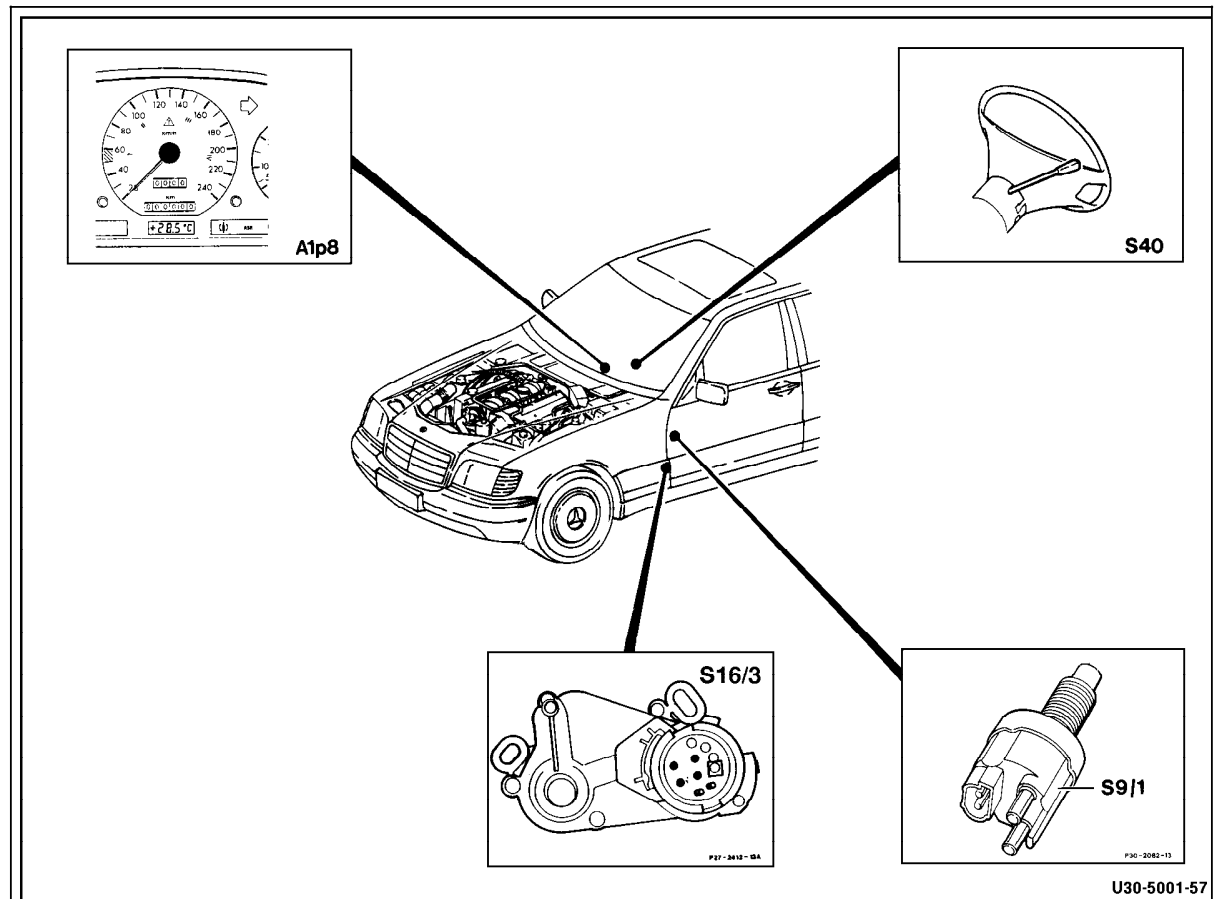

Figure 4

- A1p8 Electronic speedometer with top speed limitation
- S9/1 Stop lamp switch
- S16/3 Starter lock-out/backup lamp switch  
(transmission range recognition)
- S40 Cruise control switch
  - V Decelerate/set
  - B Accelerate/set
  - SP Resume
  - A Off