

Electrical Test Program – Component Locations

Components on engine
Model 129

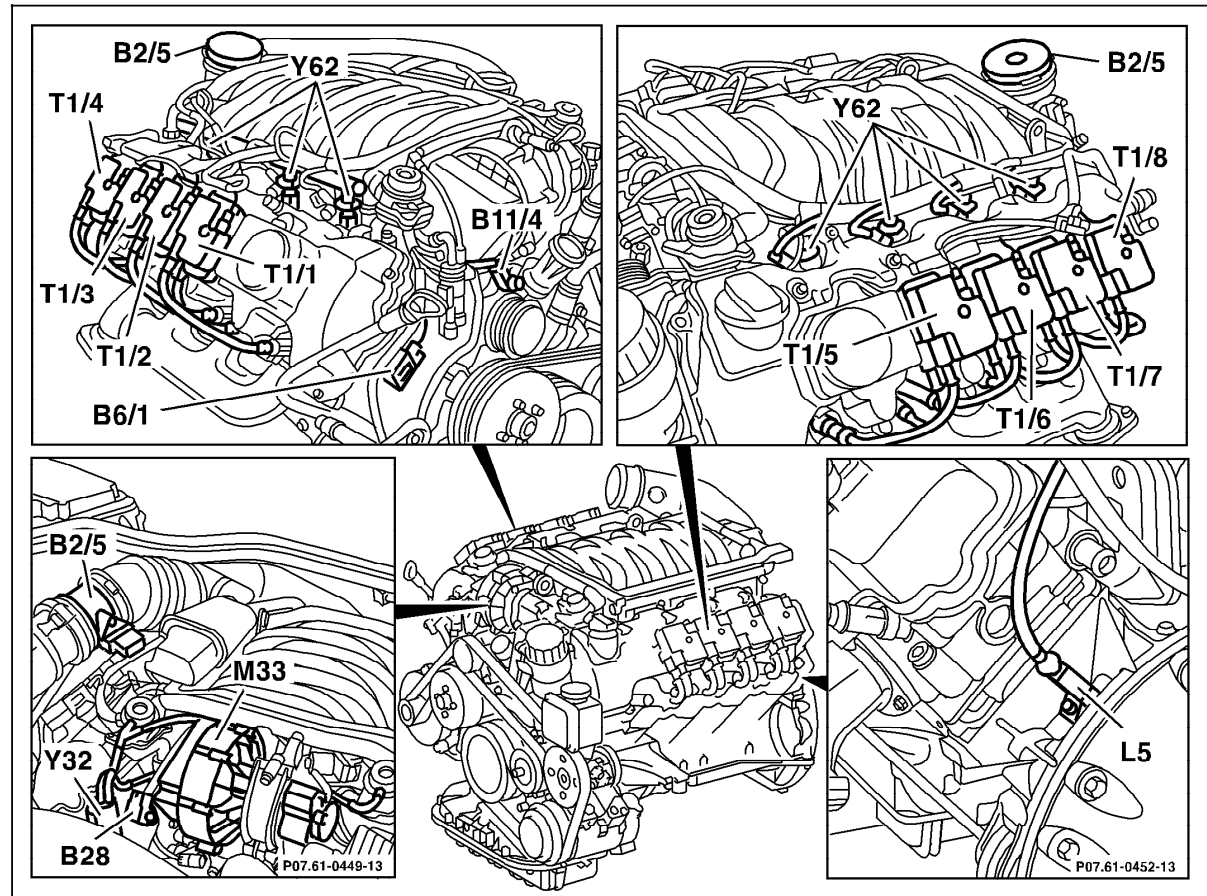

Figure 1

- B2/5 Hot film MAF sensor
- B6/1 Camshaft Hall-effect sensor
- B11/4 ECT sensor
- B28 Pressure sensor (only USA)
- L5 CKP sensor
- M33 AIR pump (only USA)
- T1/1 Ignition coil 1
- T1/2 Ignition coil 2
- T1/3 Ignition coil 3
- T1/4 Ignition coil 4
- T1/5 Ignition coil 5
- T1/6 Ignition coil 6
- T1/7 Ignition coil 7
- T1/8 Ignition coil 8
- Y32 Air pump switchover valve (only USA)
- Y62 Injectors

P07.61-2014-06

Electrical Test Program – Component Locations

Components on engine
Model 129

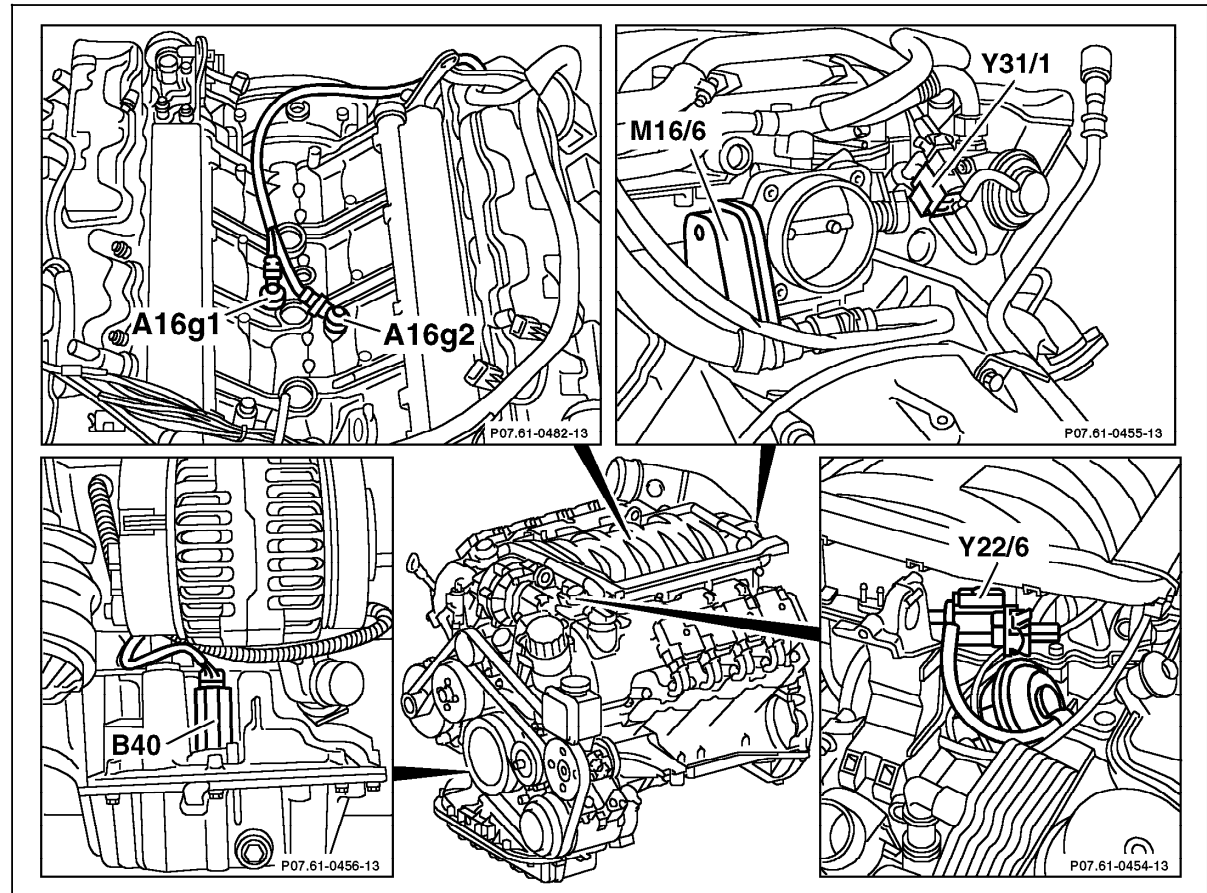

Figure 2

- A16g1 KS 1 (right side of engine)
- A16g2 KS 2 (left side of engine)
- M16/6 EA/CC/ISC actuator
- Y22/6 Resonance intake manifold switchover valve
- Y31/1 EGR valve vacuum transducer
- B40 Oil sensor (level/temperature/quality)

P07.61-0554-06

Electrical Test Program – Component Locations

Engine Compartment
Model 129

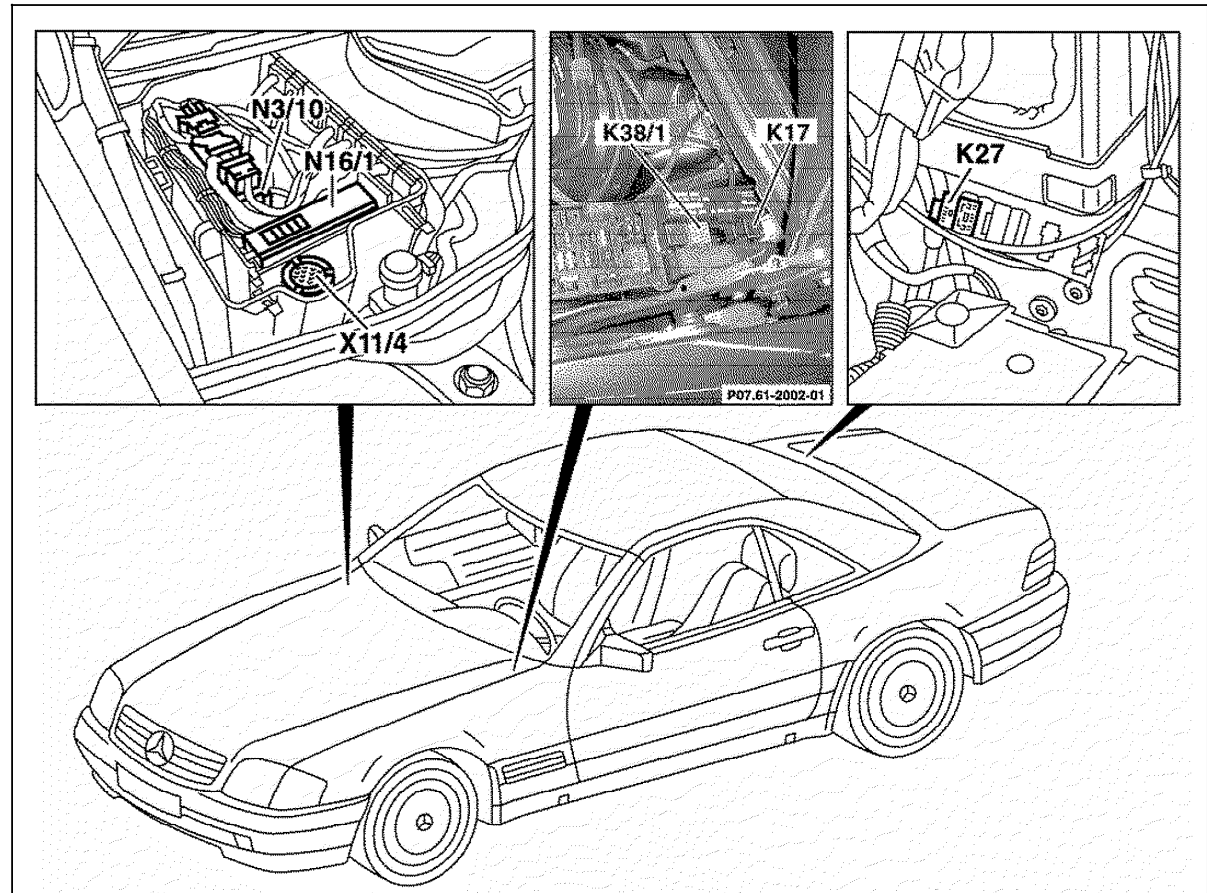

Figure 3

- K17 AIR relay module (only USA)
- K27 FP relay module
- K38/1 Starter lock-out relay module
- N3/10 Engine control module (ME-SFI)
- N16/1 Base module (BM)
- X11/4 Data link connector (DTC readout)

P07.61-2027-06

Electrical Test Program – Component Locations

Engine Compartment
Model 129

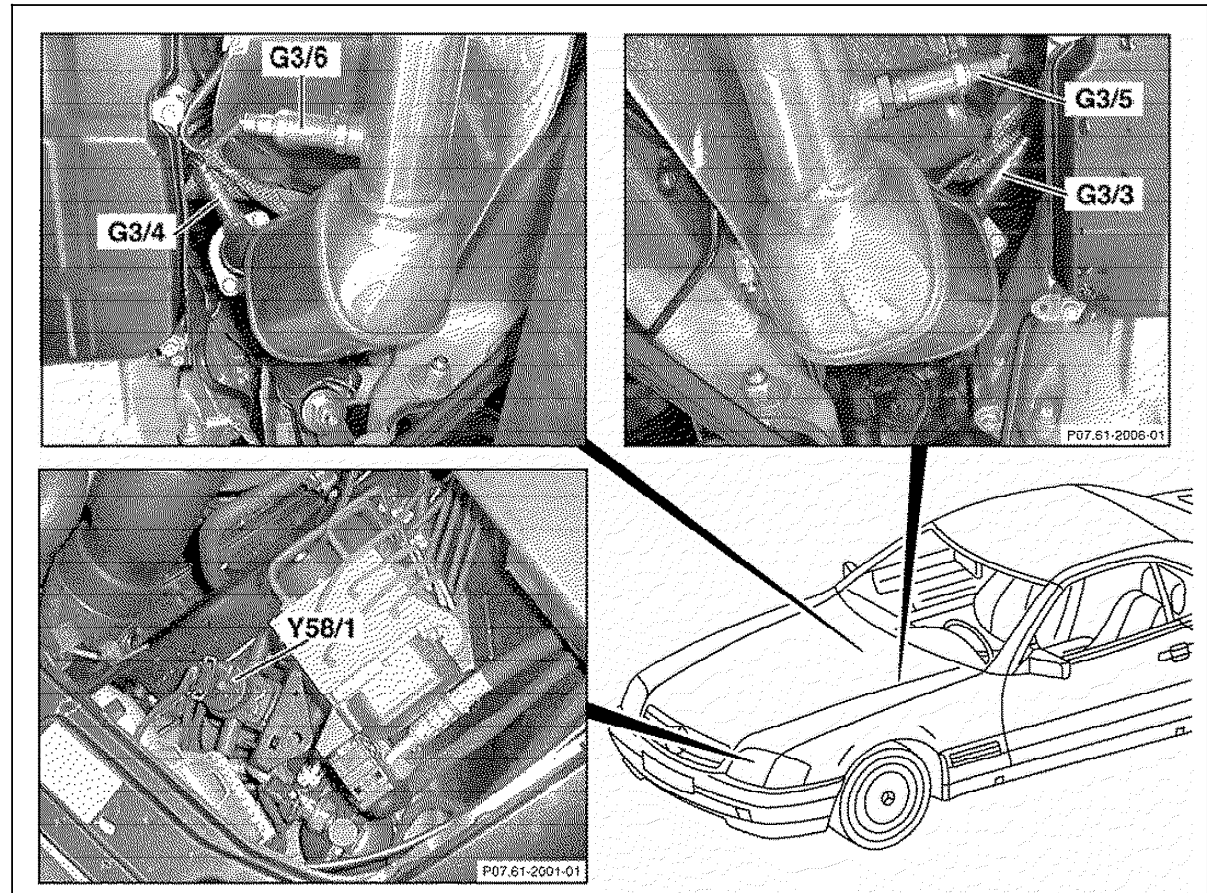

Figure 4

- G3/3 Left O2S 1 (before TWC)
- G3/4 Right O2S 1 (before TWC)
- G3/5 Left O2S 2 (after TWC) (only USA)
- G3/6 Right O2S 2 (after TWC) (only USA)
- Y58/1 Purge control valve

P07.61-2010-06

Electrical Test Program – Component Locations

Engine Compartment
Model 129

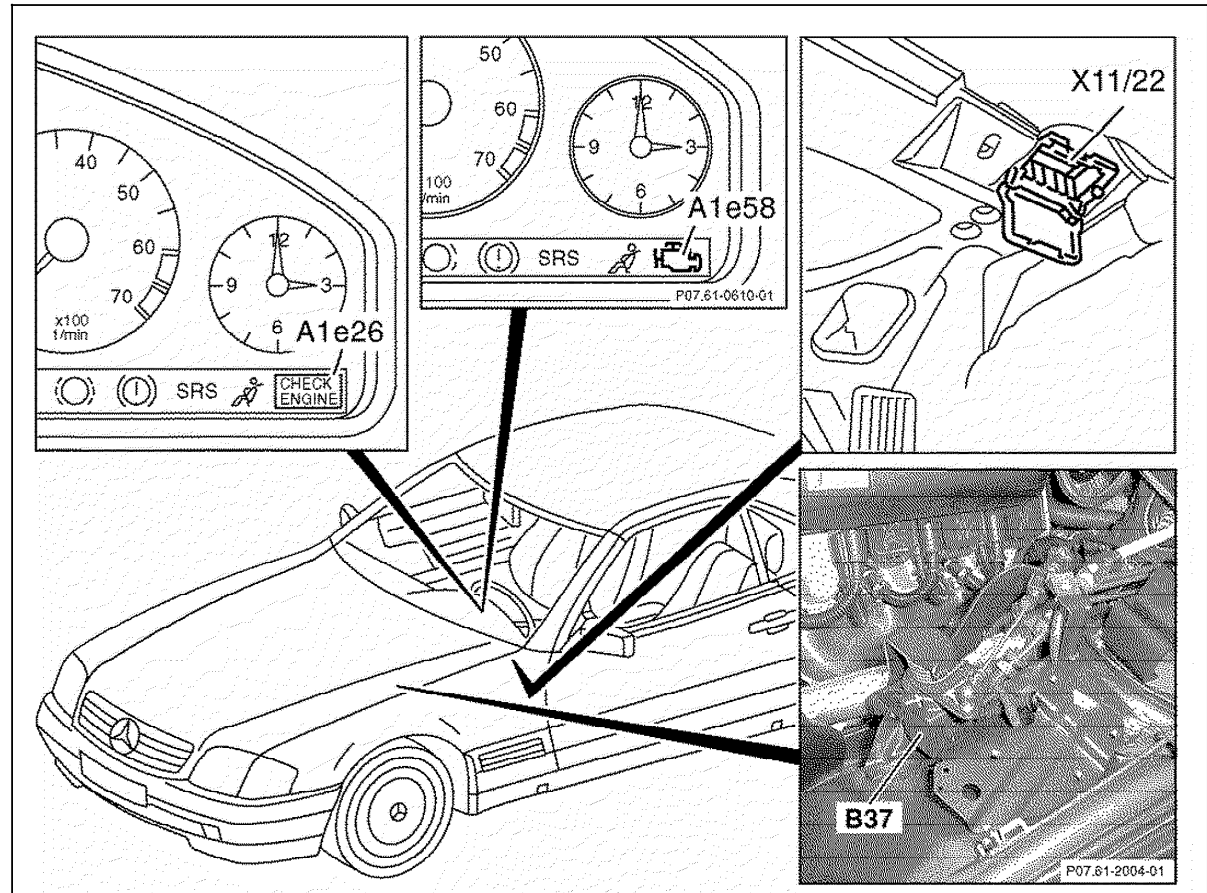

Figure 5

- A1e26 "CHECK ENGINE" MIL (only USA)
- A1e58 Engine diagnostics indicator lamp (only USA)
- B37 Pedal value sensor
- X11/22 Diagnostic module (OBDI) generic scan tool connector

P07.61-2011-06

Electrical Test Program – Component Locations

Trunk
Model 129

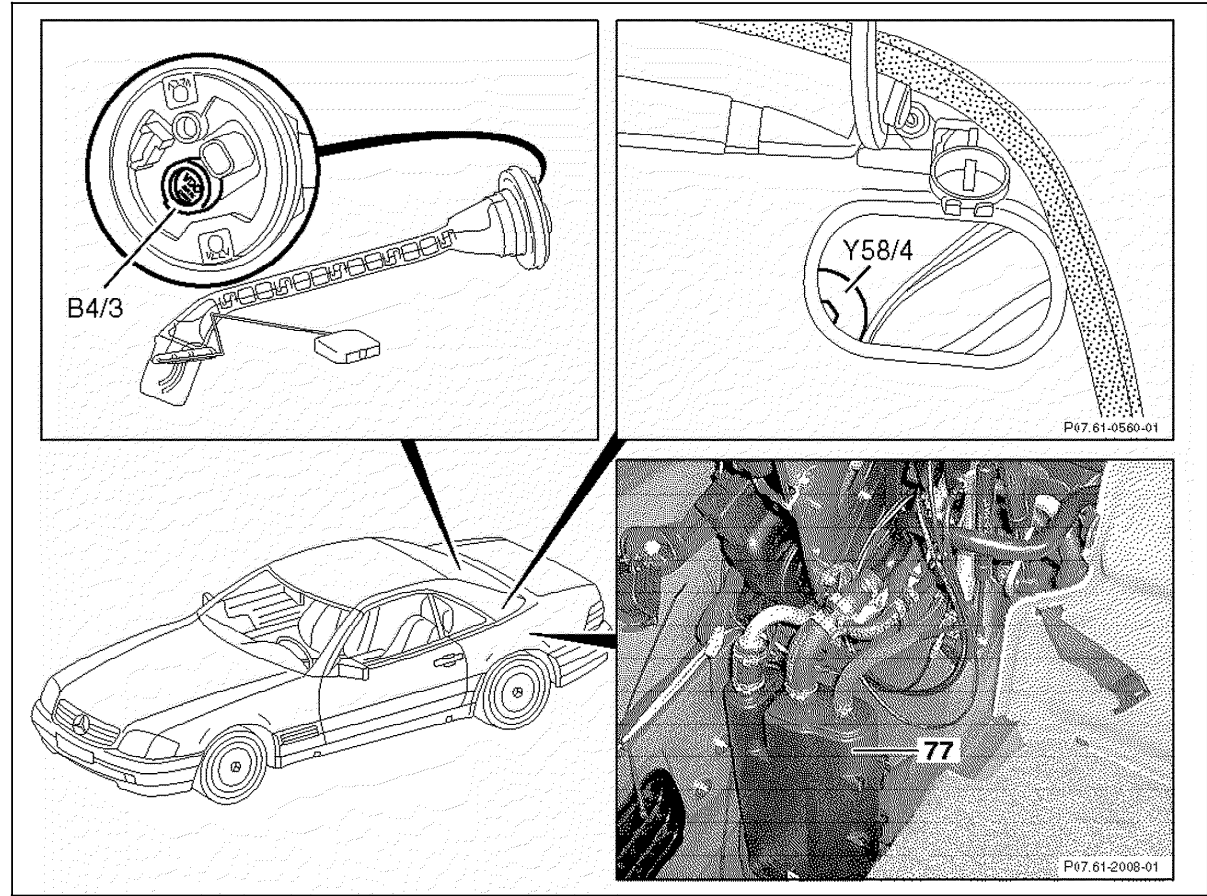

Figure 6

- B4/3 Fuel tank pressure sensor (only USA)
- Y58/4 Activated charcoal canister shut-off valve (only USA)
- 77 Activated charcoal canister

P07.61-2012-06

Electrical Test Program – Component Locations

Components on engine
Model 163

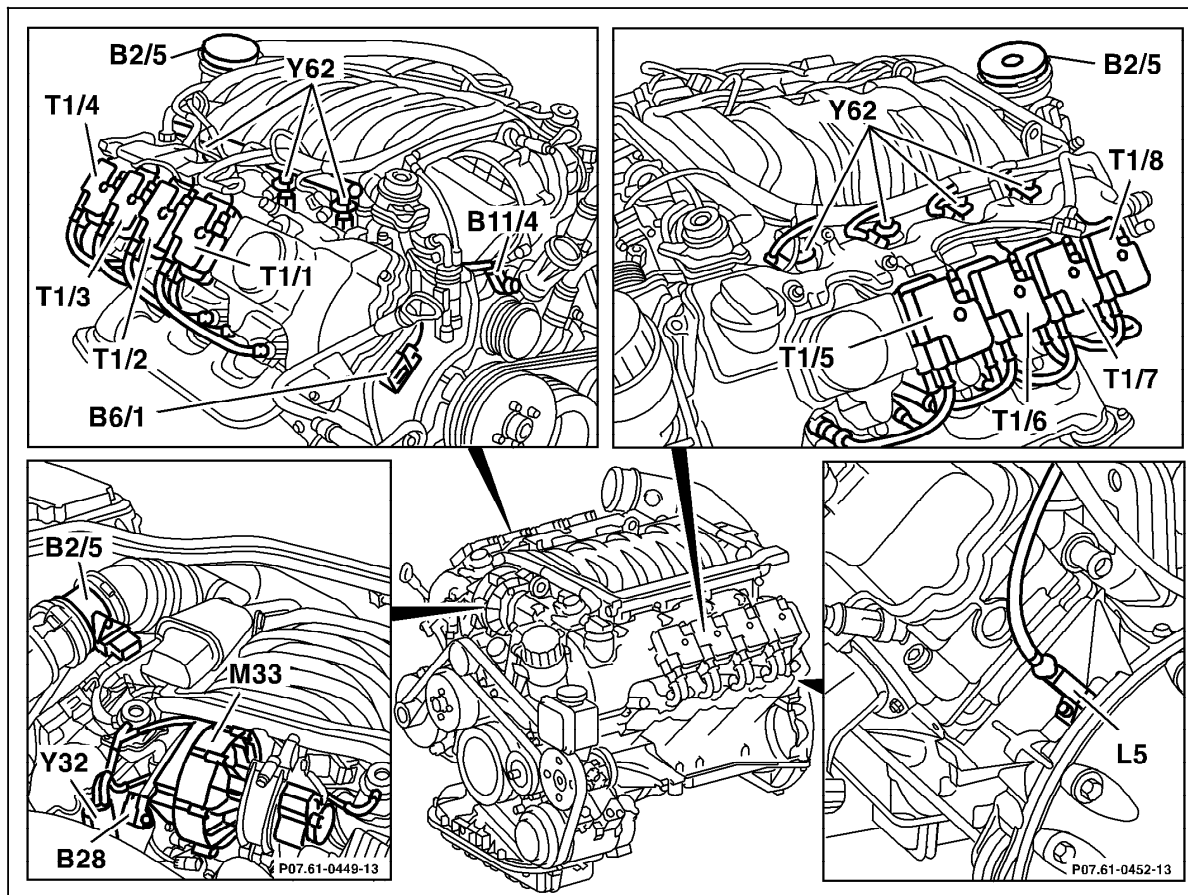

Figure 7

- B2/5 Hot film MAF sensor
- B6/1 Camshaft Hall-effect sensor
- B11/4 ECT sensor
- B28 Pressure sensor (only USA)
- L5 CKP sensor
- M33 AIR pump (only USA)
- T1/1 Ignition coil 1
- T1/2 Ignition coil 2
- T1/3 Ignition coil 3
- T1/4 Ignition coil 4
- T1/5 Ignition coil 5
- T1/6 Ignition coil 6
- T1/7 Ignition coil 7
- T1/8 Ignition coil 8
- Y32 Air pump switchover valve (only USA)
- Y62 Injectors

P07.61-2014-06

Electrical Test Program – Component Locations

Components on engine
Model 163

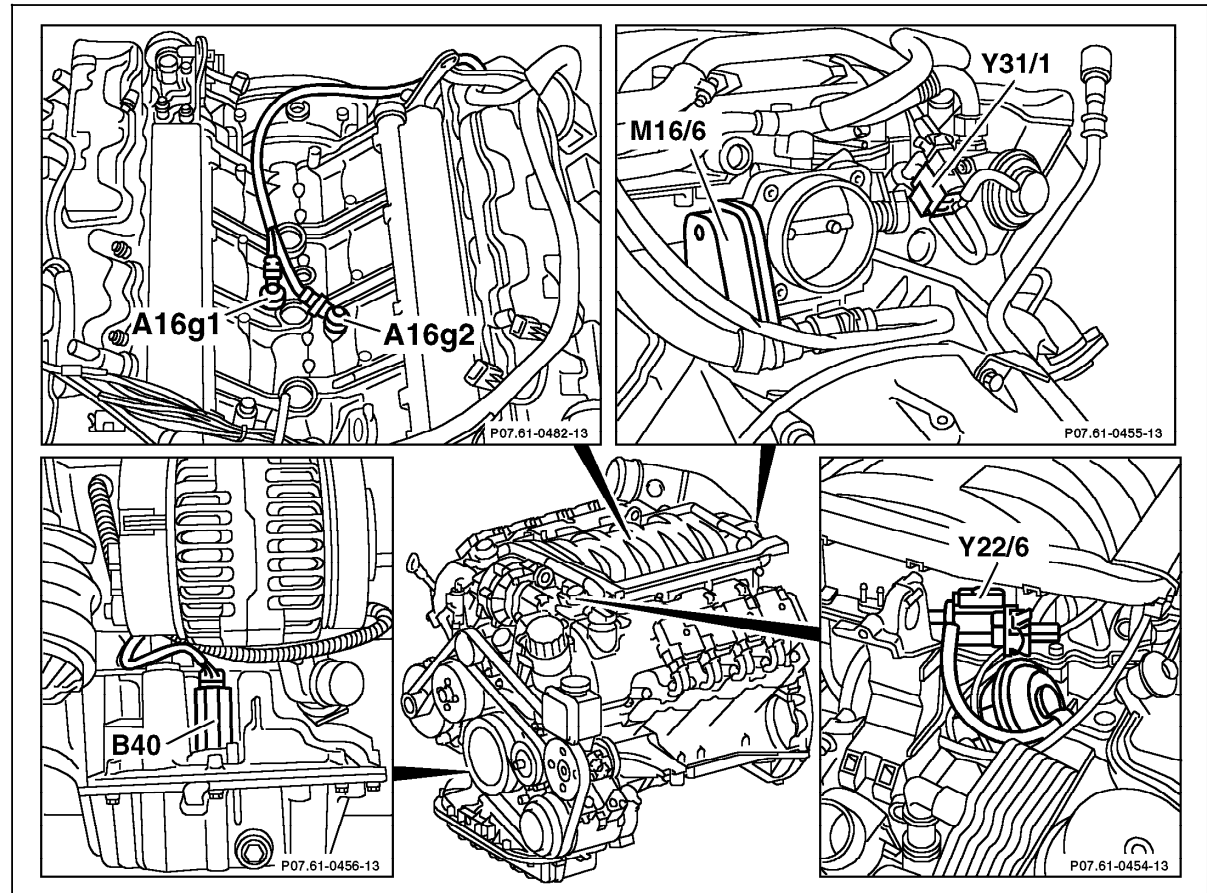

Figure 8

- A16g1 KS 1 (right side of engine)
- A16g2 KS 2 (left side of engine)
- M16/6 EA/CC/ISC actuator
- Y22/6 Resonance intake manifold switchover valve
- Y31/1 EGR valve vacuum transducer
- B40 Oil sensor (level/temperature/quality)

P07.61-0554-06

Electrical Test Program – Component Locations

Components in engine compartment
Model 163

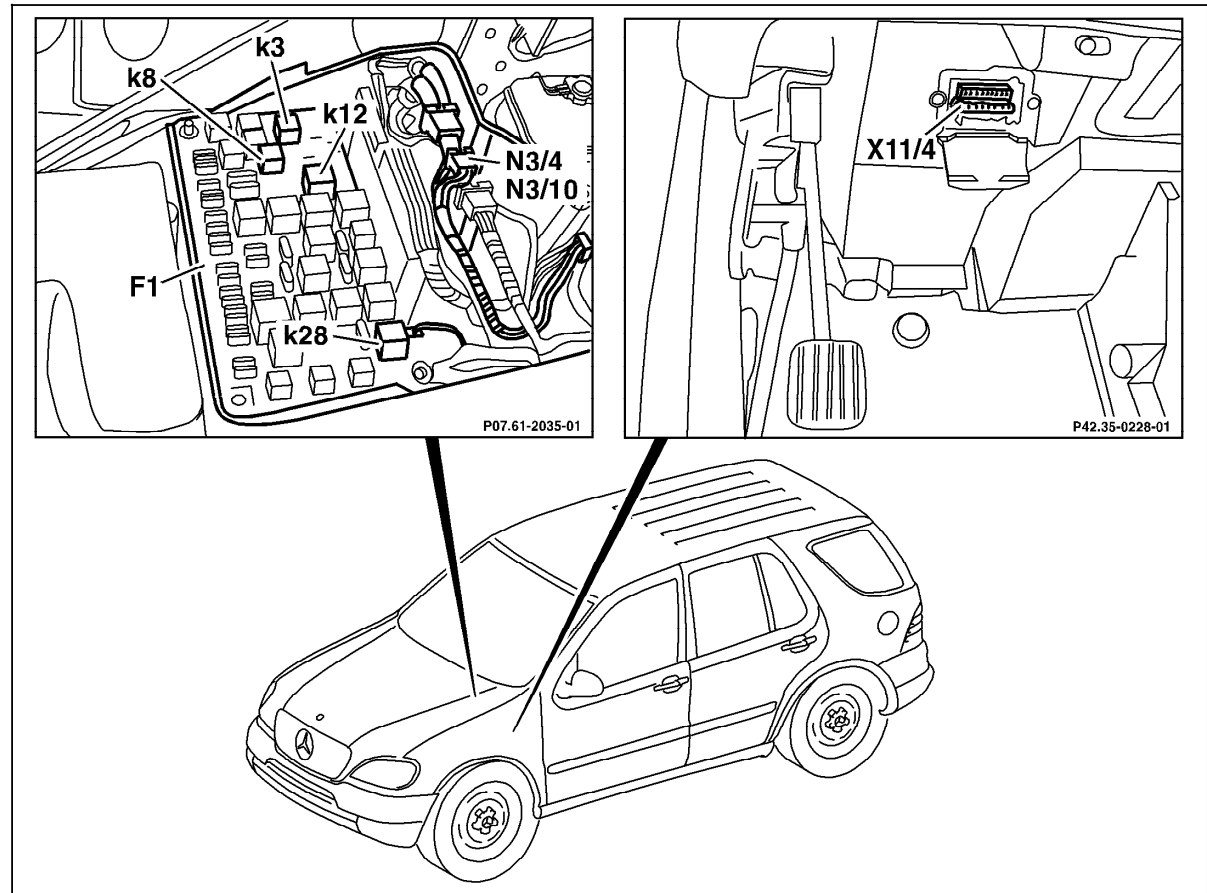

Figure 9

- F1 Fuse and relay box with:
 - k3 Fuel pump relay
 - k8 Starter relay
 - k12 Circuit 15 relay
 - k28 Secondary air injection pump relay (only USA)
- N3/10 Engine control module (ME-SFI)
- X11/4 Data link connector (DTC readout)

P07.61-2029-06

Electrical Test Program – Component Locations

Model 163

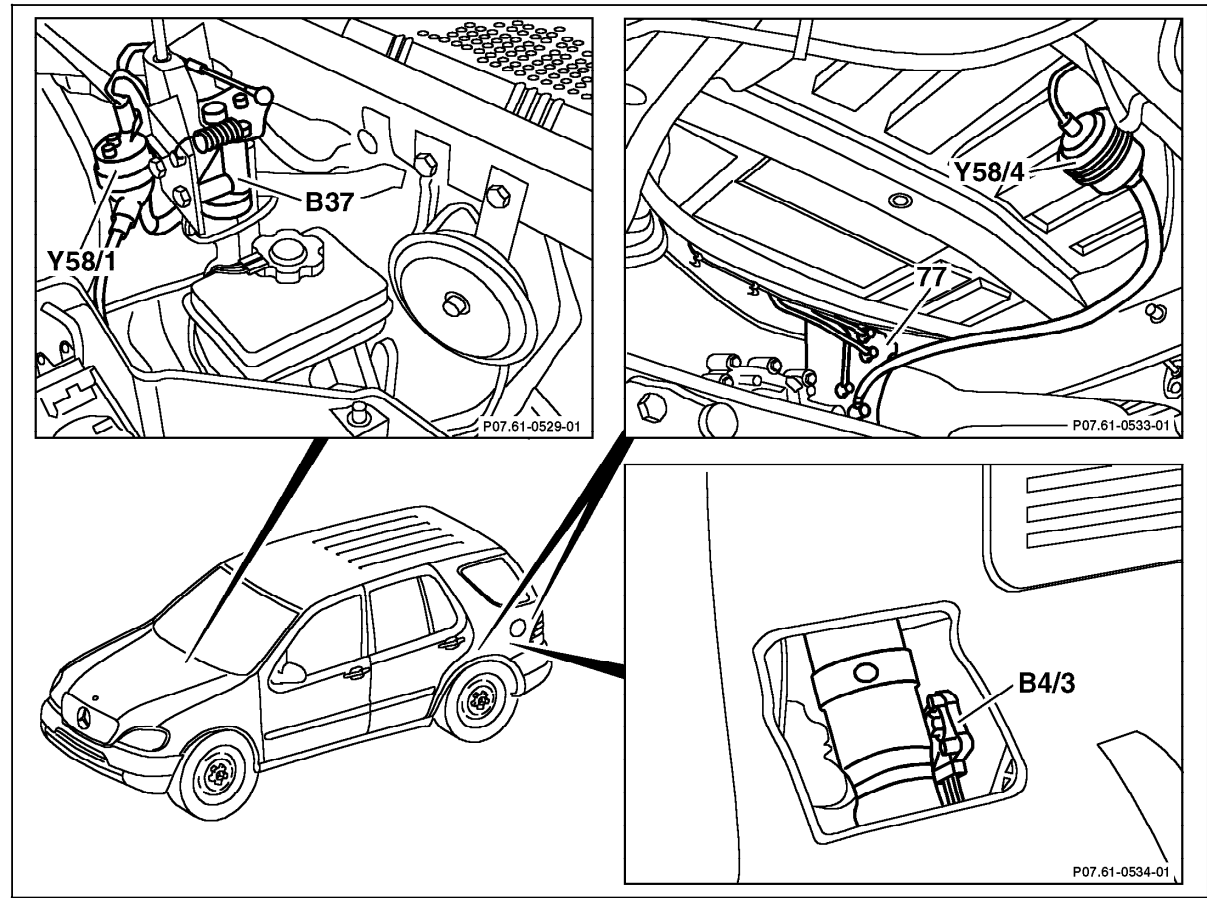

Figure 10

- B4/3 Fuel tank pressure sensor (only USA)
- B37 Pedal value sensor
- Y58/1 Purge control valve
- Y58/4 Activated charcoal canister shut-off valve (only USA)
- 77 Activated charcoal canister

P07.61-0545-06

Electrical Test Program – Component Locations

Model 163

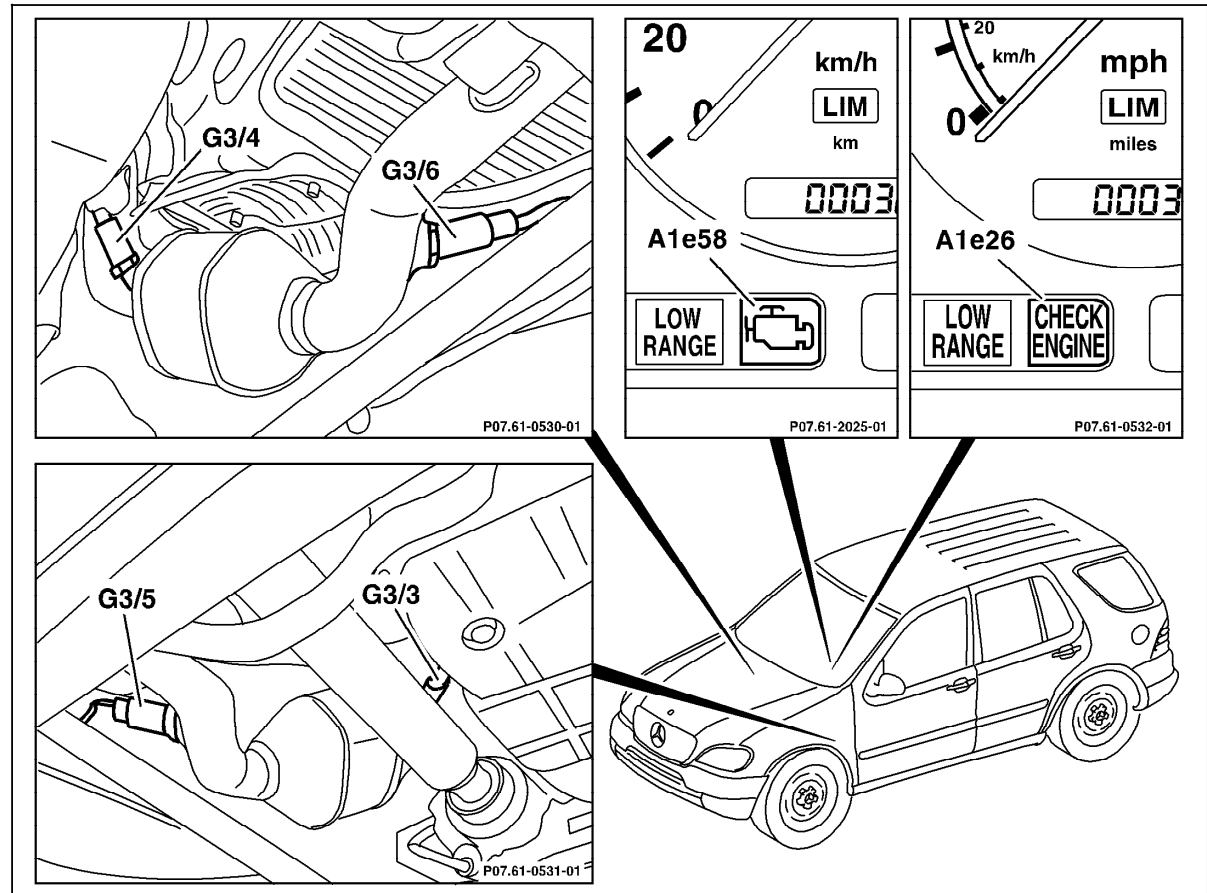

Figure 11

- A1e26 "CHECK ENGINE" MIL (only USA)
- A1e58 Engine diagnostics indicator lamp (only USA)
- G3/3 Left O2S 1 (before TWC)
- G3/4 Right O2S 1 (before TWC)
- G3/5 Left O2S 2 (after TWC) (only USA)
- G3/6 Right O2S 2 (after TWC) (only USA)

P07.61-2028-06

Electrical Test Program – Component Locations

Components on engine
Model 208

Figure 12

- B2/5 Hot film MAF sensor
- B6/1 Camshaft Hall-effect sensor
- B11/4 ECT sensor
- B28 Pressure sensor (only USA)
- L5 CKP sensor
- M33 AIR pump (only USA)
- T1/1 Ignition coil 1
- T1/2 Ignition coil 2
- T1/3 Ignition coil 3
- T1/4 Ignition coil 4
- T1/5 Ignition coil 5
- T1/6 Ignition coil 6
- T1/7 Ignition coil 7
- T1/8 Ignition coil 8
- Y32 Air pump switchover valve (only USA)
- Y62 Injectors

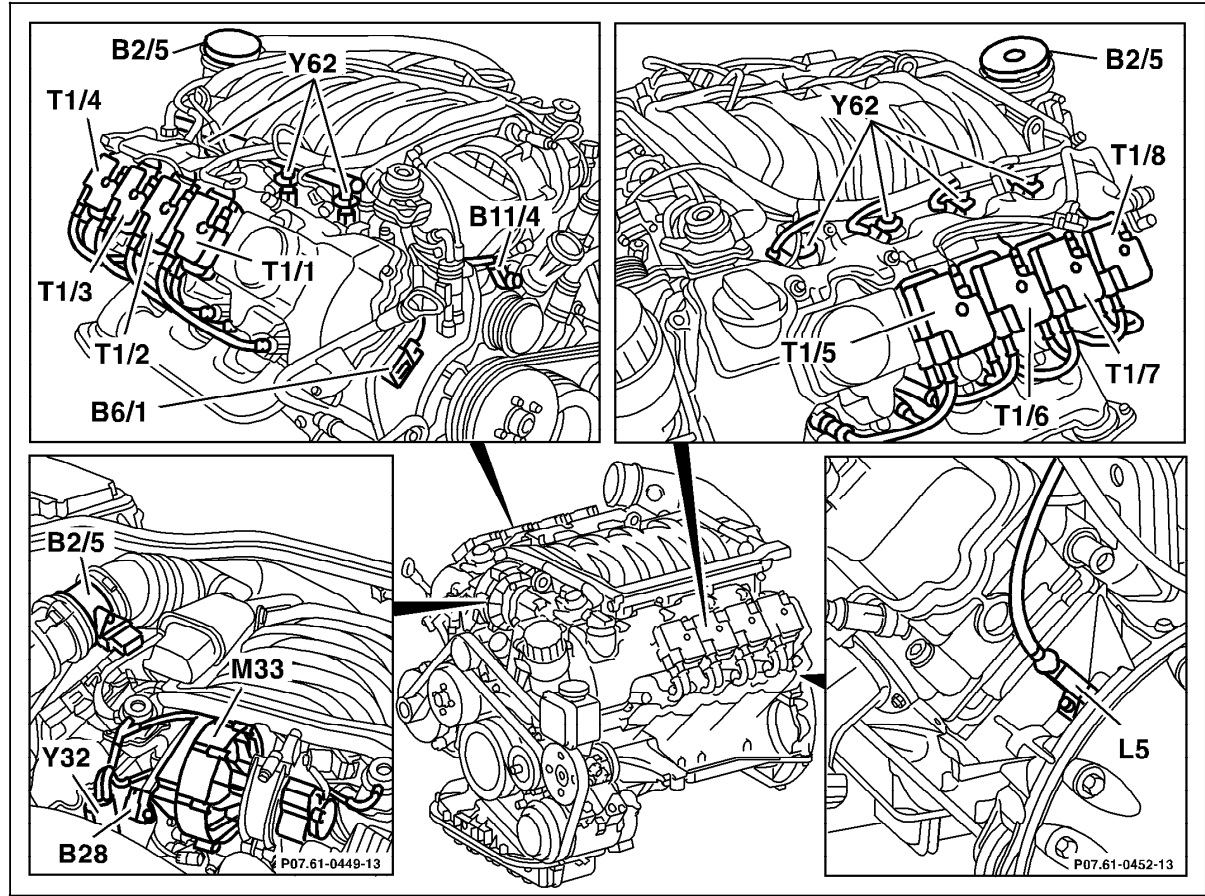

P07.61-2014-06

Electrical Test Program – Component Locations

Components on engine
Model 208

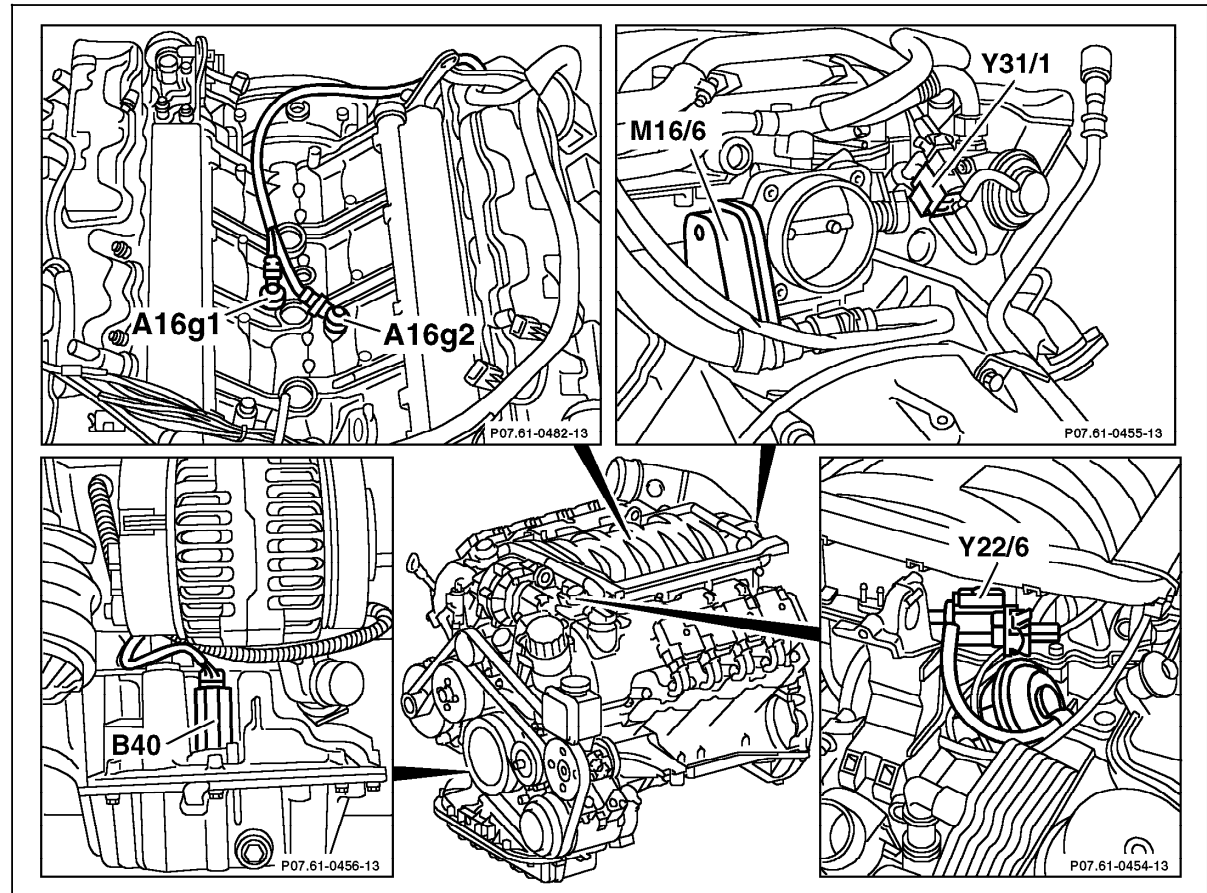

Figure 13

- A16g1 KS 1 (right side of engine)
- A16g2 KS 2 (left side of engine)
- M16/6 EA/CC/ISC actuator
- Y22/6 Resonance intake manifold switchover valve
- Y31/1 EGR valve vacuum transducer
- B40 Oil sensor (level/temperature/quality)

P07.61-0554-06

Electrical Test Program – Component Locations

Model 208

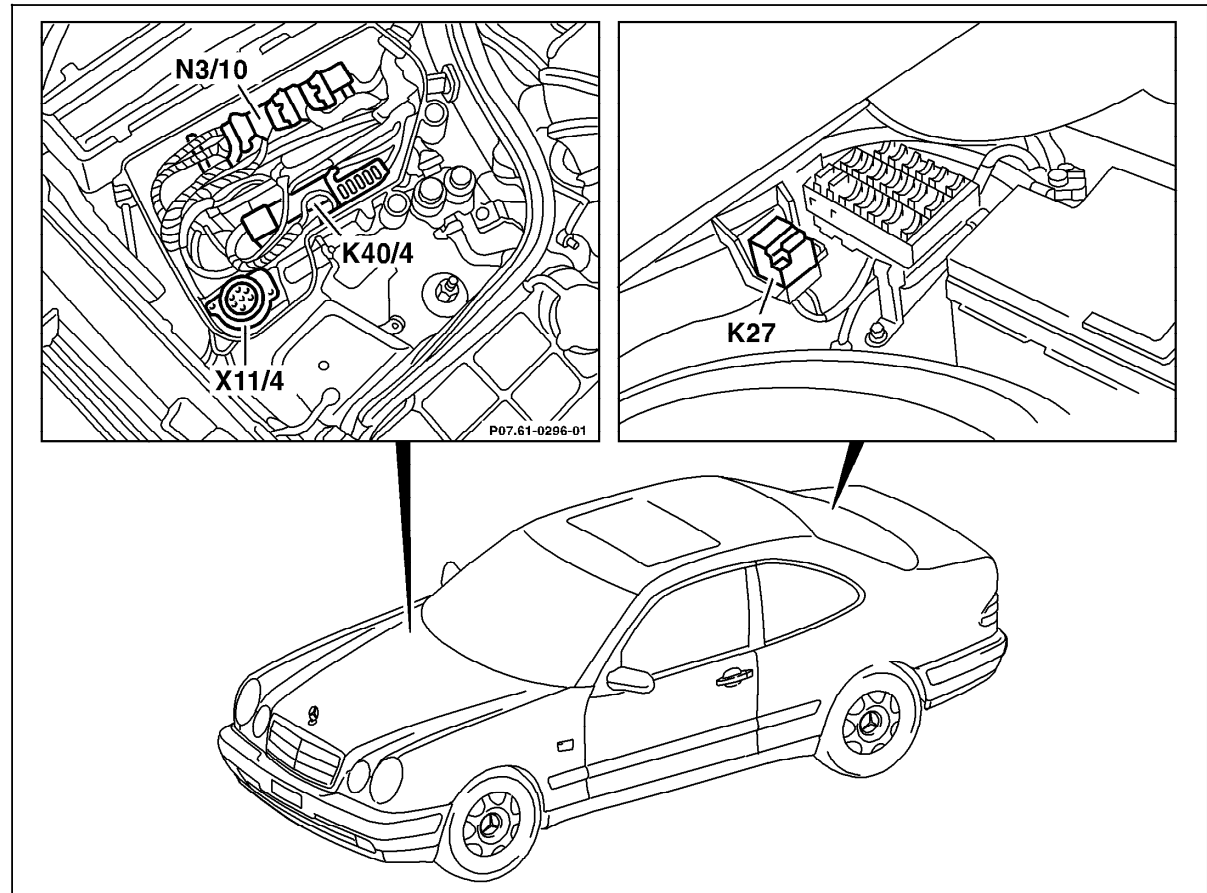

Figure 14

- K27 FP relay module
- K40/4 Passenger-side fuse and relay module box
- N3/10 Engine control module (ME-SFI)
- X11/4 Data link connector (DTC readout)

P07.61-2030-06

Electrical Test Program – Component Locations

Model 208

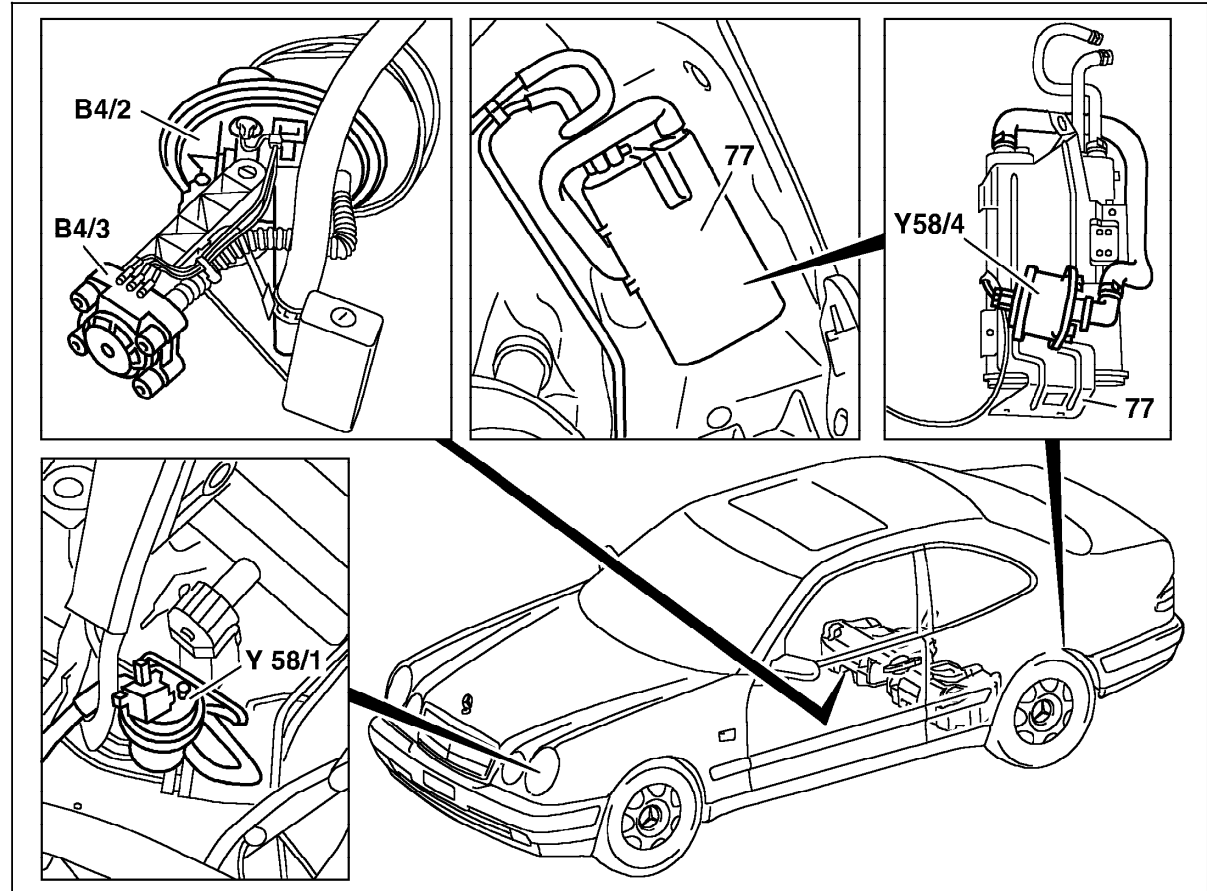

Figure 15

- B4/2 Right fuel level sensor
- B4/3 Fuel tank pressure sensor (only USA)
- Y58/1 Purge valve
- Y58/4 Activated charcoal canister shut-off valve (only USA)
- 77 Activated charcoal canister

P07.61-2032-06

Electrical Test Program – Component Locations

Model 208

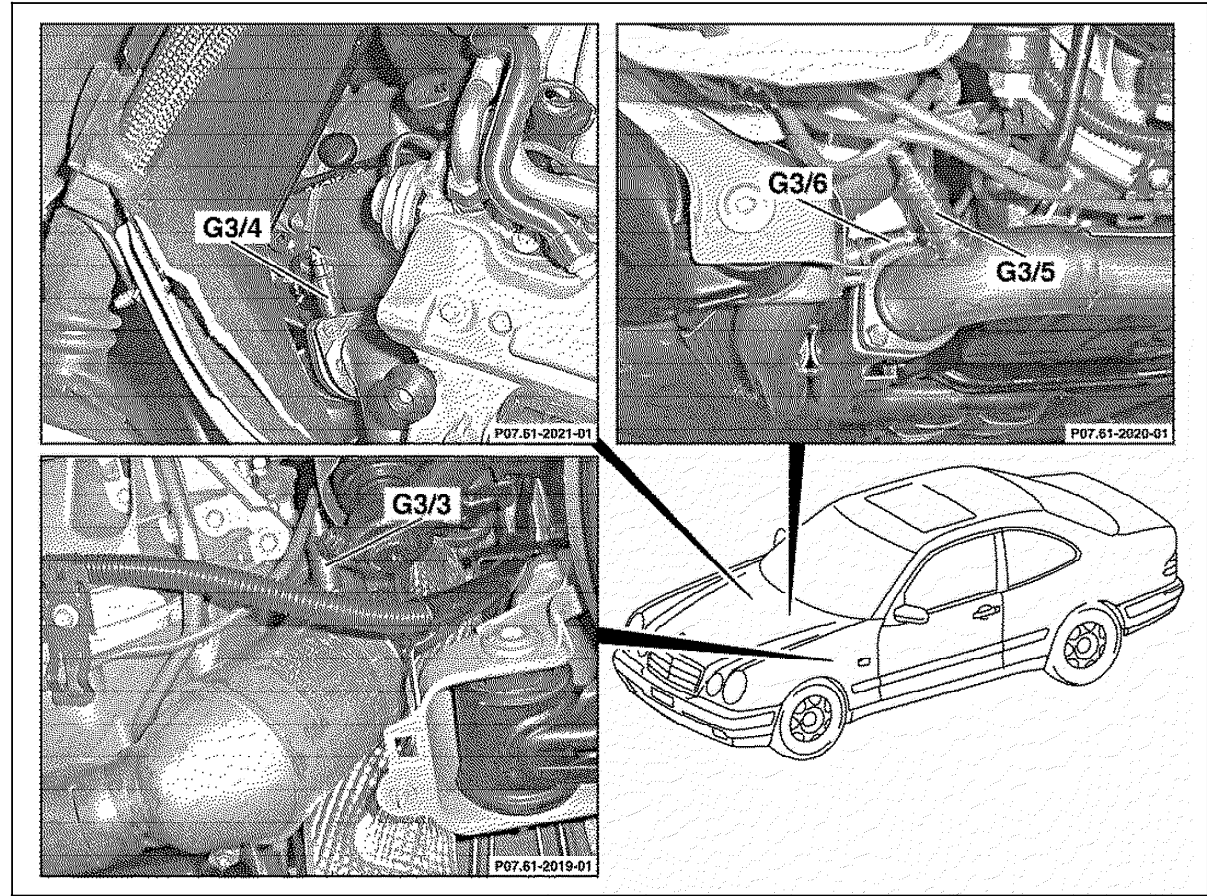

Figure 16

- G3/3 Left O2S 1 (before TWC)
- G3/4 Right O2S 1 (before TWC)
- G3/5 Left O2S 2 (after TWC) (only USA)
- G3/6 Right O2S 2 (after TWC) (only USA)
- Y58/1 Purge control valve

P07.61-2033-06

Electrical Test Program – Component Locations

Model 208

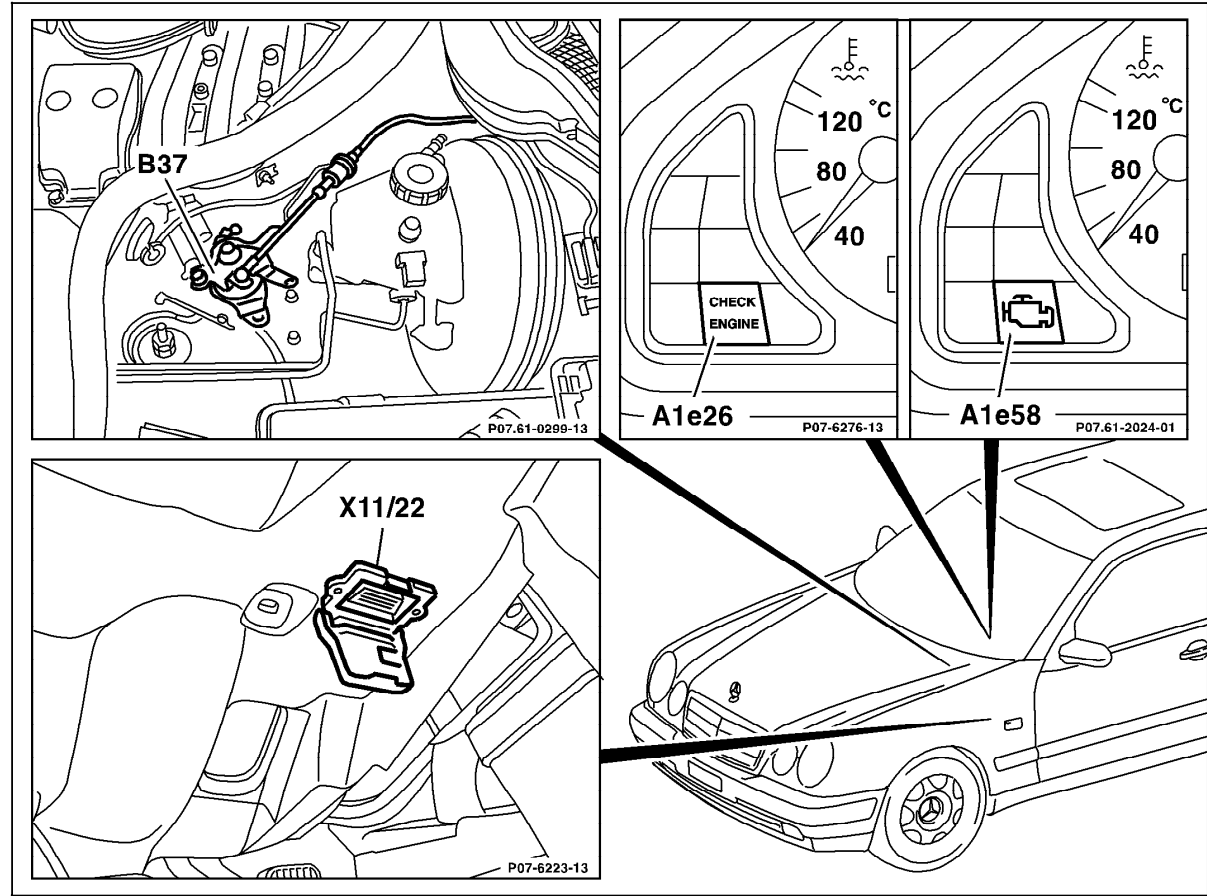

Figure 17

- A1e26 "CHECK ENGINE" MIL (only USA)
- A1e58 Engine diagnostics indicator lamp (not USA)
- B37 Pedal value sensor
- X11/22 Diagnostic module (OBDII) generic scan tool connector

P07.61-2031-06

Electrical Test Program – Component Locations

Components on engine
Model 210

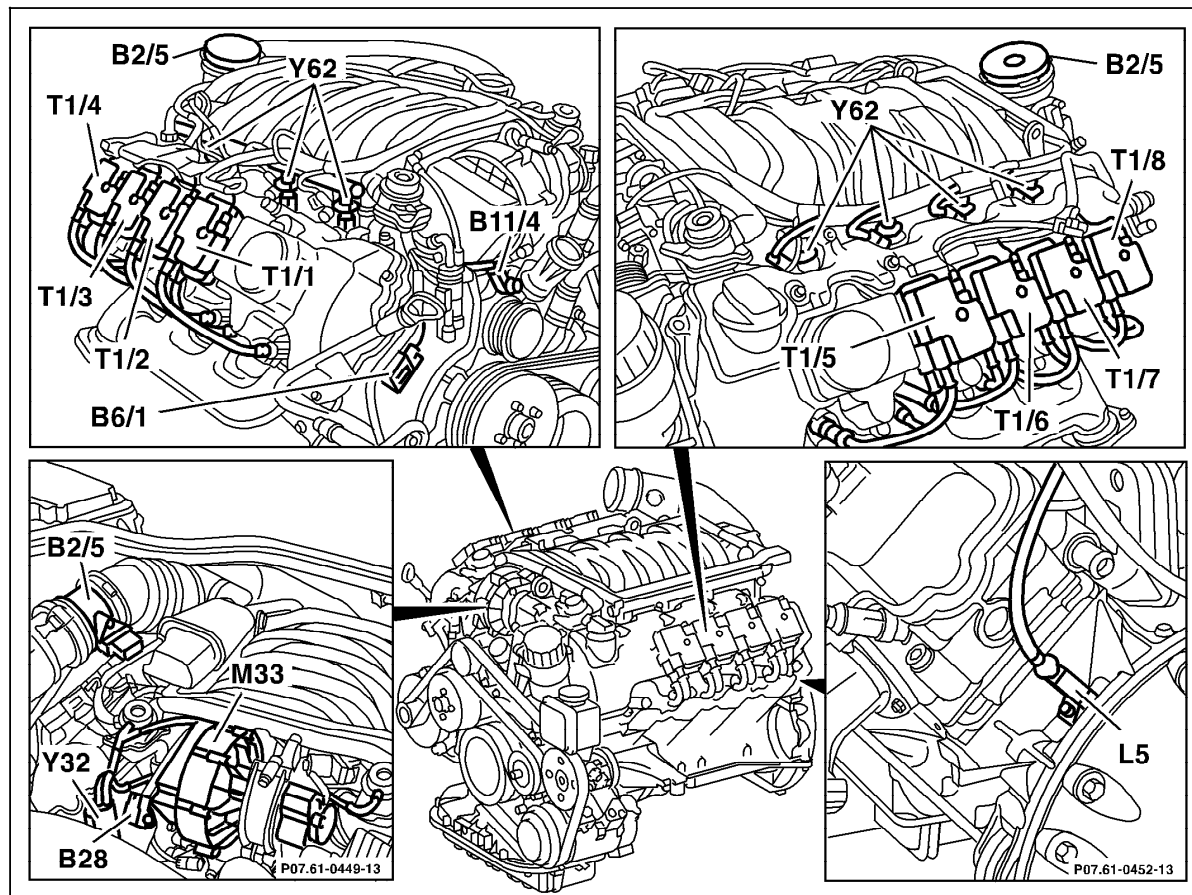

Figure 18

- B2/5 Hot film MAF sensor
- B6/1 Camshaft Hall-effect sensor
- B11/4 ECT sensor
- B28 Pressure sensor (only USA)
- L5 CKP sensor
- M33 AIR pump (only USA)
- T1/1 Ignition coil 1
- T1/2 Ignition coil 2
- T1/3 Ignition coil 3
- T1/4 Ignition coil 4
- T1/5 Ignition coil 5
- T1/6 Ignition coil 6
- T1/7 Ignition coil 7
- T1/8 Ignition coil 8
- Y32 Air pump switchover valve (only USA)
- Y62 Injectors

P07.61-2014-06

Electrical Test Program – Component Locations

Components on engine
Model 210

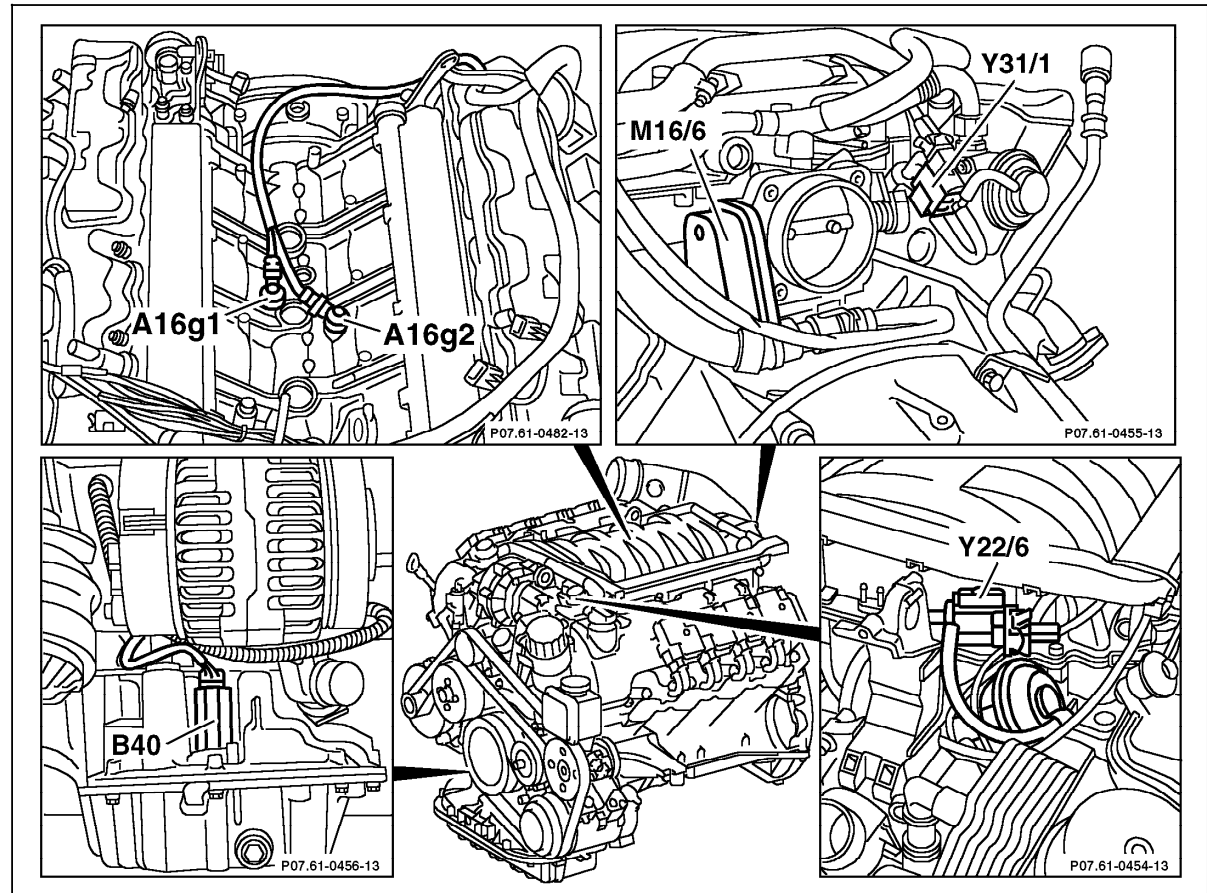

Figure 19

- A16g1 KS 1 (right side of engine)
- A16g2 KS 2 (left side of engine)
- M16/6 EA/CC/ISC actuator
- Y22/6 Resonance intake manifold switchover valve
- Y31/1 EGR valve vacuum transducer
- B40 Oil sensor (level/temperature/quality)

P07.61-0554-06

Electrical Test Program – Component Locations

Model 210

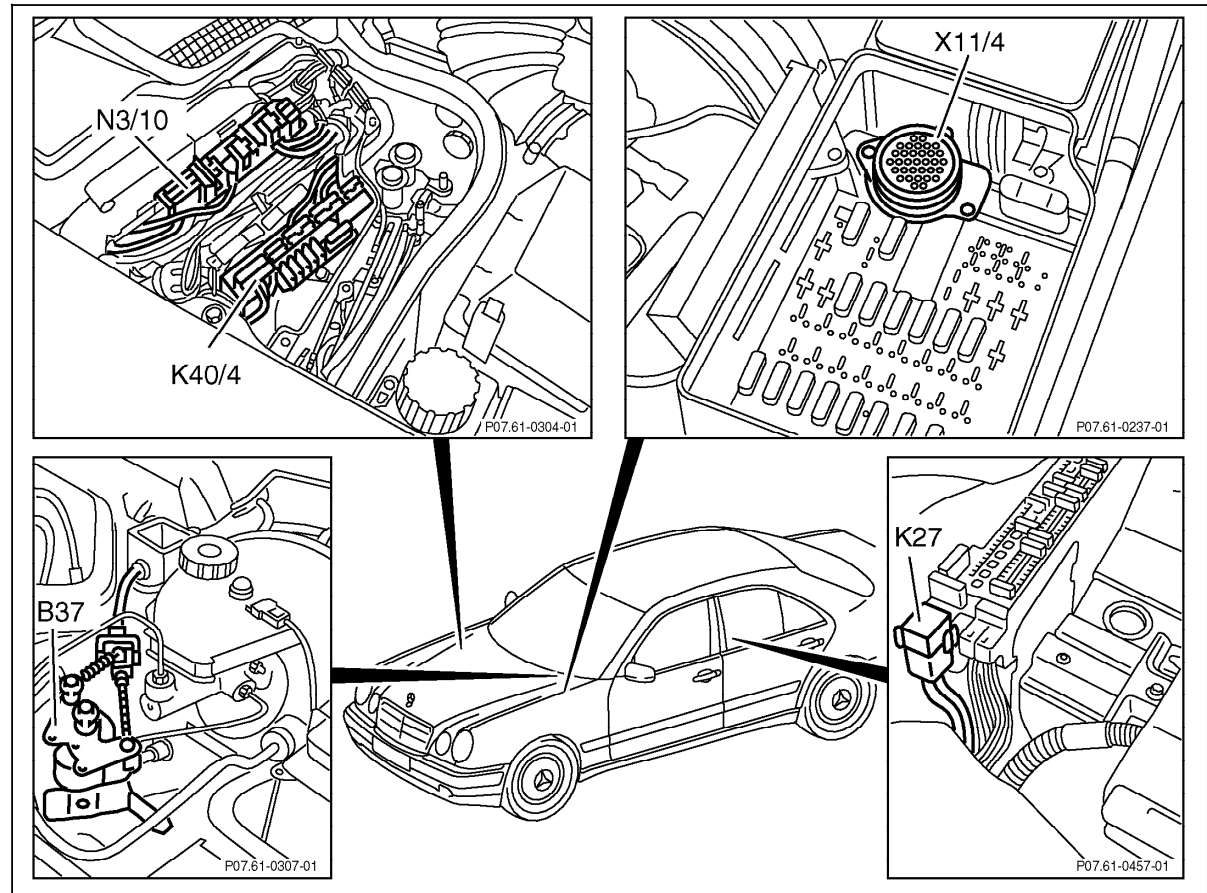

Figure 20

- B37 Pedal value sensor
- K27 FP relay module
- K40/4 Passenger-side fuse and relay module box
- N3/10 Engine control module (ME-SFI)
- X11/4 Data link connector (DTC readout)

P07.61-0461-06

Electrical Test Program – Component Locations

Engine compartment
Model 210

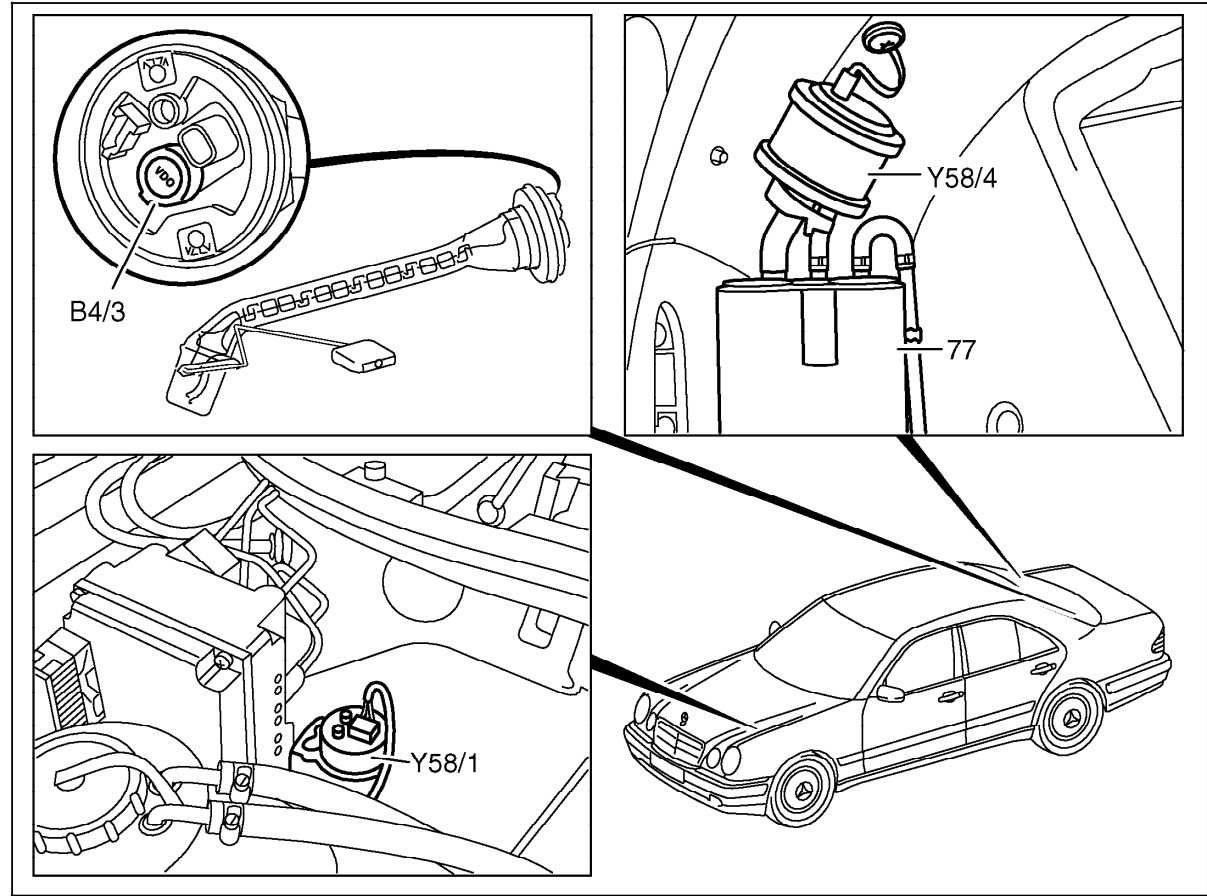

Figure 21

- B4/3 Fuel tank pressure sensor
- Y58/1 Purge control valve
- Y58/4 Activated charcoal canister shut-off valve
- 77 Activated charcoal canister

P07.61-0288-06

Electrical Test Program – Component Locations

Engine compartment
Model 210

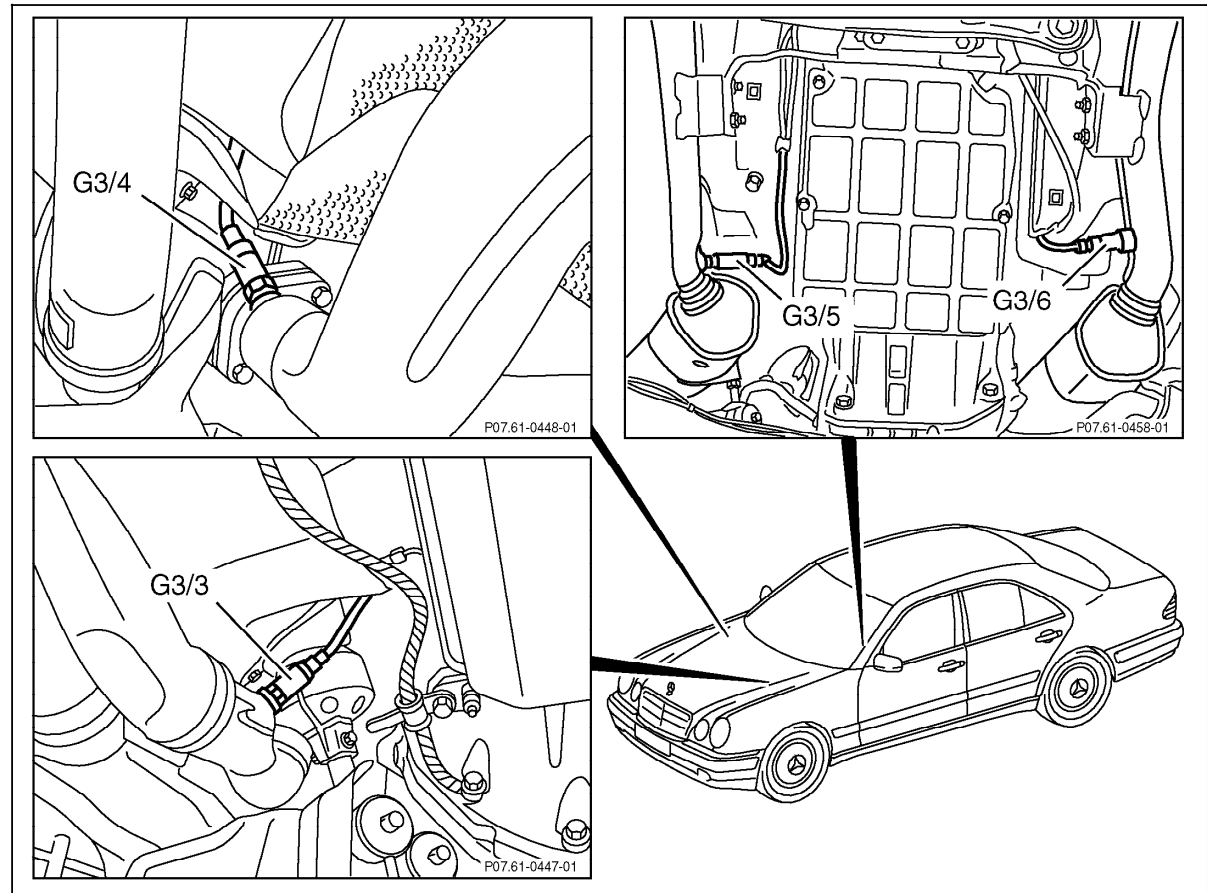

Figure 22

- G3/3 Left O2S 1 (left, before TWC)
- G3/4 Right O2S 1 (right, before TWC)
- G3/5 Left O2S 2 (left, after TWC) (only USA)
- G3/6 Right O2s 2 (right, after TWC) (only USA)

P07.61-0462-06

Electrical Test Program – Component Locations

Passenger compartment
Models 210

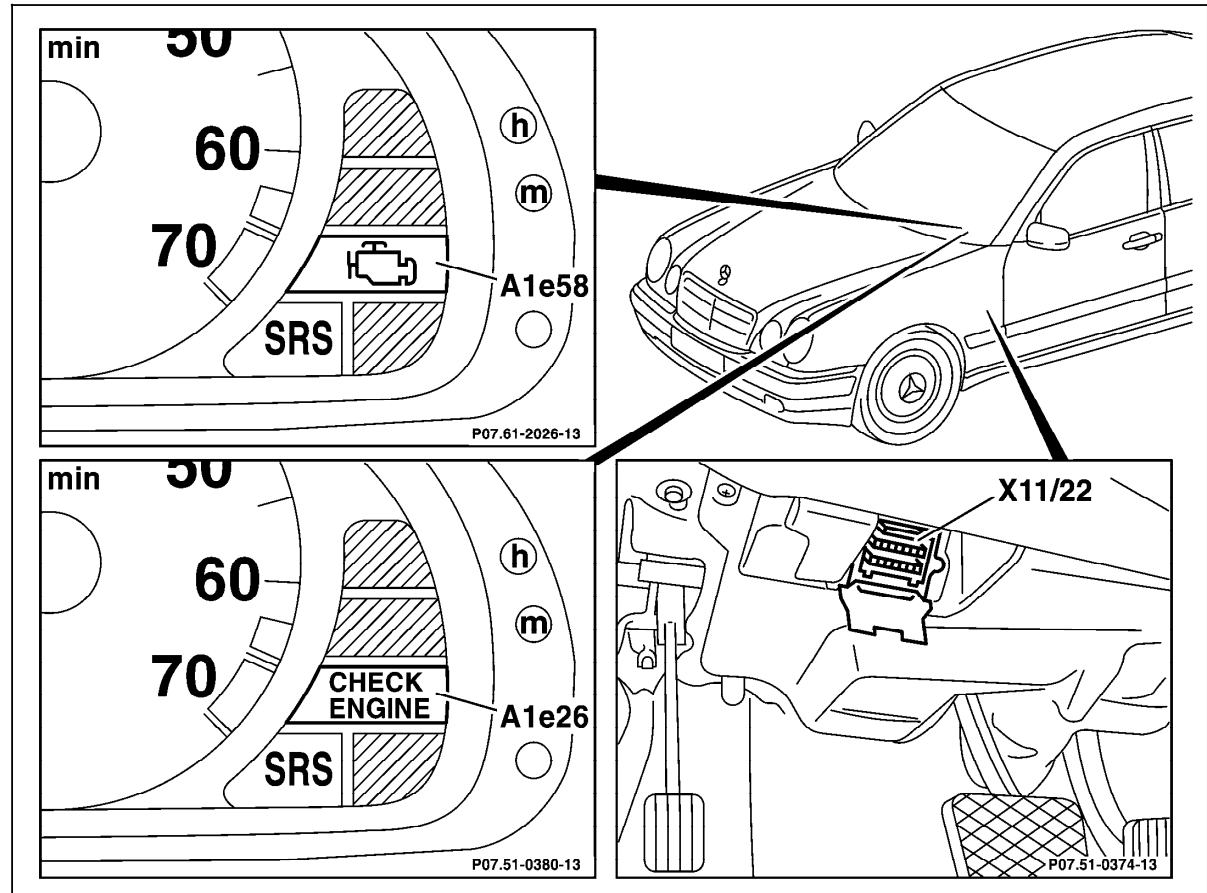

P07.61-2034-06

Figure 23

A1e26 "CHECK ENGINE" MIL (only USA)

A1e58 Engine diagnostics indicator lamp (only USA)

X11/22 Diagnostic module (OBD II) generic scan tool connector