

Electrical Test Program – Component Locations

Components on engine
Model 129

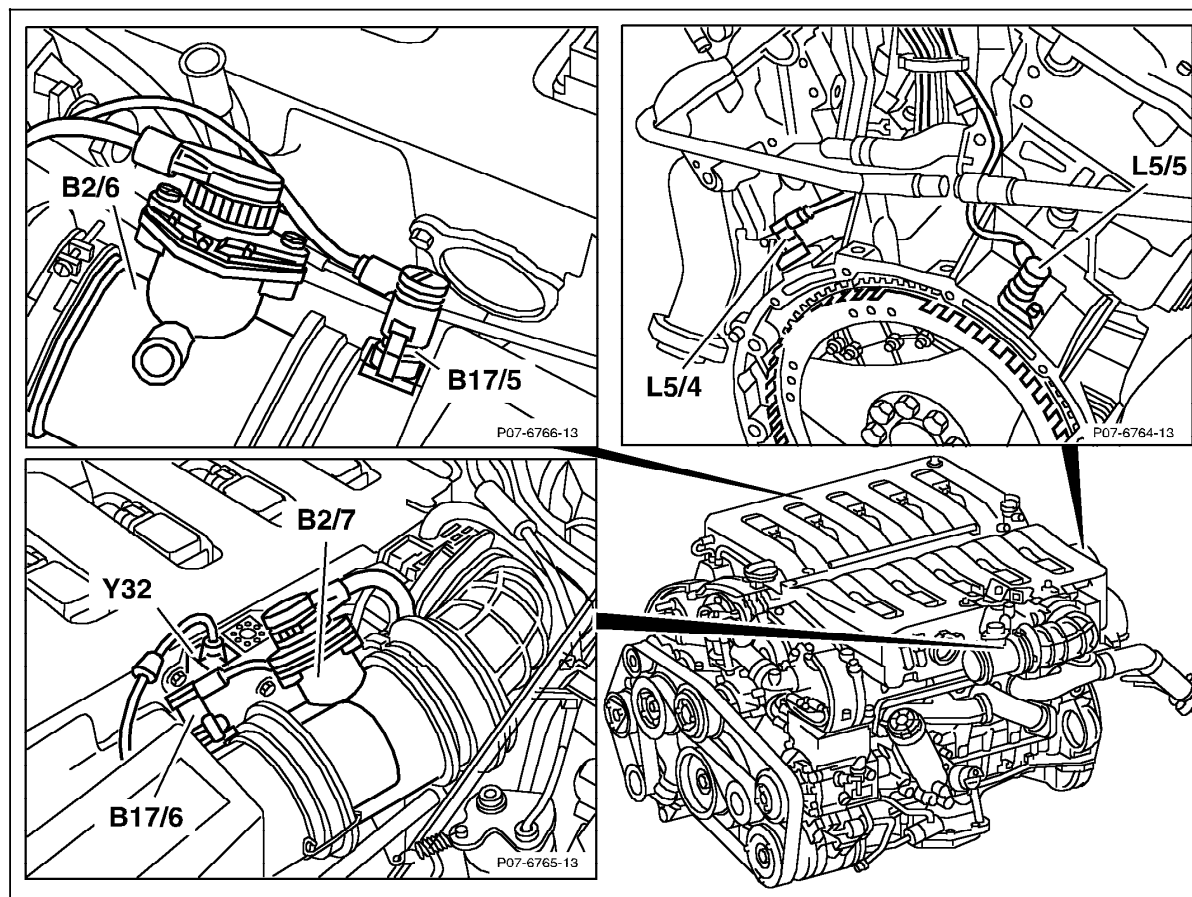

Figure 1

- B2/6 Left hot film MAF sensor (located on right side of engine)
- B2/7 Right hot film MAF sensor (located on left side of engine)
- B17/5 Left IAT sensor (located in engine compartment, right hand side)
- B17/6 Right IAT sensor (located in engine compartment, left hand side)
- L5/4 Left CKP sensor
- L5/5 Right CKP sensor
- Y32 AIR pump switchover valve

P07.61-2052-06

Electrical Test Program – Component Locations

Components on engine
Model 129

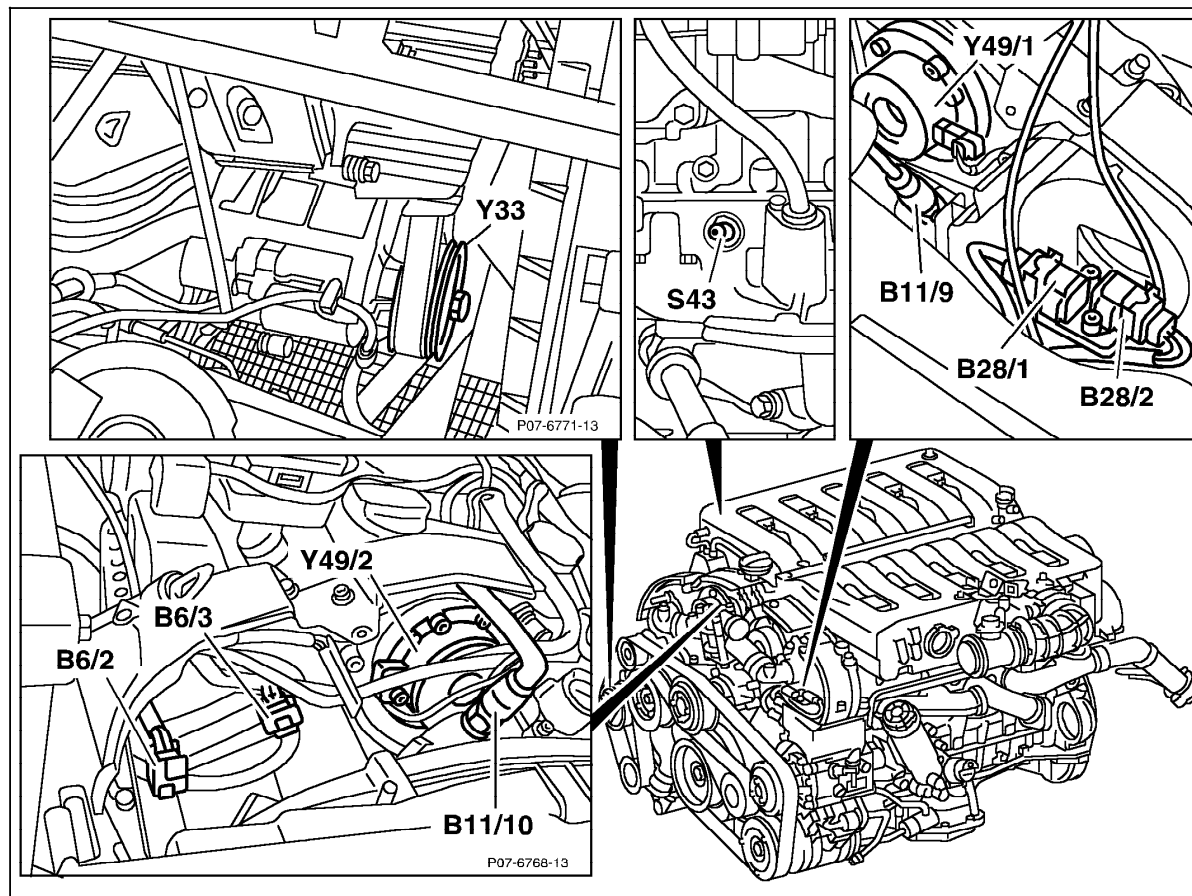

Figure 2

- B6/2 Left camshaft Hall-effect sensor
- B6/3 Right camshaft Hall-effect sensor
- B11/9 Left ECT sensor
- B11/10 Right ECT sensor
- B28/1 Left pressure sensor (only USA)
- B28/2 Right pressure sensor (only USA)
- S43 Oil level switch
- Y33 Electromagnetic AIR pump clutch
- Y49/1 Left adjustable camshaft timing solenoid
- Y49/2 Right adjustable camshaft timing solenoid

P07.61-2054-06

Electrical Test Program – Component Locations

Components on engine
Model 129

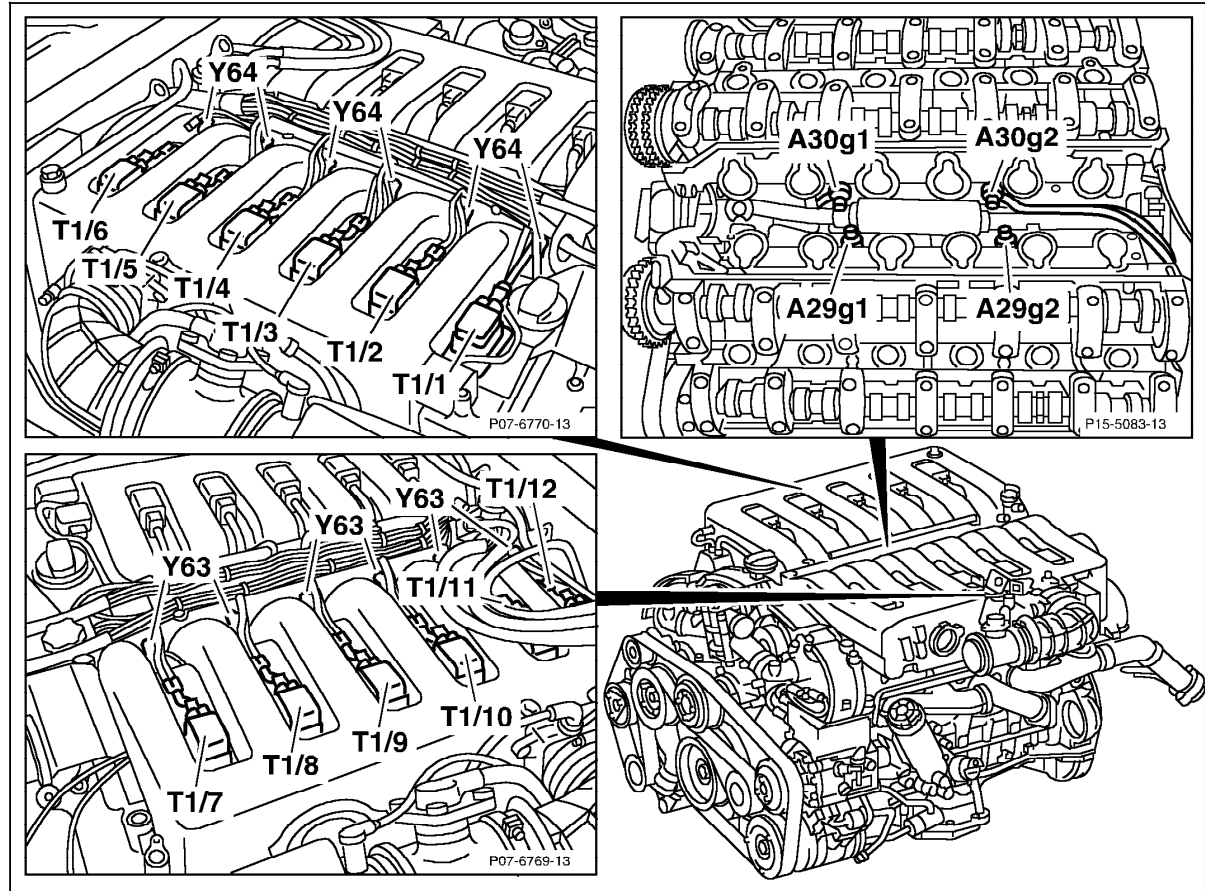

Figure 3

- A29g1 Left knock sensor 1
- A29g2 Left knock sensor 2
- A30g1 Right knock sensor 1
- A30g2 Right knock sensor 2
- T1/1 Ignition coil cylinder 1
- T1/2 Ignition coil cylinder 2
- T1/3 Ignition coil cylinder 3
- T1/4 Ignition coil cylinder 4
- T1/5 Ignition coil cylinder 5
- T1/6 Ignition coil cylinder 6
- T1/7 Ignition coil cylinder 7
- T1/8 Ignition coil cylinder 8
- T1/9 Ignition coil cylinder 9
- T1/10 Ignition coil cylinder 10
- T1/11 Ignition coil cylinder 11
- T1/12 Ignition coil cylinder 12
- Y63 Left injectors
- Y64 Right injectors

P07.61-2053-06

Electrical Test Program – Component Locations

Engine Compartment
Model 129

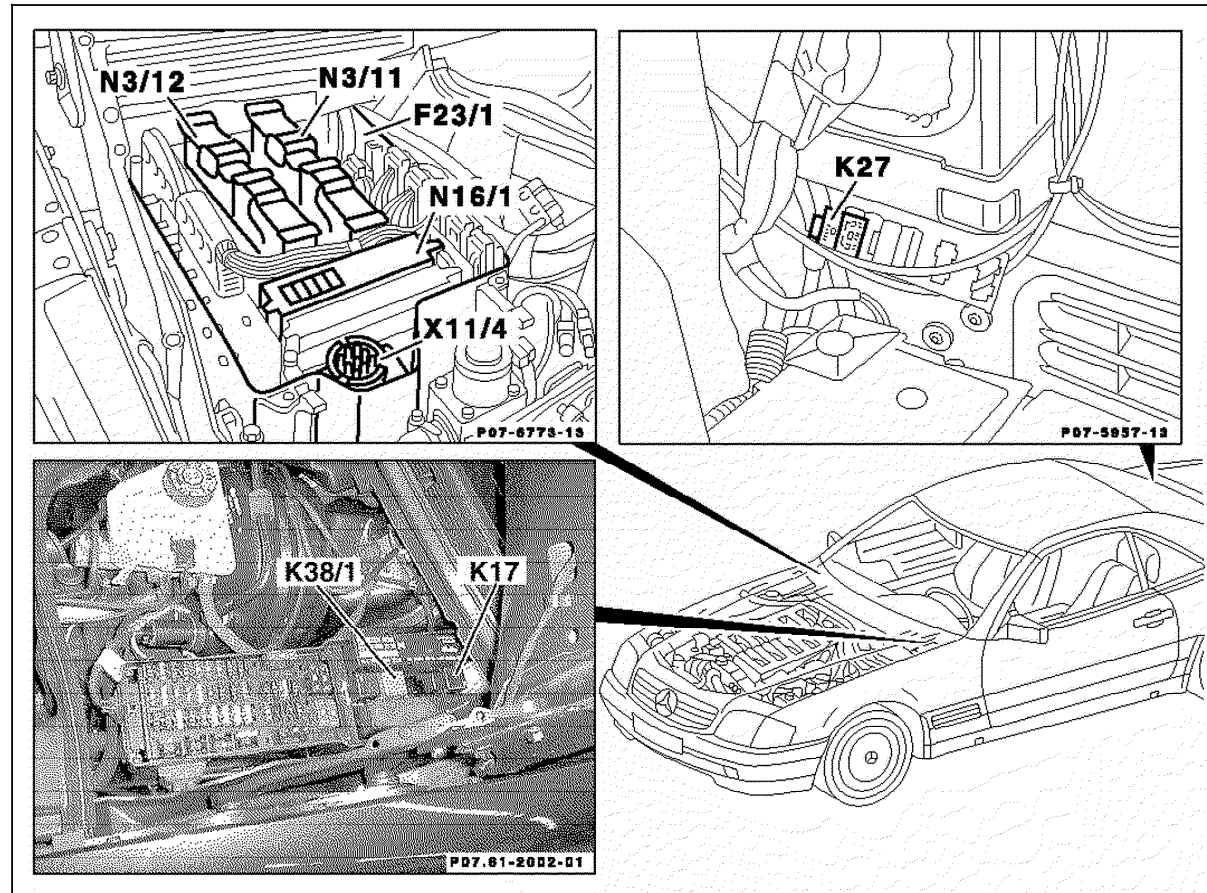

Figure 4

- F23/1 Control module box
- K17 AIR relay module
- K27 FP relay module
- K38/1 Starter lock-out relay module
- N3/11 Left engine control module (ME-SFI)
- N3/12 Right engine control module (ME-SFI)
- N16/1 Base module
- X11/4 Data link connector (DTC readout)

P07.61-2017-06

Electrical Test Program – Component Locations

Engine Compartment
Model 129

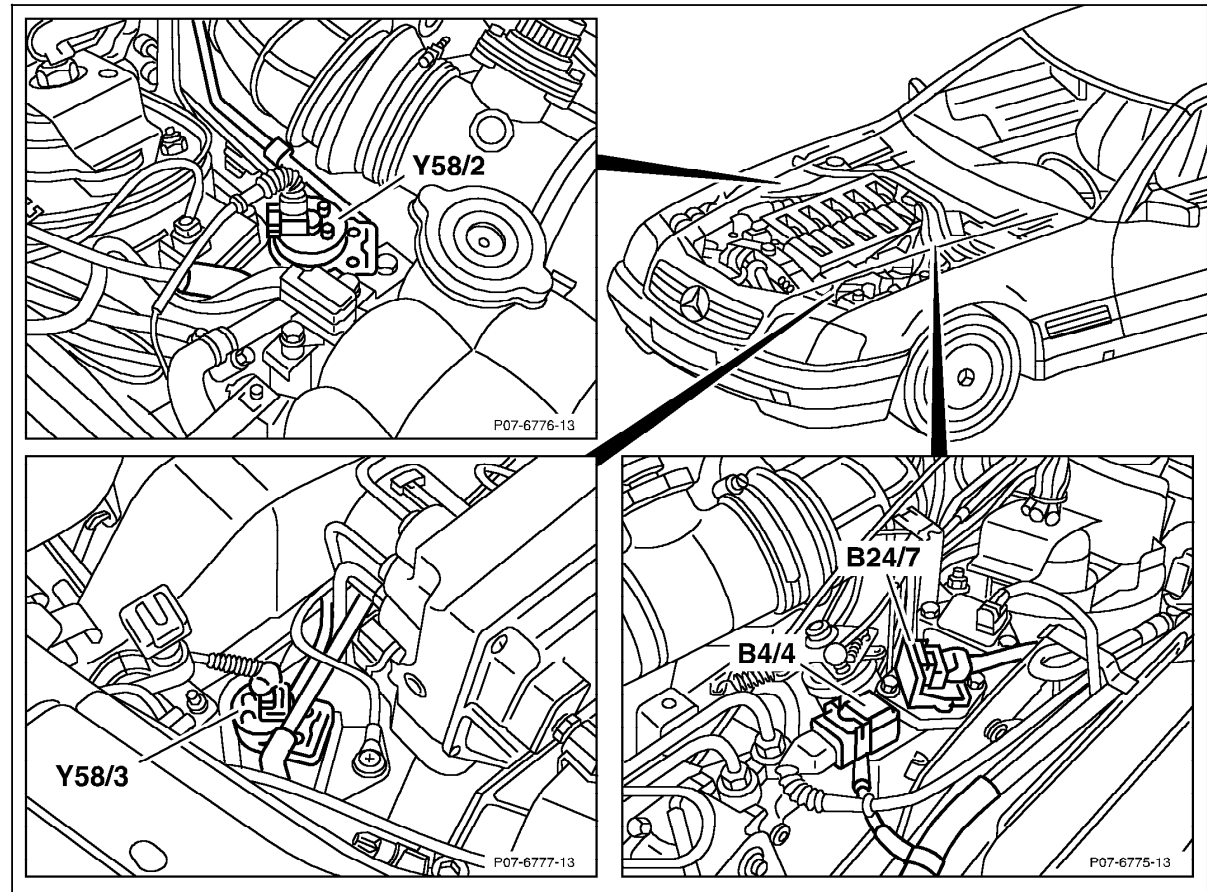

Figure 5

- B4/4 Purge control pressure sensor (only USA, up to 08/97)
- B24/7 Body acceleration sensor (only up to 05/97)
- Y58/2 Left purge control valve (located in engine compartment, right hand side)
- Y58/3 Right purge control valve (located in engine compartment, left hand side)

P07.61-2055-06

Electrical Test Program – Component Locations

Engine Compartment
Model 129

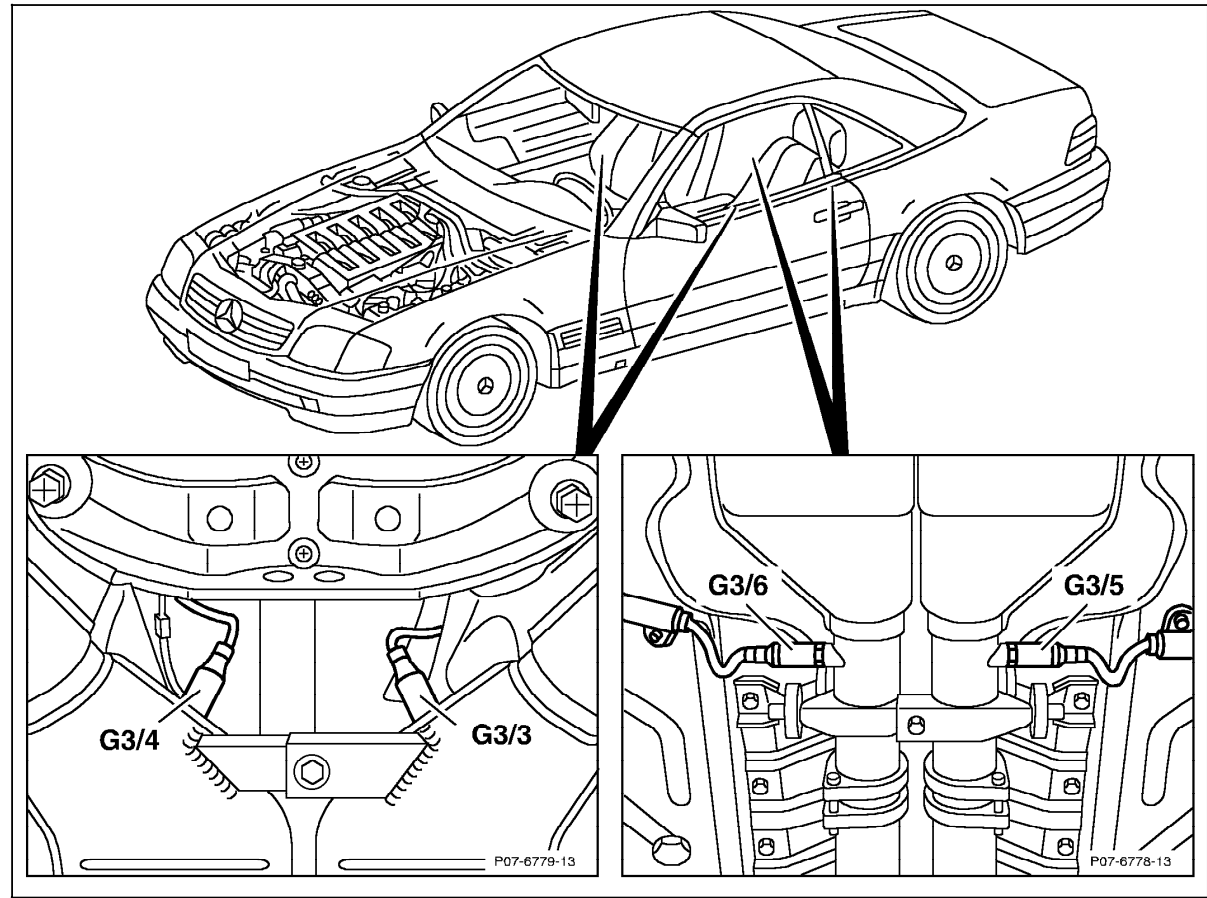

Figure 6

- G3/3 Left O2S 1 (before TWC)
- G3/4 Right O2S 1 (before TWC)
- G3/5 Left O2S 2 (after TWC) (only USA)
- G3/6 Right O2S 2 (after TWC) (only USA)

P07.61-2057-06

Electrical Test Program – Component Locations

Engine Compartment
Model 129

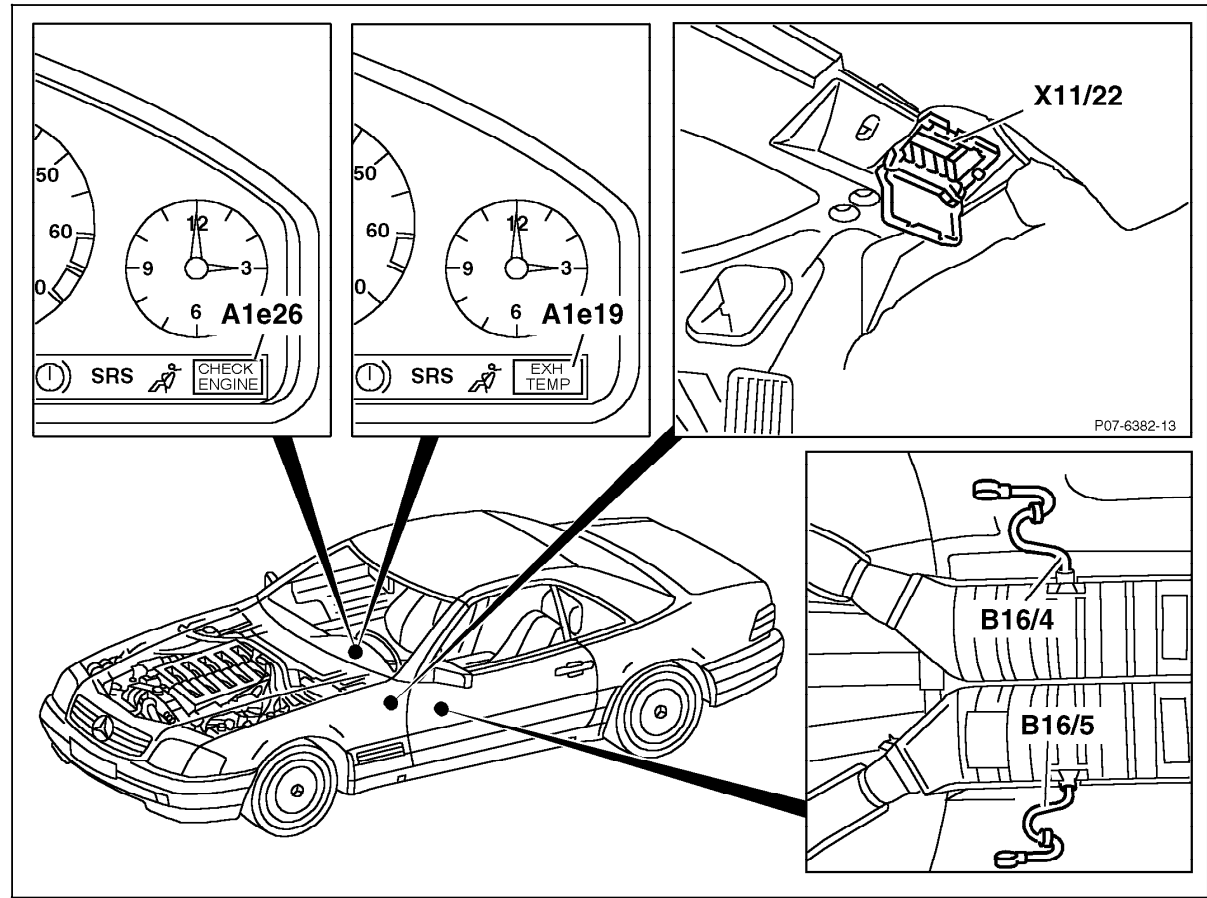

Figure 7

- A1e19 Catalytic converter overheat warning lamp (Ⓝ) up to 05/96)
- A1e26 "CHECK ENGINE" MIL (only USA)
- B16/4 Left exhaust gas temperature sensor (Ⓝ) up to 05/96)
- B16/5 Right exhaust gas temperature sensor (Ⓝ) up to 05/96)
- X11/22 Diagnostic module (OBD II) generic scan tool connector (only USA)

P07.61-0228-06

Electrical Test Program – Component Locations

Trunk Compartment
Model 129

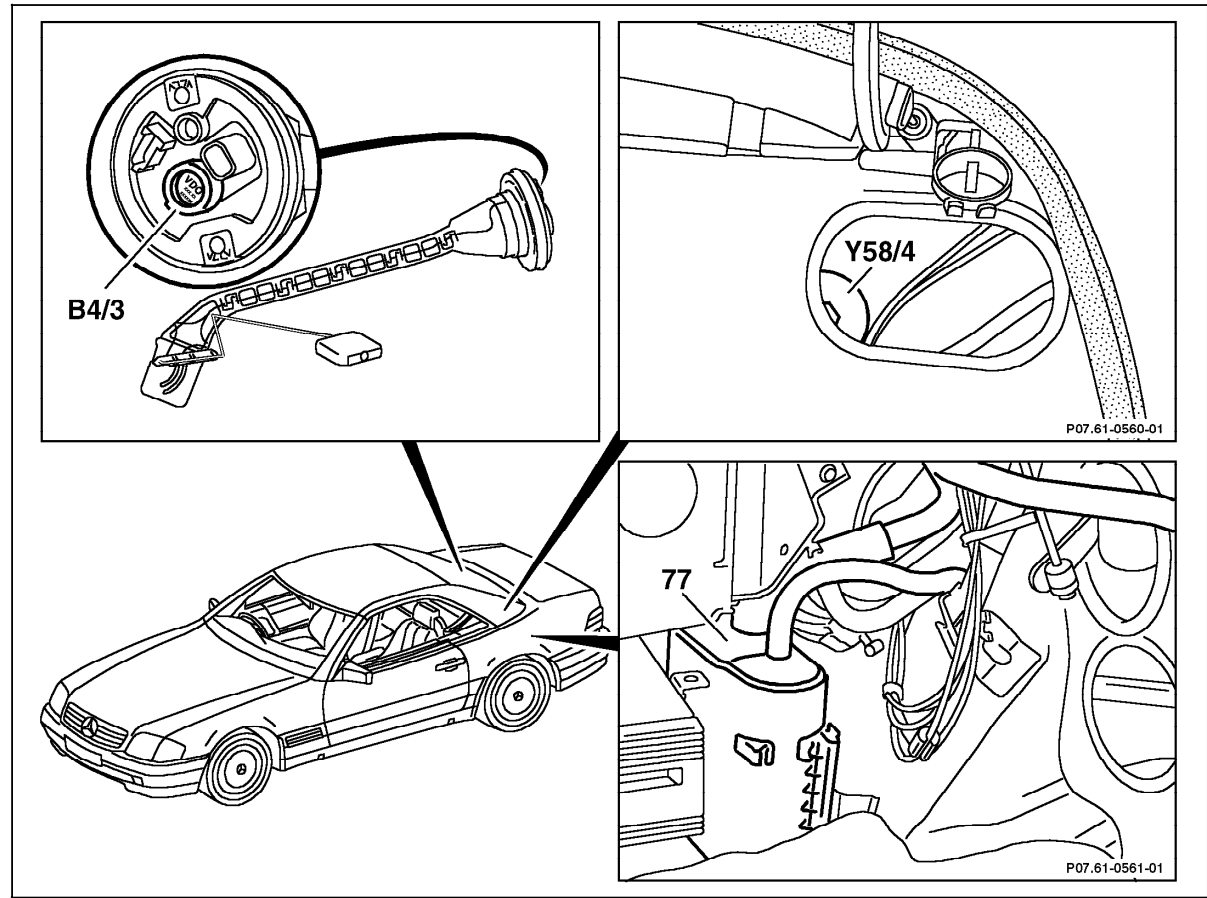

Figure 8

- B4/3 Fuel tank pressure sensor (only USA, as of 09/97)
- Y58/4 Activated charcoal canister shut-off valve (only USA, as of 09/97)
- 77 Activated charcoal canister

P07.61-0552-06

Electrical Test Program – Component Locations

Components on engine
Model 140

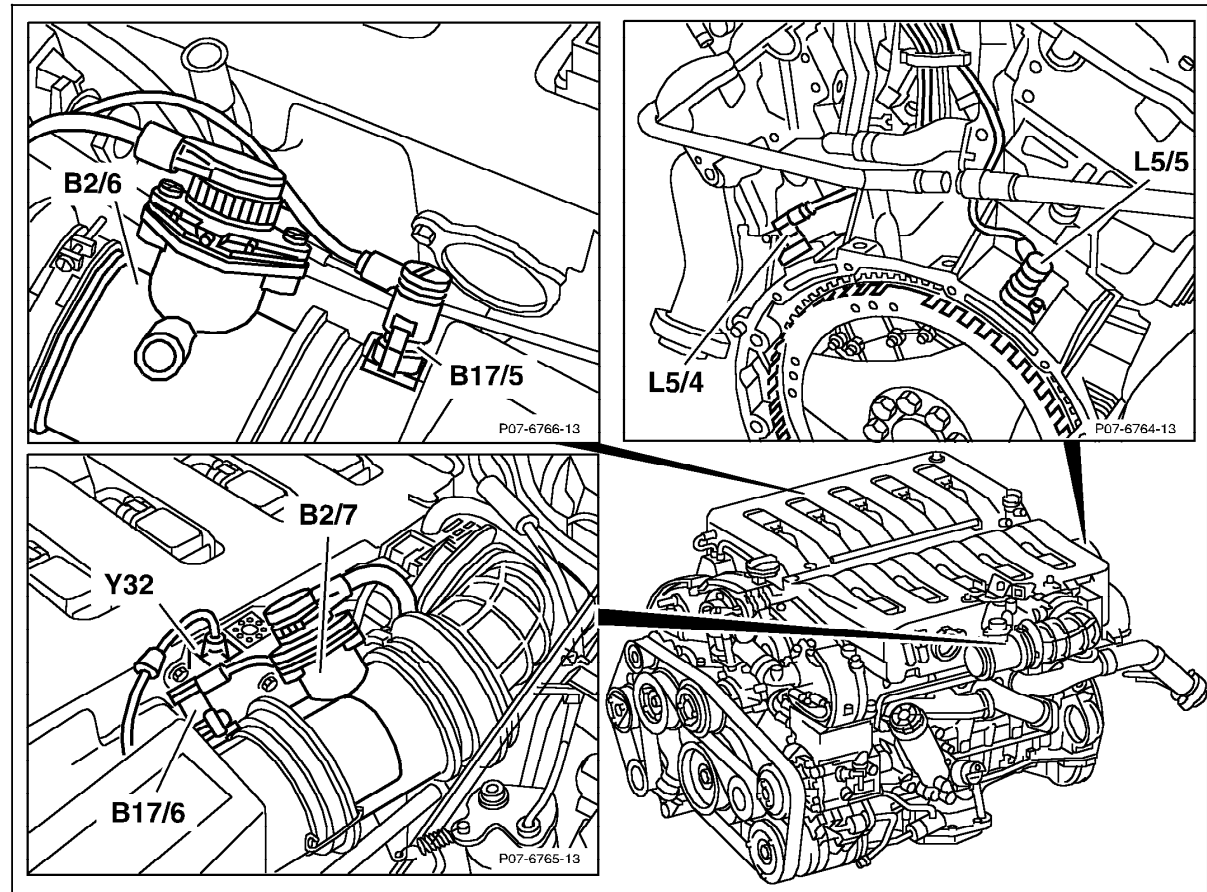

Figure 9

- B2/6 Left hot film MAF sensor (located on right side of engine)
- B2/7 Right hot film MAF sensor (located on left side of engine)
- B17/5 Left IAT sensor (located in engine compartment, right hand side)
- B17/6 Right IAT sensor (located in engine compartment, left hand side)
- L5/4 Left CKP sensor
- L5/5 Right CKP sensor
- Y32 AIR pump switchover valve

P07.61-2052-06

Electrical Test Program – Component Locations

Components on engine
Model 140

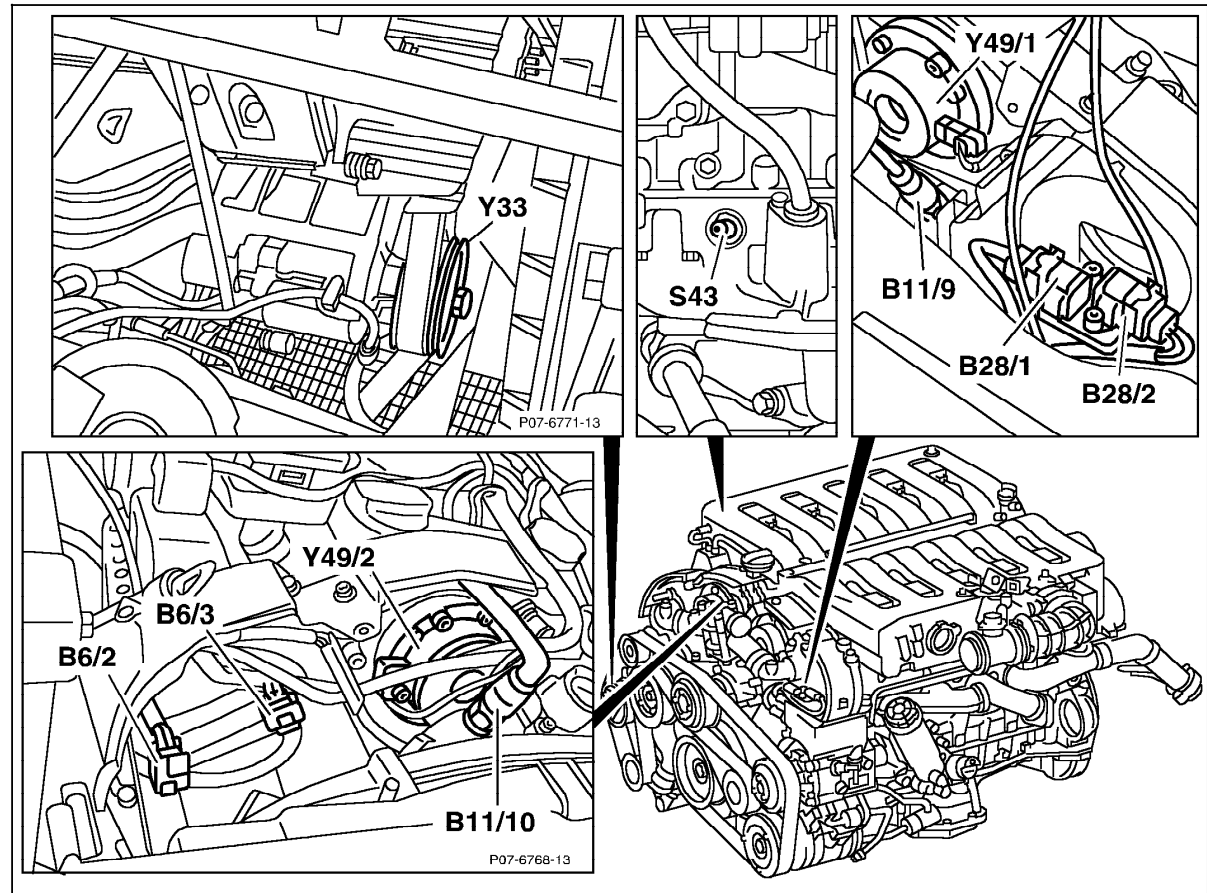

Figure 10

- B6/2 Left camshaft Hall-effect sensor
- B6/3 Right camshaft Hall-effect sensor
- B11/9 Left ECT sensor
- B11/10 Right ECT sensor
- B28/1 Left pressure sensor (only USA)
- B28/2 Right pressure sensor (only USA)
- S43 Oil level switch
- Y33 Electromagnetic AIR pump clutch
- Y49/1 Left adjustable camshaft timing solenoid
- Y49/2 Right adjustable camshaft timing solenoid

P07.61-2054-06

Electrical Test Program – Component Locations

Components on engine
Model 140

Figure 11

- A29g1 Left knock sensor 1
- A29g2 Left knock sensor 2
- A30g1 Right knock sensor 1
- A30g2 Right knock sensor 2
- T1/1 Ignition coil cylinder 1
- T1/2 Ignition coil cylinder 2
- T1/3 Ignition coil cylinder 3
- T1/4 Ignition coil cylinder 4
- T1/5 Ignition coil cylinder 5
- T1/6 Ignition coil cylinder 6
- T1/7 Ignition coil cylinder 7
- T1/8 Ignition coil cylinder 8
- T1/9 Ignition coil cylinder 9
- T1/10 Ignition coil cylinder 10
- T1/11 Ignition coil cylinder 11
- T1/12 Ignition coil cylinder 12
- Y63 Left injectors
- Y64 Right injectors

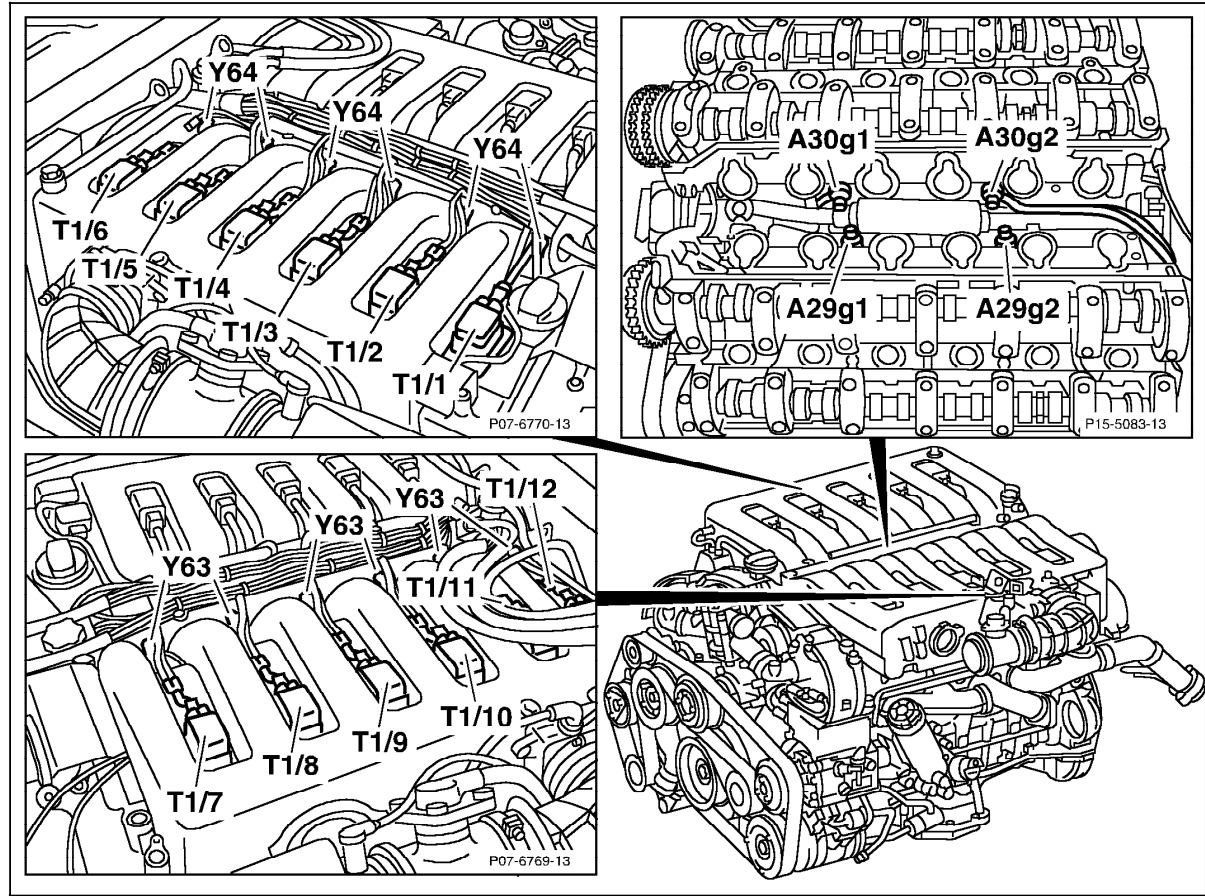

P07.61-2053-06

Electrical Test Program – Component Locations

Engine Compartment
Model 140

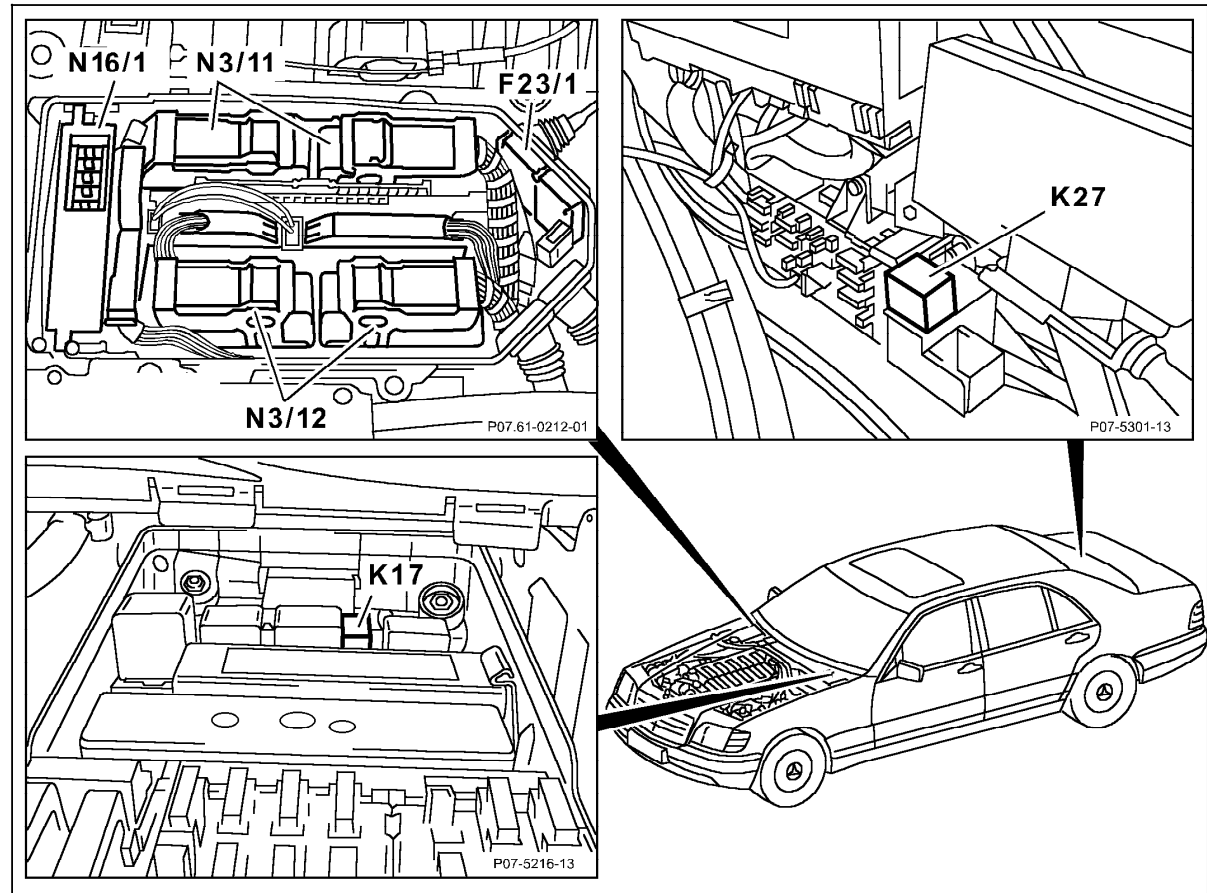

Figure 12

- F23/1 Control module box
- K17 AIR relay module
- K27 FP relay module
- N3/11 Left engine control module (ME-SFI)
- N3/12 Right engine control module (ME-SFI)
- N16/1 Base module

Electrical Test Program – Component Locations

Engine Compartment
Model 140

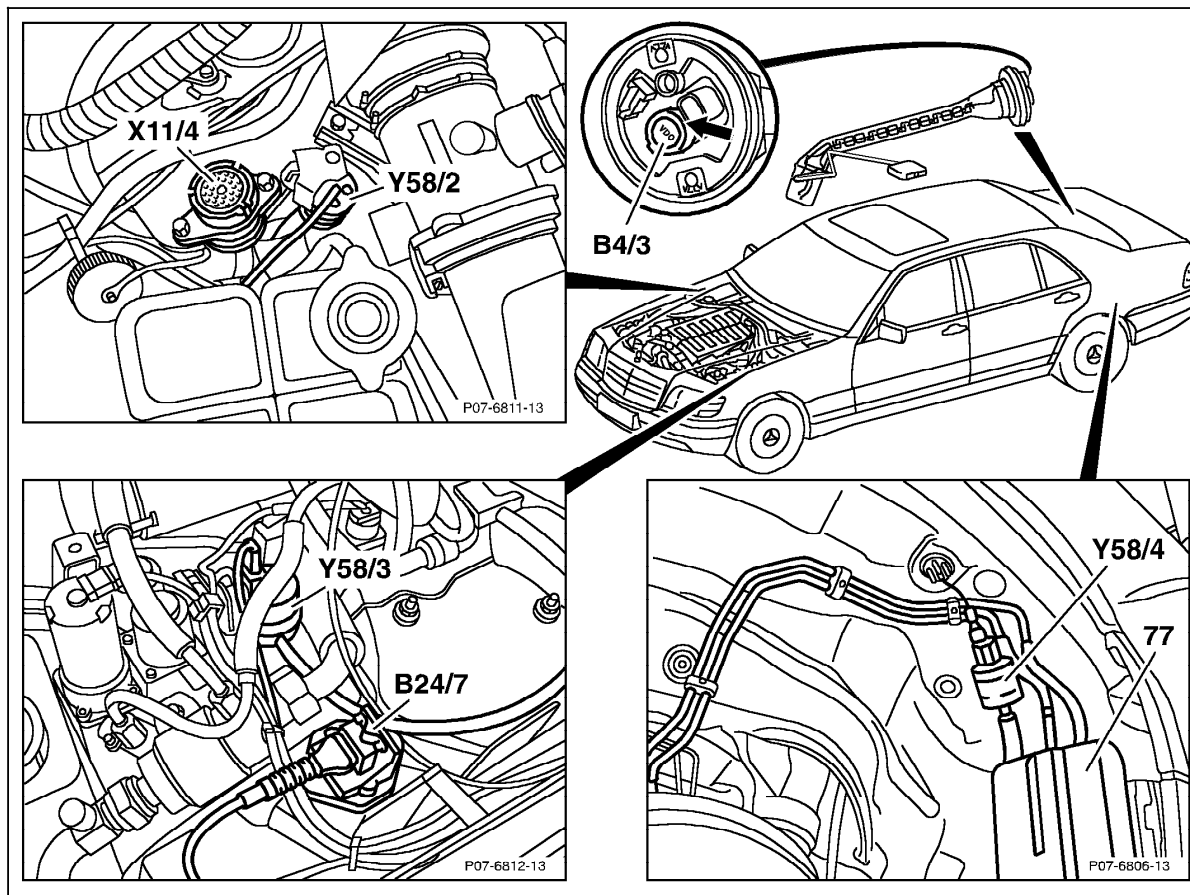

Figure 13

- B4/3 Fuel tank pressure sensor (only USA)
- B24/7 Body acceleration sensor (only up to 05/96)
- X11/4 Data link connector
- Y58/2 Left purge control valve (located in engine compartment, right hand side)
- Y58/3 Right purge control valve (located in engine compartment, left hand side)
- Y58/4 Activated charcoal canister shut-off valve (only USA)
- 77 Active charcoal canister

P07.61-2056-06

Electrical Test Program – Component Locations

Engine Compartment
Model 140

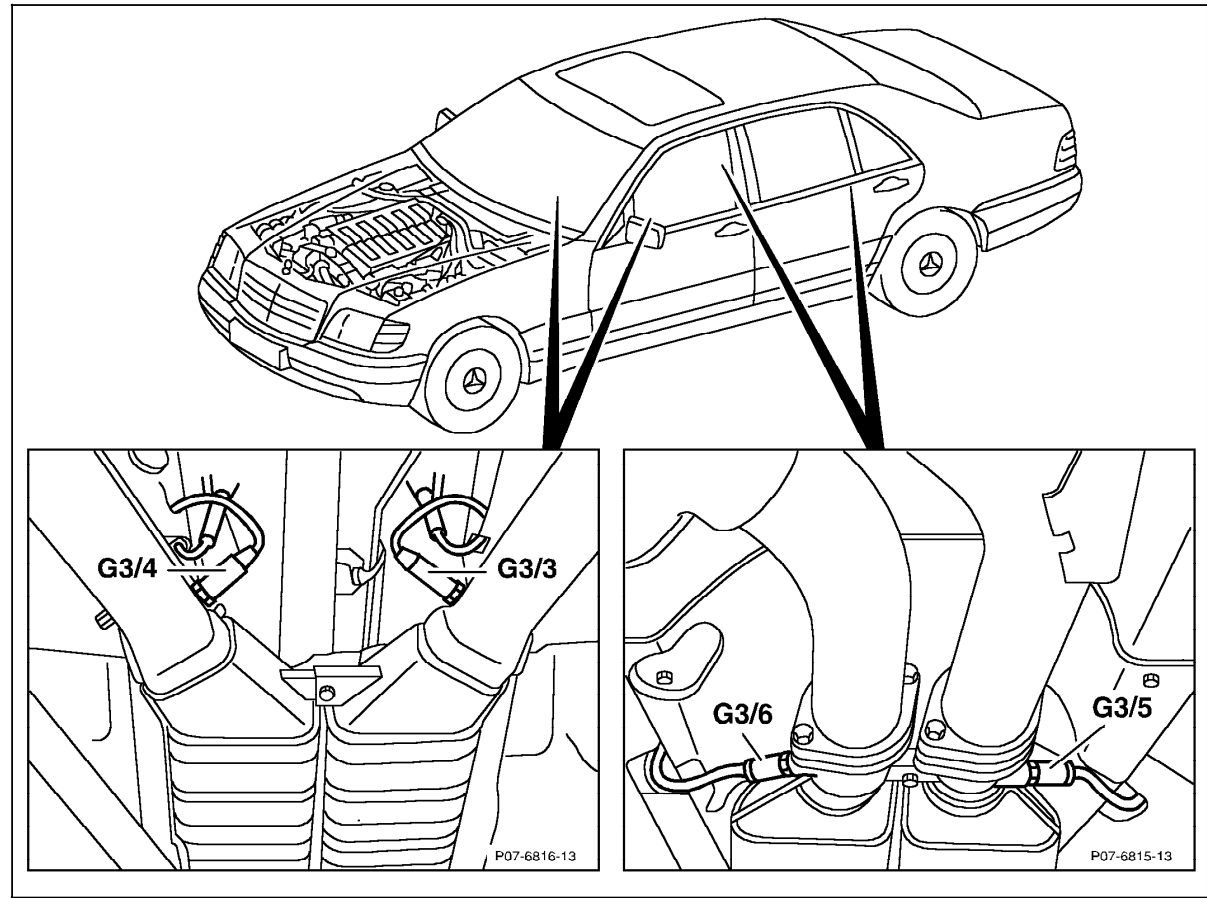

Figure 14

- G3/3 Left O2S 1 (before TWC)
- G3/4 Right O2S 1 (before TWC)
- G3/5 Left O2S 2 (after TWC) (only USA)
- G3/6 Right O2S 2 (after TWC) (only USA)

P07.61-2058-06

Electrical Test Program – Component Locations

Engine Compartment
Model 140

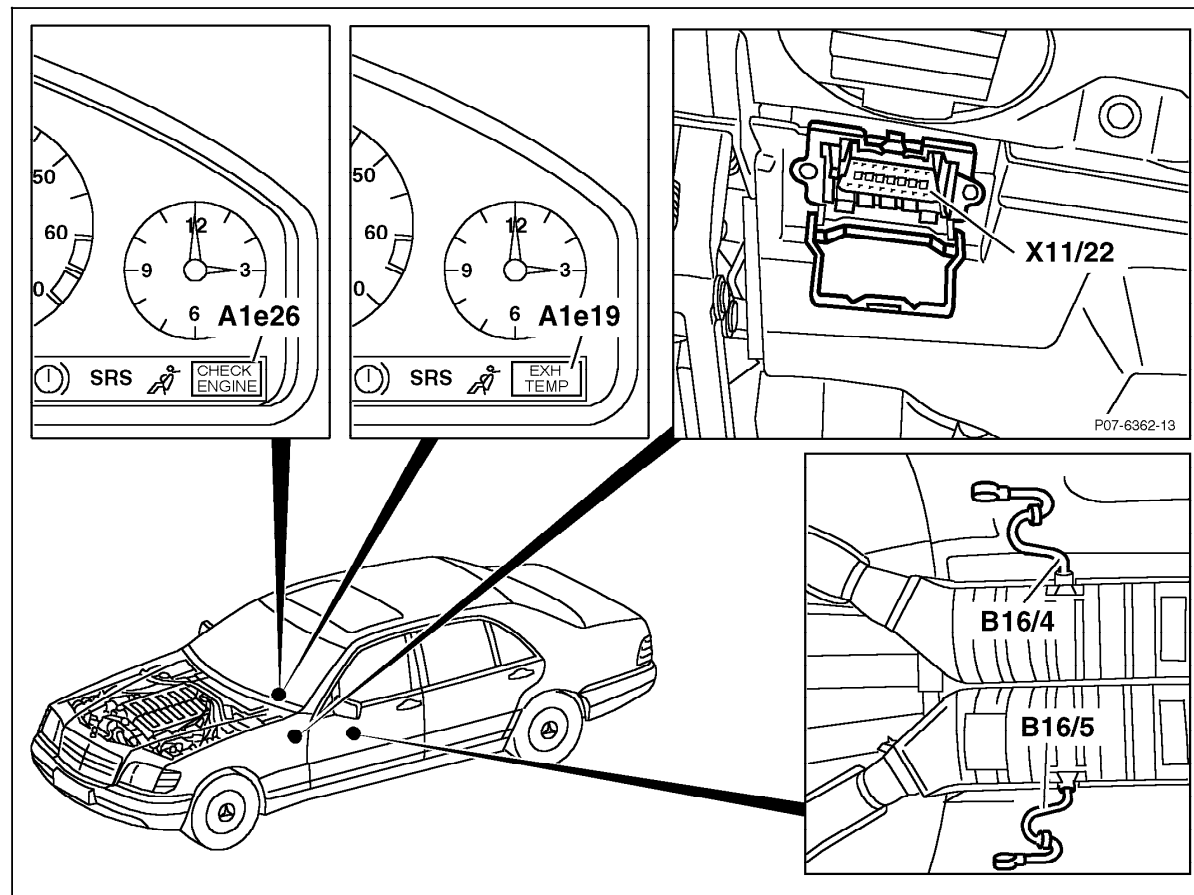

Figure 15

- A1e19 Catalytic converter overheat warning lamp (Ⓝ) up to 05/96)
- A1e26 “CHECK ENGINE” MIL (only USA)
- B16/4 Left exhaust gas temperature sensor (Ⓝ) up to 05/96)
- B16/5 Right exhaust gas temperature sensor (Ⓝ) up to 05/96)
- X11/22 Diagnostic module (OBD II) generic scan tool connector (only USA)

P07.61-0230-06

Electrical Test Program – Component Locations

Model 140

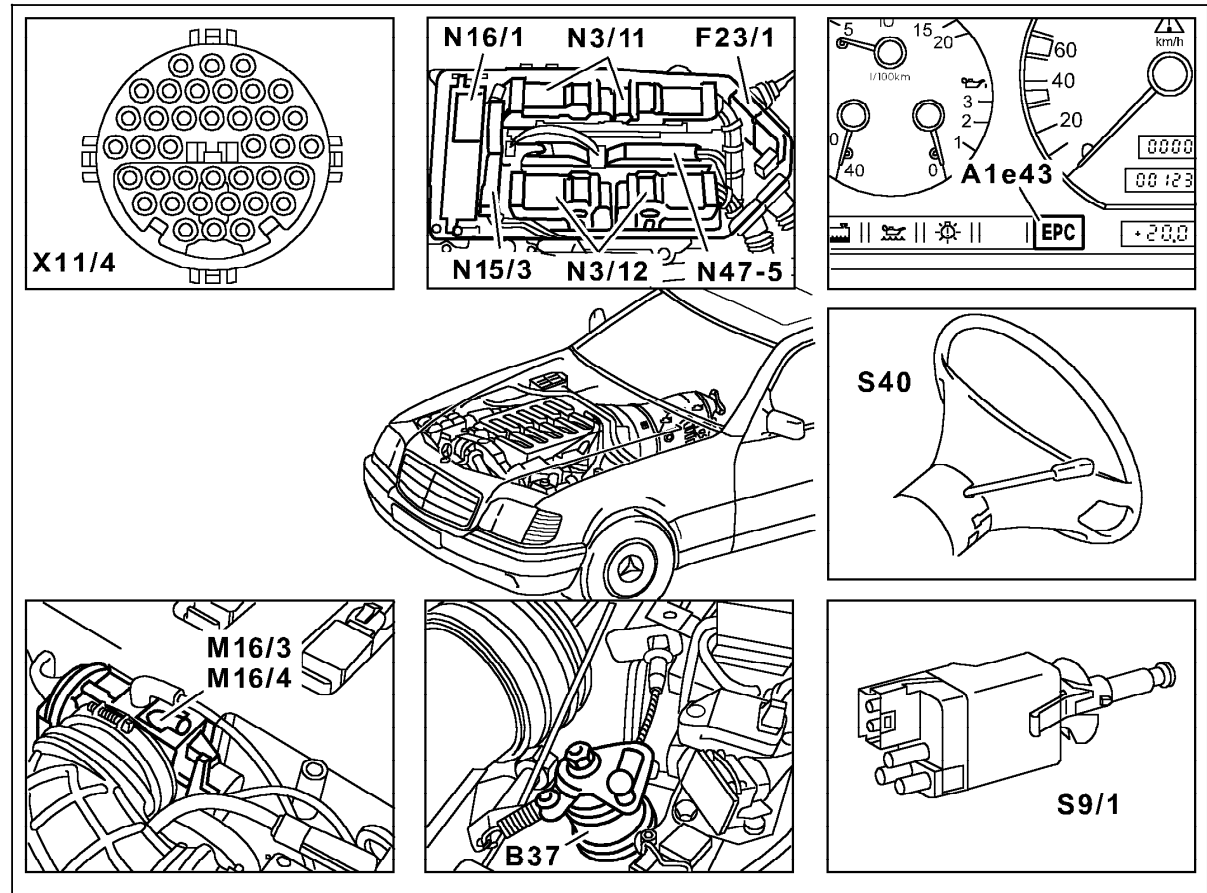

Figure 16

- A1e43 EPC MIL (up to 05/96)
- B37 Pedal value sensor
- F23/1 Control module box
- M16/3 Right EA/CC/ISC actuator (located on left)
- M16/4 Left EA/CC/ISC actuator (located on right)
- N3/11 Left engine control module (ME-SFI)
- N3/12 Right engine control module (ME-SFI)
- N15/3 Transmission control module
- N16/1 Base module
- N47-5 ESP/SPS control module
- S9/1 Stop lamp switch
- S40 CC switch
- V Decelerate/set
- B Accelerate/set
- SP Memory
- A OFF
- X11/4 Data link connector (DTC readout)

P07.61-0214-06