

Pneumatic Test Program - Preparation for Test

Preparation for Test:

1. Connect vacuum/pressure tester with reservoir to PSE control module (see 32, Figures 1, 2 and 3).
2. Unlock vehicle using IR transmitter,
3. Battery voltage 11 – 14 V,
4. Fuses ok,
5. Review section 0, 11, 12, 20, 21, 22, 31, 32,
6. Provide access to PSE control module (A37) and disconnect PSE pneumatic multiple connector (do not disconnect wiring harness).

Parts Required for Test:

1	Reservoir	107 800 08 19
1	Y-distributor	117 078 01 45
3	Connector	202 800 03 53
1	Connector	202 800 05 53
1	Connection hose, 50 mm long	007 997 61 82
2	Pneumatic line, 1 m long	000 158 14 35
8	Rubber plug	000 987 11 45

Special Tools

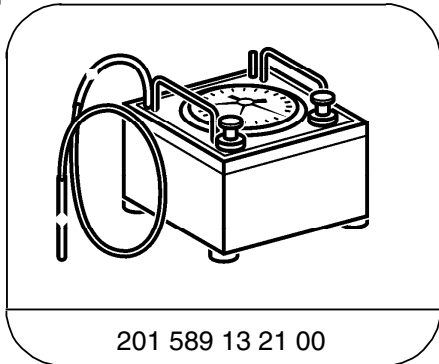

201 589 13 21 00

Tester

Notes:

1. Before testing the safety switch time of the consumers, interrupt the PSE control module power supply for at least 3 seconds.
2. After completing the **PSE** control module test, interrupt the PSE control module power supply for at least 3 seconds (erase safety switch time memory).
3. After completing the **PSE** control module test, do not operate any system which would require vacuum or pressure for approx. 10 minutes.
4. The connections on the PSE control module are marked with their German acronyms. Reference to these connections in this test are made to their U. S. equivalents. In other words:
 ZV (German) = CL (U.S.),
 SRU (German) = MVA (U.S.),
 OSL (German) = OSB (U.S.).

Pneumatic Test Program - Preparation for Test

Connection Diagram - Vacuum/Pressure Tester with Reservoir
Model 129

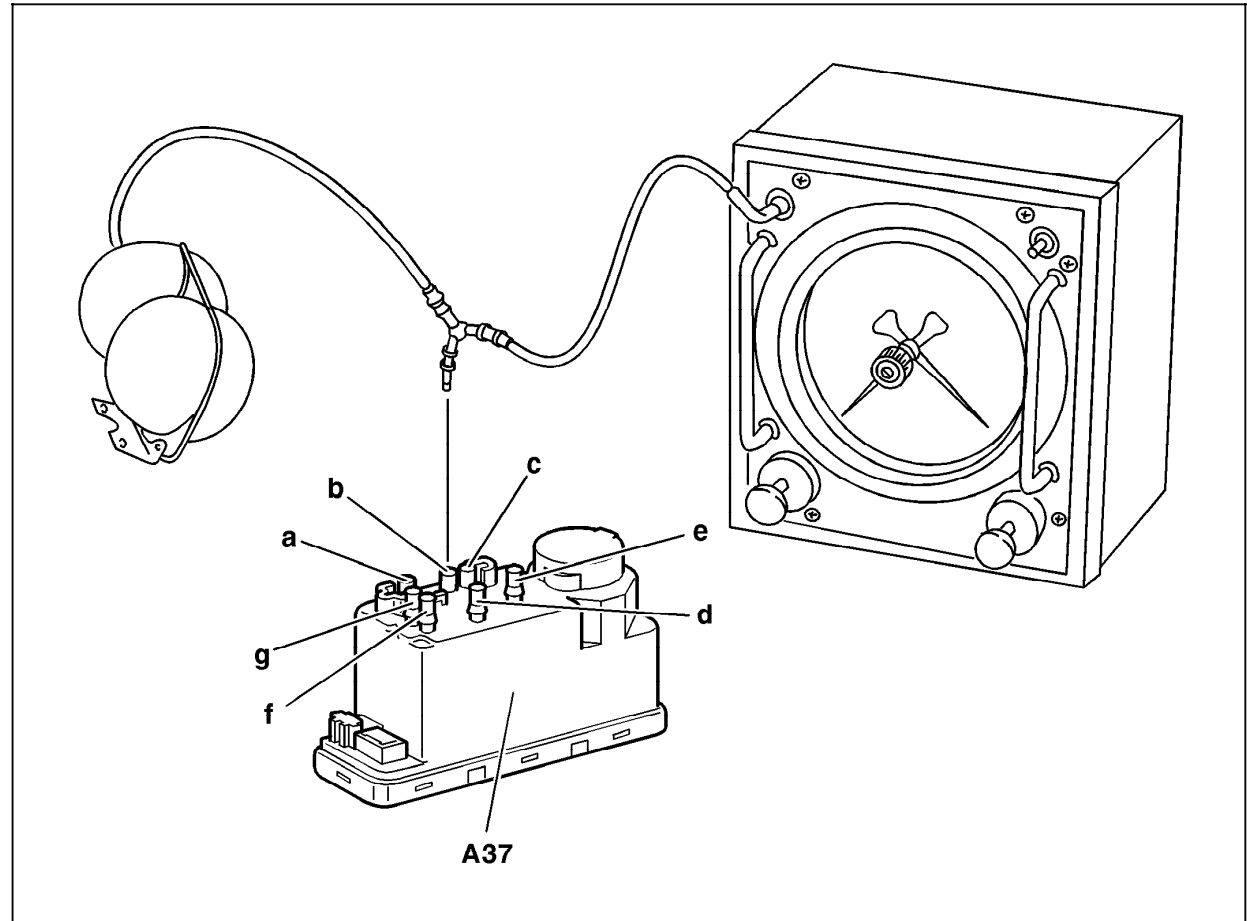

Figure 1

- a Right door pneumatic connection
- b Left door pneumatic connection
- c Fuel filler flap pneumatic connection
- d RTR pneumatic connection
- e OSB pneumatic connection
- f Trunk lid pneumatic connection
- g CL pneumatic connection
- A37 PSE control module, combined functions

P80.20-0450-06

Pneumatic Test Program - Preparation for Test

Connection Diagram - Vacuum/Pressure Tester with Reservoir
Model 140

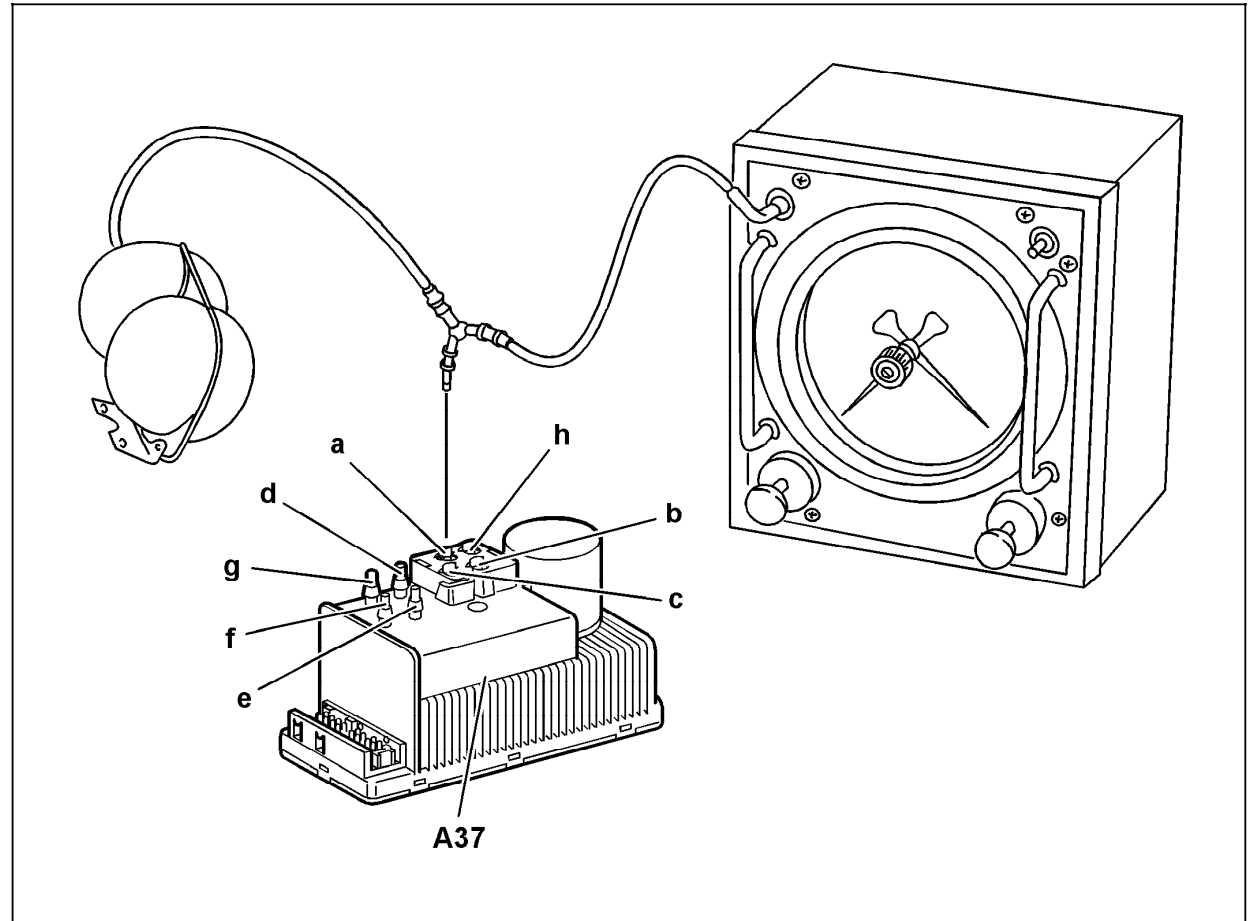

Figure 2

- a Pneumatic connection, passenger/rear doors
- b Pneumatic connection, driver-side door
- c Pneumatic connection, fuel tank filler flap
- d Pneumatic connection, RTR/RHR
- e OSB pneumatic connection
- f MVA pneumatic connection
- g RTG pneumatic connection
- h Trunk lid pneumatic connection
- A37 PSE control module, combined functions

P80.20-0449-06

Pneumatic Test Program - Preparation for Test

Connection Diagram - Vacuum/Pressure Tester with Reservoir
Model 170

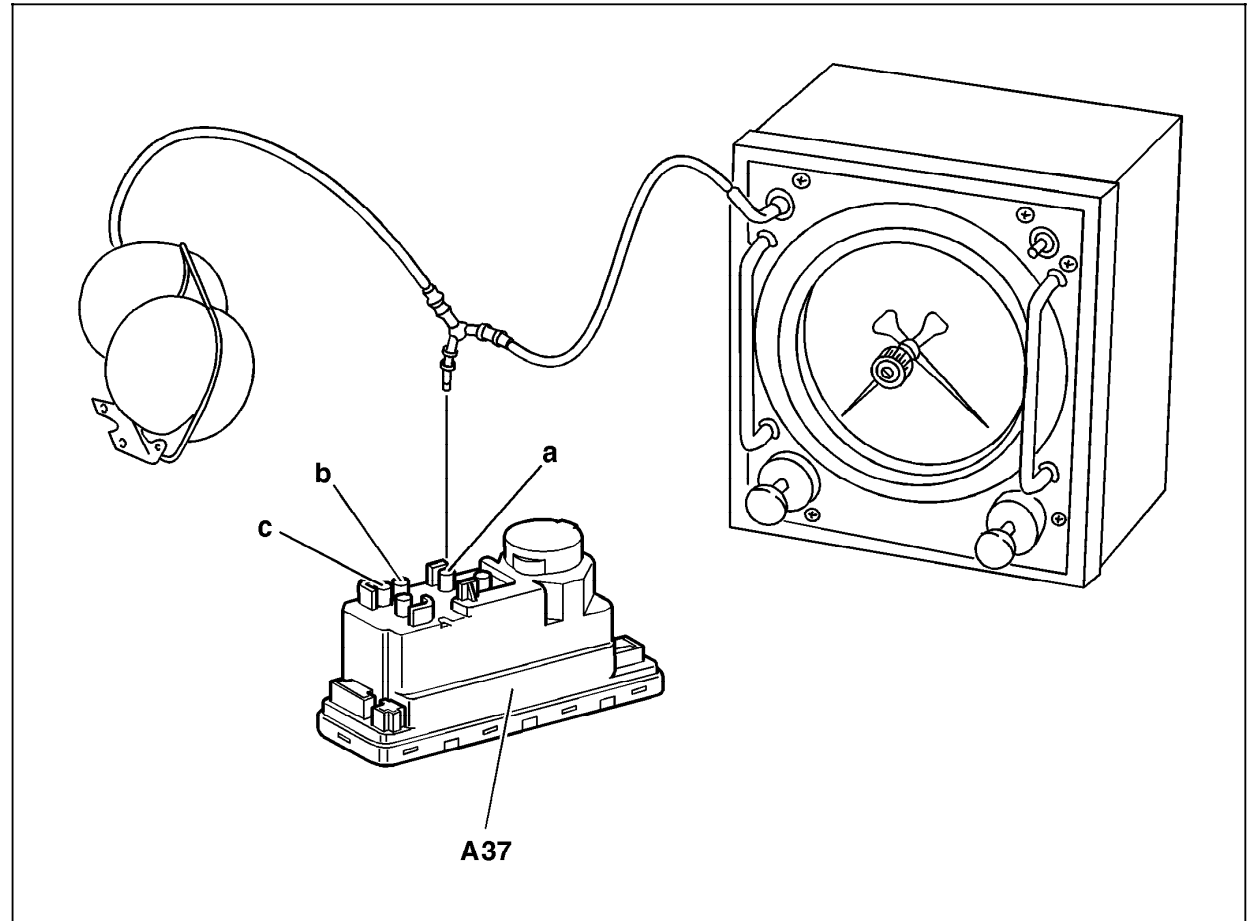

Figure 3

- a Passenger-side door pneumatic connection
- b Left door pneumatic connection
- c Fuel filler flap pneumatic connection
- A37 PSE control module, combined functions

P80.20-0448-06