

### Pneumatic Test Program - Preparation for Test

#### A. Pneumatic Test: Vacuum distribution block, Vacuum Reservoir, Fresh/recirculated Air flap Switchover Valve (Y13)

1. Disconnect all vacuum lines at vacuum distributor block (36), Figure 1.
2. Check gray vacuum line to intake manifold for leaks.



Permissible leakage of the elements with vacuum lines at 400 mbar vacuum per minute is 30 mbar.

#### Parts Required for Test:

- 1 Connector 129 800 95 15

#### Special Tools

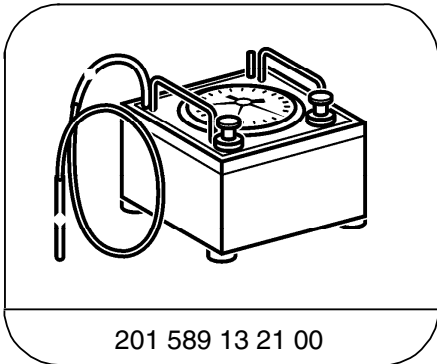

Tester

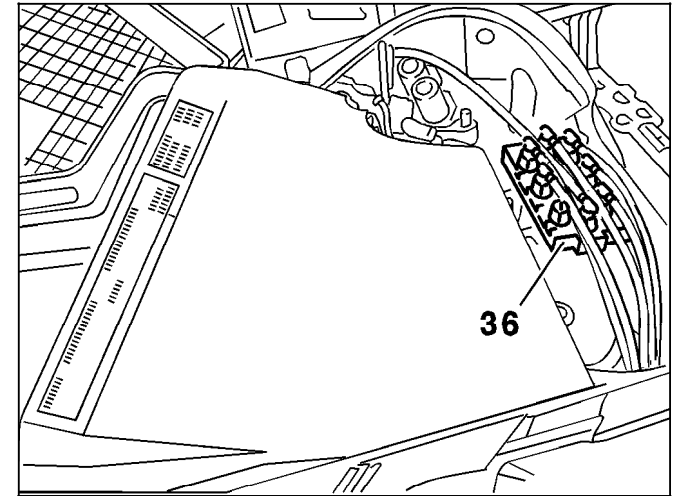

Figure 1

P83.25-0300-01

36 Vacuum distribution block

## Pneumatic Test Program – Test

## A. Vacuum distributor block, Vacuum Reservoir, Fresh/recirculated air flap switchover valve (Y13)

⇒	Test scope	Test connection	Test condition	Nominal value	Possible cause/Remedy
1.0	Entire vacuum distributor block, See 32/1	Connection "P" <b>on</b> vacuum tester.	Evacuate system with 300 mbar vacuum.	30 mbar pressure increase in 1 minute.	Vacuum distributor block, ⇒ 1.1
1.1	Vacuum distributor block, Check valve "a"	Connection "1" <b>on</b> vacuum tester.	Evacuate system with 300 mbar vacuum.	30 mbar pressure increase in 1 minute.	Vacuum distributor block, ⇒ 1.2
1.2	Vacuum distributor block, Check valve "b"	Connection "4" <b>on</b> vacuum tester.	Evacuate system with 300 mbar vacuum.	30 mbar pressure increase in 1 minute	Vacuum distributor block.



## Pneumatic Test Program – Test

## A. Vacuum distributor block, Vacuum Reservoir, Fresh/recirculated air flap switchover valve (Y13)

⇒	Test scope	Test connection	Test condition	Nominal value	Possible cause/Remedy
2.0	Vacuum reservoir with vacuum line, See 32/1	Red/gray line (connection 3) on vacuum tester.	Evacuate system with 300 mbar vacuum.	30 mbar pressure increase in 1 minute	Vacuum lines, Vacuum reservoir.
3.0	Fresh/recirculated air flap switchover valve (Y13), See 32/4, (Figure 2)	Ignition: <b>OFF</b> Medium green line (connection 2) on vacuum tester.	Evacuate system with 300 mbar vacuum.	30 mbar pressure increase in 1 minute	Vacuum lines, Y13
4.0	Fresh/recirculated air flap vacuum actuator, See 32/4, (Figure 2, 44)		Evacuate system with 300 mbar vacuum.	30 mbar pressure increase in 1 minute	Vacuum lines, Actuator.

### Pneumatic Test Program - Preparation for Test

#### Vacuum system

1. Ignition: **ON**
2.  stage 1
3.  button is illuminated.
4. Medium green line (connection 5) to tester.

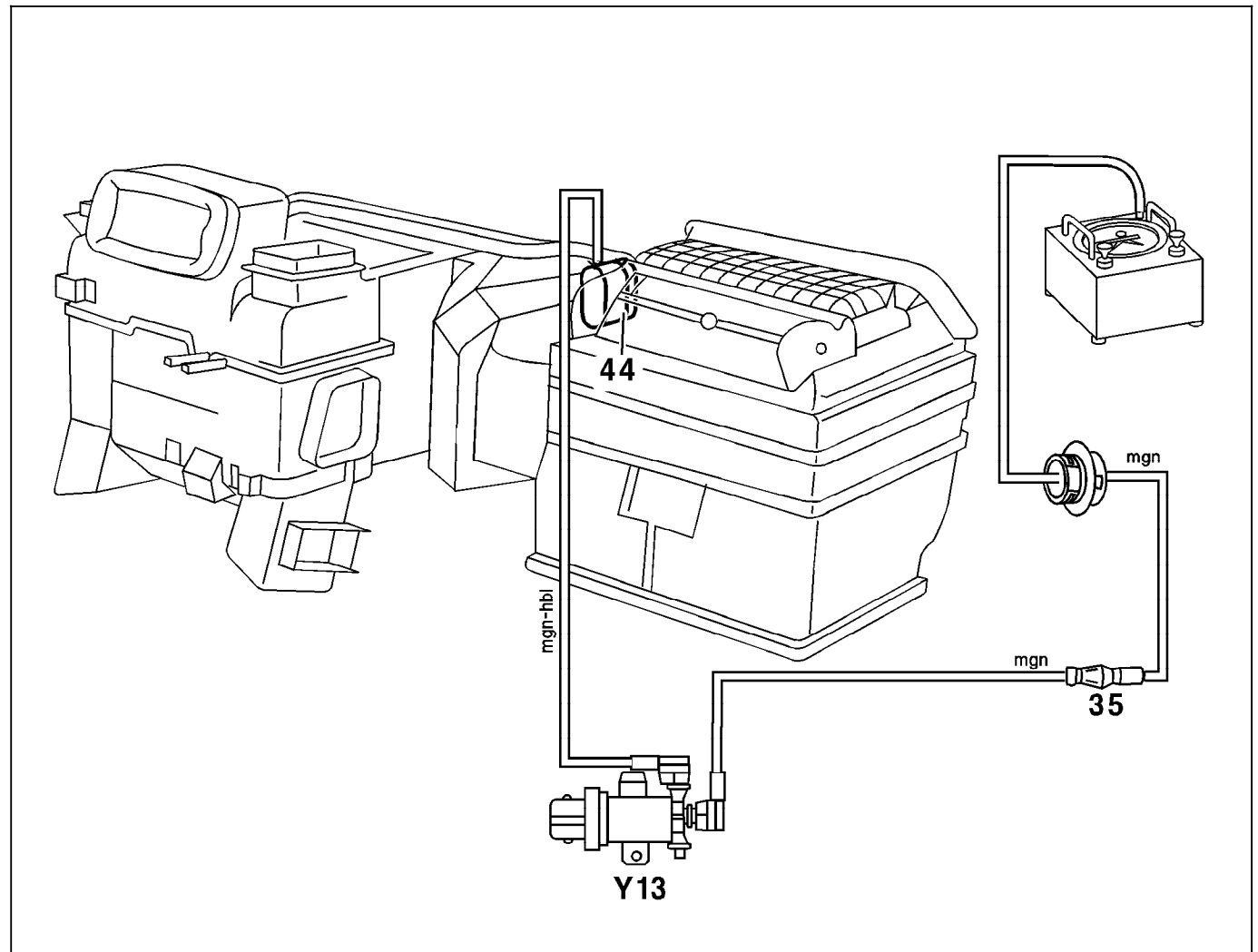

Figure 2

- |     |                                              |
|-----|----------------------------------------------|
| 35  | Separation point (cockpit)                   |
| 44  | Fresh/recirculated air flap vacuum actuator  |
| Y13 | Fresh/recirculated air flap switchover valve |
| mgn | Medium green                                 |

P83.25-0303-06