

Hydraulic Test Program - Preparation for Test

Preparation for Test

1. Ignition: **OFF**
2. Check oil level in oil reservoir and correct if necessary.
3. Remove plastic cover.
4. Remove ASD control module.
5. Bridge socket 8 and socket 10 at the electrical connector for ASD control module.
6. Connect the pressure test tool to the ring cylinder as per the connection diagram.

Note:

Depending on accessibility, the pressure test tool can be installed on either the right vent screw or the left “HS” line.

Note:

Checking hydraulic pump: Model 129, 140: 3.2 32 (ADS)
 Model 124, 201, 202: See SMS, Job no. 32-0530

Special Tools

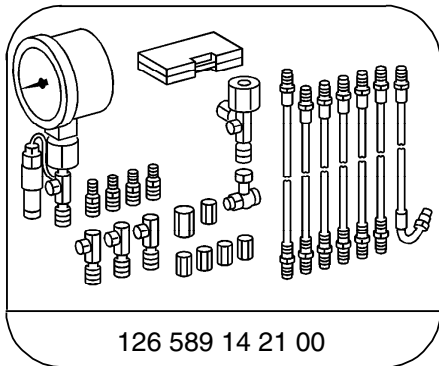

126 589 14 21 00

Tester

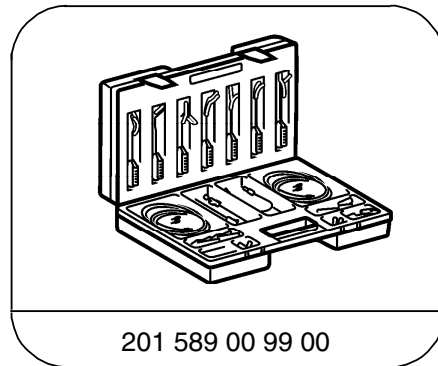

201 589 00 99 00

Electrical connecting set

Hydraulic Test Program - Preparation for Test

Connection Diagram - Pressure Test Tool
(Model 201 shown)

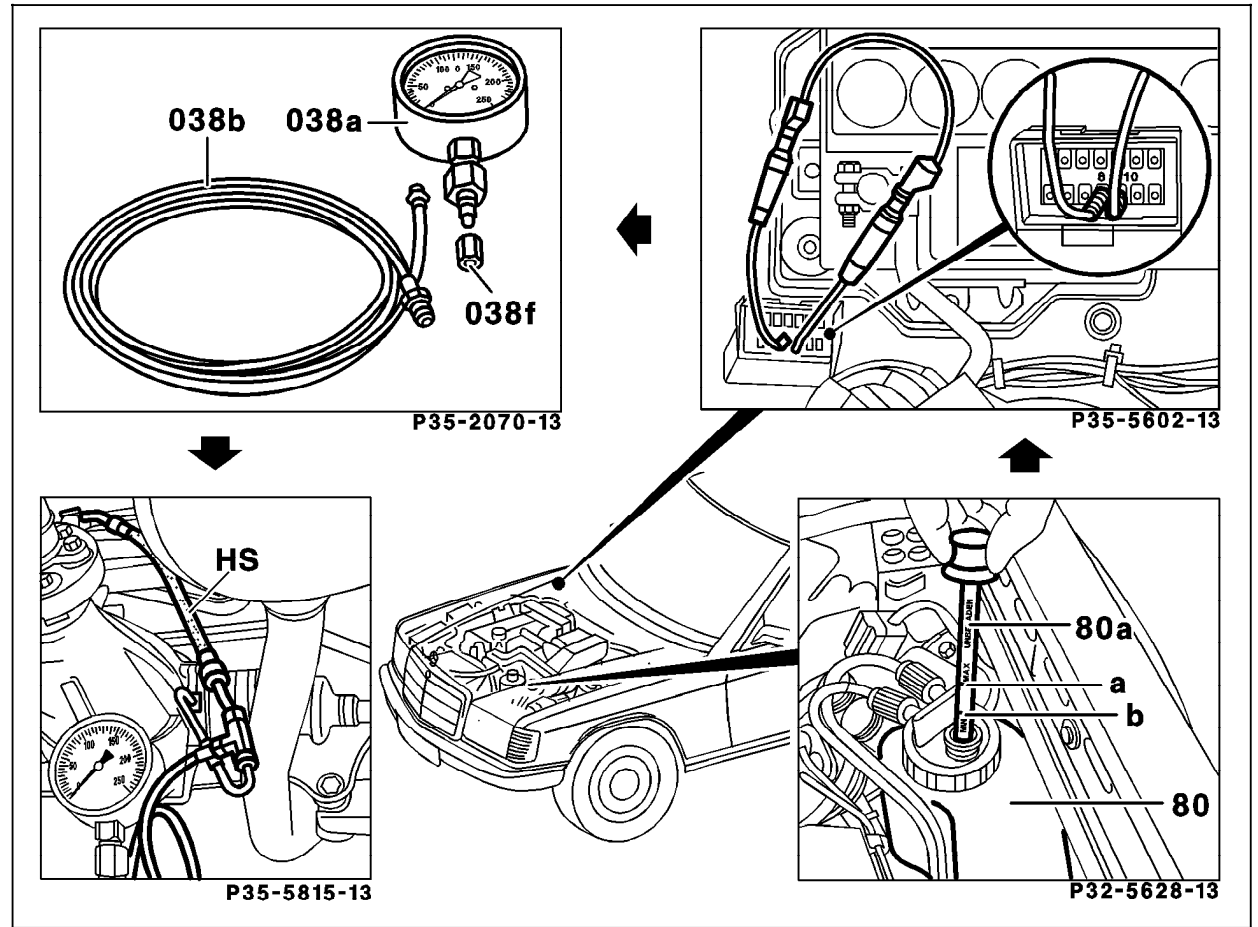

P35-5823-57

Figure 1

- 80 Oil reservoir
- 80a Oil reservoir dip stick
- a Maximum oil level
- b Minimum oil level
- HS Pressure line